

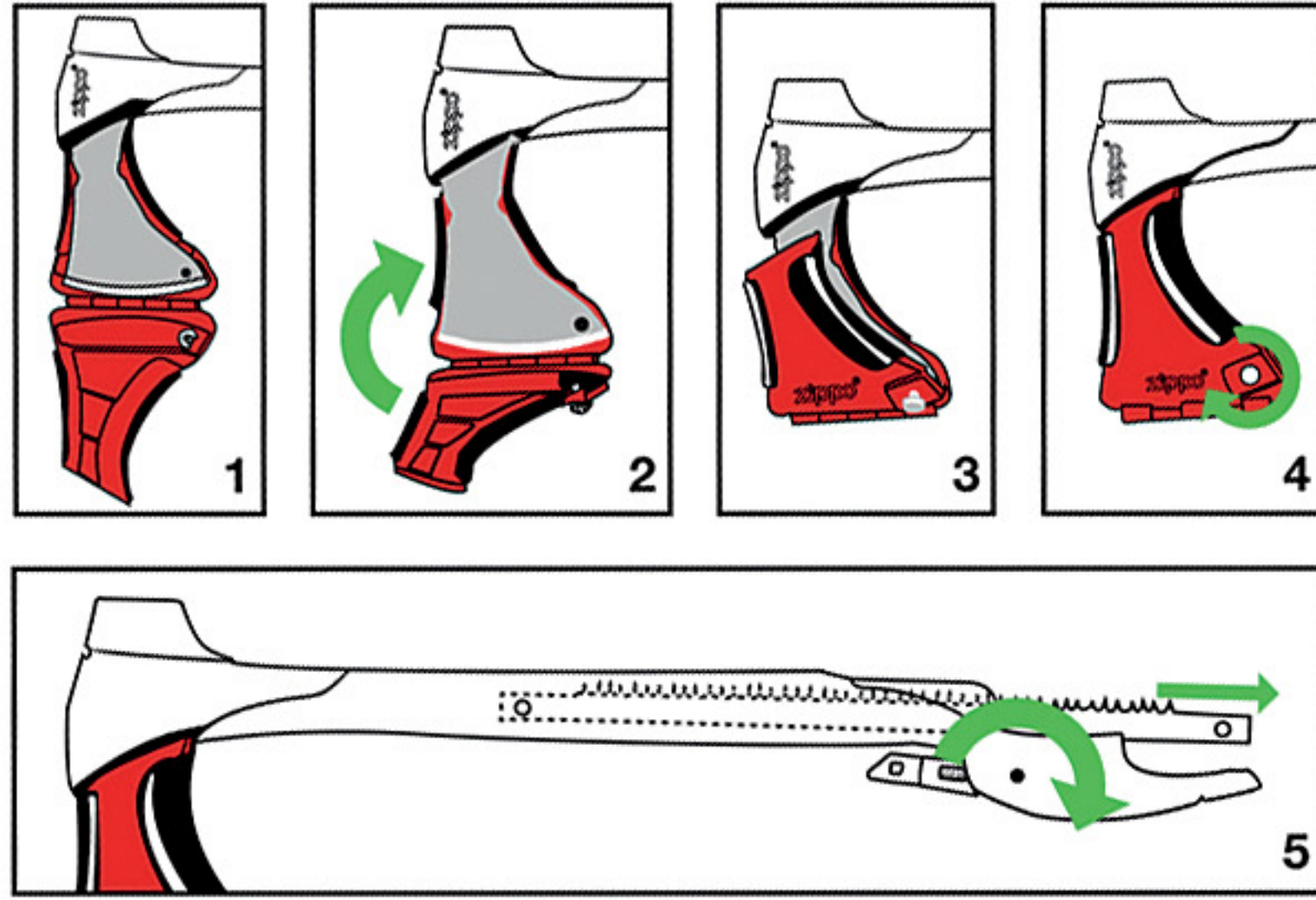

WARNING: AxeSaw should never be used by or around children. Serious injury or death could occur.
WARNING: Axe and saw blades are extremely sharp. Use caution at all times when using or handling the AxeSaw. Failure to comply could cause serious injury.

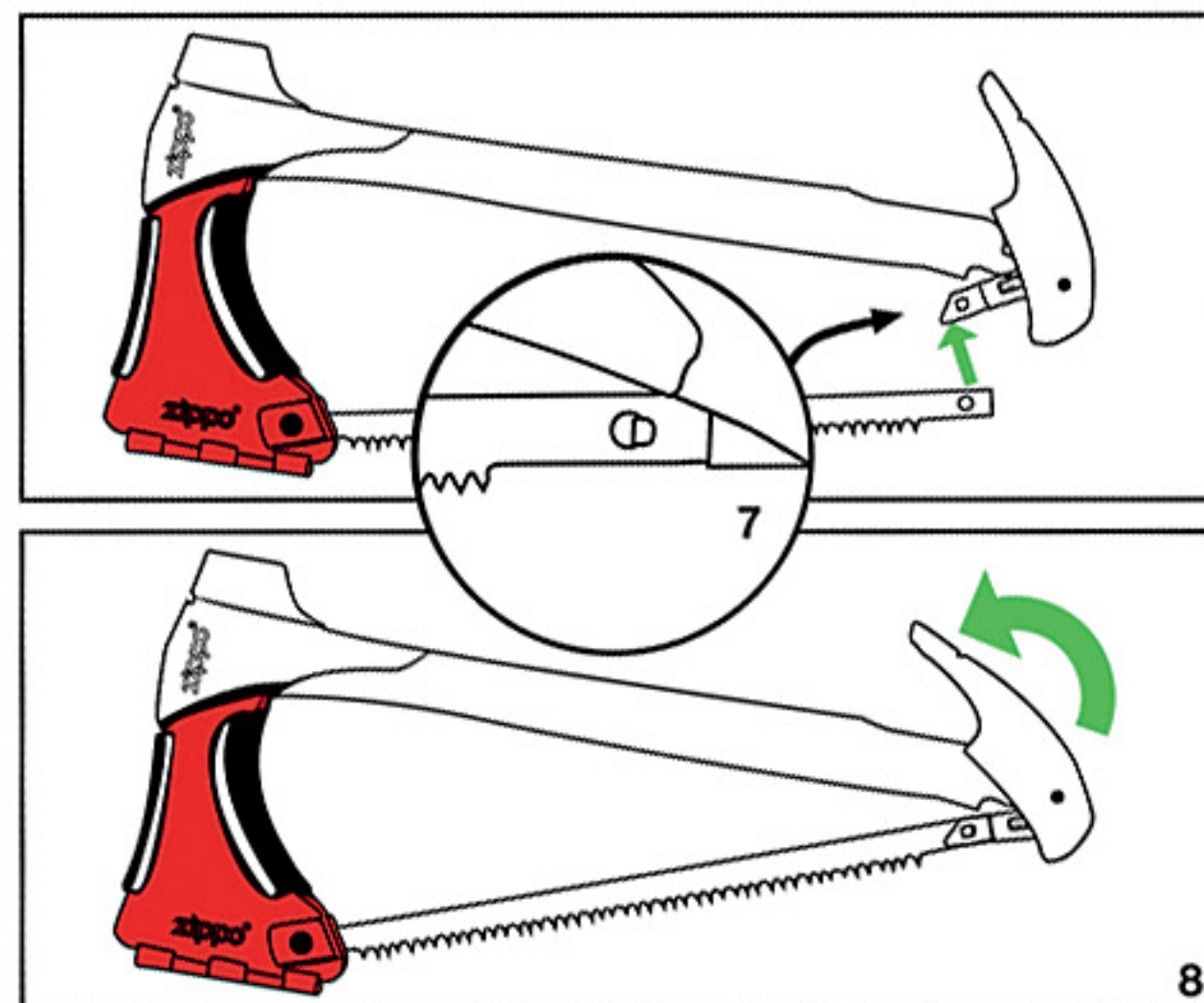

- | | | |
|------------------------|------------------|---------------------|
| A. Mallet | E. Blade Storage | I. Barrel Connector |
| B. Axe | F. Saw Blade | J. Indentation |
| C. Tension Compensator | G. Safety Sheath | |
| D. Cam | H. Thumbscrew | |

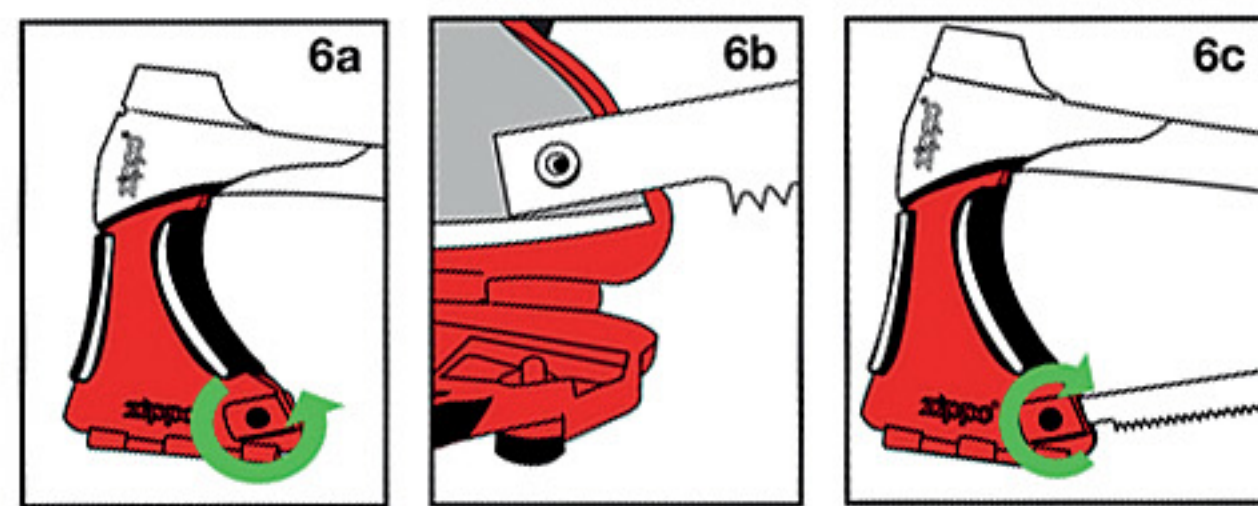
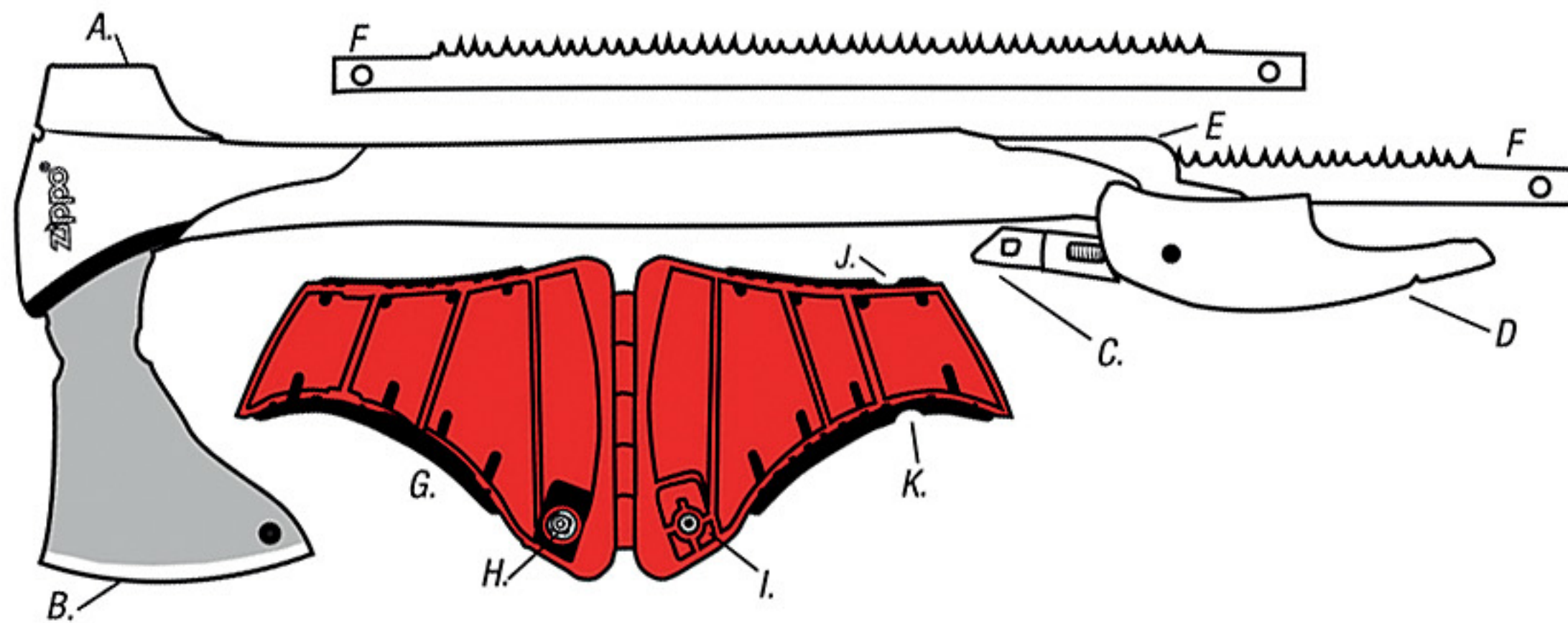

IMPORTANT: When using the AxeSaw as a mallet, or bow saw, or when storing, always have the sheath on and properly secured. Failure to comply could cause serious injury or death.

WARNING: Operator and bystanders should always wear eye protection when AxeSaw is in use. Flying debris can result in eye or other injury. Failure to wear eye protection could result in serious eye injury or blindness to operator or bystanders.

Use for cutting wood only.

WARNING: AxeSaw mallet is intended for driving tent stakes. Do not use to pound nails or other metal objects. Flying debris can result in eye or other injury. Failure to comply could cause serious injury to you or damage to the AxeSaw.

WARNING: AxeSaw bow saw is for cutting small branches around campsite. Do not use to saw trees, bushes, boards or other objects. Failure to comply could cause serious injury to you or damage to the AxeSaw.

Attaching the Safety Sheath:

Place the axe head into the Safety Sheath as shown (1). Close the sheath around the axe head (2). Ensure the sheath is properly closed around the axe head (3). Place the thumb screw in the screw hole in the sheath and tighten the thumb screw (4).

Axe Mode:

To use as an axe, remove the Safety Sheath by loosening the thumb screw. Open at the thumb indentations.

IMPORTANT: the saw blade must be properly stored with the cam lever in the closed position before using the axe.

IMPORTANT: Retain the Safety Sheath as it is needed to operate in saw mode and provide protection from the axe blade.

Saw Mode:

Before using the AxeSaw in saw mode the Safety Sheath must be properly attached to the axe head. Open the cam lever on handle and remove the saw blade from the blade storage (5).

WARNING: Saw blade is extremely sharp. Always wear protective gloves when handling the saw blade or while sawing.

Note: When attaching the saw blade always ensure the saw teeth are facing away from the handle.

Attach a (single) blade to the axe head by loosening the thumb screw on the sheath (6a) and opening the sheath by pulling in opposite directions on the finger indents. The thumbscrew attaches to a barrel connector that protrudes through the axe blade. Align the hole of the blade over the barrel connector (6b), close the safety sheath and tighten the thumbscrew into the barrel connector (6c). Attach the opposite end of the (single) saw blade's hole to the tension compensator clip in the clamping assembly in the handle (7). Tighten the blade by carefully rotating the cam lever to the closed position (8).

WARNING: Always ensure the cam lever is completely closed before using the AxeSaw. Failure to comply may cause serious injury.

WARNING: Always grasp the sheath as the saw handle. Failure to comply may cause serious injury.

WARNING: Always grasp the sheath as the saw handle. Failure to comply may cause serious injury.

Reverse the above process to remove and store blade, using caution.

Mallet Mode:

Before using the AxeSaw as a mallet the sheath must be properly attached to the axe head and the saw blade must be properly stored with the cam lever in the closed position. The mallet is designed to drive tent stakes into the ground.

WARNING: Do not use as hammer for nails or similar tasks. Flying debris can result in eye or other injury. Failure to comply could cause serious injury to you, bystanders or damage to the AxeSaw.

Storage: Do not store in wet or damp area. If storing for an extended period, coat metal components with a moisture sealant to protect against corrosion and rust.

Limited Warranty – 1 year on materials and workmanship of sheath, axe head and handle. Normal wear and tear, misuse or abuse, use contrary to instructions and saw blade are excluded.