

# YAKIMA LANDING PAD #13

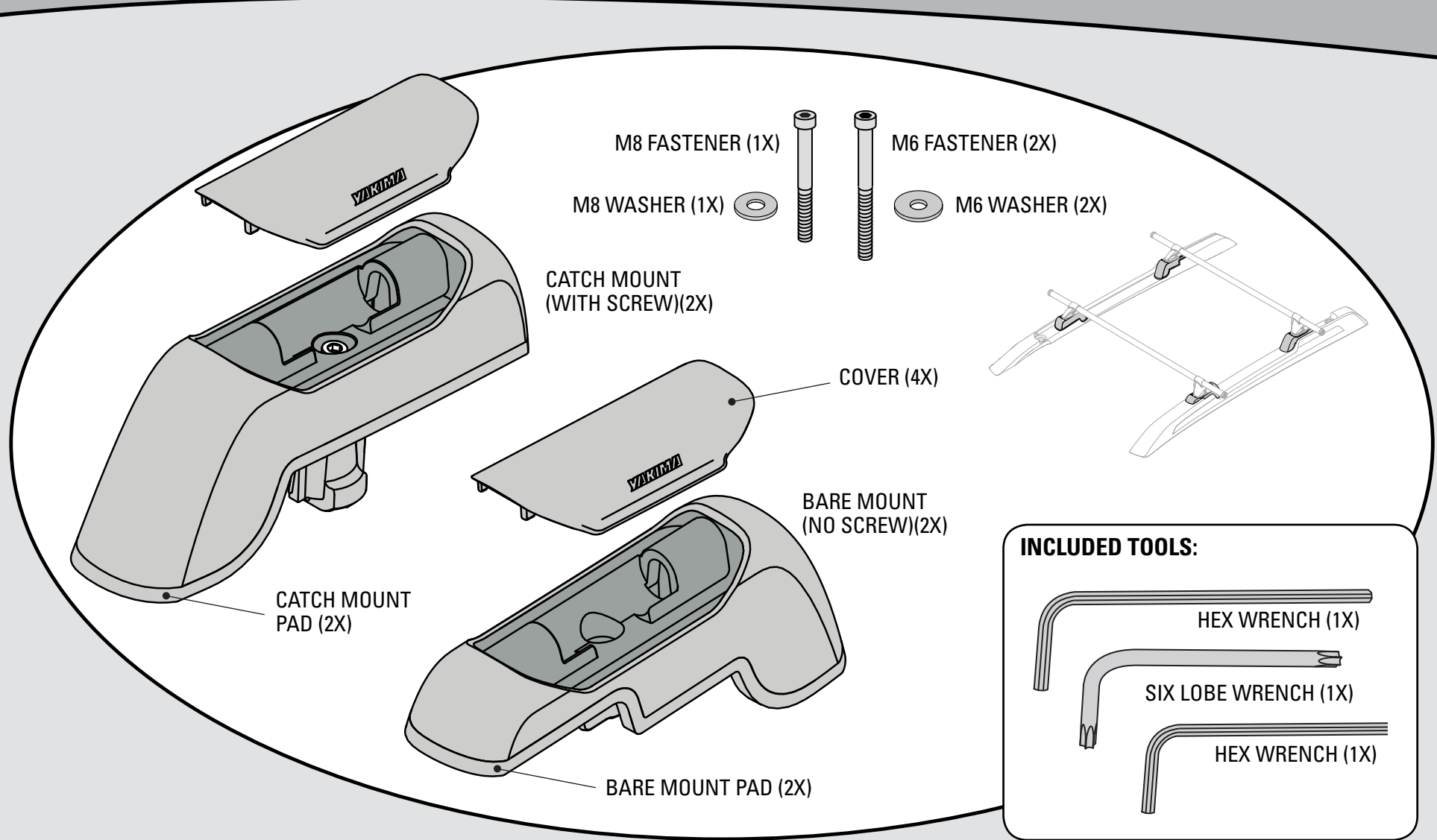

Refer to YAKIMA [Control Tower](#) instructions for important warning and load limitations, and YAKIMA's limited warranty.

**1** Remove factory crossbars.

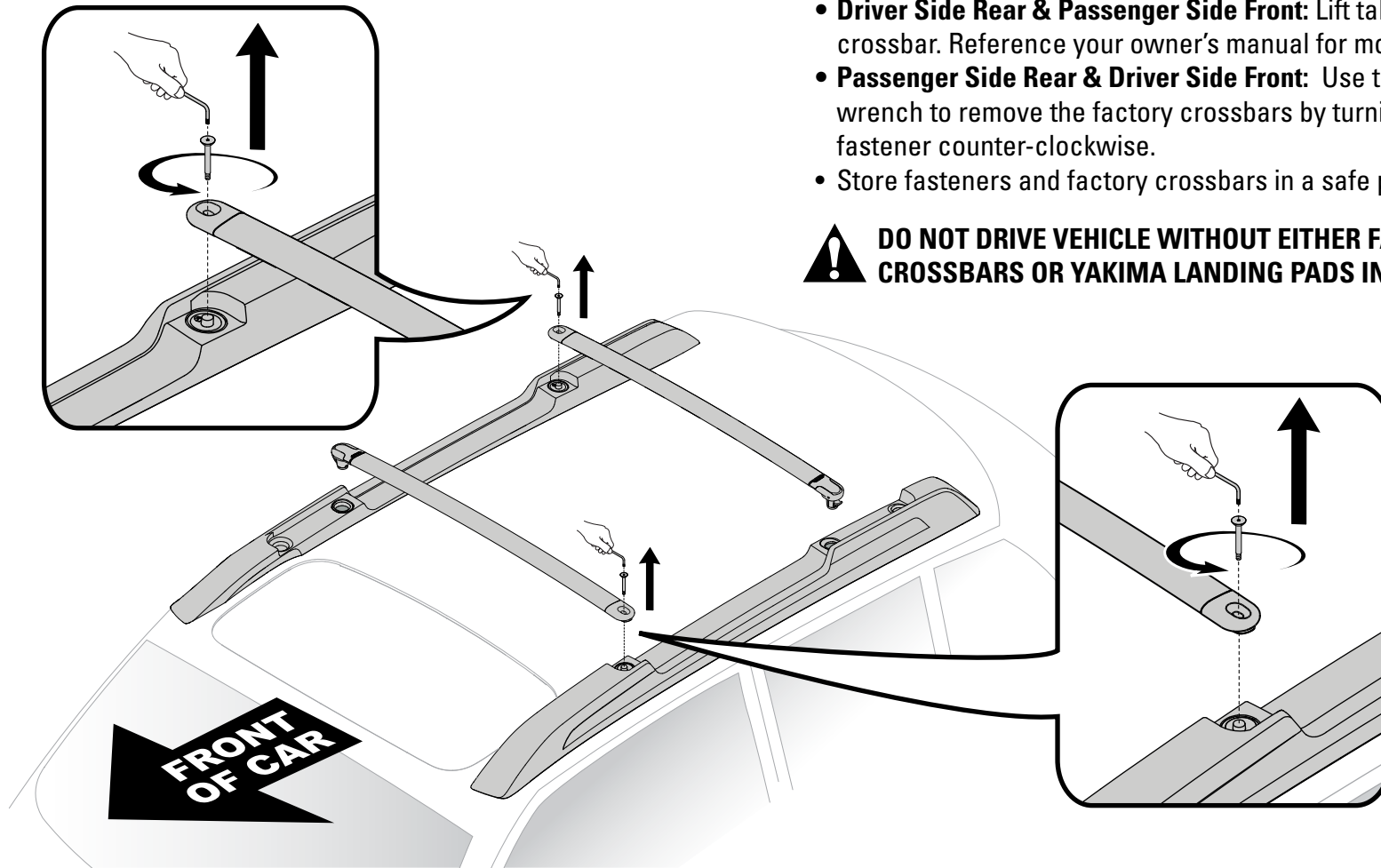

- **Driver Side Rear & Passenger Side Front:** Lift tab to release crossbar. Reference your owner's manual for more information.
- **Passenger Side Rear & Driver Side Front:** Use the six lobe wrench to remove the factory crossbars by turning the fastener counter-clockwise.
- Store fasteners and factory crossbars in a safe place.

**! DO NOT DRIVE VEHICLE WITHOUT EITHER FACTORY CROSSBARS OR YAKIMA LANDING PADS INSTALLED.**

**2** Prepare Catch Mount.

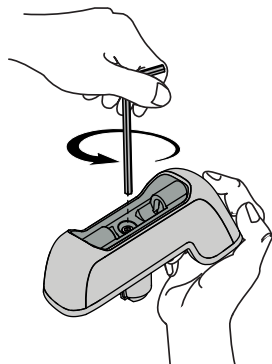

- Using the hex wrench fully open both Catch Mounts by turning the screw counter-clockwise.

**For Outback 2010**

**For Outback 2013+**



## 2010-2012 OUTBACK

### 3 Install Landing Pads.

- A** Using the hex wrench install each **Catch Mount** and pad as pictured (Catch Mounts are located diagonally from one another). Fully tighten.
- B** Using the hex wrench install the M6 fastener, washer, **Bare Mount**, and pad as pictured.

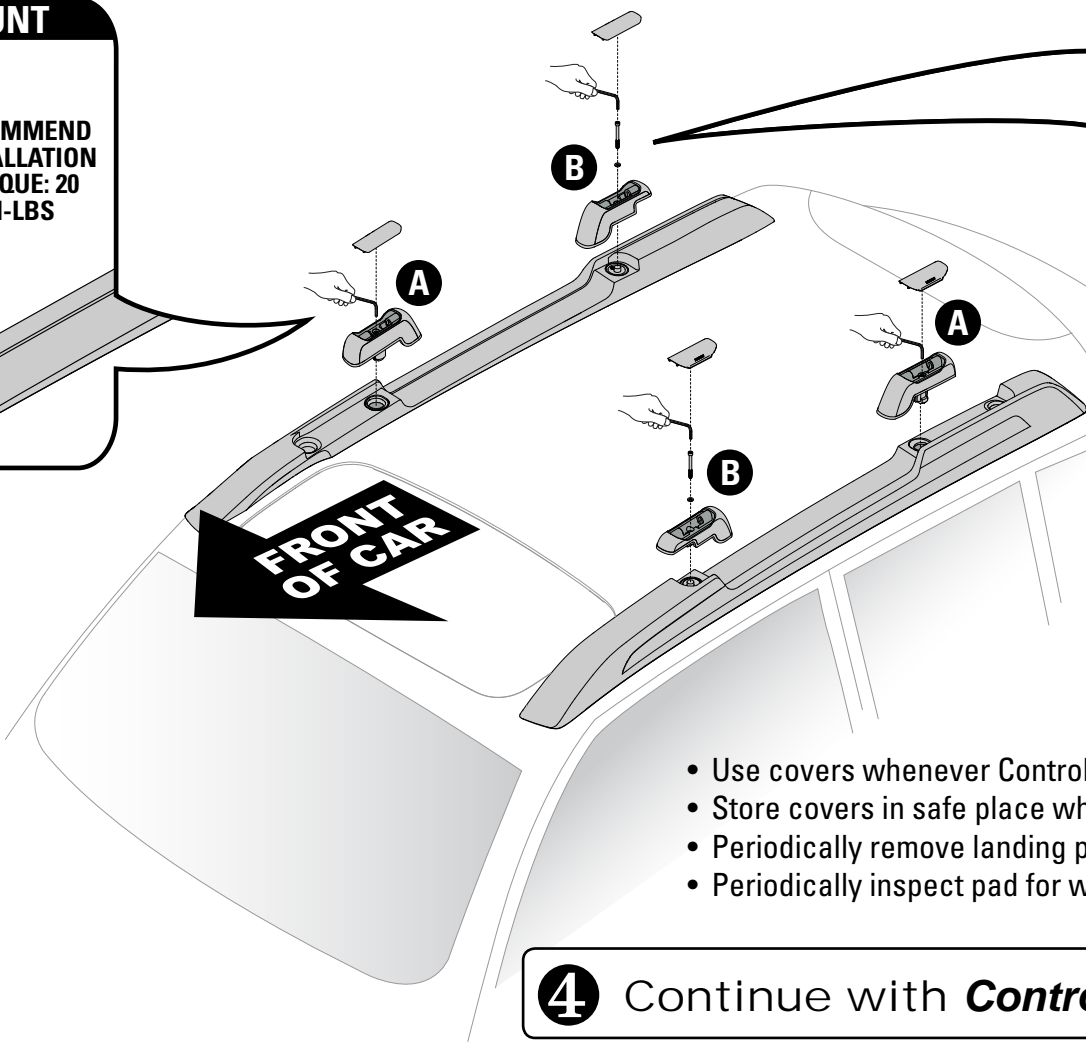
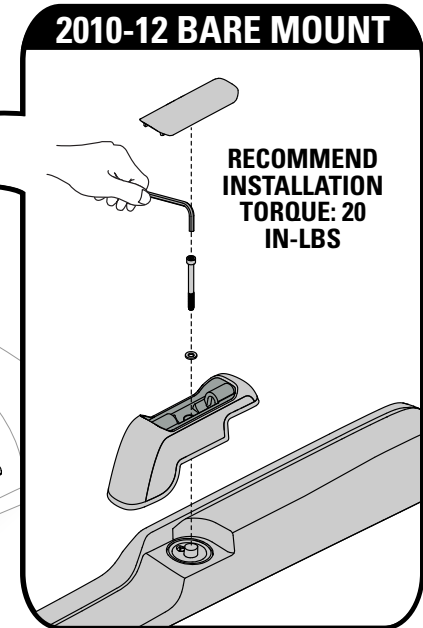
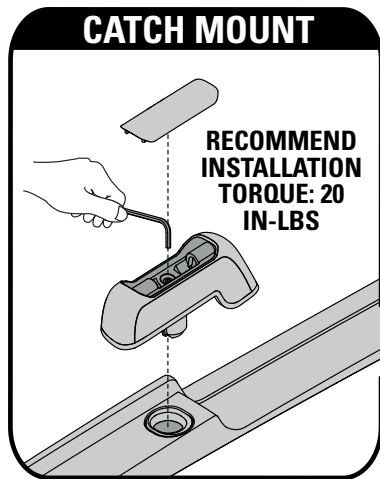

**ATTACHMENT  
HARDWARE CAN  
LOOSEN OVER TIME.  
CHECK AND TIGHTEN  
AS NECESSARY,  
BEFORE EACH USE.**

- Use covers whenever Control Towers are not installed.
- Store covers in safe place whenever Control Towers are installed.
- Periodically remove landing pad and clean under pad.
- Periodically inspect pad for wear or cracking. Replace if damaged.

**4** Continue with **Control Tower** installation.

## 2013 OUTBACK

### 3 Install Landing Pads.

- A** Using the hex wrench install each **Catch Mount** and pad as pictured (Catch Mounts are located diagonally from one another). Fully tighten.
- B** Using the hex wrench install the M6 fastener, washer, **Bare Mount**, and pad as pictured.
- C** Using the hex wrench install m8 fastener, M8 washer, bare mount and pad as shown. To prevent screws from cross-threading start threading fastener using your fingers. Fully tighten.

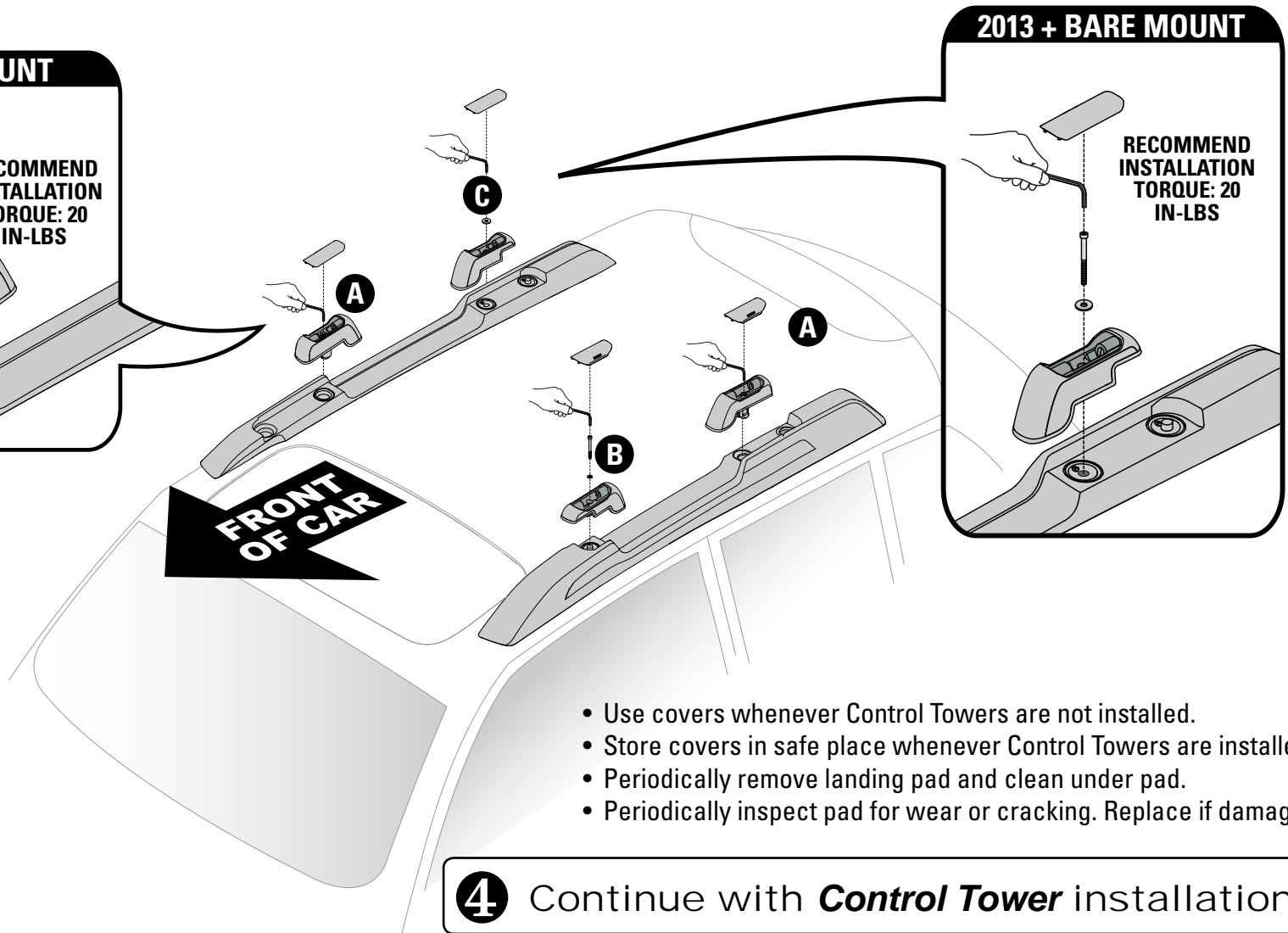
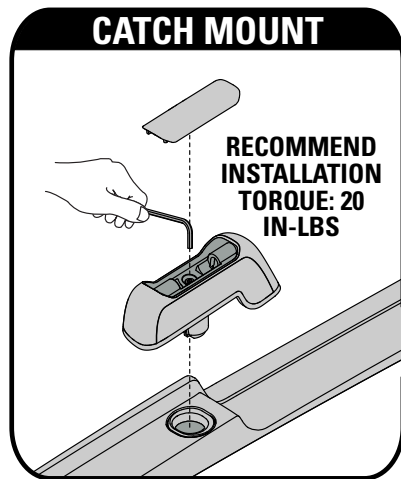

**ATTACHMENT  
HARDWARE CAN  
LOOSEN OVER TIME.  
CHECK AND TIGHTEN  
AS NECESSARY,  
BEFORE EACH USE.**

- Use covers whenever Control Towers are not installed.
- Store covers in safe place whenever Control Towers are installed.
- Periodically remove landing pad and clean under pad.
- Periodically inspect pad for wear or cracking. Replace if damaged.

**4** Continue with **Control Tower** installation.