

YAKIMA LandingPad #11

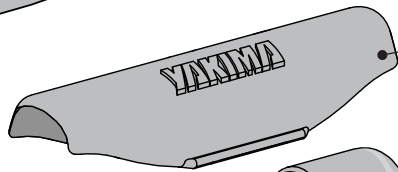

BASE COVER (2X)

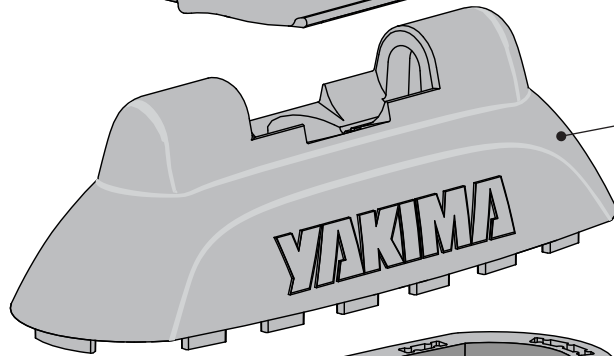

BASE (2X)

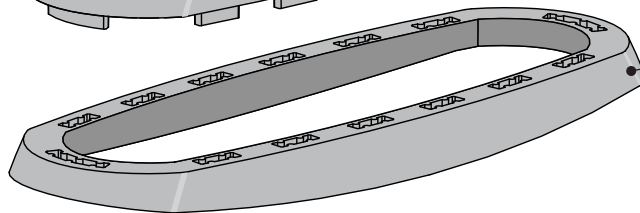

RUBBER PAD (2X)

TOOL:
5 mm hex wrench
(included in Control Tower kit)

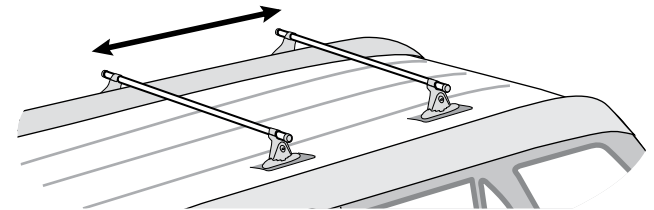

Note: Crossbar spread is fixed.

M6 HARDWARE BAGS

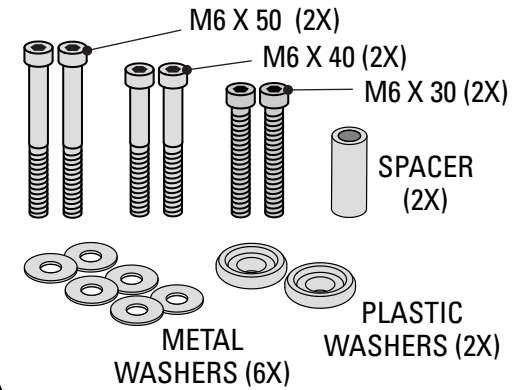

M7 HARDWARE BAG

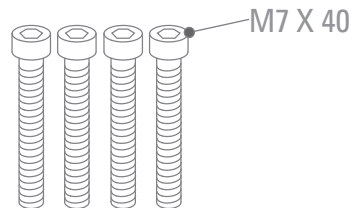

M7X40 hardware (PN 8880281) not included with Landing Pad 11.

Refer to YAKIMA Control Tower instructions for important warning and load limitations, and YAKIMA's limited warranty.

M8 HARDWARE BAG

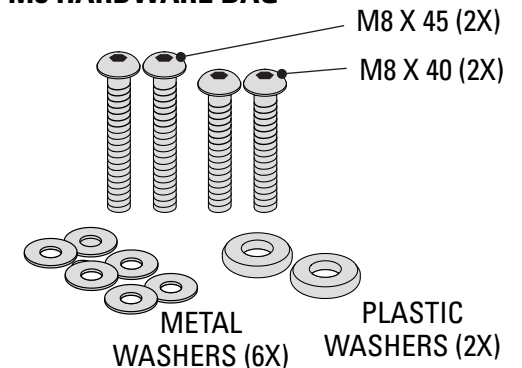

1

If your vehicle has factory crossbars, remove them now, then proceed to step 3.

2

OPEN THE COVER-PLATES.

Consult your vehicle's owner's manual to determine how your cover plates are opened or removed. This will vary from vehicle to vehicle.

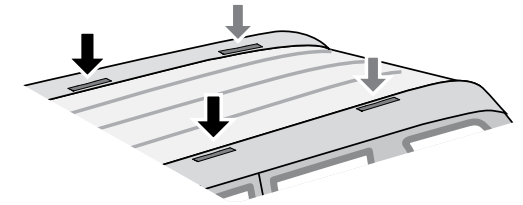
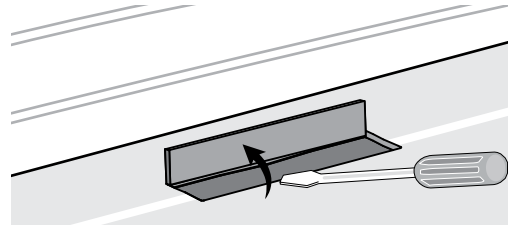

3

DETERMINE YOUR HARDWARE AND PREPARE THREADS



Refer to the fit chart on page 5 to determine the correct hardware for your vehicle.

Be sure the threads are clear of paint by carefully threading your fastener in and out of the hole a few times while blowing away any debris that accumulates.

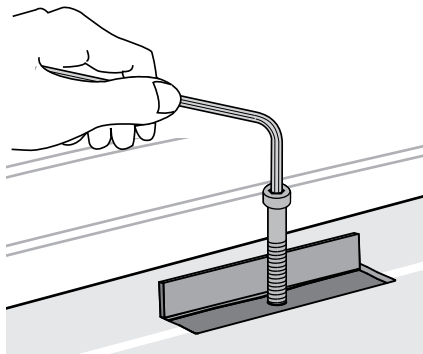

NOTE: If there are multiple holes in each pocket, use the rear-most holes.

NOTE: Some vehicles have a plug in the threads which must be removed.

4

REMOVE THE COVERS

Remove the covers from the bases.

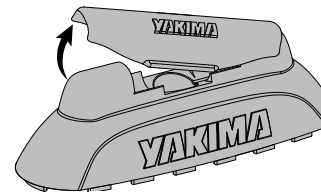

When the racks are not installed, use the covers to keep the bases free of debris.

5

INSTALL PADS TO BASES

Attach each pad to each base.

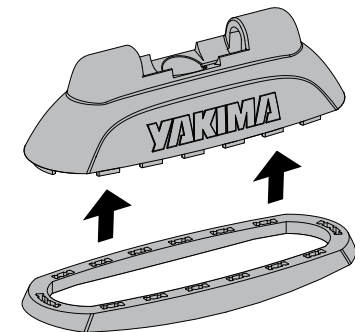

6 ATTACH LANDING PADS

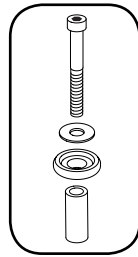

Use M6 spacer if required for your vehicle.

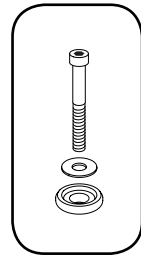

M6 Hardware

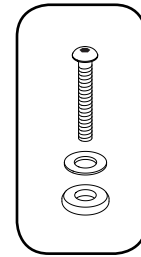

M8 Hardware



BE SURE TO USE THE CORRECT LENGTH OF HARDWARE!

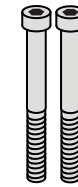

M6 X 50

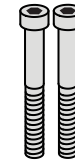

M6 X 40

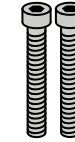

M6 X 30

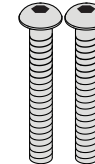

M8 X 45

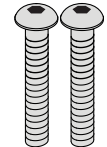

M8 X 40

- Put Landing Pad in place on a clean and dry rooftop.
- Stack metal washer on top of plastic washer with convex side of plastic washer facing down. Add washers as needed to prevent bolt from bottoming out.
- Put fastener through washers, through Landing Pad, and thread into threaded mounting point in rooftop.
- Thread the fastener, and tighten with short handle as shown, but do not fully tighten. USE CAUTION NOT TO CROSS THREAD FASTENER.
- Jostle and rotate landing pad in all directions to ensure plastic washer is fully seated, also allowing Landing Pad a small amount of play to prepare for final alignment and tightening in step 7.
- Repeat for second Landing Pad.



WARNING: DO NOT ALLOW EDGES OF PAD TO CURL UNDER!

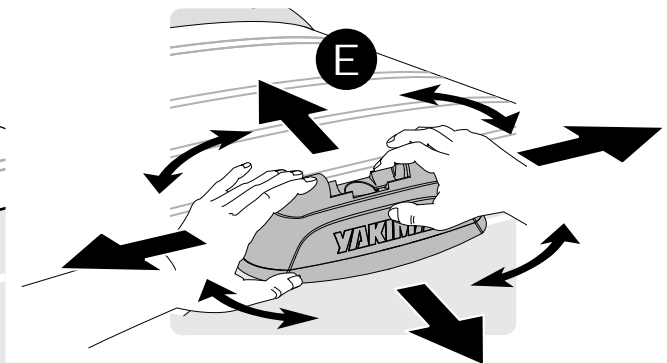
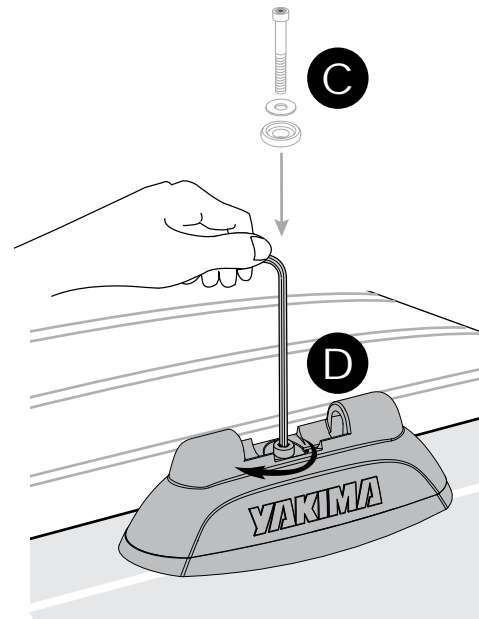
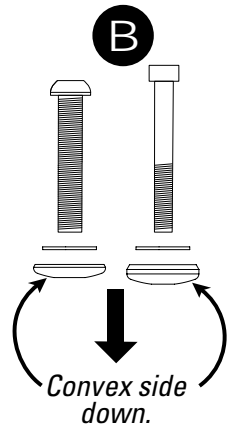
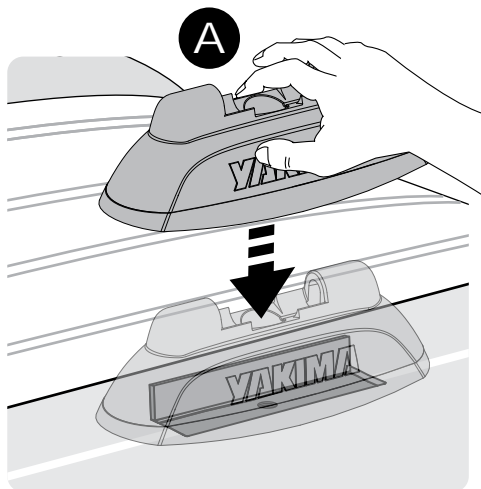
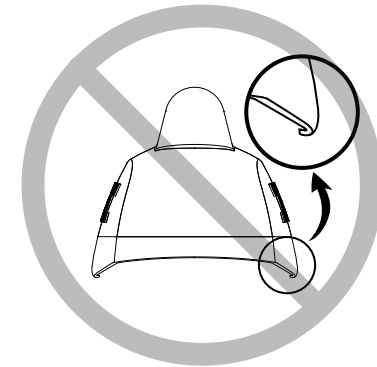

NOTE: Final tightening will happen in the next step.

7 ADJUST LANDING PAD POSITIONS THEN TIGHTEN THEM DOWN.

- Using your control tower instruction as a reference, carefully place a bar and towers assembly onto the landing pads.
- Align position of Landing pads to allow the control towers to fully close.
- Center cross bars and attach Control Towers to cross bars according to Control Tower instructions.

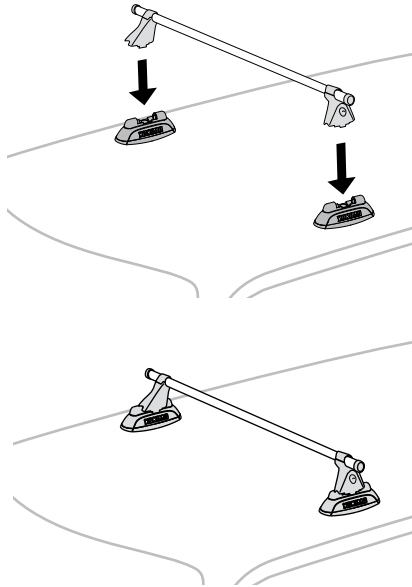

- Open one Control Tower cover and lift it up while opposite tower is still engaged.
- While holding Control Tower above Landing Pad, fully tighten Landing Pad with long handle as shown. If your vehicle requires spacers torque to 27 in-lbs (3 Nm). **DO NOT OVER TIGHTEN AS DAMAGE TO ROOF MOUNTING POINTS MAY OCCUR.**
- Repeat the process again for the other Landing Pads to ensure they have not changed position.
- Re-insert Control Tower into Landing Pad, fully tighten tower and close cover (Control Towers Step 8).

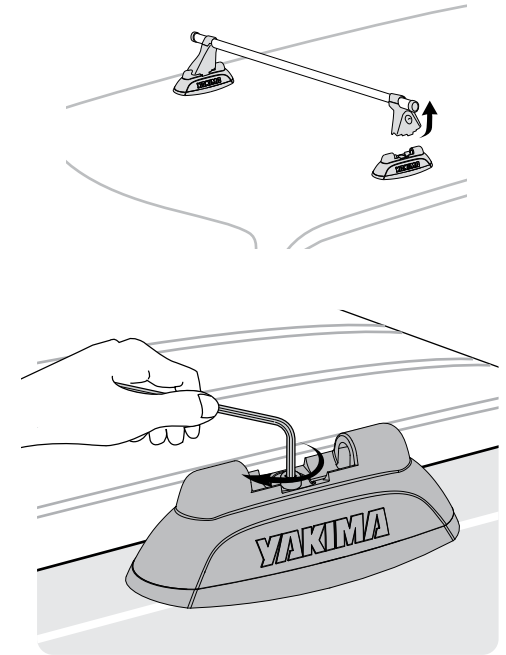

NOTE: Due to manufacturing variations the fastening hardware may bottom out in the hardpoint before the landing pad is fully tight. If you encounter this situation, go back to step 6 and re-install with additional metal washer(s) (up to 3) to take up the slack.

8 READ THESE WARNINGS!



Make sure Control Towers, with bars installed, seat completely with Landing Pad. If they do not seat properly, repeat step 7.



Be sure all hardware is secured according to instructions. Failure to perform safety checks before driving away can result in property damage, personal injury, or death.

Attachment hardware can loosen over time. Check and tighten if necessary, before each use.

To avoid damage your vehicle's finish remove and clean Landing pads and mounting points periodically as road sediment will accumulate over time.



DO NOT EXCEED MAXIMUM WEIGHT LIMIT FOR YOUR VEHICLE .

Remove your YAKIMA rack and accessories before entering automatic car washes.

9 Continue with **Control Tower** installation.



LANDING PAD #11 FIT CHART

	HARDWARE/LENGTH		QTY. FRONT WASHERS	QTY. REAR WASHERS	M6 SPACER REQUIRED	MAX WEIGHT	
BMW							
1 Series 2dr	08-13	M6x40	1	1		165 lbs./75 kg	1,47,54,72,81,103,109,187,191,197
2 Series 2dr	14-15	M6x40	1	1	Yes	165 lbs./75 kg	1,45,47,72,81,103,109,143,187,191
3 Series 2dr	00-06	M6x40	1	1		165 lbs./75 kg	1,47,54,72,81,103,109,162,187,191,197
3 Series 4dr	99-05	M6x40	1	1		165 lbs./75 kg	1,47,54,72,81,103,109,162,187,191,197
3 Series 4dr	06-11	M6x40	1	1	Yes	165 lbs./75 kg	1,45,47,54,72,81,103,109,187,191,197
3 Series 4dr	12-15	M6x40	1	1	Yes	165 lbs./75 kg	1,45,47,54,72,81,103,109,187,191,197
3 Series Wagon	11-12	M6x40	1	1	Yes	165 lbs./75 kg	1,45,47,54,69,72,81,103,109,132,187,191,197
3 Series Gran Turismo 5dr	14-15	M6x40	1	1	Yes	165 lbs./75 kg	1,45,47,72,81,103,109,143,187,191
4 Series 2dr	14-15	M6x40	1	1	Yes	165 lbs./75 kg	1,45,47,72,81,103,109,143,187,191
4 Series Gran Coupe 4dr	15-15	M6x40	1	1	Yes	165 lbs./75 kg	1,45,47,72,81,103,109,143,187,191
5 Series 4dr	97-03	M6x40	1	1		165 lbs./75 kg	1,47,54,72,81,103,109,162,187,191,197
5 Series 4dr	11-15	M7x40	1	1		165 lbs./75 kg	39,54,72,81,109,164,187,191,197
5 Series Gran Turismo 5dr	10-15	M6x40	1	1		165 lbs./75 kg	1,47,61,69,72,81,103,109,132,162,187,191,197
FORD							
Flex 5dr	09-15	M6x50	1	1		165 lbs./75 kg	48,51,52,54,69,72,81,109,132,191,197
Transit Connect 5dr	10-13	M8x40	1	1		165 lbs./75 kg	49,72,81,84,85,109,161,191,194,197
HYUNDAI							
Accent 5dr	12-15	M6 x40	1	1		165 lbs./75 kg	47,69,72,81,109,132,161,164,191,197
Elantra GT 5dr	13-15	M6 x40	1	1		165 lbs./75 kg	47,54,69,72,81,109,113,132,164,187,191,197
i-25 5dr	12-13	M6 x40	1	1		165 lbs./75 kg	46,72,109,191
KIA							
Soul 5dr	14-15	M6 x50	1	1		165 lbs./75 kg	1,47,69,72,81,103,109,113,132,187,191,197
LAND ROVER							
LR4 5dr	10-15	M6 x40	1	1		165 lbs./75 kg	47,51,69,81,82,104,132,191
Range Rover 5dr	03-12	M8 x45	1	1		165 lbs./75 kg	50,51,72,81,109,140,191,197
MAZDA							
2 5dr	11-15	M6x40	3	3		165 lbs./75 kg	1,47,72,81,103,109,132,162,187,191,197
3 4dr	04-09	M6x40	1	2		165 lbs./75 kg	1,47,52,54,72,81,103,109,162,187,191,197
3 4dr	10-13	M6x40	1	1		165 lbs./75 kg	1,47,52,54,72,81,103,109,162,187,191,197
3 4dr	14-15	M6x40	1	1		165 lbs./75 kg	1,47,52,54,72,81,103,109,162,187,191,197



LANDING PAD #11 FIT CHART

		HARDWARE/LENGTH	QTY. FRONT WASHERS	QTY. REAR WASHERS	M6 SPACER REQUIRED	MAX WEIGHT	
3 5dr	04-09	M6x40	1	1		165 lbs./75 kg	1,47,52,54,69,72,81,103,109,132,162,187,191,197
3 5dr	10-13	M6x40	1	1		165 lbs./75 kg	1,47,52,54,69,72,81,103,109,132,162,187,191,197
3 5dr	14-15	M6x40	1	1		165 lbs./75 kg	1,47,52,54,69,72,81,103,109,132,162,187,191,197
5 5dr	06-10	M6x30	1	1		165 lbs./75 kg	46,69,72,81,109,132,144,161,164,191,197
5 5dr	12-15	M6x30	1	1		165 lbs./75 kg	46,69,72,81,109,132,144,161,164,191,197
6 4dr	14-15	M6x40	1	1		165 lbs./75 kg	1,47,52,72,81,103,109,162,187,191,197
CX-5 5dr	13-15	M6x30	1	1		165 lbs./75 kg	47,54,69,72,81,84,85,109,140,161,191,197
CX-7 5dr	07-12	M6x40	1	1		100 lbs./45 kg	1,31,47,54,61,69,81,103,109,113,140,162,187,191,197
CX-9 5dr	07-15	M6x40	2	2		165 lbs./75 kg	47,51,54,69,72,81,84,85,109,140,161,191,197
Protegé 5 5dr	02-03	M6x40	1	1		165 lbs./75 kg	1,47,69,72,81,103,109,132,144,162,187,191,197
Speed3 5dr	04-09	M6x40	1	1		165 lbs./75 kg	1,47,52,54,69,72,81,103,109,132,162,187,191,197
Speed3 5dr	10-13	M6x40	1	1		165 lbs./75 kg	1,47,52,54,69,72,81,103,109,132,162,187,191,197
MERCEDES							
B-Class 5dr	05-11	M6x40	1	1		165 lbs./75 kg	47,69,72,81,109,132,144,164,191,197
C-Class 2dr	12-15	M8x40	1	1		165 lbs./75 kg	49,54,72,81,109,164,187,191,197
C-Class 4dr	08-14	M8x40	1	1		165 lbs./75 kg	49,54,72,81,109,164,187,191,197
C-Class 4dr	15-15	M8x40	1	1		165 lbs./75 kg	49,72,81,109,113,143,164,187,191
CLS-Class 4dr	06-11	M8x40	2	1		165 lbs./75 kg	1,49,54,72,81,103,109,162,187,191,197
E-Class 2dr	10-15	M8x40	1	1		165 lbs./75 kg	49,72,81,109,164,187,191,197
E-Class 4dr	03-09	M8x40	1	1		165 lbs./75 kg	47,54,72,81,109,164,187,191,197
E-Class 4dr	10-15	M8x40	1	1		165 lbs./75 kg	49,72,81,109,164,187,191,197
R-Class 5dr	06-12	M8x40	1	1		165 lbs./75 kg	49,54,72,81,109,140,164,187,191,197
S-Class/S-Class Hybrid 4dr	07-13	M6x40	1	1		165 lbs./75 kg	49,54,72,81,109,164,187,191,197
MITSUBISHI							
Lancer Sportback 5dr	10-14	M6x40	1	1		165 lbs./75 kg	1,47,69,72,81,103,109,132,144,162,187,191,197
Outlander 5dr	10-15	M6x40	1	1		165 lbs./75 kg	1,47,54,69,72,81,103,109,132,162,187,191,197
Outlander Sport 5dr	11-15	M6x40	1	1		165 lbs./75 kg	1,47,54,69,72,81,103,109,132,162,187,191,197
RVR 2+ dr	10-13	M6x40	1	1		165 lbs./75 kg	1,47,54,69,72,81,103,109,132,162,187,191,197
NISSAN							
NV200 5dr	13-15	M8x40	1	1		165 lbs./75 kg	49,72,81



LANDING PAD #11 FIT CHART

		HARDWARE/LENGTH	QTY. FRONT WASHERS	QTY. REAR WASHERS	M6 SPACER REQUIRED	MAX WEIGHT	
PORSCHE							
911 2dr	05-12	M6x50	1	1		165 lbs./75 kg	48,54,72,81,187
Cayman 5dr	07-12	M6x50	1	1		125 lbs./57 kg	48,54,67,81,187
Panamera 5dr	10-15	M6x50	1	1		165 lbs./75 kg	48,54,69,72,81,109,132,164,187,191,194,197
SAAB							
9-3 Wagon	06-12	M6x50	1	1		165 lbs./75 kg	1,48,54,69,72,81,103,109,140,162,187,191,197
SATURN							
Astra 3dr	08-09	M6x40	1	1		165 lbs./75 kg	1,47,54,69,72,81,103,109,140,162,187,191,197
Astra 5dr	08-09	M6x40	1	1		165 lbs./75 kg	1,47,54,69,72,81,103,109,140,162,187,191,197
SUBARU							
Forester 5dr	09-13	M6x40	1	1		165 lbs./75 kg	1,47,54,69,72,81,103,109,132,162,187,191,197
Forester 5dr	14-15	M6x40	1	1		165 lbs./75 kg	47,54,69,72,81,109,132,161,164,191,197
Impreza 4dr	08-11	M6x40	1	1		165 lbs./75 kg	47,54,72,81,109,164,187,191,197
Impreza 5dr	08-11	M6x40	1	1		165 lbs./75 kg	47,54,69,72,81,109,140,164,187,191,197
Impreza 5dr	12-15	M6x40	1	1		165 lbs./75 kg	47,54,69,72,81,109,140,164,187,191,197
Impreza WRX/STI 4dr	08-14	M6x40	1	1		165 lbs./75 kg	47,54,72,81,109,164,187,191,197
Impreza WRX/STI/Outback Sport 5dr	08-14	M6x40	1	1		165 lbs./75 kg	47,54,69,72,81,109,140,164,187,191,197
Outback Sport 5dr	08-11	M6x40	1	1		165 lbs./75 kg	47,54,69,72,81,109,140,164,187,191,197
Tribeca 5dr	06-07	M6x40	1	1		165 lbs./75 kg	47,54,69,72,81,84,85,109,140,161,191,197
Tribeca 5dr	08-14	M6x40	1	1		165 lbs./75 kg	47,54,69,72,81,84,85,109,140,161,191,197
SUZUKI							
Kizashi 4dr	10-13	M6x40	1	1		165 lbs./75 kg	47,72,81,109,161,164,191,197
TESLA							
Model S w/ Panoramic Roof 4dr	12-15	M8x40	1	1		165 lbs./75 kg	49,72,81,109,112,132,161,191,197