

For use with Yakima SkyLine or Timberline towers.

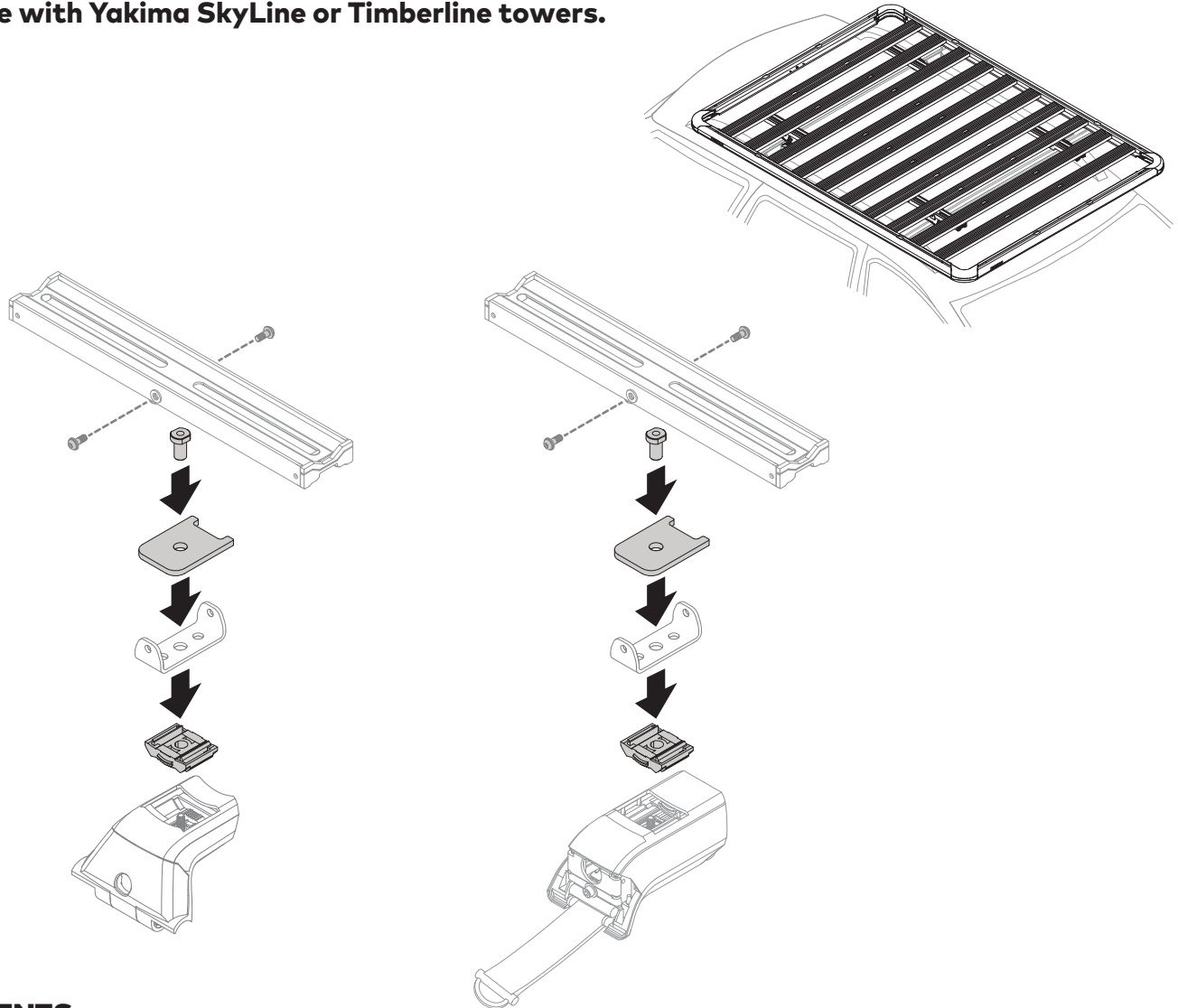

## CONTENTS

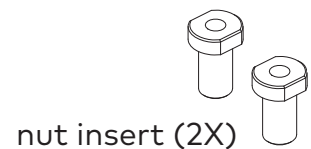
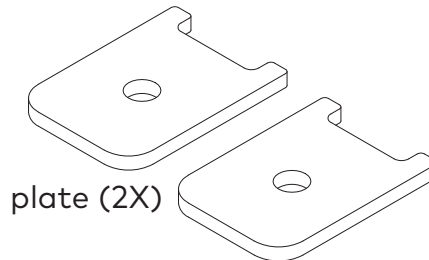
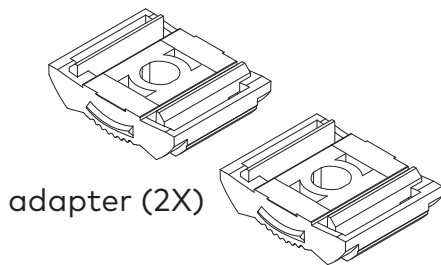

### TOOLS REQUIRED

4mm hex or torque wrench  
10mm box or spanner wrench

**Note:** Each 2 pack of adapters is for 2 towers. Purchase additional sets depending on the number of towers.

### LOAD CAPACITY

Go to [yakimatech](http://yakimatech) for your specific vehicle load capacity

- 2 Crossbars (4 Clamps) - up to 220lbs (100 kg)
- 3 Crossbars (6 Clamps) - up to 330lbs (150 kg)
- 4 Crossbars (8 Clamps) - up to 440lbs (200 kg)

# TIMBERLINE INSTALLATION



Vehicles with curved raised rails may require more pitch adjustment. Assess your vehicle beforehand and do not use the plates in TimberLine step 5 if necessary.

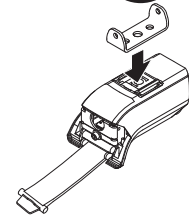
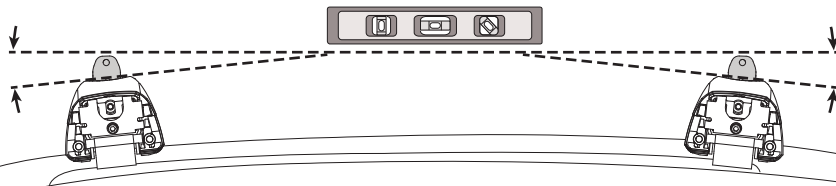

## 1 REMOVE COVERS.

Squeeze and pull to remove the covers.

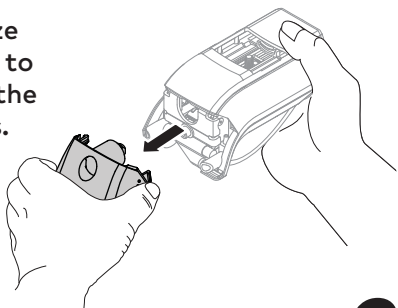

2X

## 2 LOOSEN THE ADJUSTMENT SCREW.

Use the 4mm torque wrench supplied with your TimberLine towers to loosen the upper adjustment screw 8 turns.

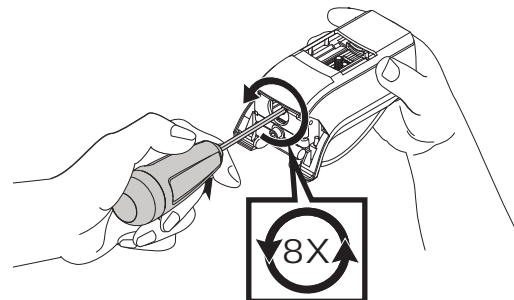

2X

## 3 BACK OUT BOLTS AND RELEASE STRAPS.

Using the torque wrench or a cordless drill, loosen the lower adjustment screw on each tower about 50 turns until the straps can be lifted out of the cradle. Press against the backside of the strap and lift out of the cradle as shown.

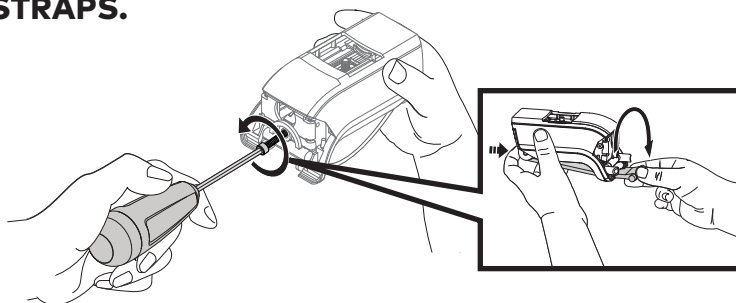

2X

## 4 INSTALL THE ADAPTERS.

Snap the adapters into place.

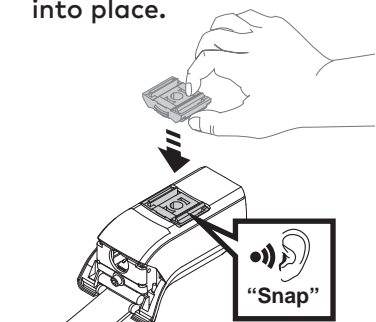

2X

## 5 INSTALL THE BRACKET AND PLATES.

Install the bracket from your LockNLoad Platform, the plate, and nut insert as shown. Tighten the bottom screw and the upper front adjustment screw to 3.5 Nm using the torque wrench.

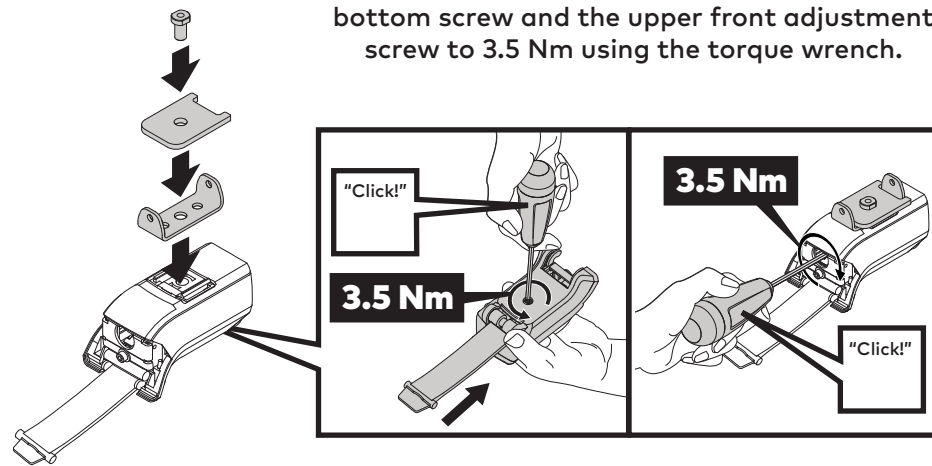

2X

## 6 INSTALL THE MOUNTING BLOCKS.

Align the mounting block from the LockNLoad platform with the bracket. Then thread two M6 x 16mm capscrews from the platform hardware and tighten to 3.5 Nm using the torque wrench.

**NOTE:** The mounting block assembly will still have movement after tightening the screws.

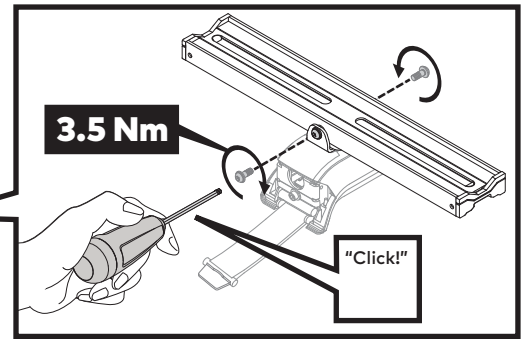
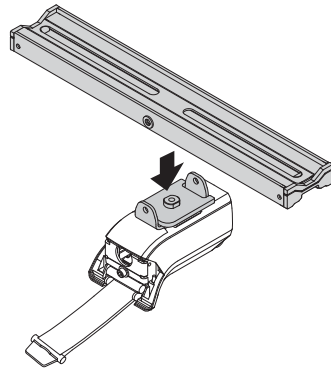

2X

## 7 ATTACH TOWER AND MOUNTING BLOCK ASSEMBLIES TO THE VEHICLE RAISED SIDERAILS.

Place the Timberline tower and mounting block assemblies on top of the rail, ensuring that the hole on the underside of the assembly is positioned directly on top of the rail. Check that the strap can pass underneath the rail and re-engage with the cradle. If not, back off bolt shown in Step 3 further.

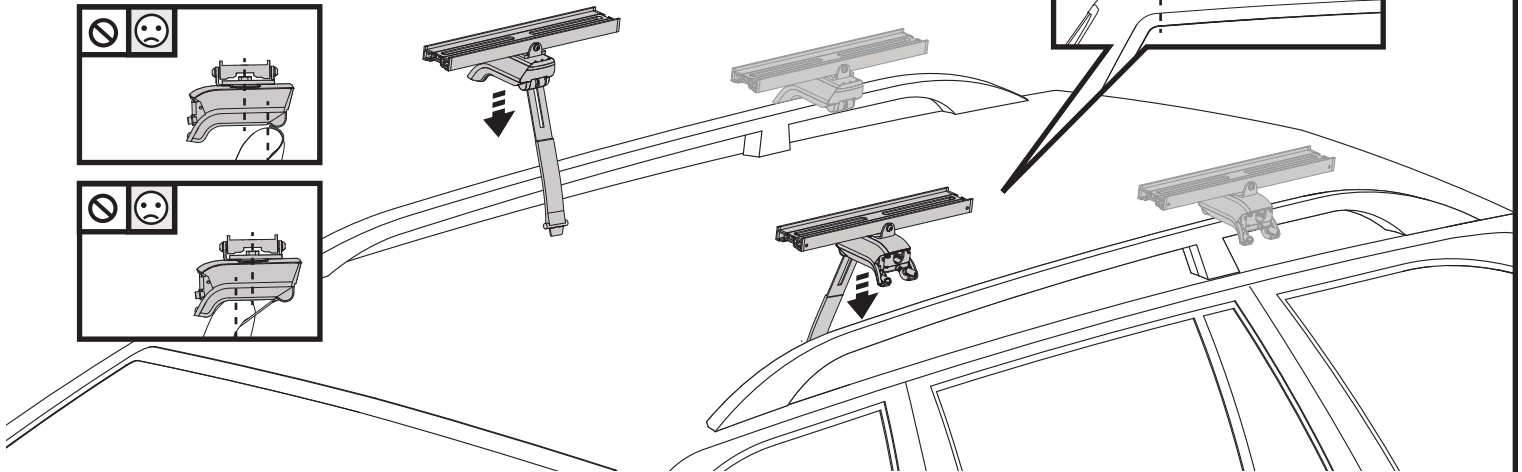
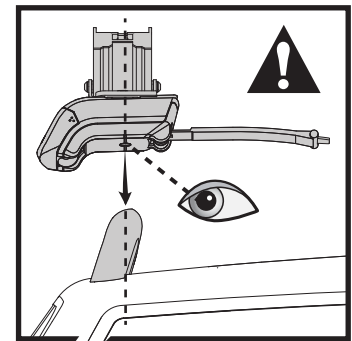
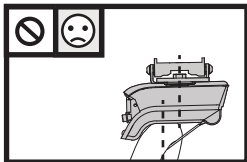
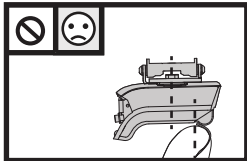
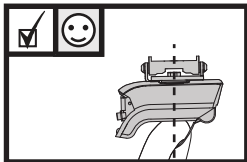

**Note:** Second pair of mounting block assemblies are for reference only. Additional adapters sold separately.

Route the straps around your siderails and e-engage the straps then tighten the bolts until the assemblies are stable on the rails but **DO NOT TIGHTEN** them completely.

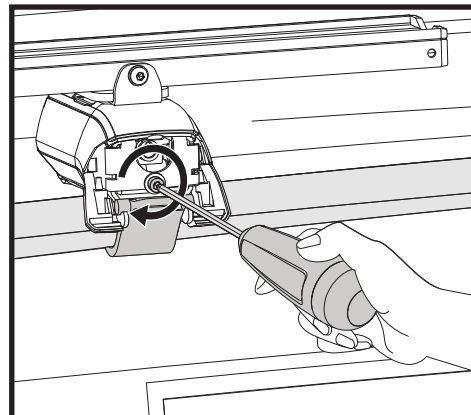
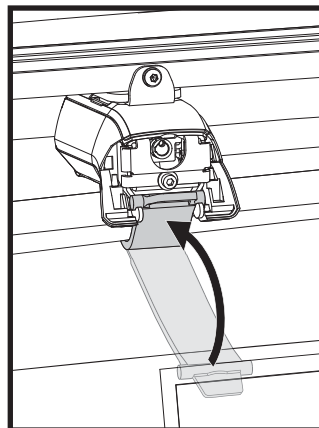

2X



Continue with your LockNLoad Platform instructions to complete your Platform installation.

# SKYLINE INSTALLATION

## 1 OPEN COVERS.

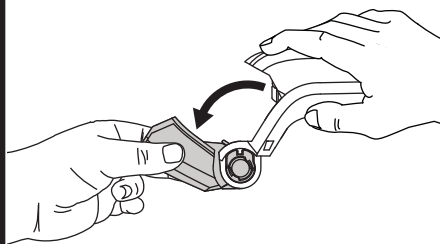

Squeeze and pull to open the covers.

**2X**

## 2 BACK OUT ADJUSTMENT SCREW.

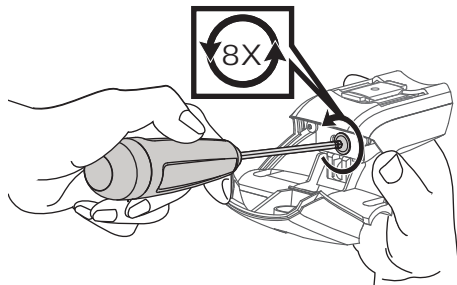

Use the 4mm torque wrench supplied with your SkyLine towers to loosen the adjustment screw about 8 turns.

**2X**

## 3 INSTALL THE ADAPTERS.

Snap the adapters into place.

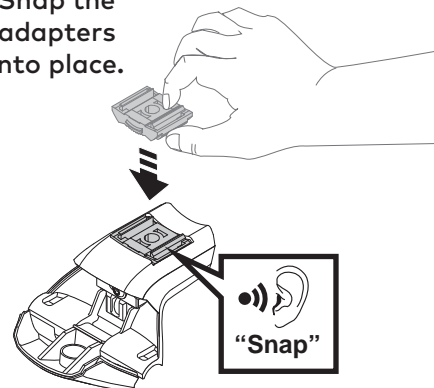

**2X**

## 4 INSTALL THE BRACKET AND PLATES.

### IF NECESSARY ADJUST THE PITCH OF YOUR SKYLINE TOWER.



Vehicles with curved rooflines or siderails may require more pitch adjustment. Assess your vehicle beforehand and set the tower's pitch to match your vehicle's roofline. Adjust the bracket so it will be level once installed on your vehicle.

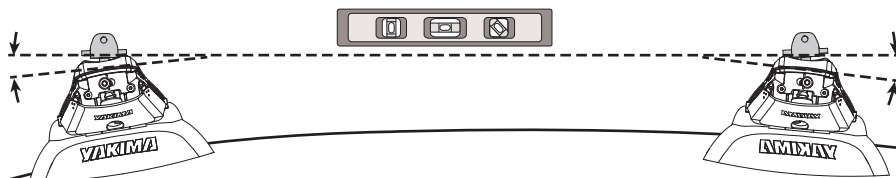

**A.** Install the bracket from your LockNLoad Platform, the plate, and nut insert as shown. Set the tower pitch. Tighten to 3.5 Nm using the torque wrench.

**B.** Then tighten the adjustment screws to 3.5 Nm using the torque wrench.

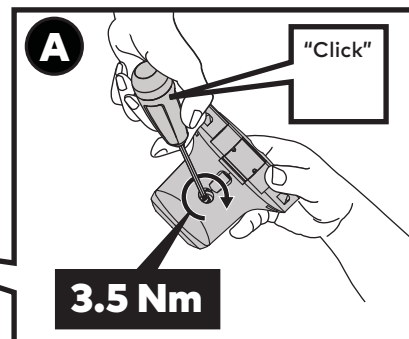
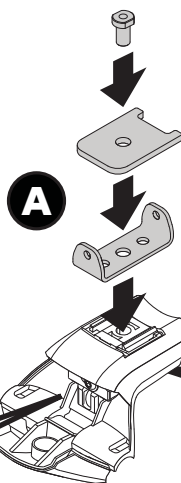
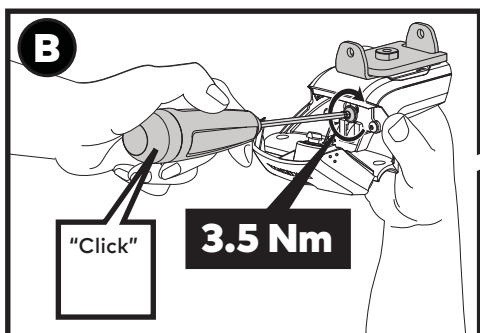

**2X**

## 5 INSTALL THE MOUNTING BLOCKS.

Align the mounting block from the LockNLoad platform with the bracket. Then thread two M6 x 16mm capscrews from the platform hardware and tighten to 3.5 Nm using the torque wrench. **NOTE:** The mounting block assembly will still have movement after tightening the screws.

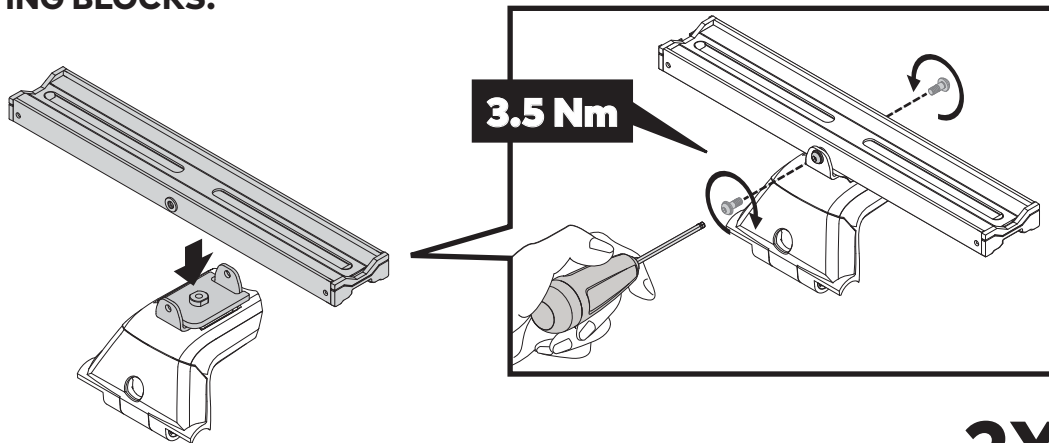

2X

## 6 OPEN THE COVERS.

Open the SkyLine covers.

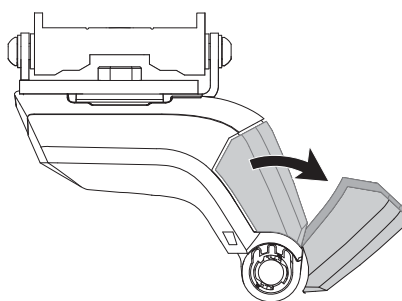

2X

## 7 ATTACH TOWER AND MOUNTING BLOCK ASSEMBLIES TO LANDING PADS.

First lay a towel over the roof to protect it. Place the SkyLine tower and mounting block assemblies onto your Landing Pads as shown. Be sure the SkyLine towers are fully seated and then close the SkyLine covers. **Note:** The second pair of mounting block assemblies are for reference only. Additional adapters sold separately.

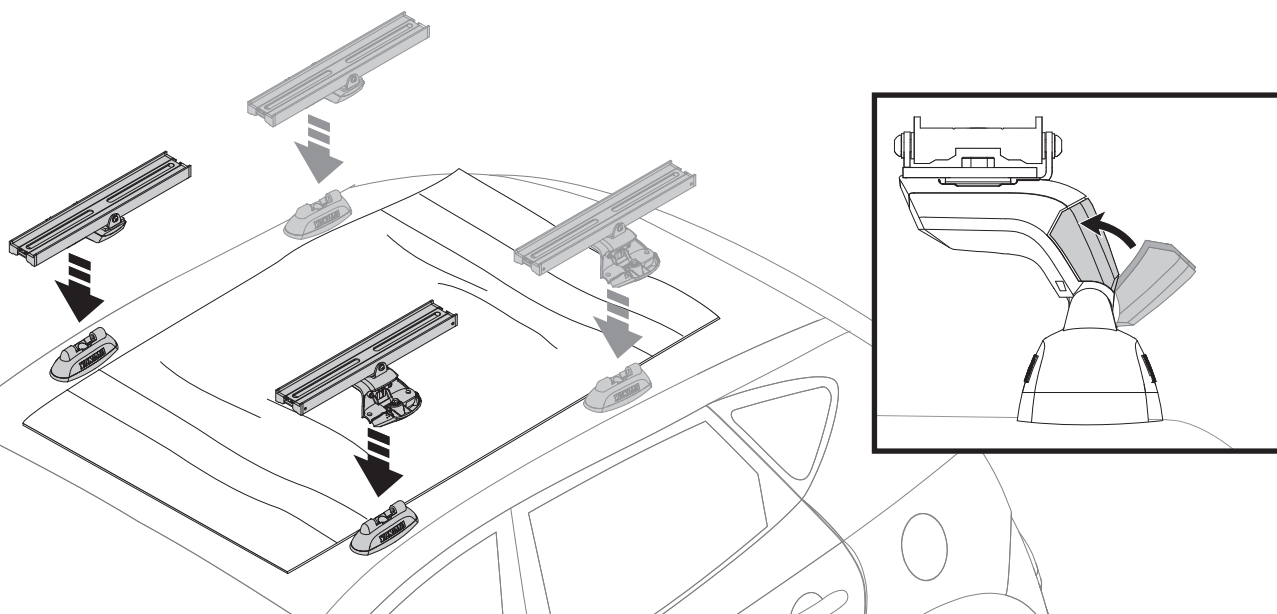

Continue with your LockNLoad Platform instructions to complete your Platform installation.

# IMPORTANT WARNINGS

## Rack Installation

Inadequately secured loads and incorrectly mounted roof racks and accessory racks can come loose during travel and cause serious accidents! Therefore, installation, handling and use must be carried out in accordance with product and vehicle instructions.

In addition to these instructions, review the mounting instructions for the roof rack and the operating instructions of the vehicle.

These instructions should be kept together with the vehicle's operating instructions and carried in the vehicle when in use and en route.

For your own safety, you should only use roof racks that are authorized for use with your vehicle.

For roof racks that do not specify the distance between the front and rear crossbars, the distance shall be at least 700 mm or as large as possible. Please note that changes (e.g. additional drill holes) to the accessory rack's attachment system are not permissible.

Check attachment hardware and load for tight fit and function:

- Before the start of any journey.
- After driving a short distance following rack or load install.
- At regular intervals on longer journeys.
- More frequently on rough terrain.
- After interruption of a journey during which the vehicle was left unsupervised (check for damage due to outside intervention).

## Rack Loading

Do not exceed the maximum load specified for the roof rack, accessory rack or the maximum load recommended by the vehicle manufacturer.

Max Roof Load = weight of roof rack + weight of accessory racks + weight of load.

Load shall be uniformly distributed with the lowest possible center of gravity.

Load should not substantially extend beyond the loading surface of the roof rack.

## Vehicle Driving and Regulations

The speed driven must be suited to the load transported and to official speed limits. In the absence of any speed limits, we recommend a maximum speed of 80 mph (130 km/h).

When transporting any load, the speed of the vehicle must take into account all conditions such as the state of the road, the surface of the road, traffic conditions, wind, etc. Vehicle handling, cornering, braking and sensitivity to side winds will change with the addition of roof top loads.

If this product is off-road certified, it is designed and intended to be used on forest service roads, access roads or other non-technical terrains at moderate speeds. It is not to be used while rock-crawling, jumping, bogging, or other technical off-road terrains. When using off-road certified products with non-off-road certified products, always follow the warnings and restrictions stated in the non-off-road certified product instructions.

## Maintenance

The accessory rack should be carefully cleaned and maintained, particularly during the winter months. Use only a solution of water and standard car wash liquid without any alcohol, bleach or ammonium additives.

For reasons of fuel economy and the safety of other road users, the accessory rack and roof rack should be removed when not in use.

Periodically inspect accessory rack for damage. Replace lost, damaged or worn parts. Use only original spare parts obtained from a stocking specialist, dealer or manufacturer.

Any changes made to the roof racks and accessory racks as well as the use of spare parts or accessories other than those supplied by the manufacturer will lead to the lapsing of the manufacturer's warranty and liability for any material damage or accidents. You should observe these instructions to the letter and only use the original parts supplied.