

YAKIMA

ShowDown

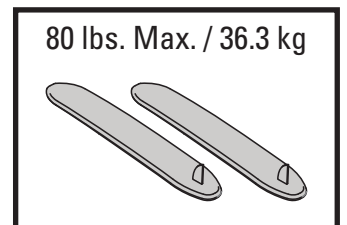
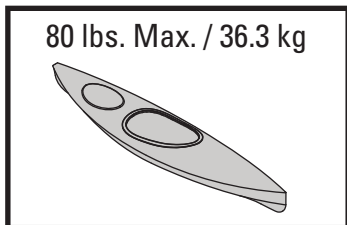
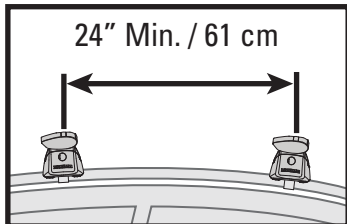
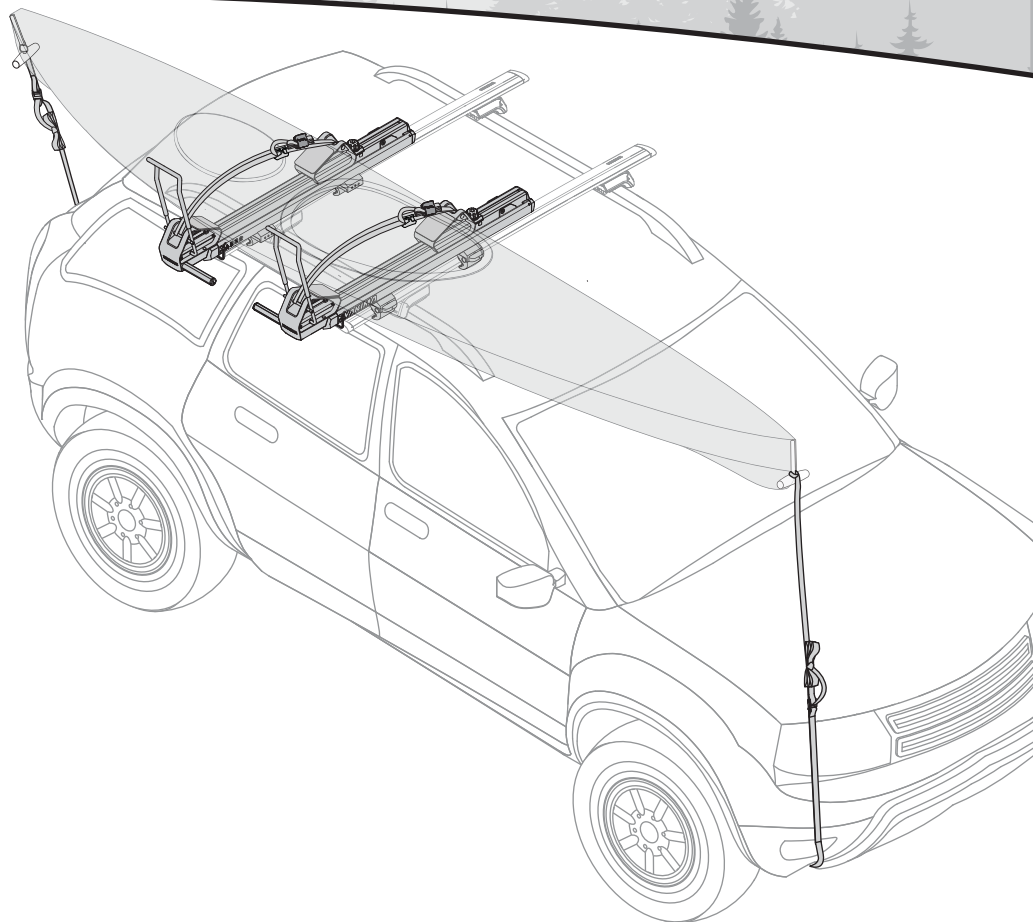

CONTENTS

ShowDown left (1x)

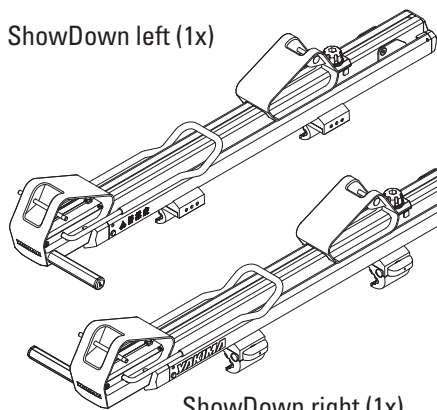

ShowDown right (1x)

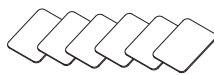

felt pad (6x)

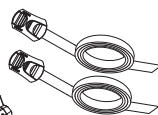

HD strap (2x)



strap clip (2x)



anchor leash (2x)

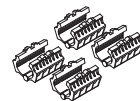

RoundBar adapter (4x)

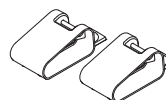

SUP saddle (2x)

Bow stern tie down

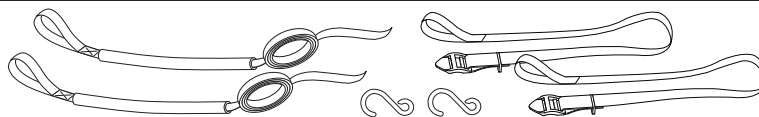

Available accessories

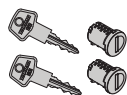

2-Pack SKS Locks

Serrures SKS (x 2)

Kit doble de cerraduras SKS

#8007202

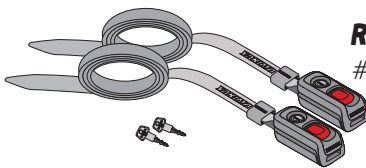

RipCord

#8004048

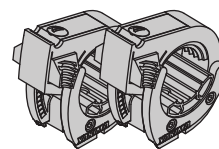

TopGrip

#8004086

IMPORTANT FIT PARAMETERS



1. You must have a minimum of 3.5" of crossbar protruding beyond the tower (see installation step 3).
2. The outboard clamp can be no farther than 4" from the tower (see loading step 3).
3. ShowDown should be adjusted on the crossbars so that it clears the vehicle by 4" when deployed.



On some vehicles this will require the purchase of crossbars one size larger than the minimum recommended size.



User should fold in side mirror if possible before deploying ShowDown and loading boat.



If you have Yakima RoundBar(s) you must remove the jaw pads from your ShowDown, and use the included RoundBar adapters. If you don't have RoundBar(s) proceed to step 1

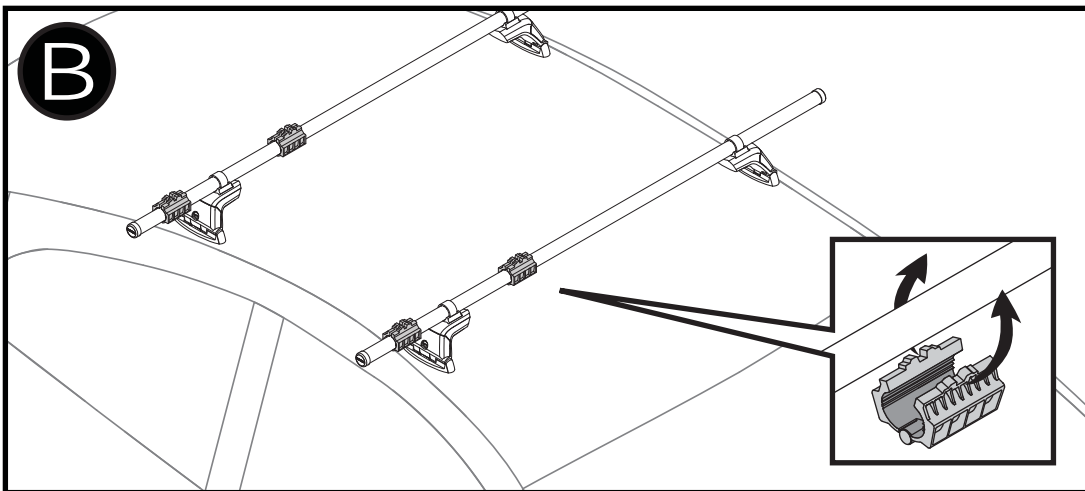
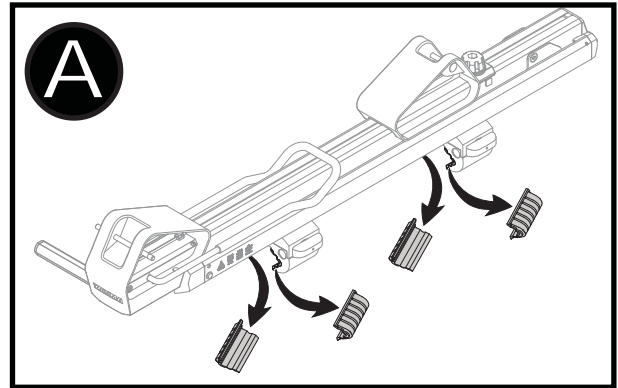

If you don't have RoundBar(s) proceed to step 1.

INSTALLATION

1

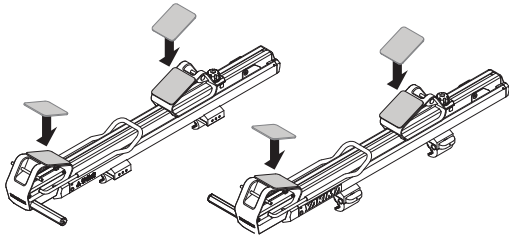

Peel off the backing, and apply the felt pads to your saddles.

2

Fully open all 4 clamps.

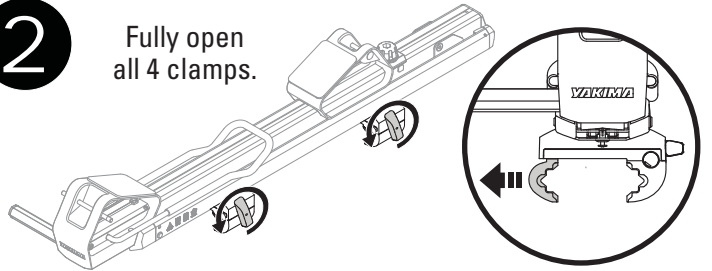

Ouvrir complètement les quatre pinces.

4X

3

3.5" (9 cm) Min.

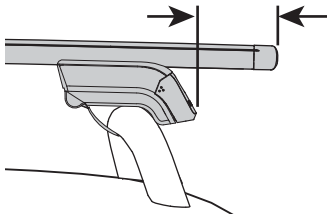

You must have a minimum of 3.5" (9 cm) of crossbar protruding beyond the tower.

Place the ShowDown units on your crossbars being sure to place the left hand unit on the left, and the right hand unit on the right. An "L" and "R" can be found on the end of the handles. **The inboard clamp of ShowDown must always be inboard of a tower.**

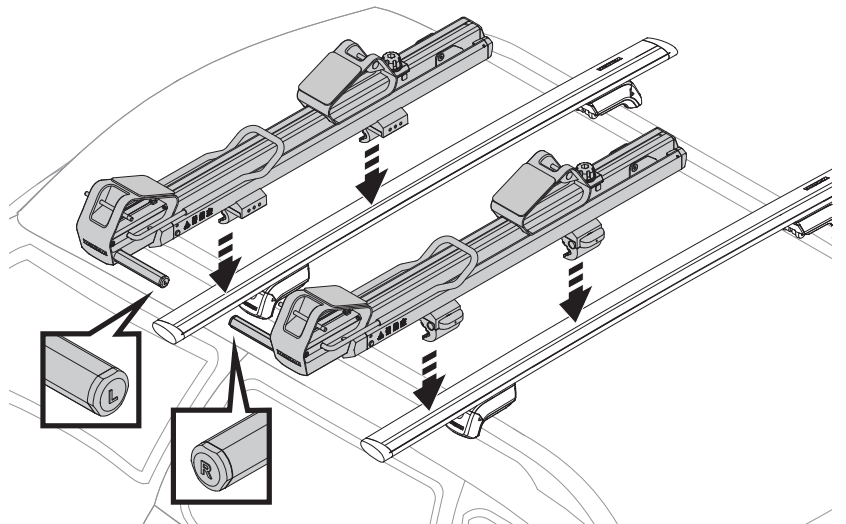

4

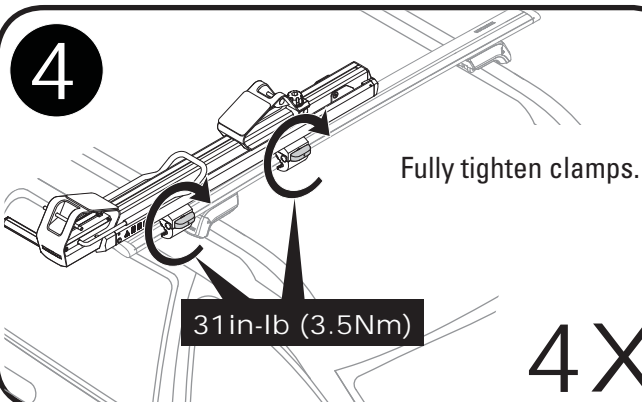

Fully tighten clamps.

31 in-lb (3.5Nm)

4X

5

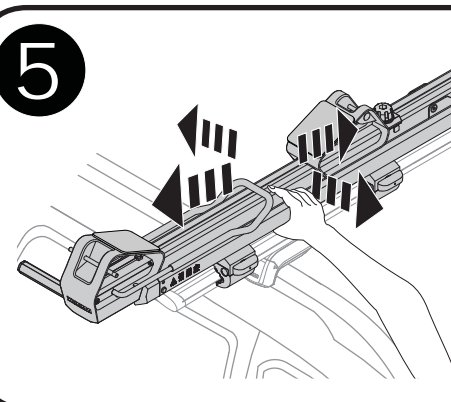

Test installation.
Retighten if necessary

2X

LOADING

1

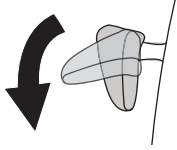

If your vehicle is equipped with folding side mirrors always fold them in before you load or unload your boat or SUP.

2

Unclip and pull out the safety pin from the loader. Let it hang, but be sure it doesn't ding your vehicle.

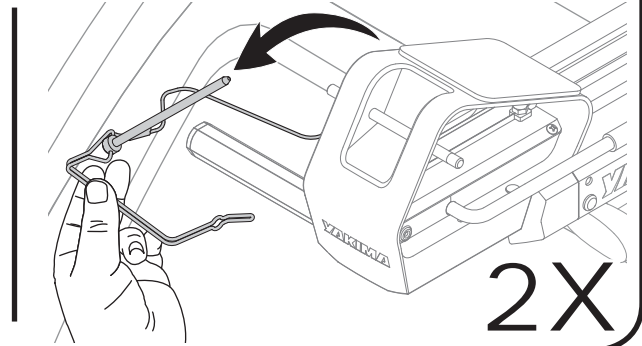
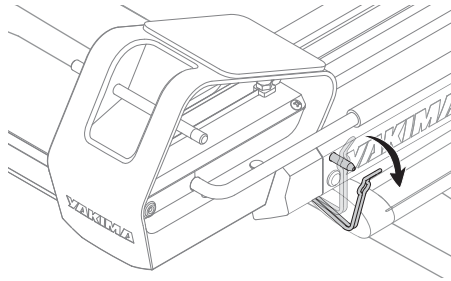

3

Grasp the handles and pull the loader all the way out, and gently lower the loaders all the way down.

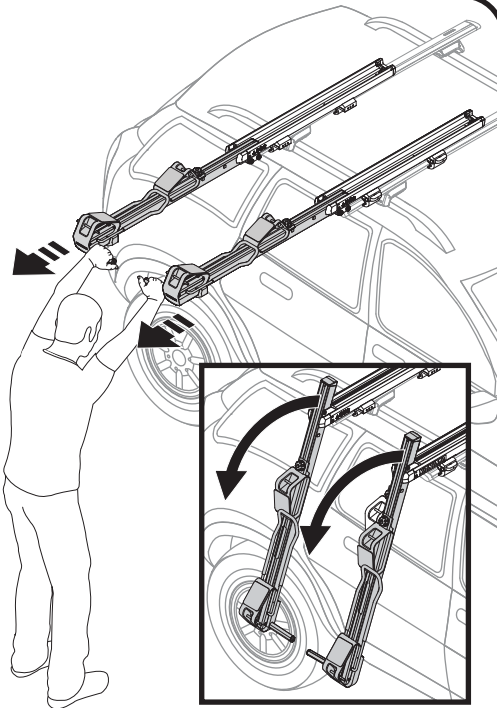

4

Loosen the knobs, and raise the inboard cradles, then retighten knobs. Pull down the support hoops.

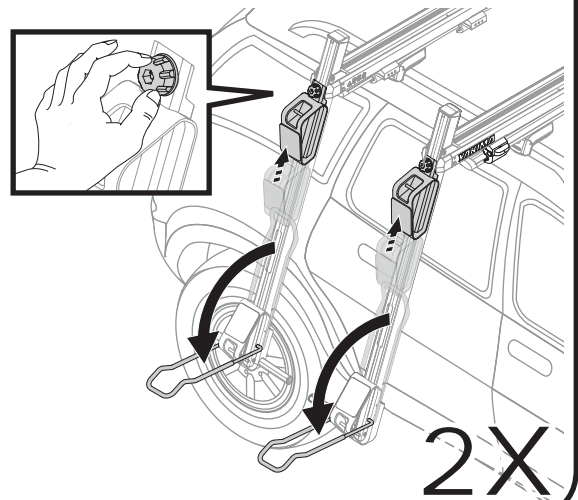

4" (10 cm) max.

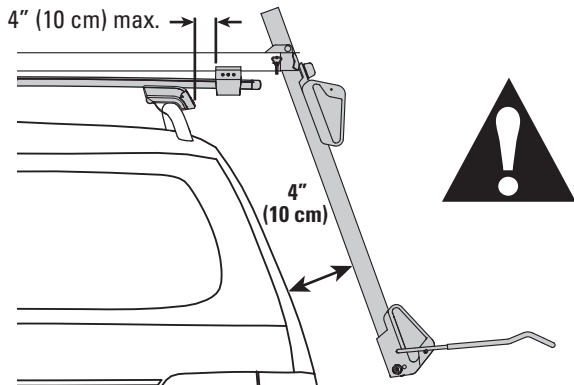

ShowDown must be adjusted on the crossbars so that it clears the vehicle by 4" when deployed. **Adjust if necessary.** The outboard clamp can be no farther than 4" from the tower.

5

Insert the strap ends down through the inboard cradles. Adjust so that the buckles are about where you see them in the image.

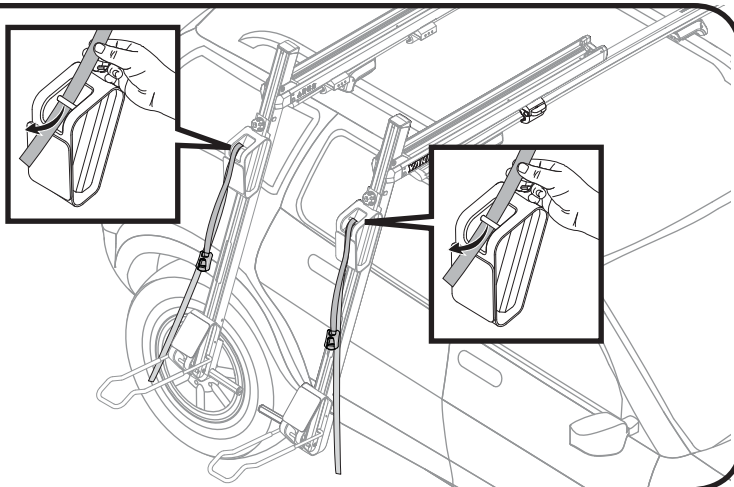

6

Load your boat, and rest it on the support hoops making sure it's balanced. Then bring the straps around to rest on the boat.

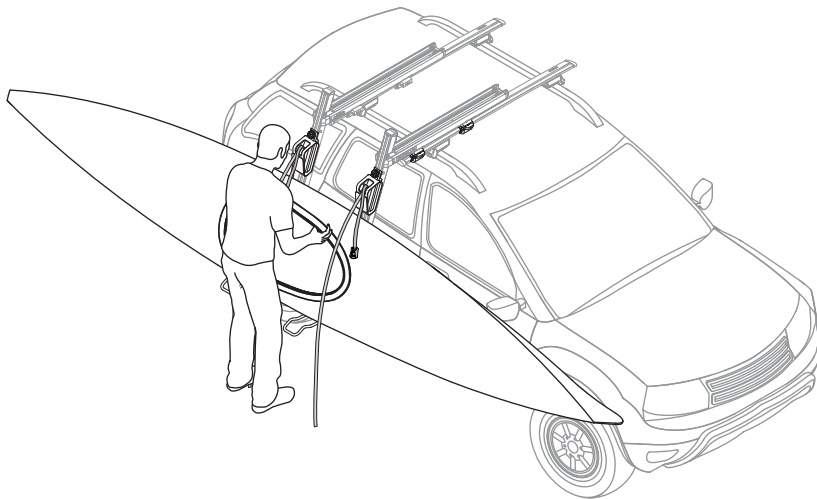

7

Loosen the knobs, and slide saddles to meet the boat. Retighten knobs. Ensure the saddles are making full contact with the boat.

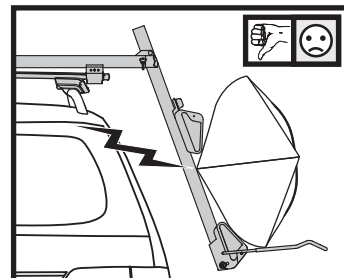
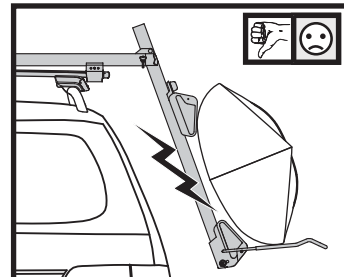
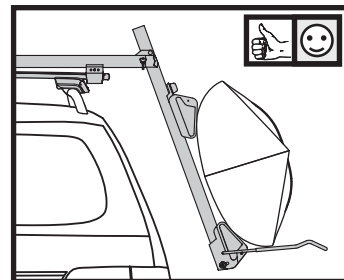
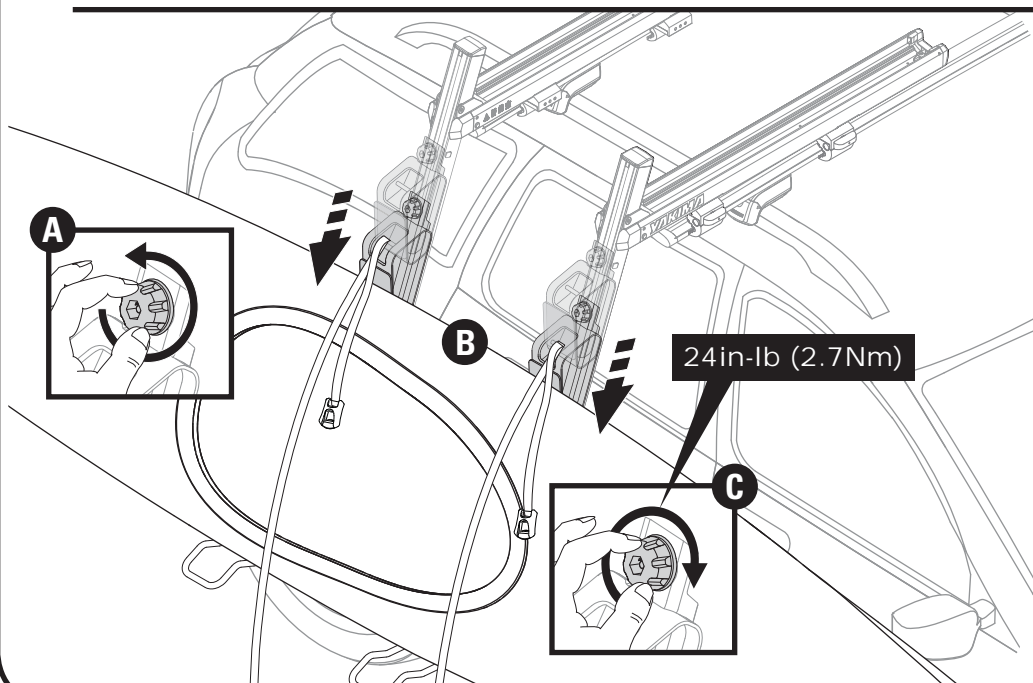

8

Route each strap through the support hoops, and through the lower saddles as shown.
Do not strap to the support hoops!

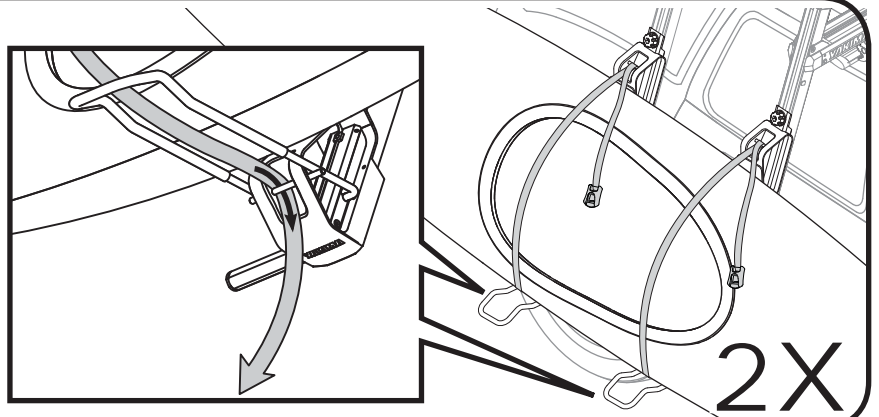

9

Route each strap upward, back through the support hoops, and insert them into the buckle as shown.

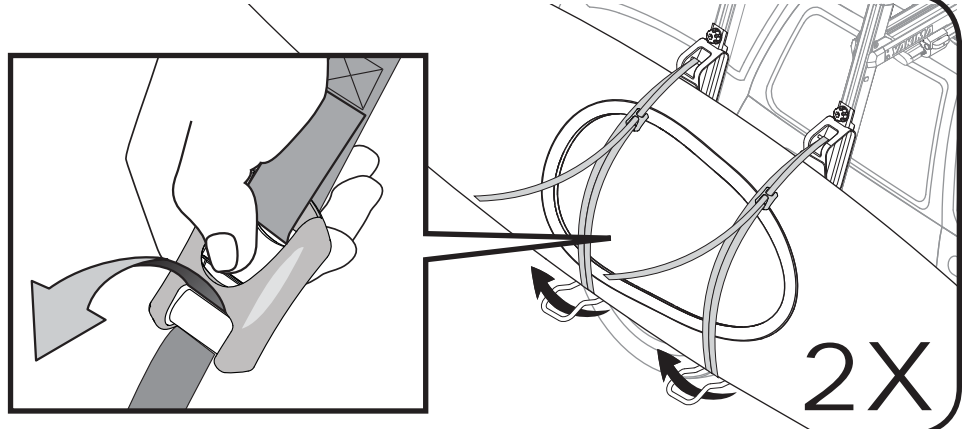

10

Pull each strap hard to tighten. Then secure the loose strap with the strap clips. Double check that you have solid contact with the cradles. Adjust and retighten if necessary.

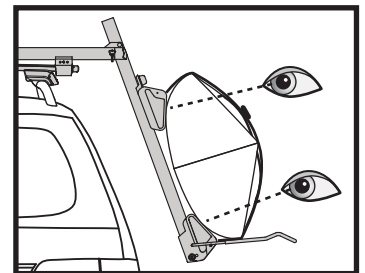
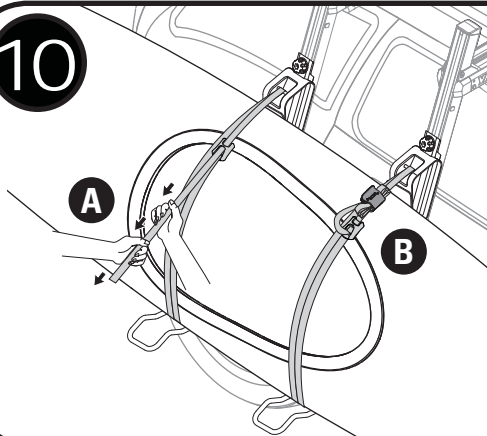

11

Grasp the handles, and raise the boat all the way up.

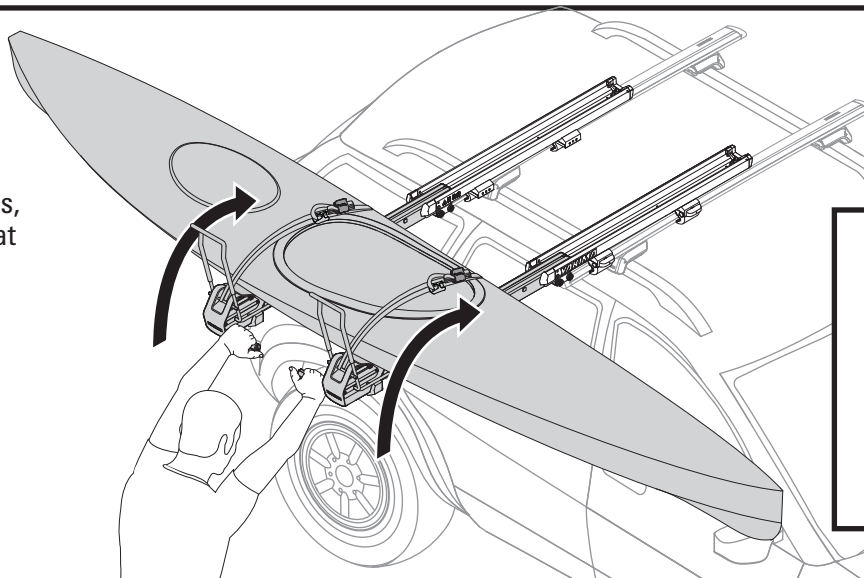

!
Use caution if you are parked on a slope.

12

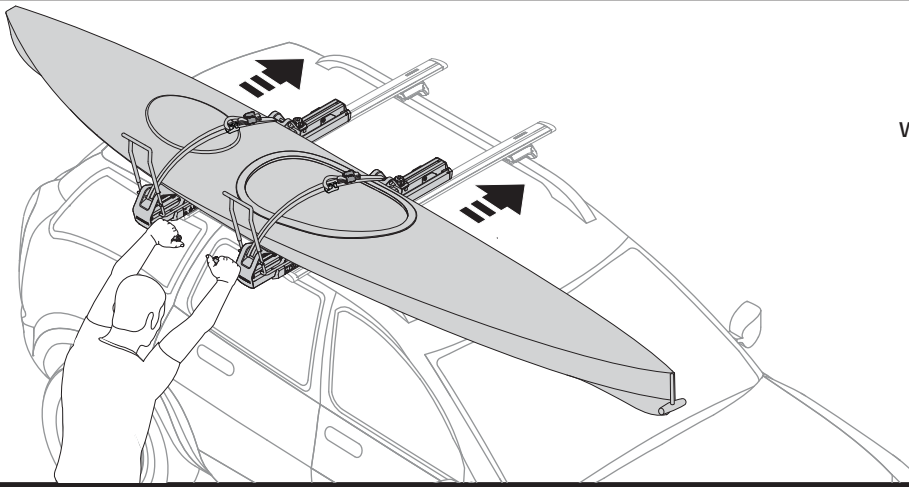

Push your boat all the way on to your vehicle.

13

Replace safety pins.

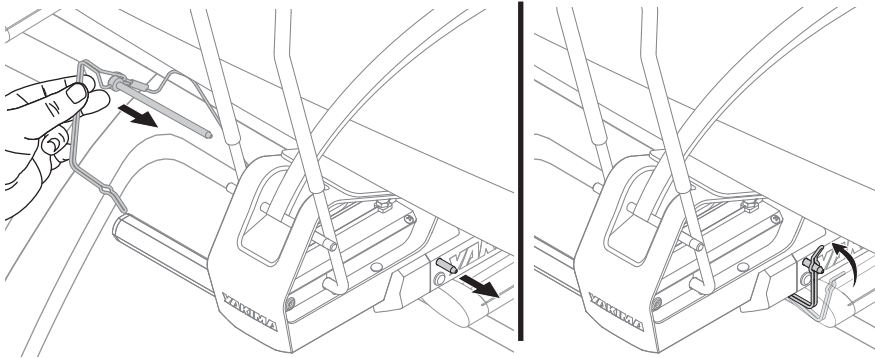

Warning: The safety pins must be inserted before driving.



Use all provided straps to secure the boat in accordance with the instructions. **Bow and stern tiedown lines must be used!**

14

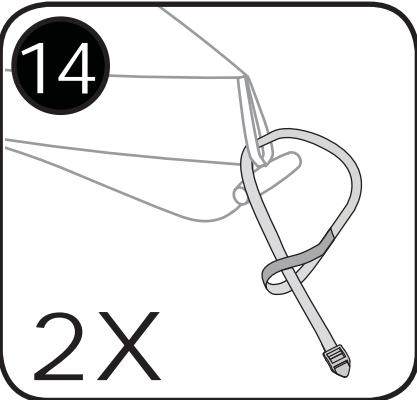

15

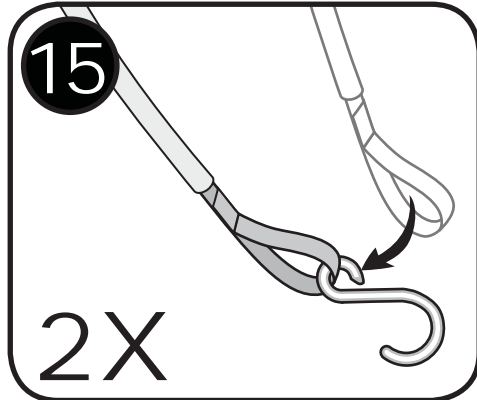

16

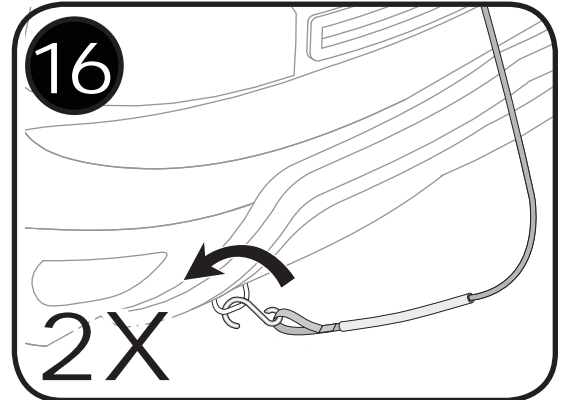

17

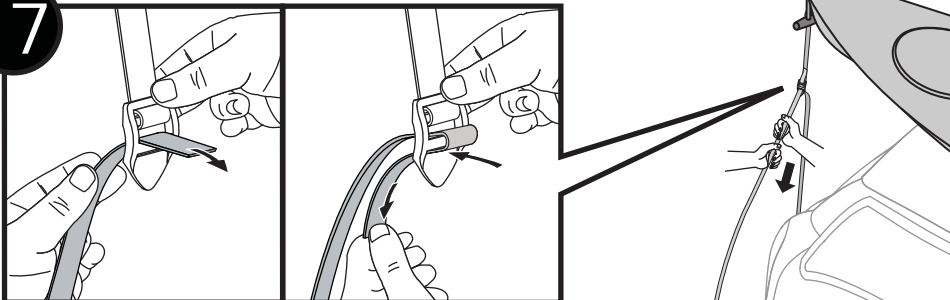

Secure stern to vehicle.

Secure loose strap.

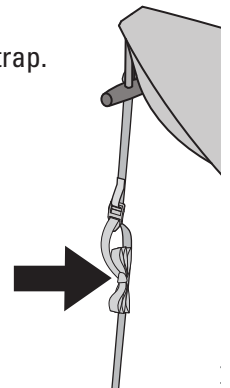

18

Secure bow
to vehicle.

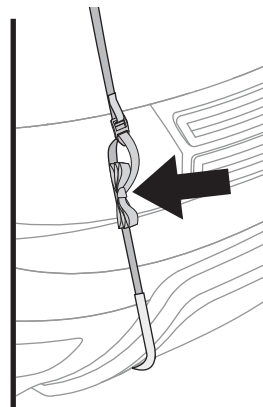
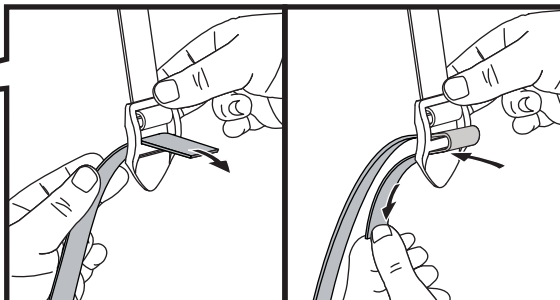
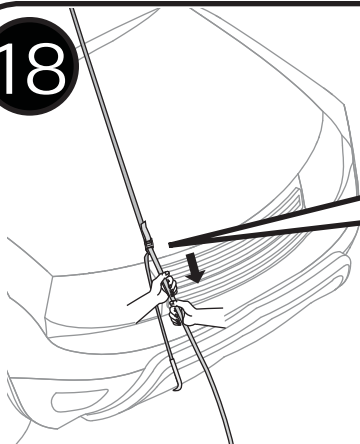

Secure
loose strap.

19

Test install. ShowDown and
boat should not slide or move
on crossbars. Reposition
cradles and retighten knobs
or straps if necessary.

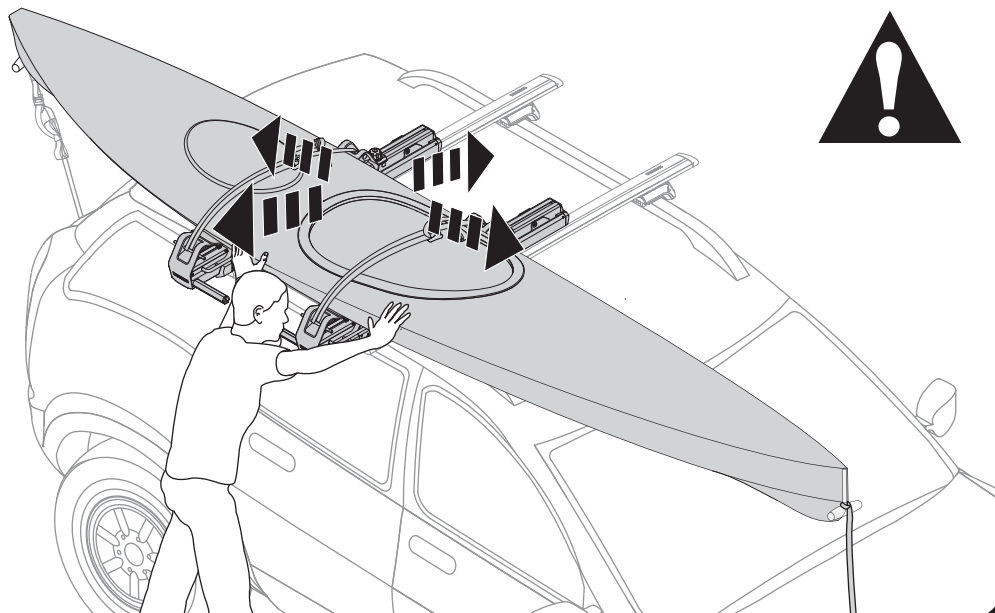

20

If you have purchased a
lock follow your lock core
instructions to install it.

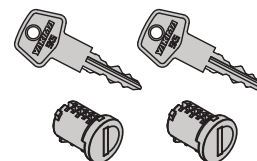

UNLOADING

1. Remove safety pins.
2. Grab the handles, and gently lower ShowDown.
3. Release and remove the straps.
4. Carefully lift your boat off the carrier.
5. Fold up the support hoops.
6. Loosen the inboard saddle knobs, and slide them against the support hoops.
7. Tighten the inboard saddle knobs.
8. Grab the handles, and raise the ShowDown.
9. Replace safety pins.

INSTALL SUP SADDLES



This section applies only to use for Stand Up Paddleboards and surfboards.

To use ShowDown for Stand Up Paddleboards (or surfboards) you need to swap the inboard saddles for the included SUP saddles. First follow this instruction through step 3 of the loading section. Then follow the steps below to install the SUP saddles. **Then read all the SUP/surf specific guidelines on the following page.**

1

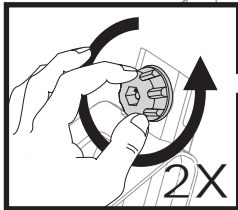

Loosen then slide the inboard saddles all the way down and remove them.

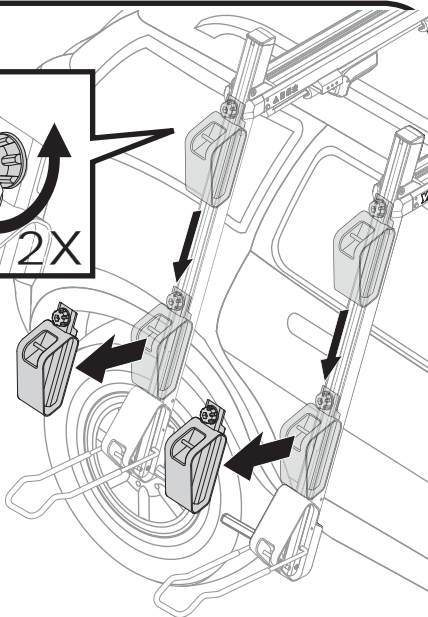

2

Remove the knob and t-bolt from each inboard saddle. Then attach the knobs and t-bolts to the SUP saddles.

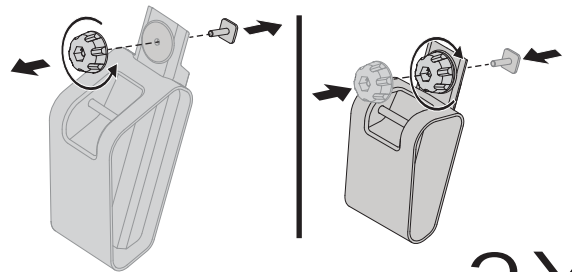

2X

3

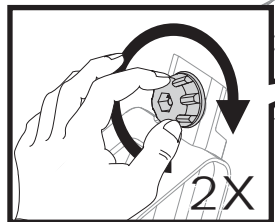

Install the SUP saddles into the slot, raise them up the channel, and tighten them down.

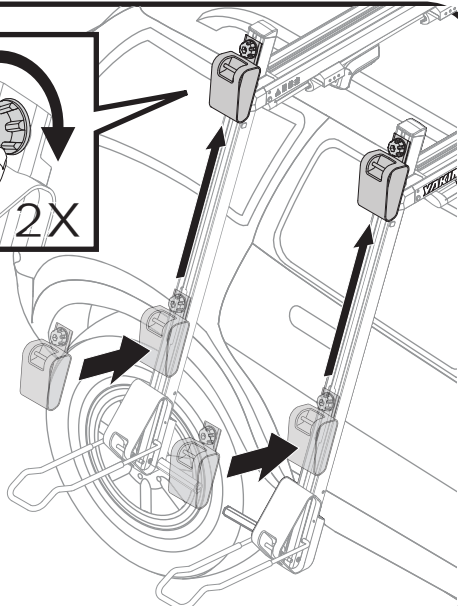

4

Read the SUP guidelines on the next page then continue to loading step 4. The general procedure is the same for SUPs as for kayaks.

INSTALL SUP SADDLES

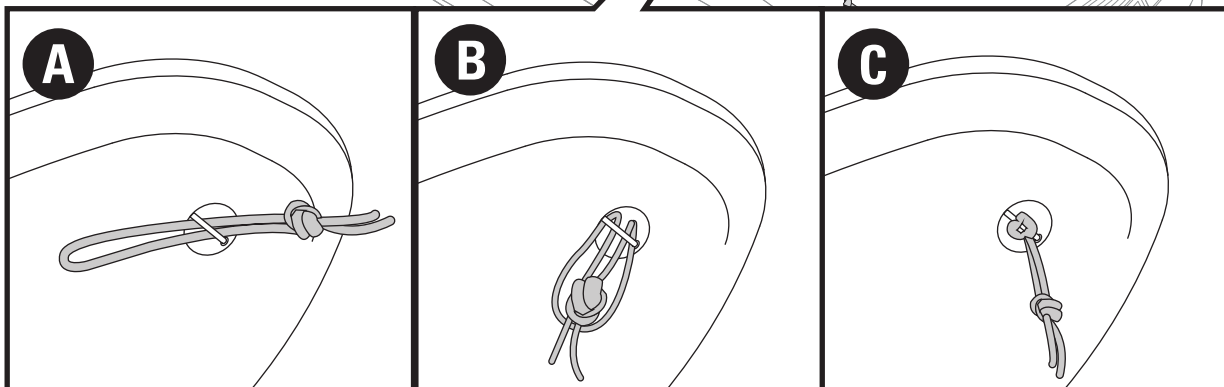
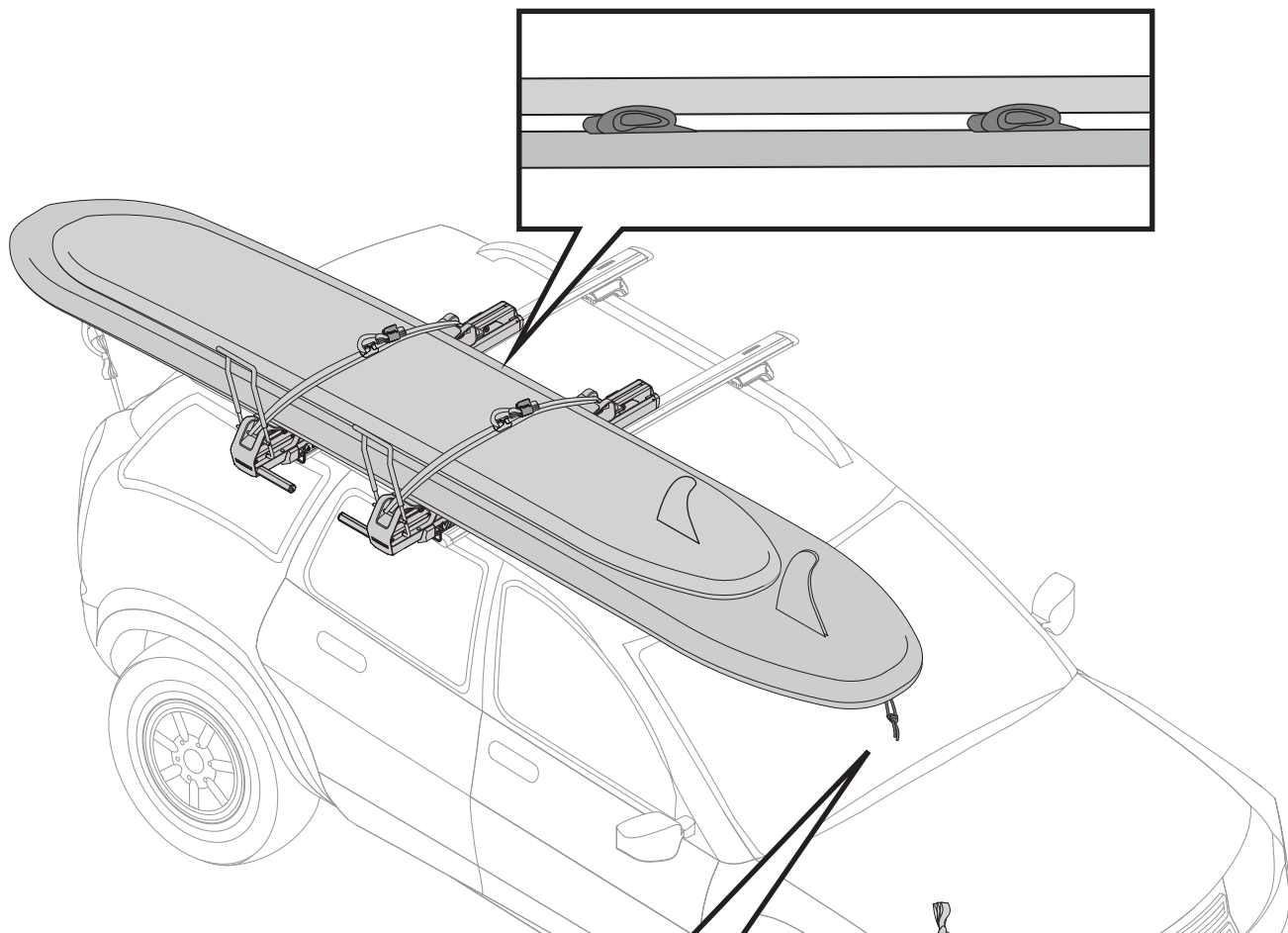

Important SUP Guidelines

The longest SUP must have bow and stern tied down for travel. Use the included anchor leashes, and attach your strap to it when securing your SUP (loading step 14). You may carry up to 2 SUPS. Always load the biggest SUP first. Place padding between the SUPs to protect them.

REMOVAL

1. Loosen the clamp knobs.
2. Carefully remove ShowDown from your vehicle.
3. Store ShowDown in a safe place.

MAINTENANCE

Use non-water soluble lubricant on screws. Use a soft cloth with water and mild detergent to clean plastic parts.

WARNING



Be sure all hardware is secured according to instructions. Attachment hardware can loosen over time. Check before each use, and tighten if necessary.

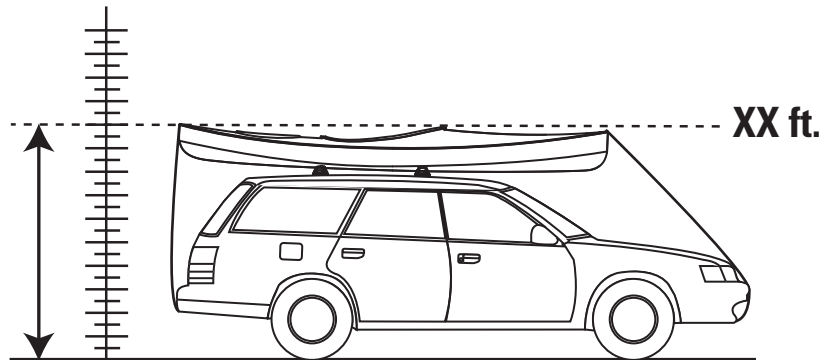
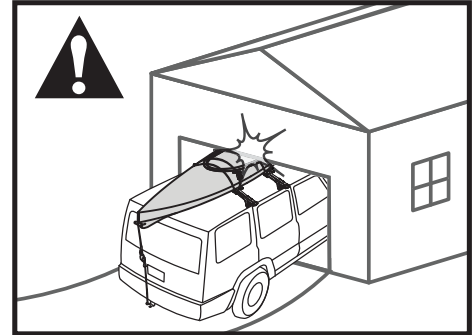
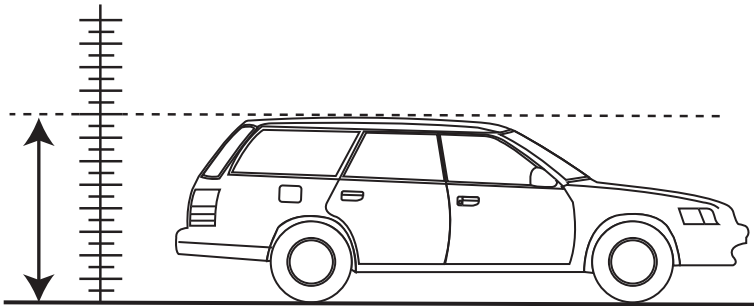

WEIGHT LIMITS

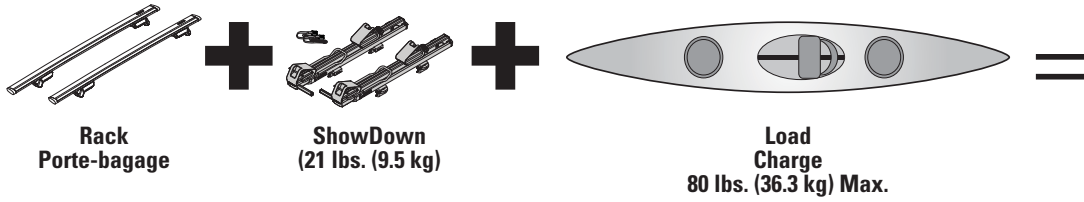

Not more than 165
lbs. (75 kg) unless
otherwise noted.

Check the Yakima Fitlist, or go to fitlookup.yakima.com for your
roof's weight limit.

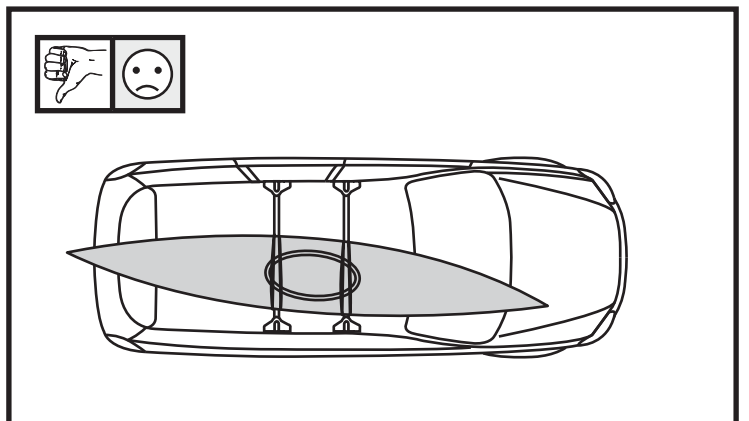
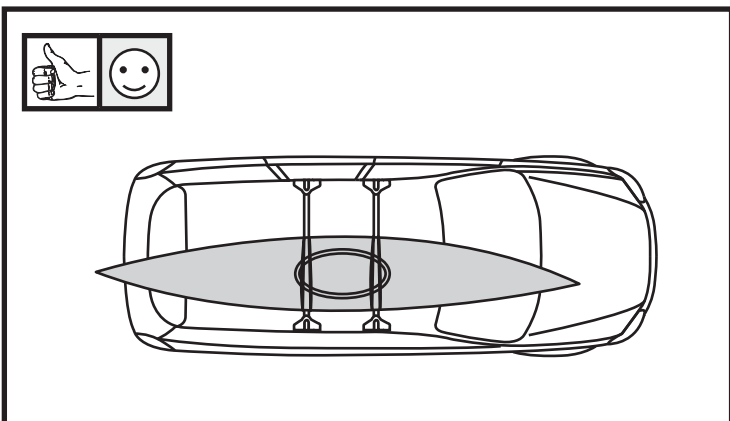
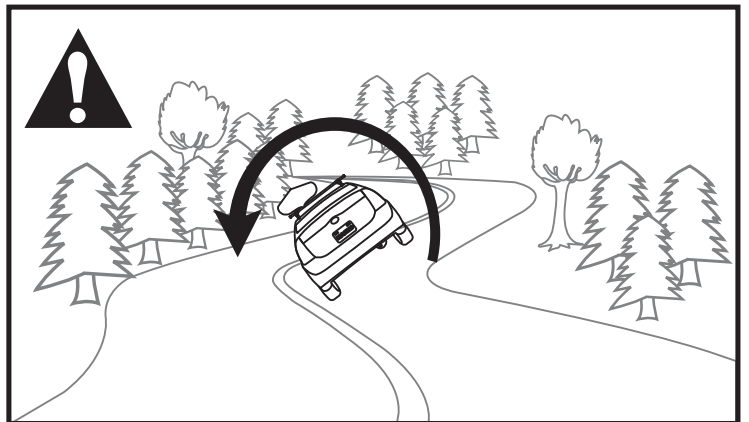
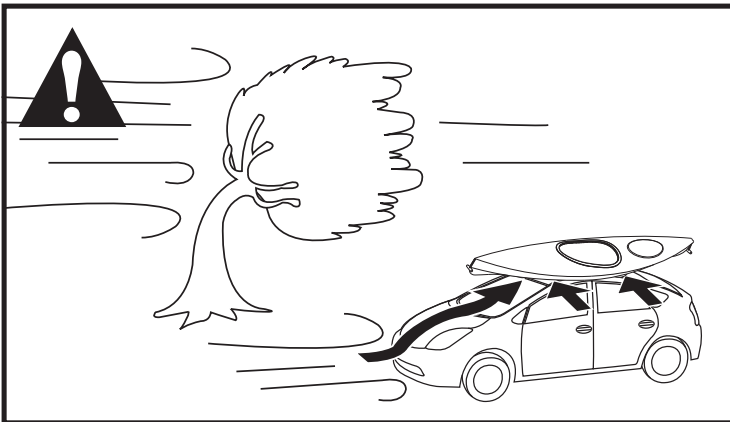
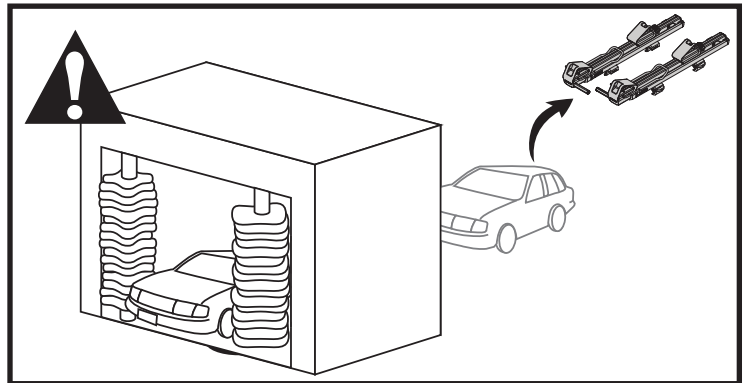
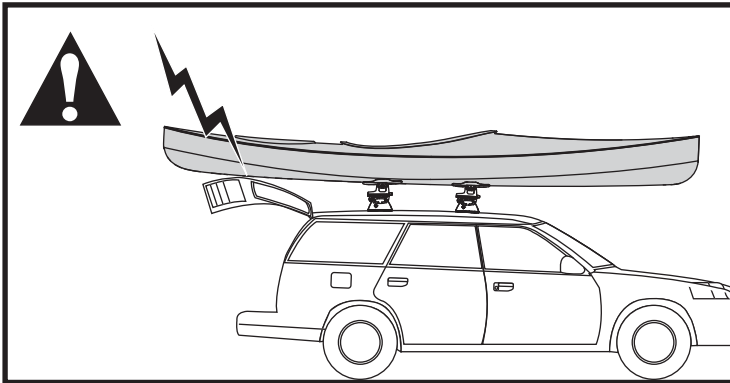

KEEP THESE INSTRUCTIONS!

IMPORTANT WARNINGS

Rack Installation

Inadequately secured loads and incorrectly mounted roof racks and accessory racks can come loose during travel and cause serious accidents! Therefore, installation, handling and use must be carried out in accordance with product and vehicle instructions.

In addition to these instructions, review the mounting instructions for the roof rack and the operating instructions of the vehicle.

These instructions should be kept together with the vehicle's operating instructions and carried in the vehicle when in use and en route.

For your own safety, you should only use roof racks that are authorized for use with your vehicle.

For roof racks that do not specify the distance between the front and rear crossbars, the distance shall be at least 700 mm or as large as possible. Please note that changes (e.g. additional drill holes) to the accessory rack's attachment system are not permissible.

Check attachment hardware and load for tight fit and function:

- Before the start of any journey.
- After driving a short distance following rack or load install.
- At regular intervals on longer journeys.
- More frequently on rough terrain.
- After interruption of a journey during which the vehicle was left unsupervised (check for damage due to outside intervention).

Rack Loading

Do not exceed the maximum load specified for the roof rack, accessory rack or the maximum load recommended by the vehicle manufacturer.

Max Roof Load = weight of roof rack + weight of accessory racks + weight of load.

Load shall be uniformly distributed with the lowest possible center of gravity.

Load should not substantially extend beyond the loading surface of the roof rack.

Boat Loading

Use all provided straps to secure the boat in accordance with the instructions. Bow and stern tiedown lines must be used!

Vehicle Driving and Regulations

The speed driven must be suited to the load transported and to official speed limits. In the absence of any speed limits, we recommend a maximum speed of 80 mph (130 km/h).

When transporting any load, the speed of the vehicle must take into account all conditions such as the state of the road, the surface of the road, traffic conditions, wind, etc. Vehicle handling, cornering, braking and sensitivity to side winds will change with the addition of roof top loads.

Off-road driving is not recommended and could result in damage to your vehicle or your gear.

Maintenance

The accessory rack should be carefully cleaned and maintained, particularly during the winter months. Use only a solution of water and standard car wash liquid without any alcohol, bleach or ammonium additives.

For reasons of fuel economy and the safety of other road users, the accessory rack and roof rack should be removed when not in use.

Periodically inspect accessory rack for damage. Replace lost, damaged or worn parts. Use only original spare parts obtained from a stocking specialist, dealer or manufacturer.

Any changes made to the roof racks and accessory racks as well as the use of spare parts or accessories other than those supplied by the manufacturer will lead to the lapsing of the manufacturer's warranty and liability for any material damage or accidents. You should observe these instructions to the letter and only use the original parts supplied.