

YAKIMA

FatCat Evo 4 & 6

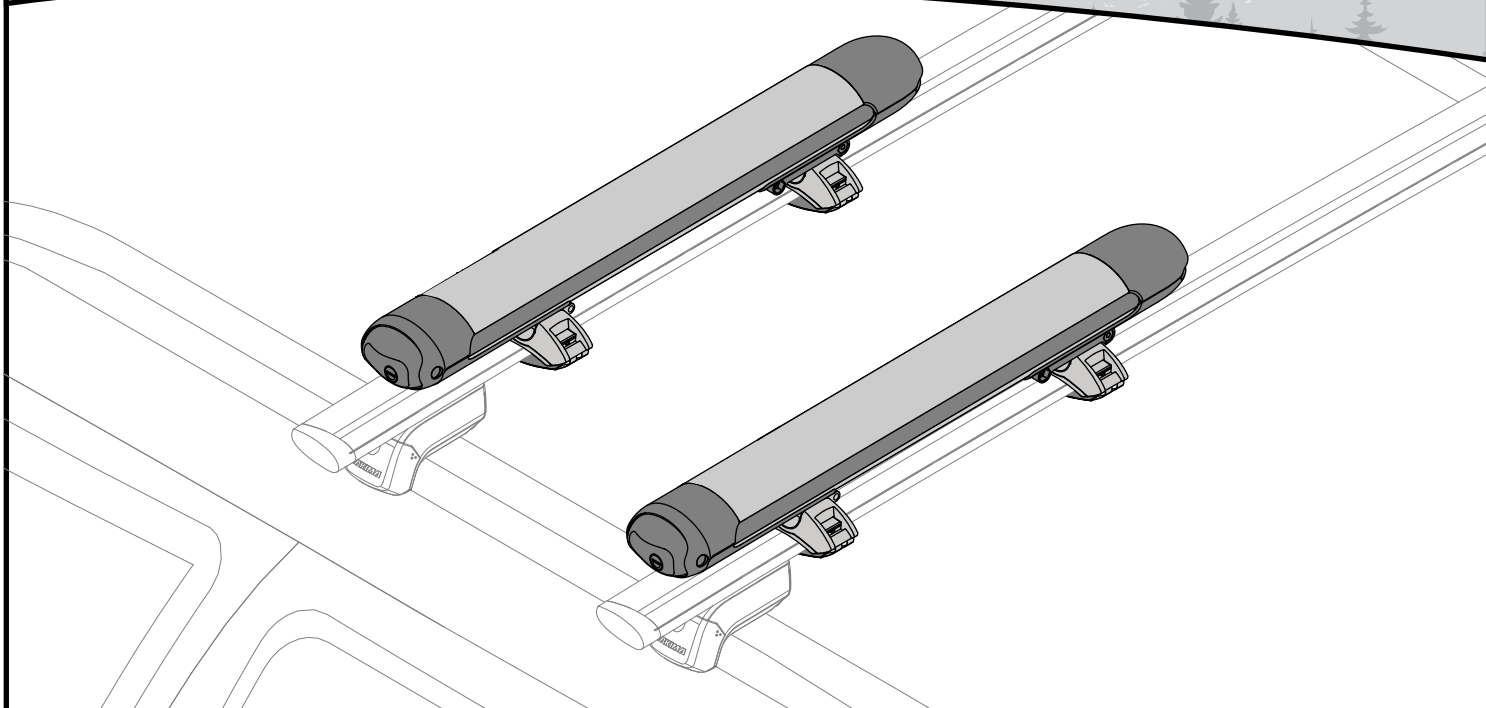

Contents

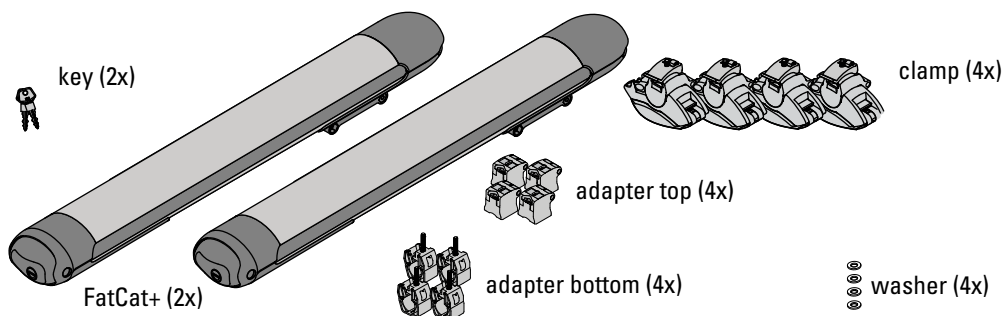

Available accessories

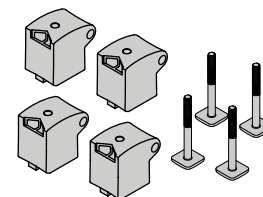

Smart-Slot Kit 2
#8003098

Crossbar spread

Skis and boards under 67": 12" - 24"

Skis and boards over 67": 12" - 36"

The distance between supporting bars should be adjusted so that when the bindings strike the ski rack, the skis cannot slip out on the other ski rack.

Aero bars

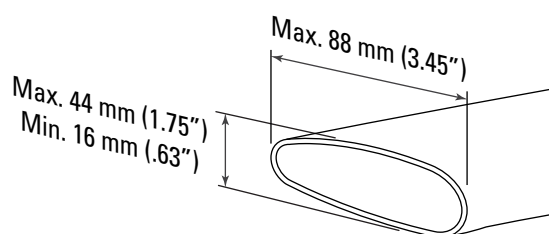

Square bar

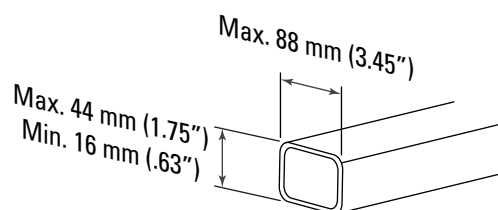

INSTALLATION



For round/square bar installation go to page 5.

2

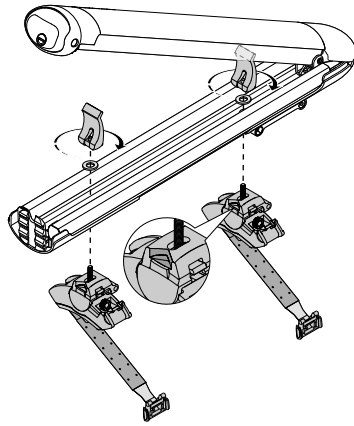

Press the button to open the FatCat Evo. Loosely attach the clamps by partially threading the knobs on. Keep them in the vertical position. Be sure to include the washers.

1

Remove the knobs from the clamps.



2X

Optional FatCat Evo 6 ONLY: If the usable space on your crossbar is 24" or less, or you want to bias the mount toward one side of your vehicle, use mounting position B.

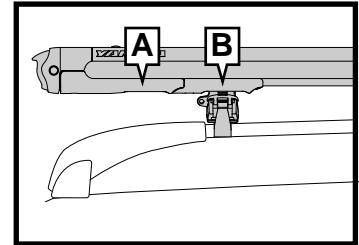
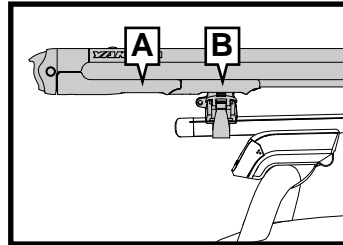

4X

3

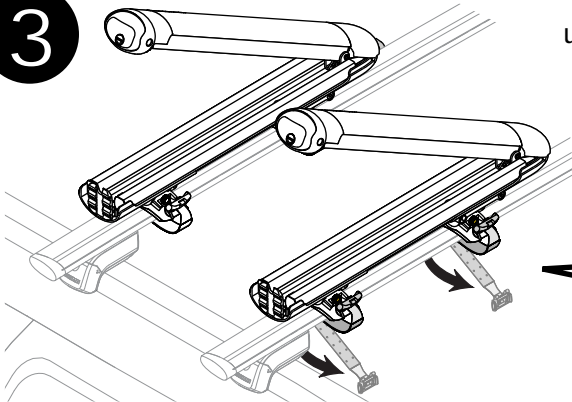

Place the mounts onto the crossbar. Route the strap under the crossbar, and hook the buckle into the clamp.

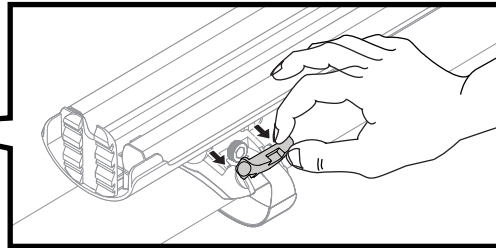

2X

4

The buckle must close with firm resistance. If it closes too easily, or does not stay closed, adjust the red wheel accordingly until the buckle closes with firm resistance.

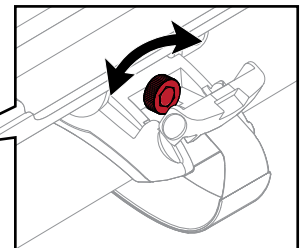
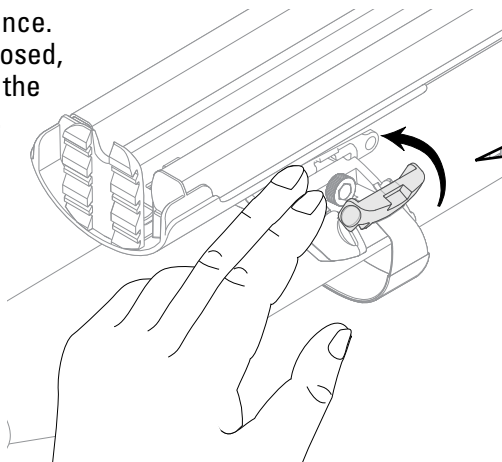

4X

5

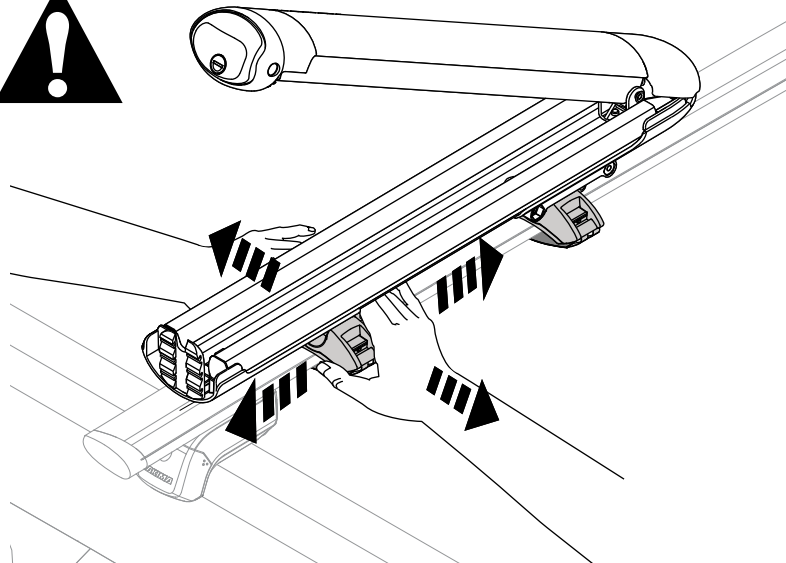

Test the clamp installation by pushing and pulling each clamp in all directions. If the clamps move repeat step 4.

4X

6

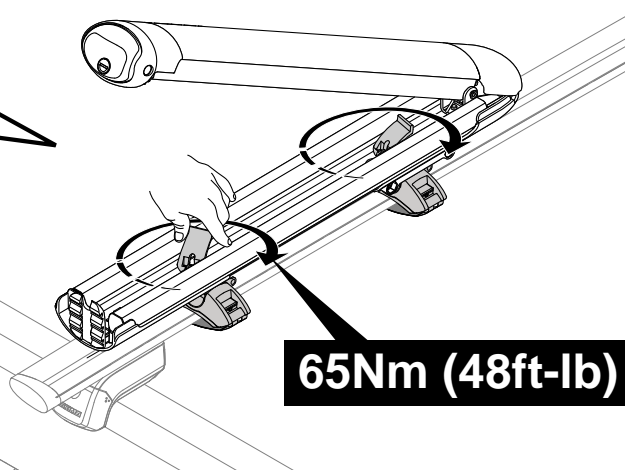
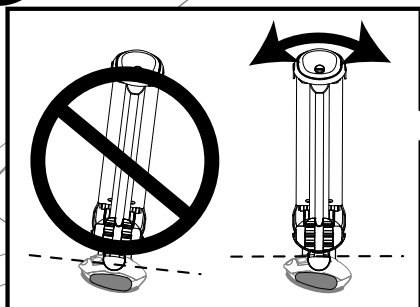
**65Nm (48ft-lb)**

Make sure the mounts are vertical, then fully tighten and close the knobs.

4X

7

Test the installation by pushing and pulling in all directions. If the mount is loose, return to step 4 and tighten the red wheel more.

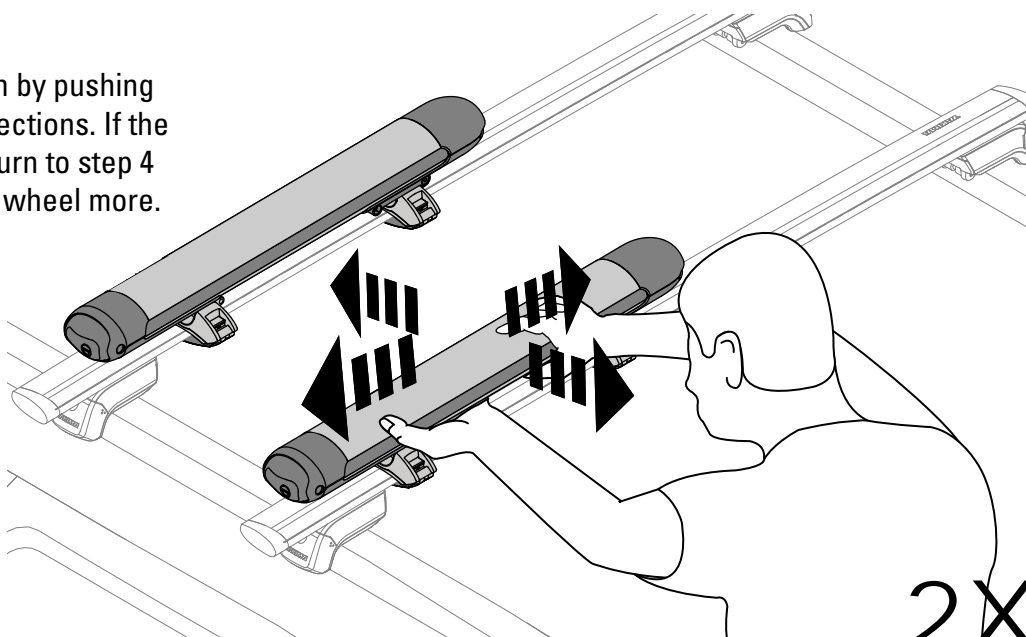

2X

LOADING

1

Press the buttons and open the mounts. Load your skis keeping the tips toward the rear of the vehicle. Load bindings between the mounts. Close mounts with firm pressure.

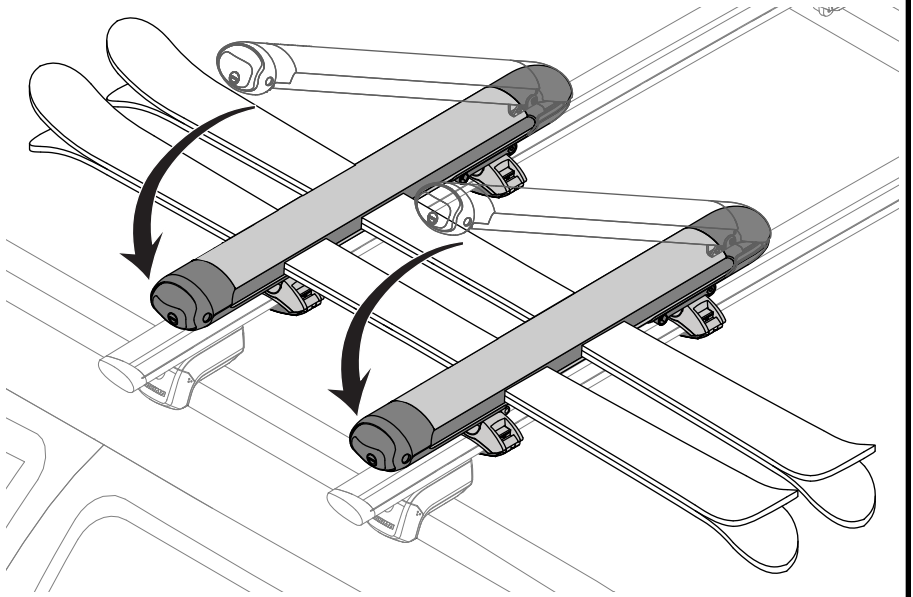

Note: In some cases you may need to close the mount between your bindings. Position them fore/ aft to best avoid hatch contact.



If your bindings contact the vehicle use the SkiLift feature. Go to page 5, or page 7 for round or square bars.

2X

2

Verify closure by pulling upward on the skis to see if the mount opens. If it opens, apply more pressure when closing the mount. Use the keys to lock your mounts.

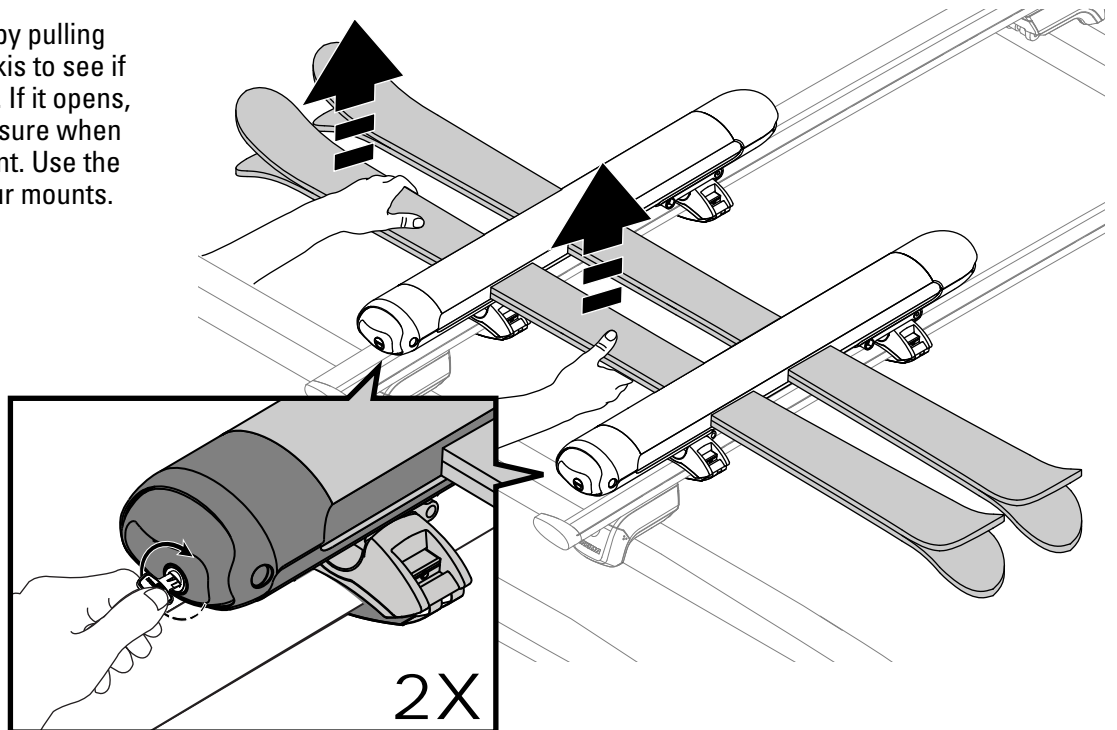

2X

ROUND/SQUARE BAR

A

Remove the knobs from the clamps.

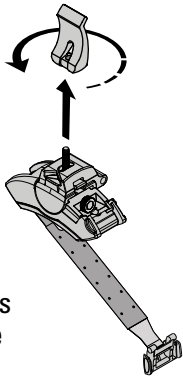

4X

Square Bar Only

1

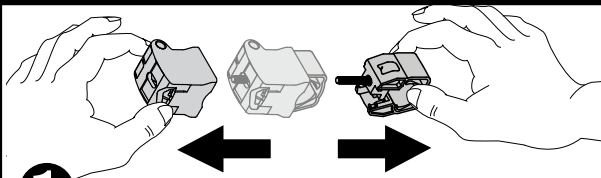

2

Cut out tabs.

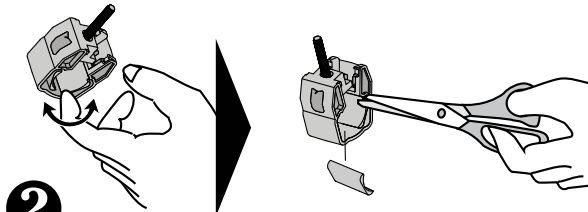

B

Snap the adapters around crossbars.

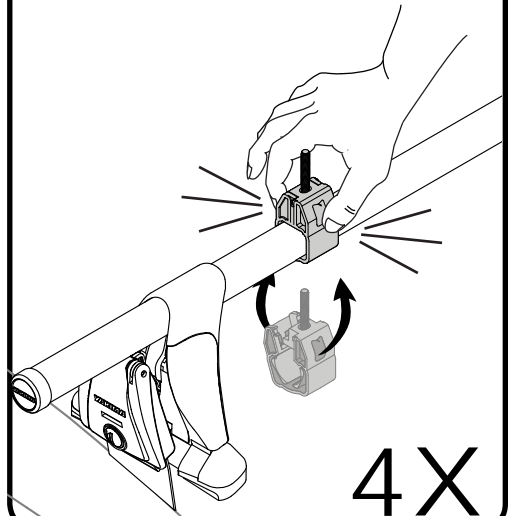

4X

C

Orient the arrows toward the front of the vehicle.

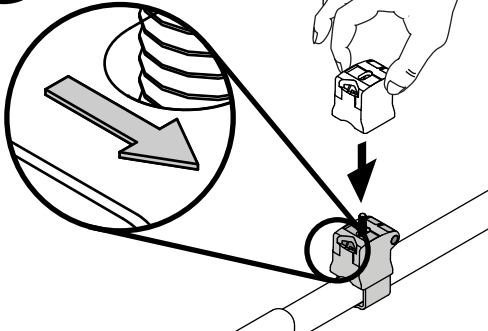

4X

D

Place the mounts onto the adapters.

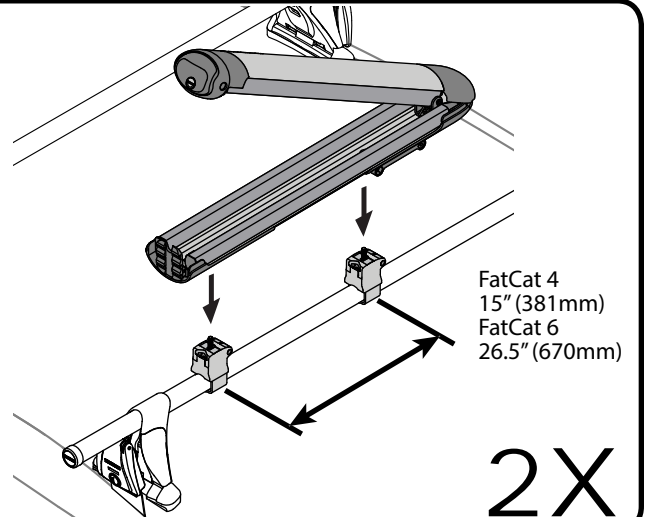

2X

E

Make sure the mounts are vertical, then fully tighten and close the knobs.

65Nm (48ft-lb)

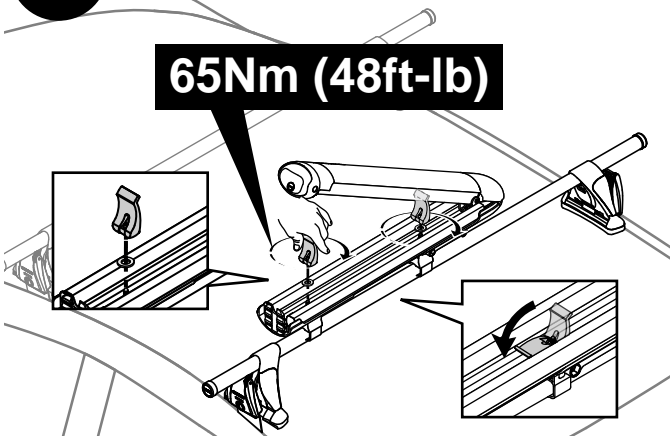

4X

F

Test install.
Retighten knobs if necessary.

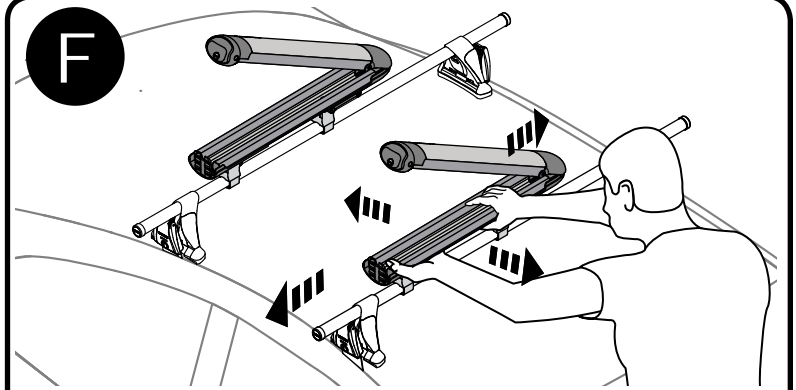

2X

G

Got to page
4 for loading
instructions.

SKI LIFT

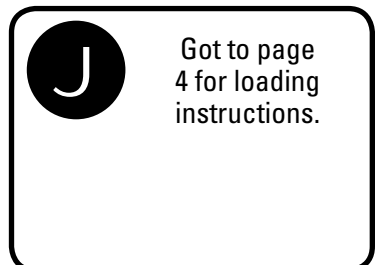
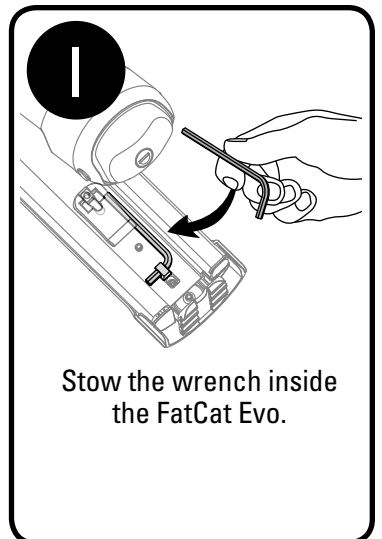
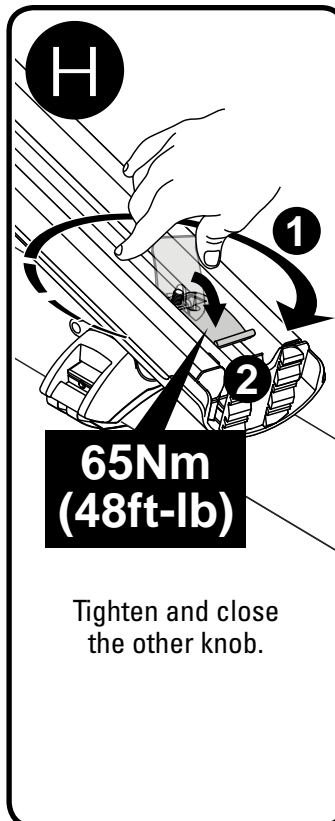
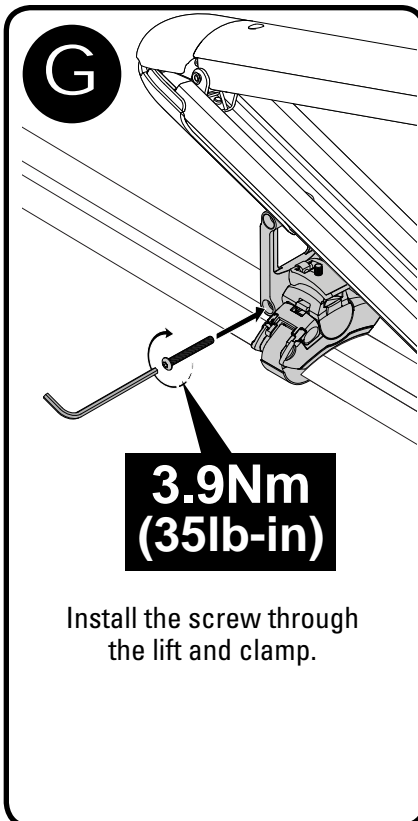
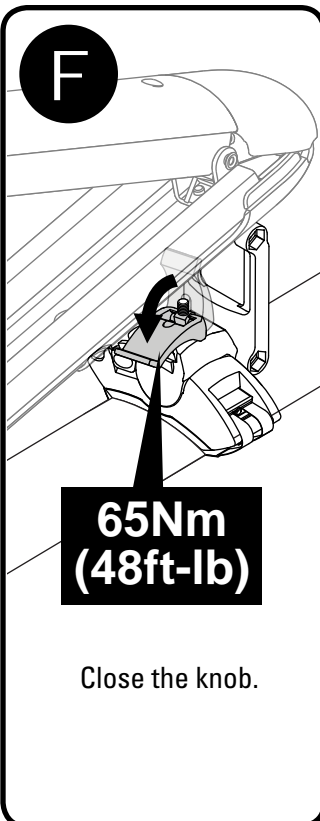
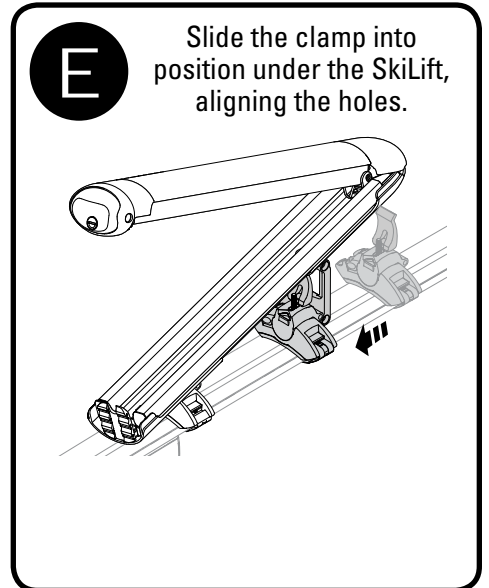
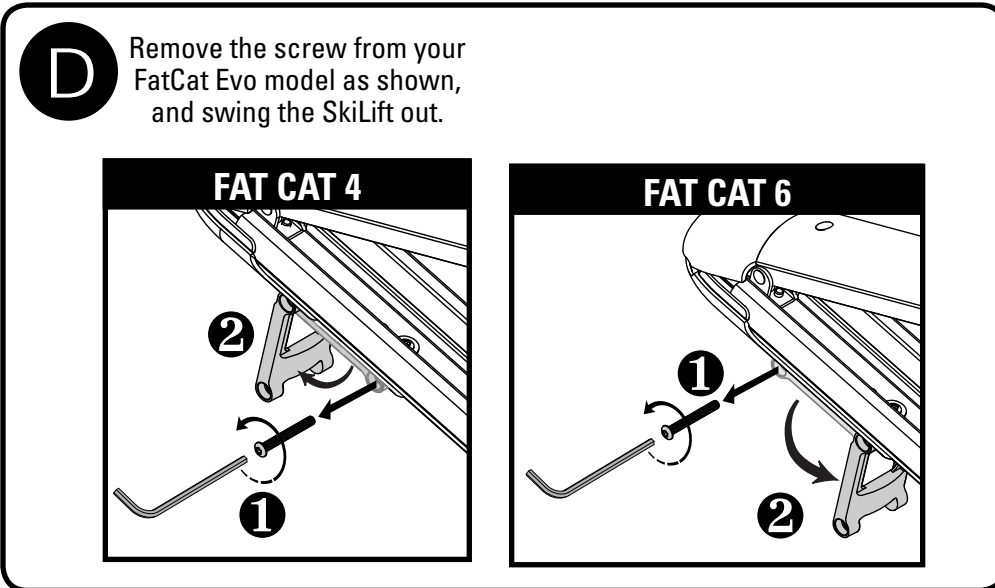
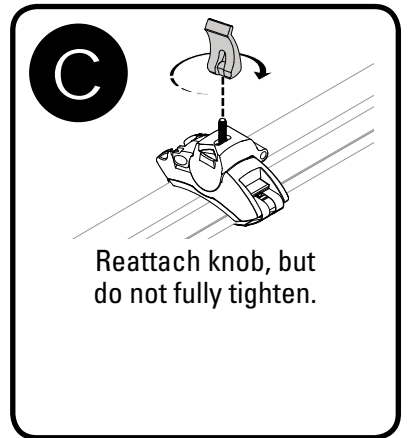
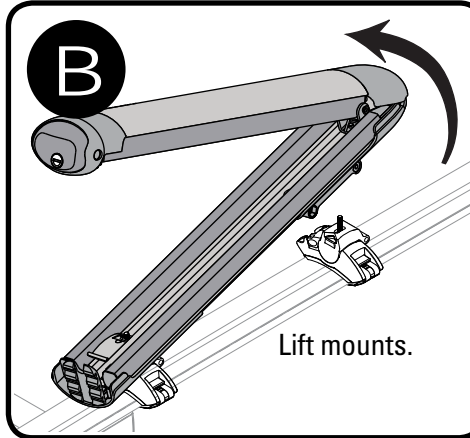
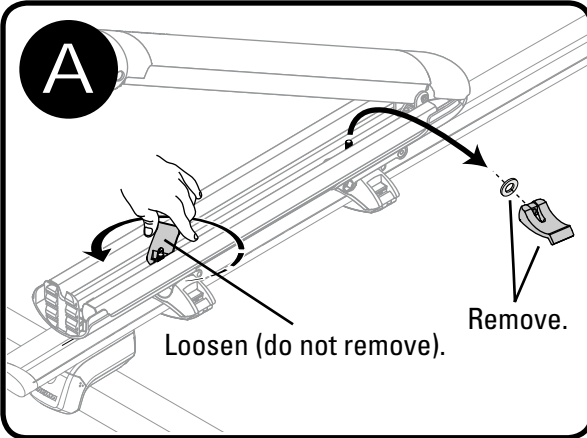

ROUND/SQUARE SKI LIFT

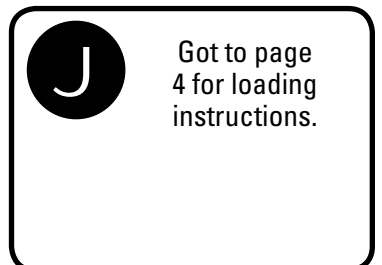
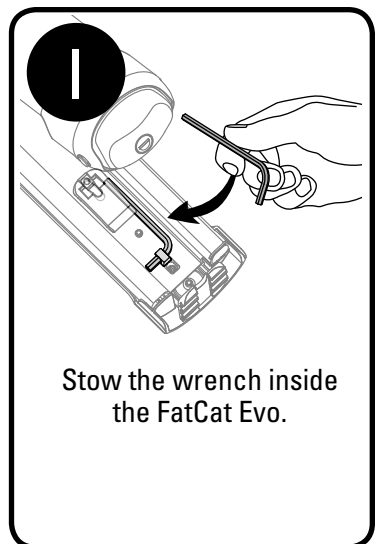
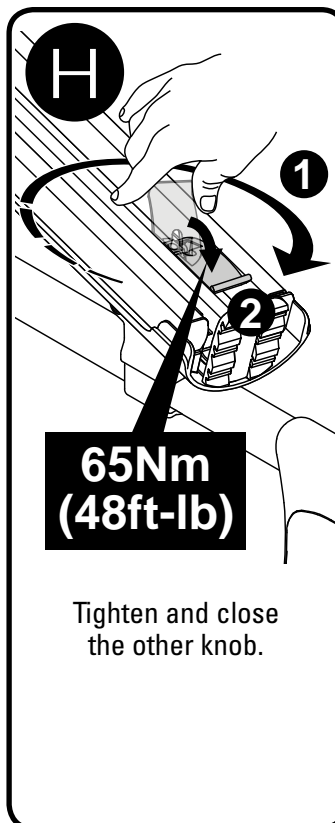
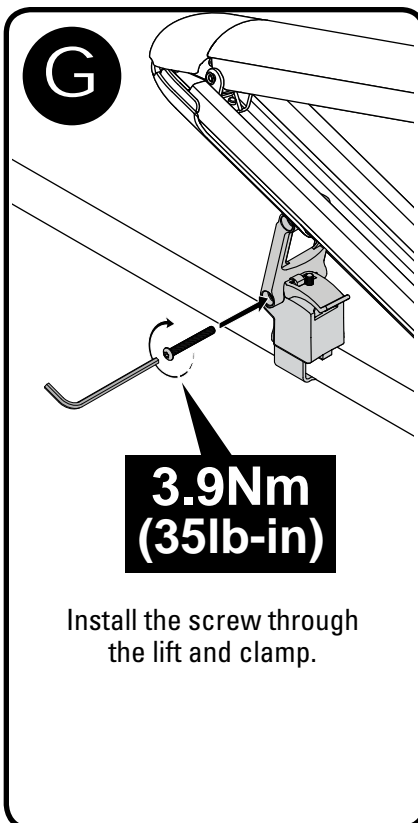
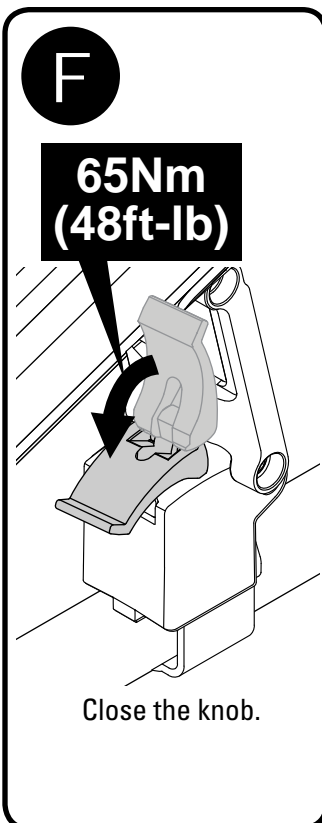
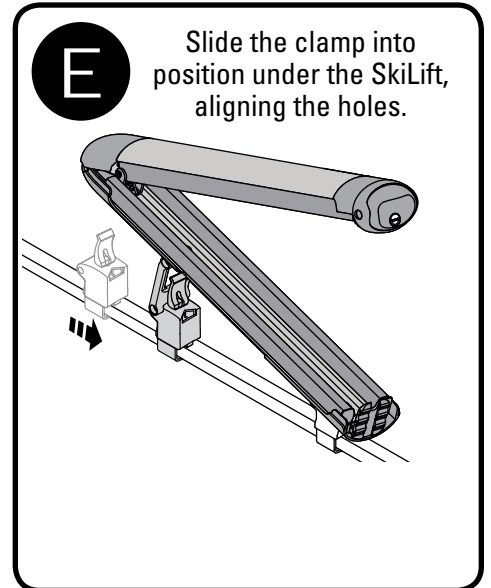
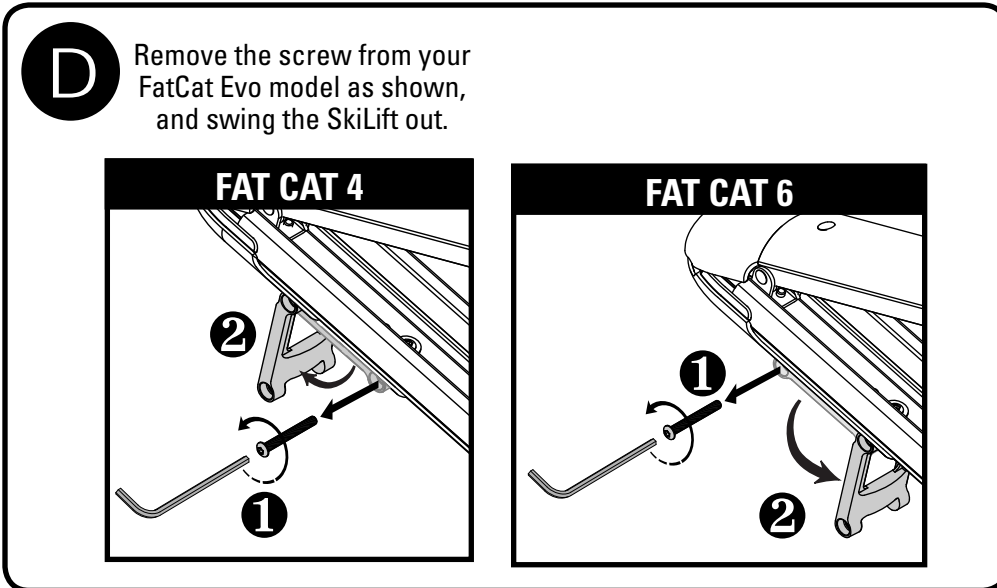
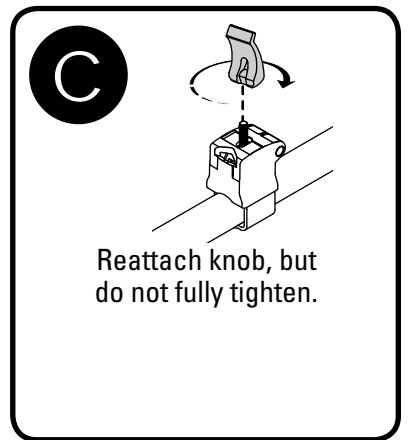
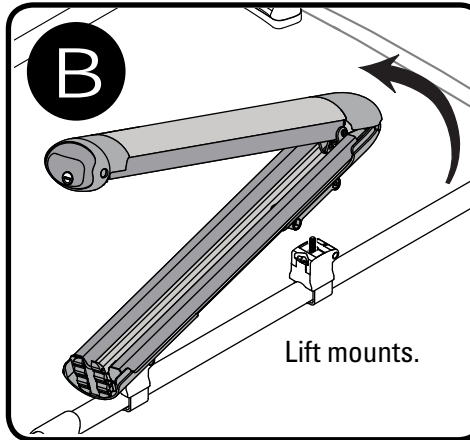
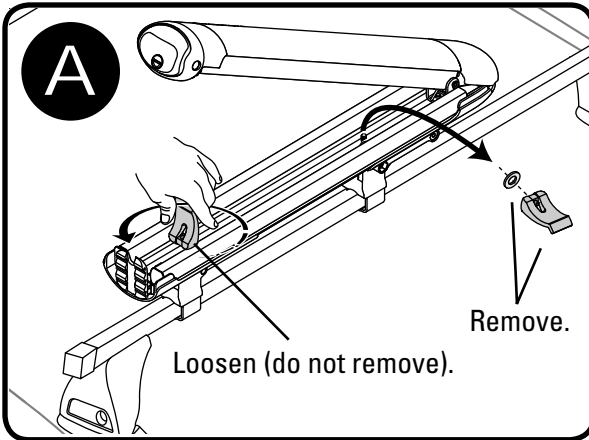

UNLOADING

1. Unlock the mounts.
2. Press the button to open the mounts.
3. Carefully remove your skis or boards.
4. Close and lock the mounts.

REMOVAL

1. Open and loosen knobs (do not remove them).
2. Unhook the buckle, and release the strap.
3. Carefully lift the mounts from your vehicle.

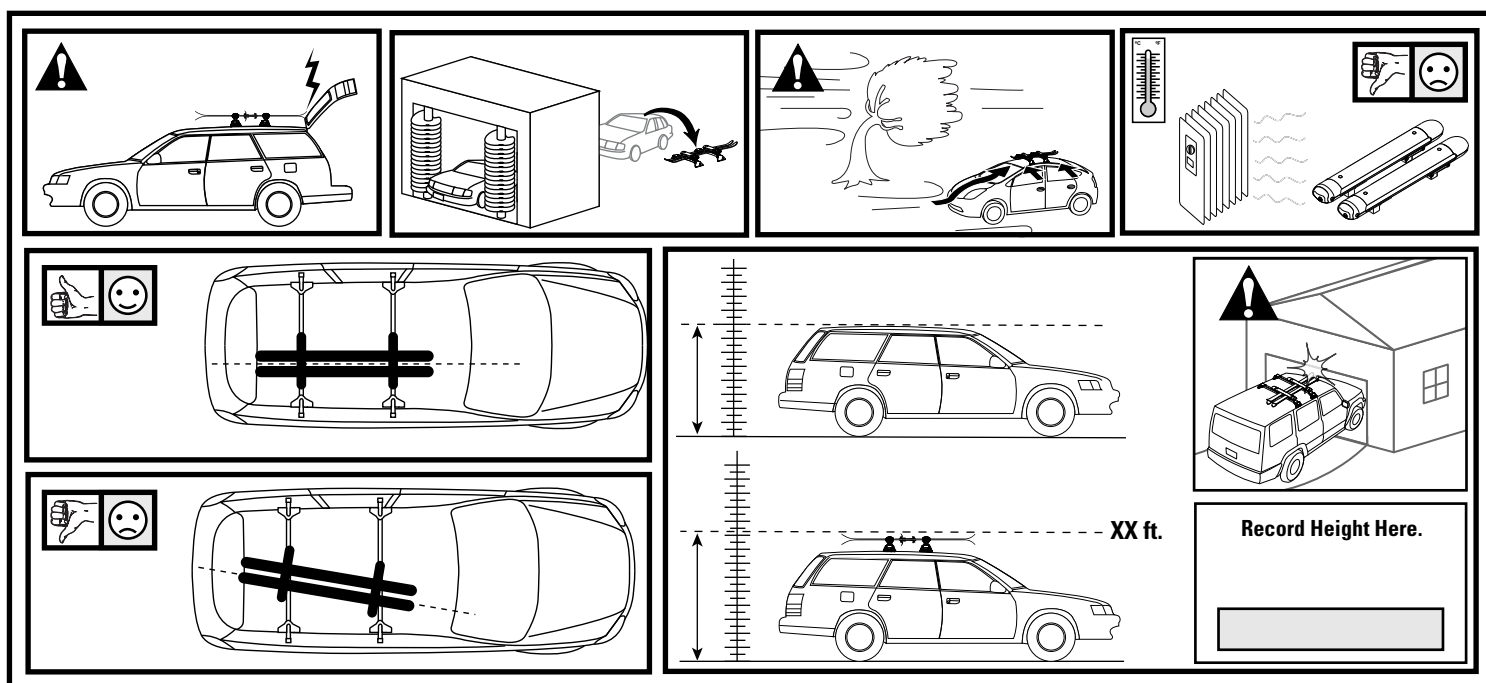

WEIGHT LIMITS

Rack
 Porte-bagage
 Portaequipaje

FatCat 4: 9.5 lbs (4.3 kg)
FatCat 6: 12.3 lbs (5.6 kg)

Load Capacity
 Carga
 92.6 lbs. (42 kg) Max.

Not more than 165 lbs. (75 kg)
unless otherwise noted.

Check the Yakima Fitlist, or go to fitlookup.yakima.com for your roof's weight limit.

KEEP THESE INSTRUCTIONS!