

CONTENTS

ski mount (with cleats) (2X)

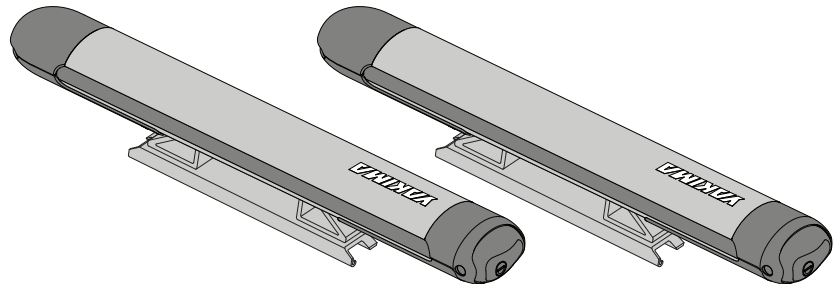

1 PREPARE YOUR EXO SYSTEM.

NOTE: If you are installing EXO SnowBank on the EXO TopShelf skip to step 2.

- A. To extend the arms, first extend the driver-side arm by pulling the pin and swinging it outward until the arm locks into place.
- B. Then pull the pin for the passenger-side arm and extend it until it locks into place.



CAUTION: Keep your fingers away from ALL moving parts!

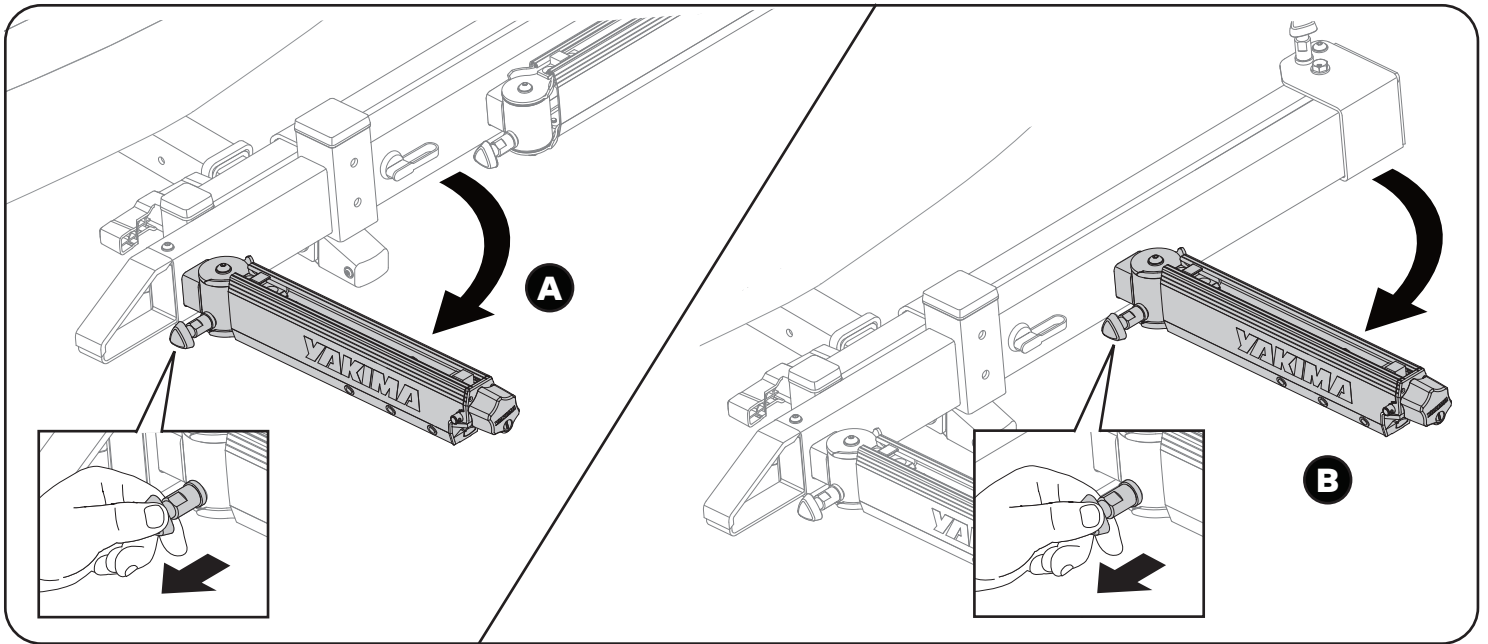

2 LOOSEN THE KNOBS.

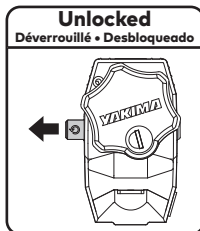
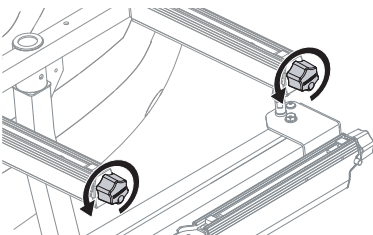

First, push the pin next to the knobs to the unlocked position. Completely loosen the knobs by turning them counter-clockwise until they no longer turn.

2X

3 ATTACH THE SKI MOUNTS TO THE ARMS.

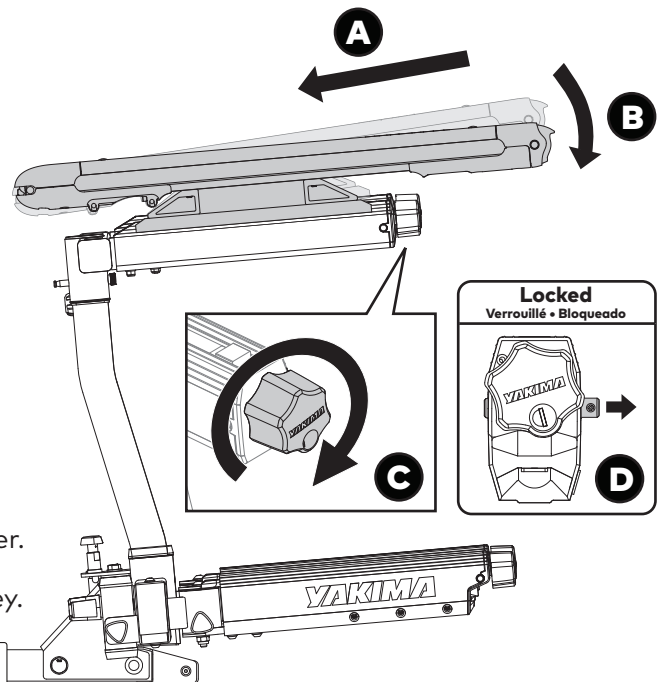

- A. Tilt the rear of the ski mounts slightly as you slide them along the tracks of the arms until they can slide no further.
- B. Lower the front of the ski mounts into the track.
- C. Tighten both knobs completely and lock them with the key.
- D. Then push the pin next to the knobs to locked position.
- E. Verify installation by lifting up on each ski mount.

NOTE: If you wish to install the extra locks that came with your EXO SwingBase™ or EXO TopShelf™ do so now.

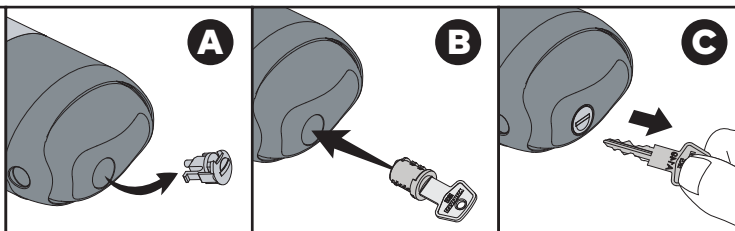

2X

LOADING

1 LOAD YOUR GEAR.

Press the buttons and open the mounts. Load your skis or boards with their bindings between the mounts. Close the mounts with firm pressure. **NOTE:** In some cases you may need to close the mount between your bindings.

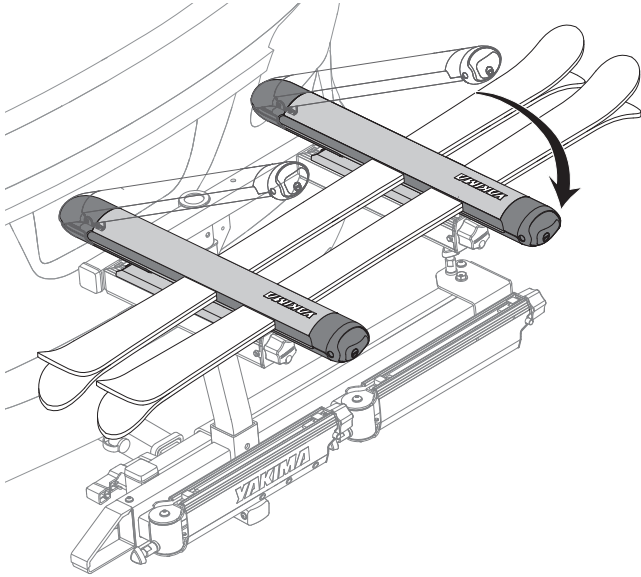

2 VERIFY THAT THE MOUNTS ARE CLOSED.

Verify closure by pulling upward on the skis or boards to see if the mounts open. If they open, apply more pressure when closing the mounts. If you've installed lock cores, use the keys to lock your mounts.

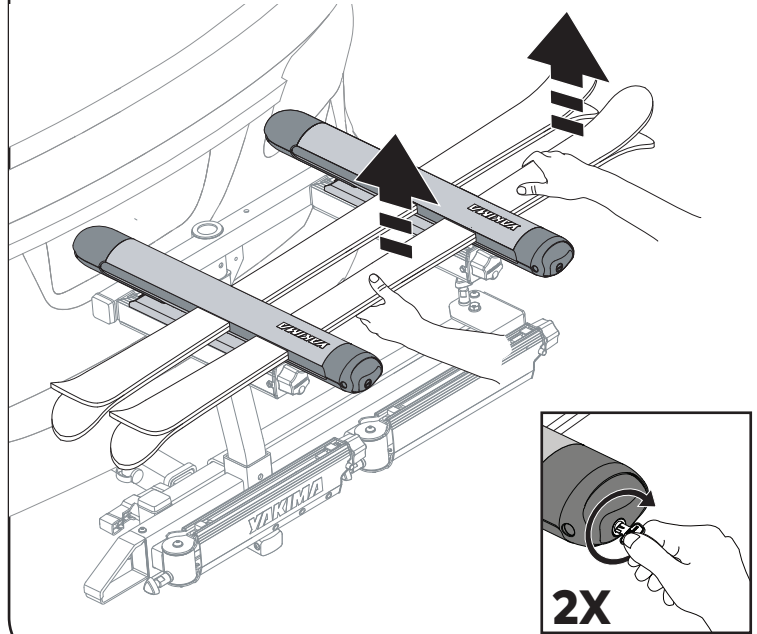

1. Ensure your skis or boards are not extending past your side view mirrors when installed.
2. Use caution when swinging open your EXO system with skis and boards installed, as they could make contact with the passenger side of your vehicle.

REMOVAL

1 REMOVE THE SKI MOUNT.

Unlock and open the mounts by pressing the buttons. Remove your skis or boards. Close the mounts. Set the lock pins to the unlocked position. Then loosen the knobs on the arms completely and lift the mounts off of the arms.

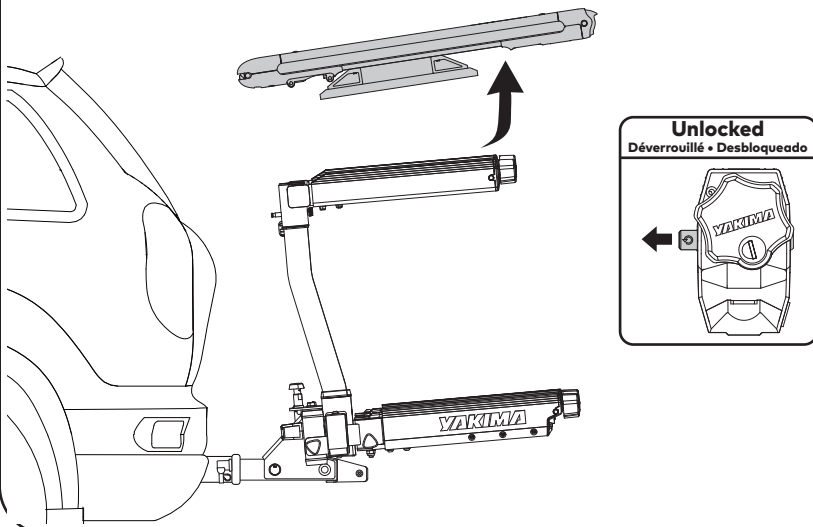

IMPORTANT!

Be sure to read all the warnings and warranty information contained in the insert accompanying these instructions!



IMPORTANT WARNINGS

Rack Installation

Inadequately secured loads and incorrectly mounted roof racks and accessory racks can come loose during travel and cause serious accidents! Therefore, installation, handling and use must be carried out in accordance with product and vehicle instructions.

In addition to these instructions, review the mounting instructions for the roof rack and the operating instructions of the vehicle.

These instructions should be kept together with the vehicle's operating instructions and carried in the vehicle when in use and en route.

For your own safety, you should only use roof racks that are authorized for use with your vehicle.

For roof racks that do not specify the distance between the front and rear crossbars, the distance shall be at least 700 mm or as large as possible. Please note that changes (e.g. additional drill holes) to the accessory rack's attachment system are not permissible.

Check attachment hardware and load for tight fit and function:

- Before the start of any journey.
- After driving a short distance following rack or load install.
- At regular intervals on longer journeys.
- More frequently on rough terrain.
- After interruption of a journey during which the vehicle was left unsupervised (check for damage due to outside intervention).

Rack Loading

Do not exceed the maximum load specified for the roof rack, accessory rack or the maximum load recommended by the vehicle manufacturer.

Max Roof Load = weight of roof rack + weight of accessory racks + weight of load.

Load shall be uniformly distributed with the lowest possible center of gravity.

Load should not substantially extend beyond the loading surface of the roof rack.

Vehicle Driving and Regulations

The speed driven must be suited to the load transported and to official speed limits. In the absence of any speed limits, we recommend a maximum speed of 80 mph (130 km/h).

When transporting any load, the speed of the vehicle must take into account all conditions such as the state of the road, the surface of the road, traffic conditions, wind, etc. Vehicle handling, cornering, braking and sensitivity to side winds will change with the addition of roof top loads.

If this product is off-road certified, it is designed and intended to be used on forest service roads, access roads or other non-technical terrains at moderate speeds. It is not to be used while rock-crawling, jumping, bogging, or other technical off-road terrains. When using off-road certified products with non-off-road certified products, always follow the warnings and restrictions stated in the non-off-road certified product instructions.

Maintenance

The accessory rack should be carefully cleaned and maintained, particularly during the winter months. Use only a solution of water and standard car wash liquid without any alcohol, bleach or ammonium additives.

For reasons of fuel economy and the safety of other road users, the accessory rack and roof rack should be removed when not in use.

Periodically inspect accessory rack for damage. Replace lost, damaged or worn parts. Use only original spare parts obtained from a stocking specialist, dealer or manufacturer.

Any changes made to the roof racks and accessory racks as well as the use of spare parts or accessories other than those supplied by the manufacturer will lead to the lapsing of the manufacturer's warranty and liability for any material damage or accidents. You should observe these instructions to the letter and only use the original parts supplied.

Record Your Key Number:

(located on the set of locking keys)

--	--	--	--