

YAKIMA

BackSwing

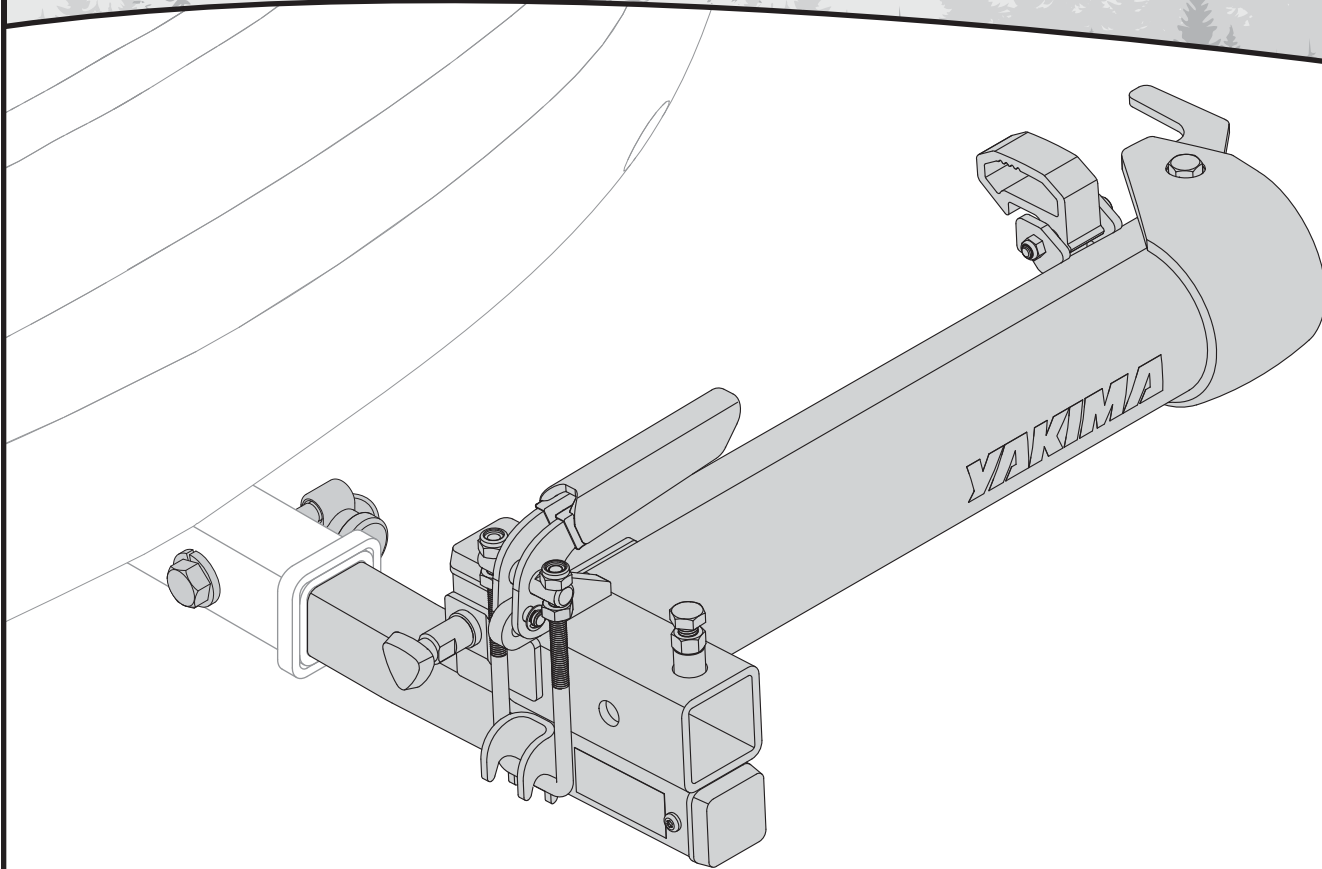

Contents

spring pin (1X)



key (2X)



stabilizer bolt (1X)



hitch bolt (1X)



stabilizer nut (1X)



lock washer (1X)



latch pin (1X)



hitch lock (1X)



BackSwing (1X)

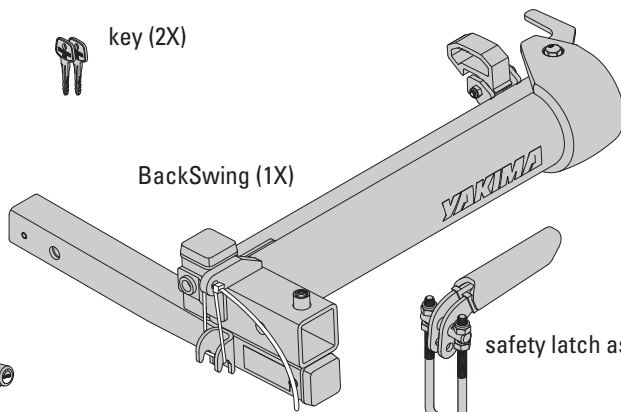

safety latch assembly (1X)



e-clip (2X)



Weight limits

250 lbs. / 113kg

TOOLS REQUIRED:



For use with class III and IV hitch receivers only.



All hardware must be tightened completely. Torque values are given for reference.

INSTALLATION

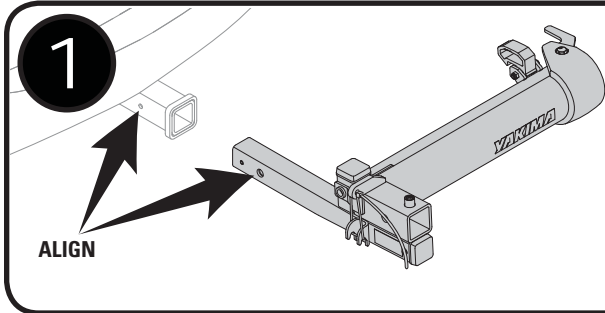

- Insert BackSwing into hitch receiver.
- The BackSwing hole must align to the hole in the hitch receiver.

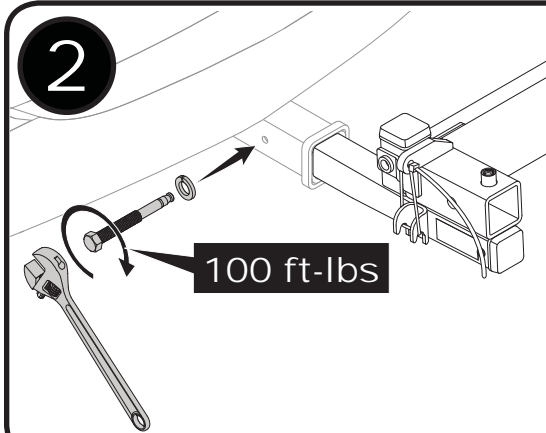

- Install hitch bolt and lock washer.
- Fully tighten with a wrench.

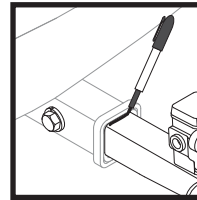

Tip: Use a permanent marker to draw a line on the tongue, so that you know how far to insert the tongue next time you install your carrier.

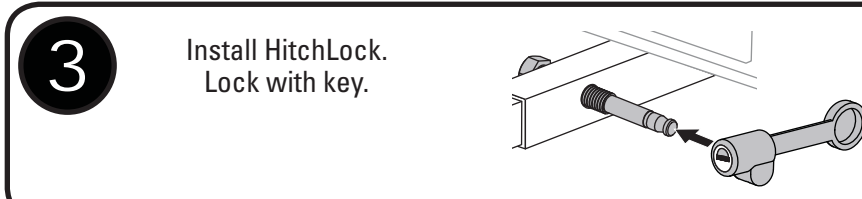

- 4**
- Cut the zip tie.
 - Install spring pin with a wrench.

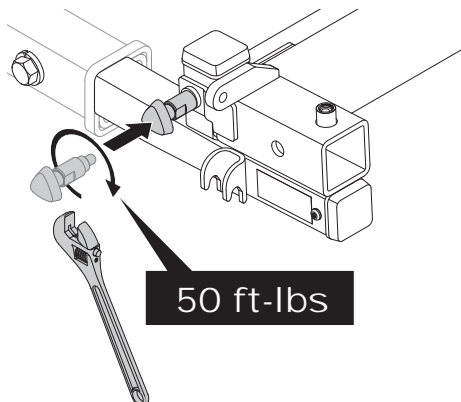
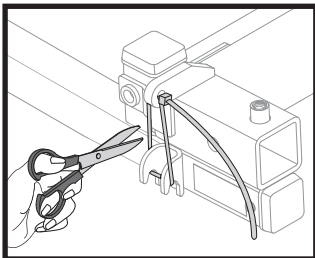

- 5**
- Orient the latch as shown, and align the latch and BackSwing.
 - Insert the latch pin.
 - Secure with the e-clip clip. Note: the second clip is a spare.

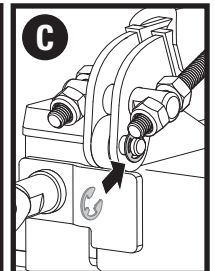
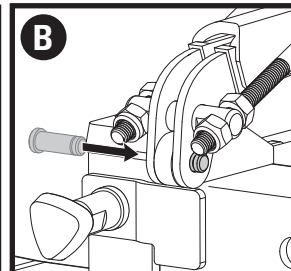
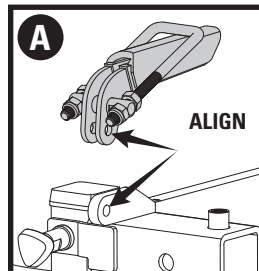

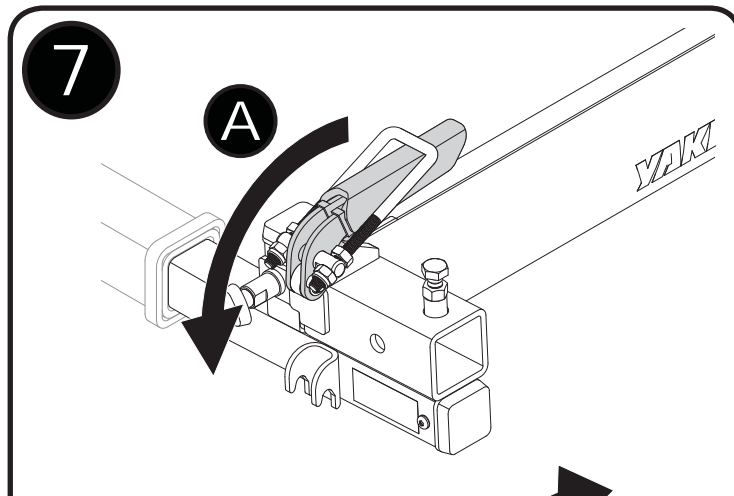
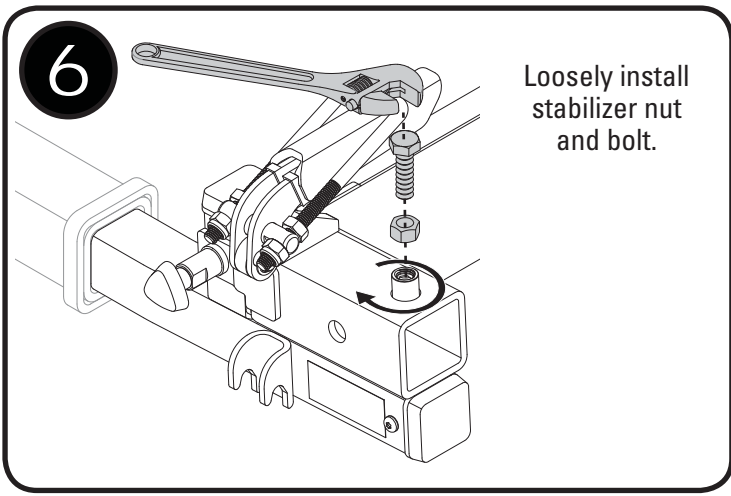

Always close the latch. There should be no gap at the point indicated below when the latch is closed. If a gap exists, see page 6 for instructions to tighten safety latch.

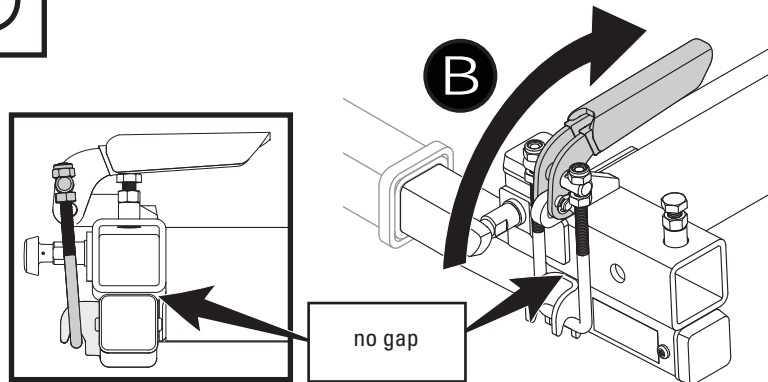

Use caution when closing the latch to avoid hooking the bottom of the latch bracket.

INSTALL PRODUCT

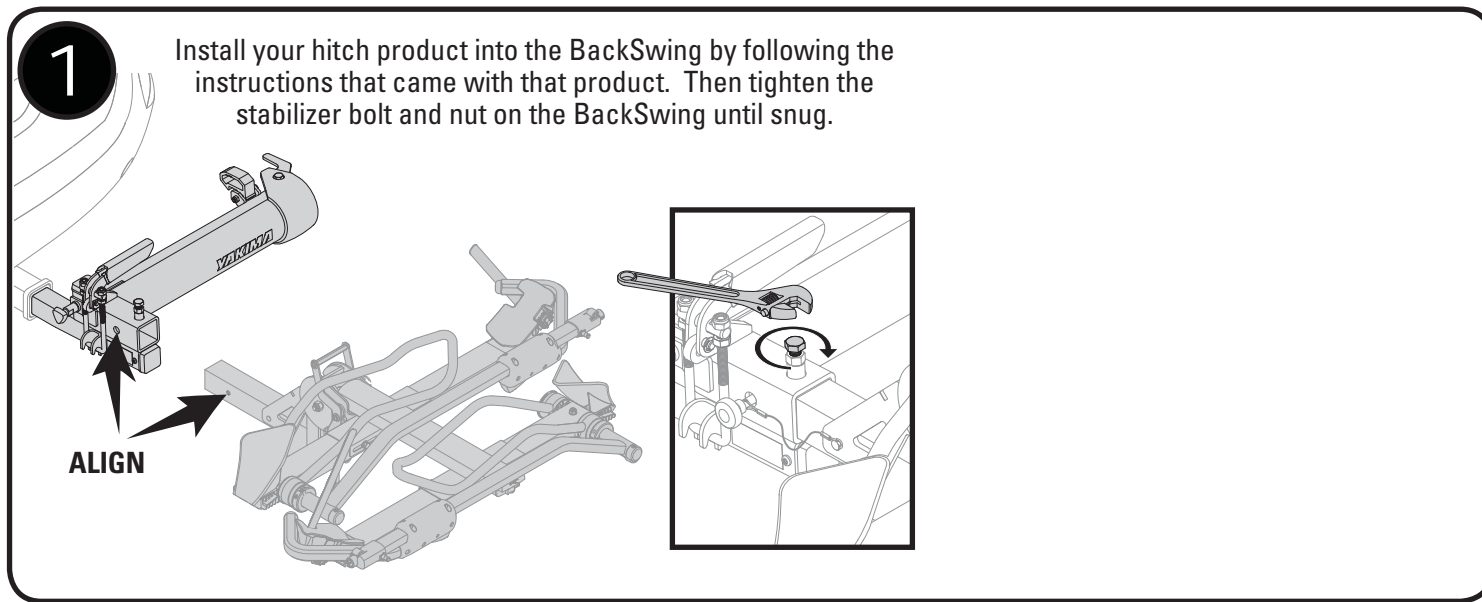

OPERATION

1

To open BackSwing.

- A. Lift lever to release.
- B. Open the latch.
- C. Pull Spring Pin.
- D. Swing open BackSwing until it locks open. Listen for a click.

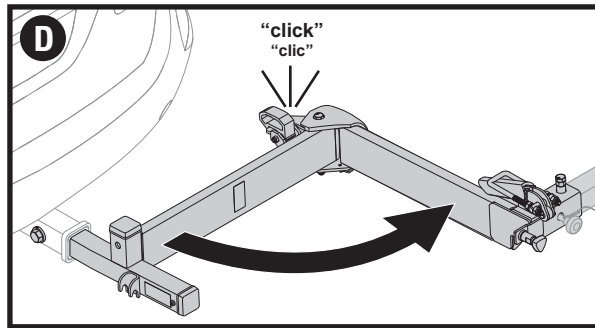
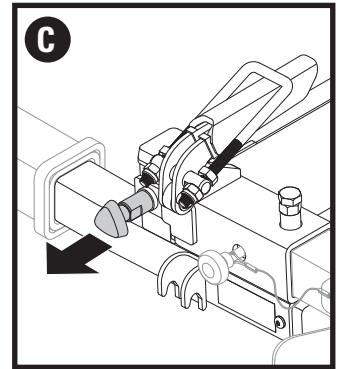
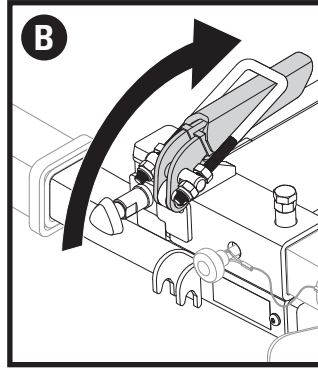
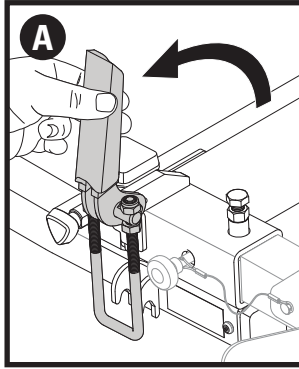

Note: BackSwing will operate more smoothly when parked on a level surface.

2

To close BackSwing. Pour fermer le BackSwing. To close BackSwing.

- A. Stand on the outside of the BackSwing to stay clear of your gear and the BackSwing.
- B. Lift the release lever.
- C. Swing the BackSwing until it closes, and the spring pin locks into place.
- D. Close the latch.

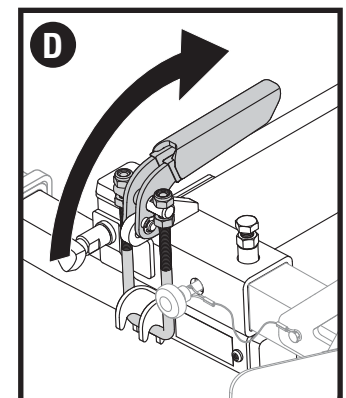
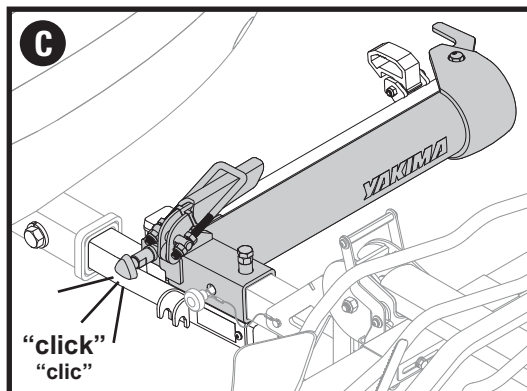
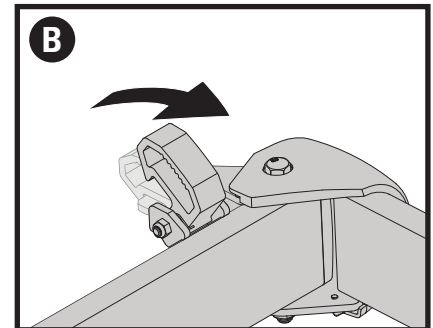
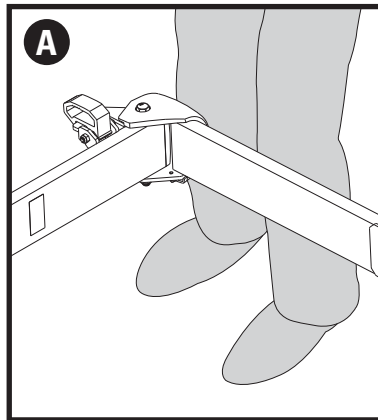

Note: Release lever will be more difficult to operate when the product is heavily loaded.



Latch must always be closed for safe transport.

IMPORTANT WARNINGS



BACKSWING IS LIMITED TO A 250 LBS. TOTAL LOAD.

This product is designed for use with 2" dedicated hitch bike racks and baskets. Yakima cannot test all possible hitch product variations and therefore cannot guarantee all products will work with the BackSwing. Any rack or basket used with this product that has not been tested is considered "use at your own risk".

- Use product as directed. Failure to use as directed will void warranty.
- Do not use with RVs or trailers.
- Do not use with a hitch-extender.
- Be aware that the hot exhaust from your vehicle has the potential to heat metal parts.
- Do not use with a 1-1/4" hitch adapter.
- Remove BackSwing when not in use.
- Vehicles with a rear axle to hitch pin hole distance of greater than 50" cannot use this product (Sprinter vans of 144" wheelbase and shorter only!).
- Do not install if spare tire causes interference with bikes, or folded carrier.
- Full size trucks and SUVs wider than 81 inches: bike tires, handles, bikes, or folded hitch products may come into contact with vehicle.
- Do not use with other swing away hitch products.
- Check vehicle ground clearance before use.
- Do not overload your existing hitch product. Consult the instructions for your existing hitch product for weight limits.
- Latch must always be closed for safe transport.
- Do not grab the product by any actuation levers.
- Do not position bicycle tires near vehicle's hot exhaust.
- Do not use an automated car wash with carrier installed.
- Do not step on BackSwing or attached rack.
- Keep in mind the added distance from your hitch will amplify deflection. Please drive accordingly.
- Never drive off-road with BackSwing installed (well maintained gravel roads are permitted).

ADJUST SAFETY LATCH

If necessary adjust safety latch. First loosen the bottom nuts, then adjust the top nuts equally until there's no gap at the point indicated at right when the latch is closed, then re-tighten the bottom nuts.

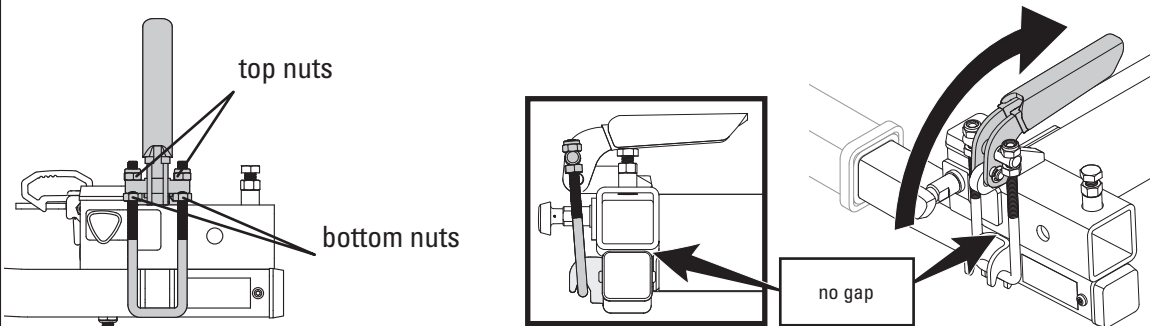

REMOVAL

1. Ensure safety latch is closed.
2. Loosen the stabilizer bolt, and uninstall any hitch product you may have installed in your BackSwing (refer to that product's instruction manual).
3. Unlock and remove hitch lock.
4. Remove hitch bolt and lock washer.
5. Remove BackSwing from your hitch.