

Contents • Contenu • Contenido

Load Stop (4X)

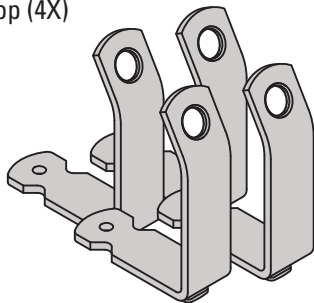

M8 flat washer (4X)

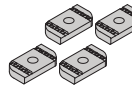

M8 thick nut plate (4X)



knob (4X)

pad (4X)

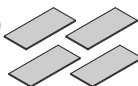

M8 thin nut plate (4X)

Capacity

HD Truck - 250 lbs (113 kg), JetStream/HD Bar roof rack - up to 220 lbs, (100 kg) FlushBar/RailBar - up to 165 lbs (75 kg)

Compatibility

Most crossbars and platforms with t-slot

1

Apply pads. Apply a pad in the location shown to each Load Stop bracket.

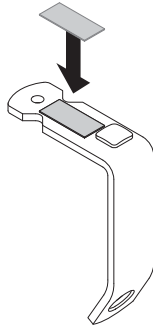

4X

2

Loosely assemble. Assemble the Load Stop as shown. For HD Bars use the thick nut plate. For Jetstream/FlushBar/RailBar use the thin nut plate.

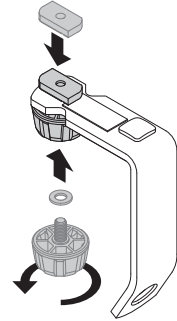

4X

3

Slide Load Stop into crossbar. Slide 2 Load Stops into the t-slot so they face each other as shown. If necessary remove end caps or tower covers, and replace once Load Stops are in place.

For HD Bar only: Remove the topside infill before installing Load Stop.

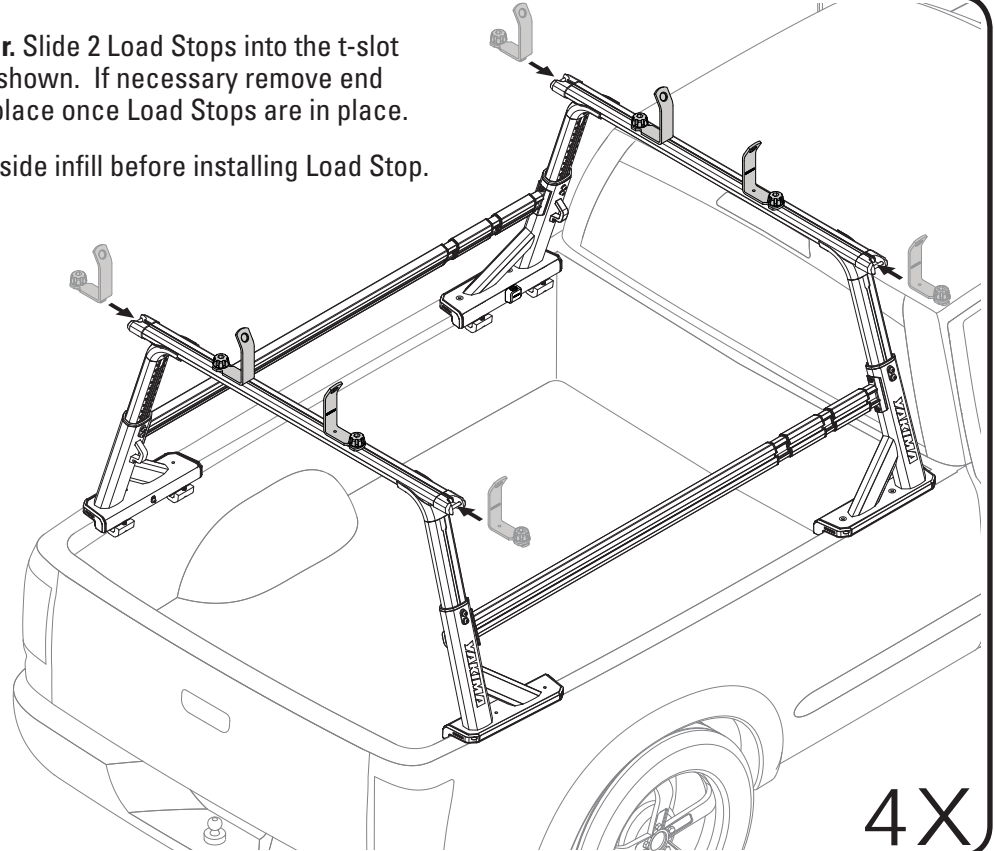

4X

4

Position and tighten. Position Load Stop and fully tighten knobs to 2.7 Nm.

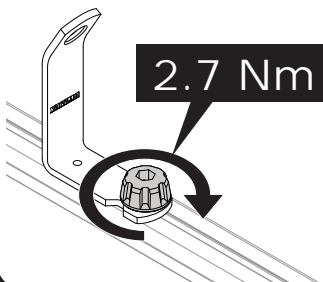

4X

Optional: If you don't plan to move your Load Stops you can remove and cut the top infill to fit around the Load Stops. Otherwise you may want to remove it to allow for free movement of the Load Stops.

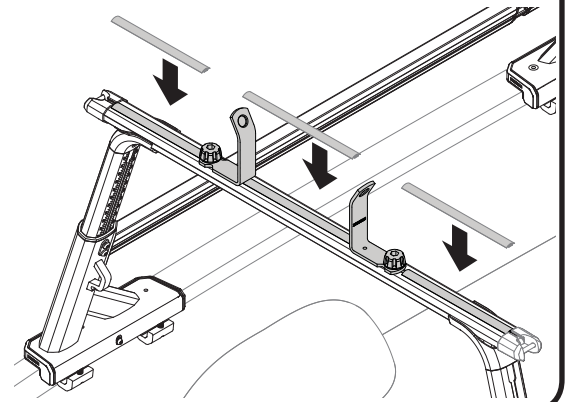

LOADING

1

- Loosen and move Load Stops to clear space for your load.
- Load gear being sure the gear is balanced front to back over your crossbars.
- Move Load Stops against gear, and tighten knobs to 2.7 Nm.

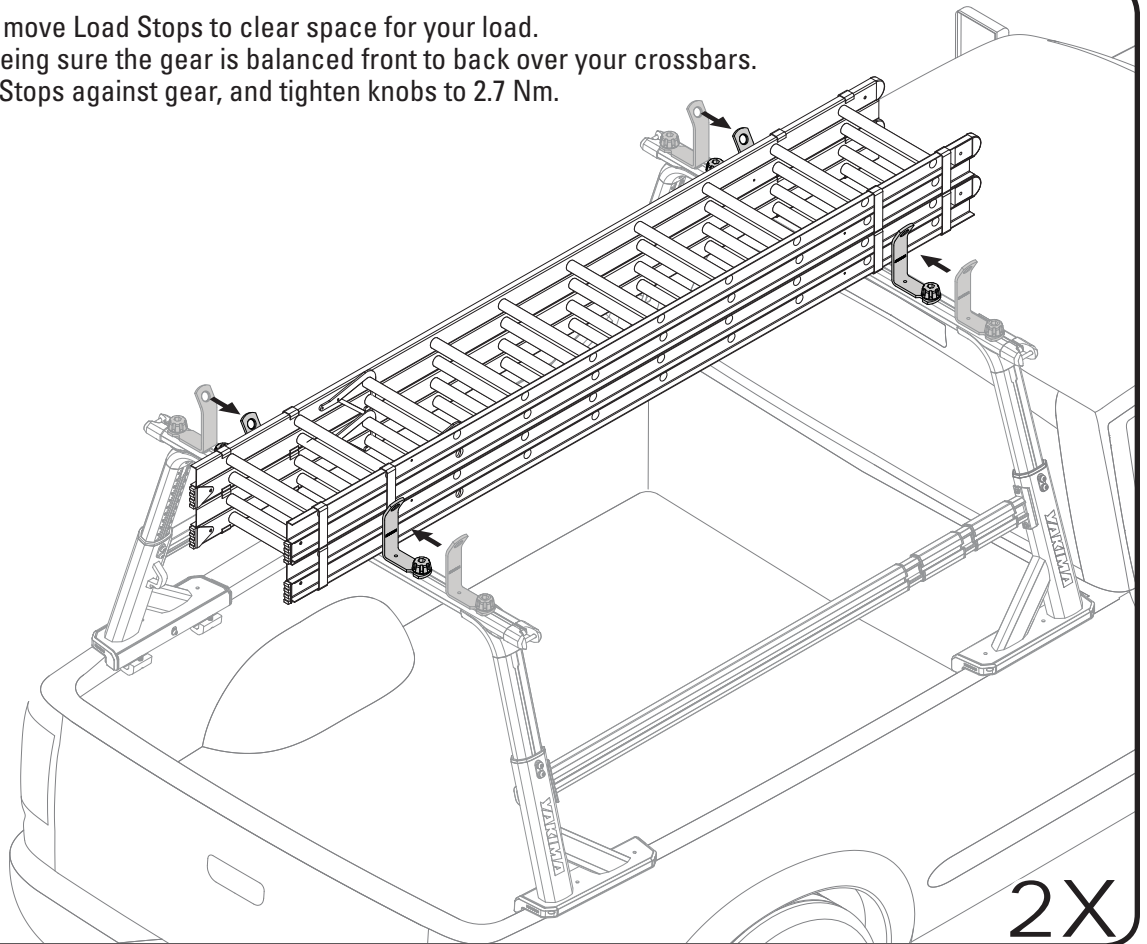

2

Secure Load. Secure your load to the bar or to the eye holes in the Load Stop. We recommend using HD Hook Straps (sold separately).

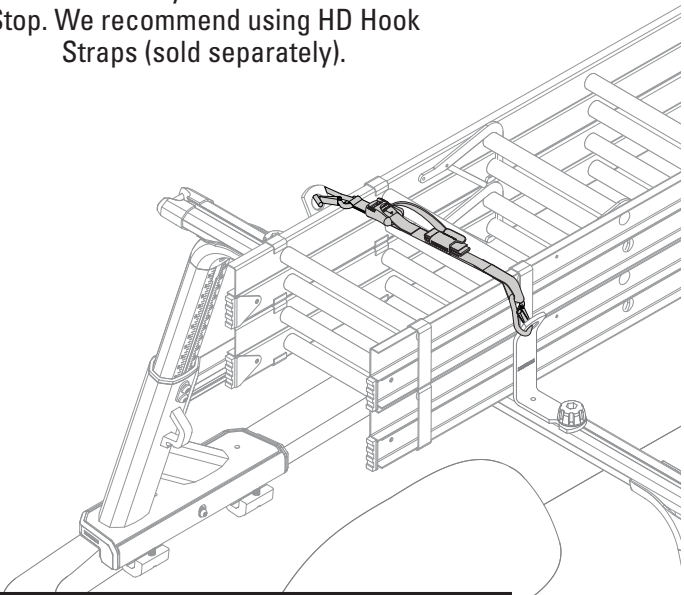

Attach a safety flag when carrying long loads.

2X

3

Verify that load is secure. Check that the load is secure with no side to side movement. Repeat steps 1 and 2 if necessary.

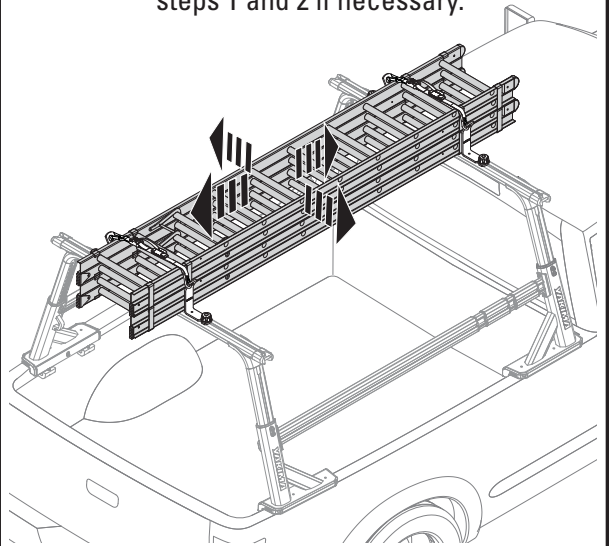

REMOVAL

1. Loosen the knobs and remove end caps or tower covers if necessary.
2. Slide Load Stop out of the crossbar.
3. Replace end caps or tower covers if removed.

EN IMPORTANT WARNINGS

Rack Installation

Inadequately secured loads and incorrectly mounted roof racks and accessory racks can come loose during travel and cause serious accidents! Therefore, installation, handling and use must be carried out in accordance with product and vehicle instructions.

In addition to these instructions, review the mounting instructions for the roof rack and the operating instructions of the vehicle.

These instructions should be kept together with the vehicle's operating instructions and carried in the vehicle when in use and en route.

For your own safety, you should only use roof racks that are authorized for use with your vehicle.

For roof racks that do not specify the distance between the front and rear crossbars, the distance shall be at least 700 mm or as large as possible. Please note that changes (e.g. additional drill holes) to the accessory rack's attachment system are not permissible.

Check attachment hardware and load for tight fit and function:

- Before the start of any journey.
- After driving a short distance following rack or load install.
- At regular intervals on longer journeys.
- More frequently on rough terrain.
- After interruption of a journey during which the vehicle was left unsupervised (check for damage due to outside intervention).

Rack Loading

Do not exceed the maximum load specified for the roof rack, accessory rack or the maximum load recommended by the vehicle manufacturer.

Max Roof Load = weight of roof rack + weight of accessory racks + weight of load.

Load shall be uniformly distributed with the lowest possible center of gravity.

Load should not substantially extend beyond the loading surface of the roof rack.

Vehicle Driving and Regulations

The speed driven must be suited to the load transported and to official speed limits. In the absence of any speed limits, we recommend a maximum speed of 80 mph (130 km/h).

When transporting any load, the speed of the vehicle must take into account all conditions such as the state of the road, the surface of the road, traffic conditions, wind, etc. Vehicle handling, cornering, braking and sensitivity to side winds will change with the addition of roof top loads.

If this product is off-road certified, it is designed and intended to be used on forest service roads, access roads or other non-technical terrains at moderate speeds. It is not to be used while rock-crawling, jumping, bogging, or other technical off-road terrains. When using off-road certified products with non-off-road certified products, always follow the warnings and restrictions stated in the non-off-road certified product instructions.

Maintenance

The accessory rack should be carefully cleaned and maintained, particularly during the winter months. Use only a solution of water and standard car wash liquid without any alcohol, bleach or ammonium additives.

For reasons of fuel economy and the safety of other road users, the accessory rack and roof rack should be removed when not in use.

Periodically inspect accessory rack for damage. Replace lost, damaged or worn parts. Use only original spare parts obtained from a stocking specialist, dealer or manufacturer.

Any changes made to the roof racks and accessory racks as well as the use of spare parts or accessories other than those supplied by the manufacturer will lead to the lapsing of the manufacturer's warranty and liability for any material damage or accidents. You should observe these instructions to the letter and only use the original parts supplied.