

HARDWARE



bolt (4X)



washer (4X)



center punch (2X)

Use only the approved hardware included with this kit.

INCLUDED TOOLS



silicone (1X)



hex wrench (1X)

REQUIRED TOOLS

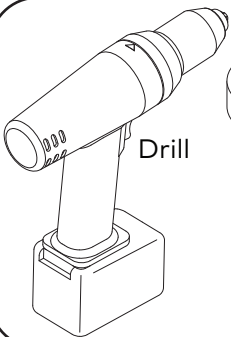

Drill

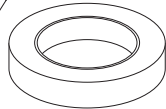

masking tape

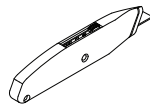

utility knife

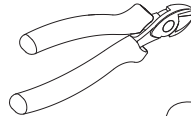

diagonal cutter



3/8" Drill Bit



tape measure



Pen

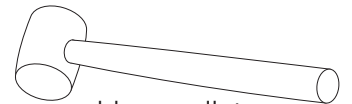

rubber mallet



REFER TO YAKIMA SKYLINE OR CONTROL TOWER INSTRUCTIONS FOR IMPORTANT WARNING AND LOAD LIMITATIONS, AND YAKIMA'S LIMITED WARRANTY.

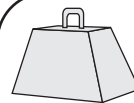

Landing Pad 24 has a load limit of 165 lbs. (75 kg) or 220 lbs. (100 kg) when paired with Yakima HD Bars.





If installing Landing Pad™ 24 with Yakima LockNLoad™ Platform size B direct to tower, it will require Pivot Mounts (mounting blocks) with two mounting locations for the U-bracket.

IMPORTANT WARNING! It is critical that all Yakima racks and accessories be properly and securely attached to your vehicle. Improper attachment could result in an automobile accident, and could cause serious bodily injury or death to you or to others. You are responsible for securing the racks and accessories to your car, checking the attachments prior to use, and periodically inspecting the products for adjustment, wear, and damage. Therefore, you must read and understand all of the instructions and cautions supplied with your Yakima product prior to installation or use. If you do not understand all of the instructions and cautions, or if you have no mechanical experience and are not thoroughly familiar with the installation procedures, you should have the product installed by a professional installer such as a qualified rack specialty installer or auto body shop.

1 REMOVE THE WEATHER STRIPPING FROM THE DRIVER'S SIDE.

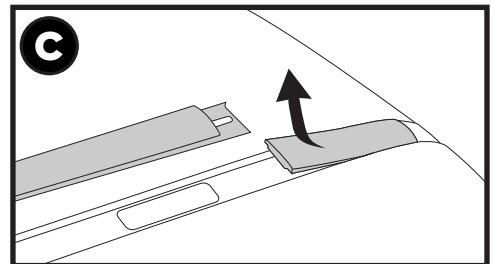
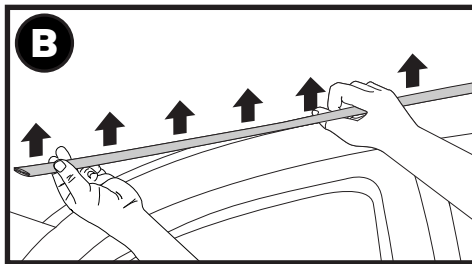
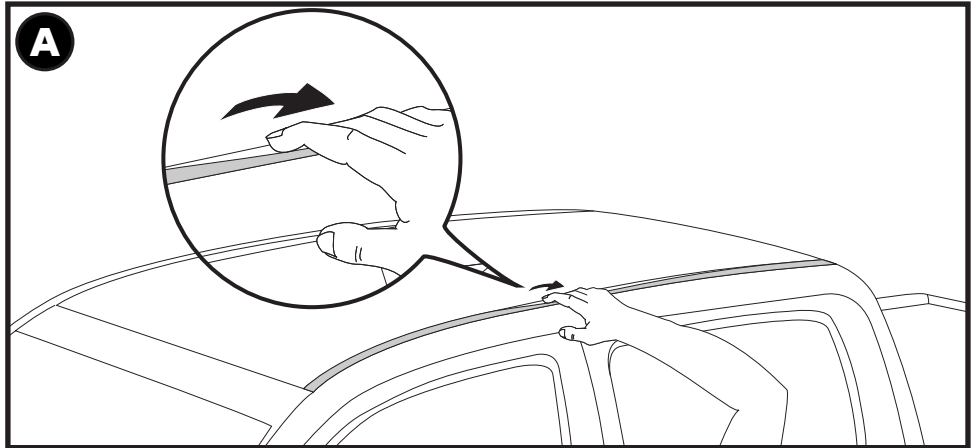
- A.** Grasp the weather-stripping at the location above where the doors meet and roll it towards you to begin to gently pry it up. Do not bend or deform the weather-stripping more than necessary.
- B.** Work your way toward the windshield until the front-end of the weather-stripping is free.
- C.** Now gently work your way back to the rear-end of the weather-stripping. You will encounter a section that is secured by an adhesive. Be careful not to bend or deform the weather-stripping more than necessary as you pull to free the weather-stripping from the adhesive. At the end of the weather-stripping you will need to pry up the end piece in order to completely remove the weather-stripping from the vehicle. Set the weather-stripping aside.



 At the ends of the ditch molding, use caution to not disturb any factory applied anchors for the weather-stripping.

2 LOCATE THE MOUNTING POINTS.

- Locate the factory applied sealing-tape near the front and rear of the ditch as shown in the image.
- Use your finger to feel for the holes beneath the sealing-tape.
- Use the image as a guide to find and identify the correct mounting point (hole). You will mark the correct holes in the following step.

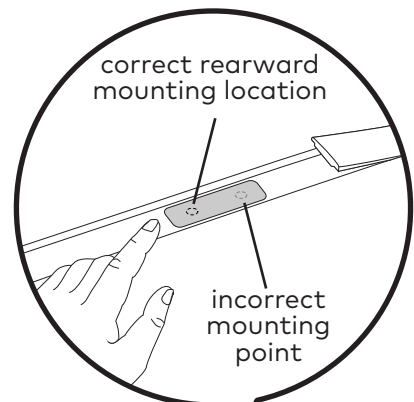
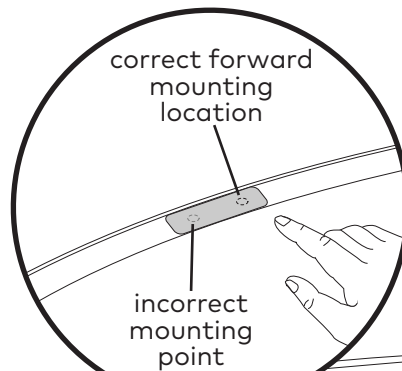

3 APPLY TAPE AND MARK THE CORRECT MOUNTING POINTS.

- Apply masking tape above the mounting points you identified in step 2.
- Use a marker to make a mark on the masking tape that corresponds to the center of the mounting point hole.

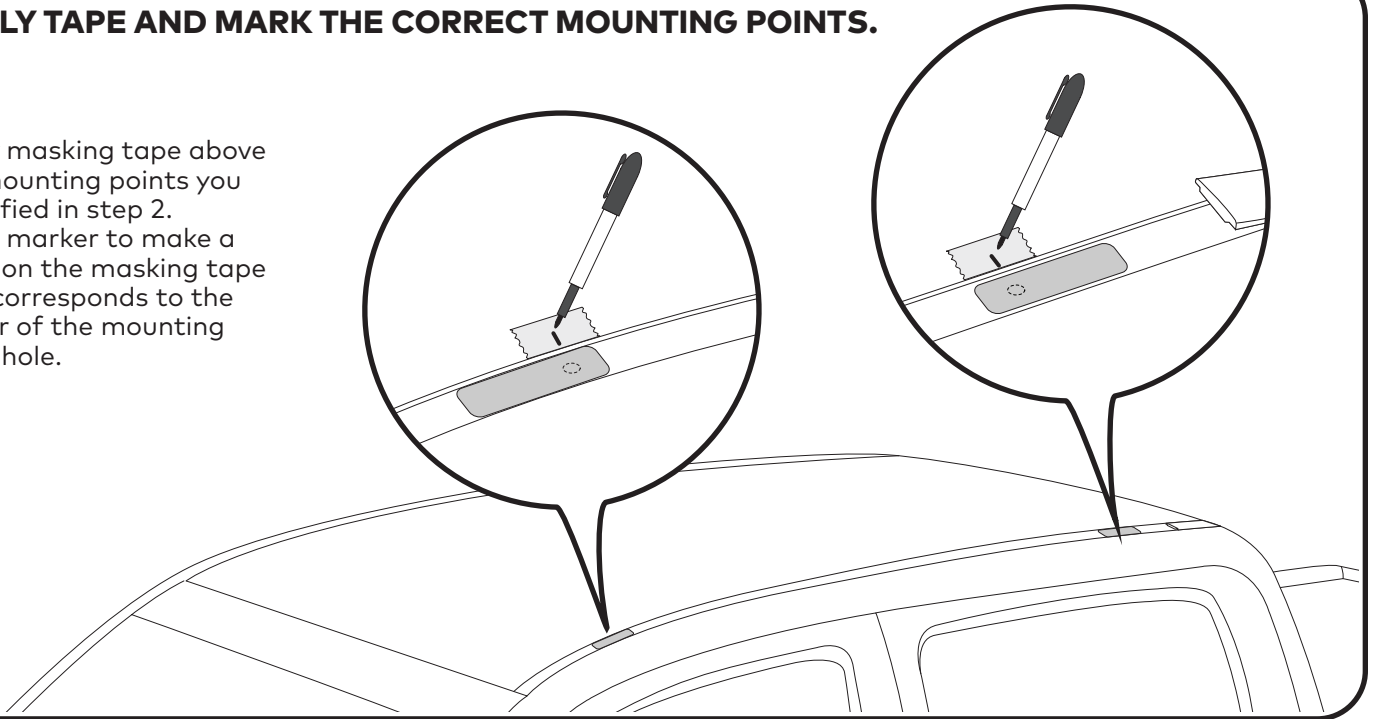

4 APPLY TAPE AND MARK THE WEATHERSTIPPING.

- Carefully align and reinstall the weather-stripping.
- Apply masking tape in the appropriate locations on the weather-stripping to correspond to the marks made in step 3.
- Use a marker to transfer the marks made in step 3 to the masking tape on the weather-stripping.



CAUTION: The weather-stripping must be aligned properly prior to making the marks.

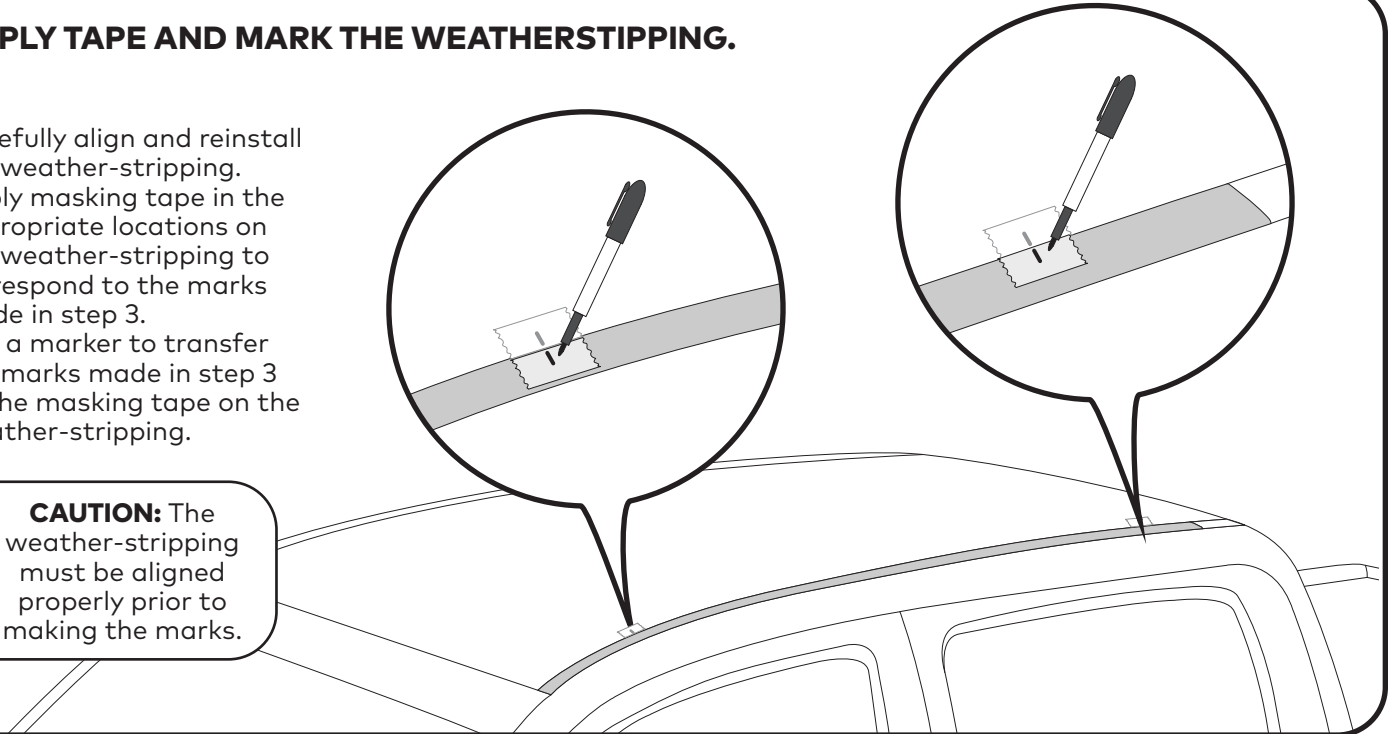

5 MEASURE AND MARK THE WEATHER-STRIPPING.

Measure and mark .5" to the left and .5" to the right of the center marks you made in step 4.

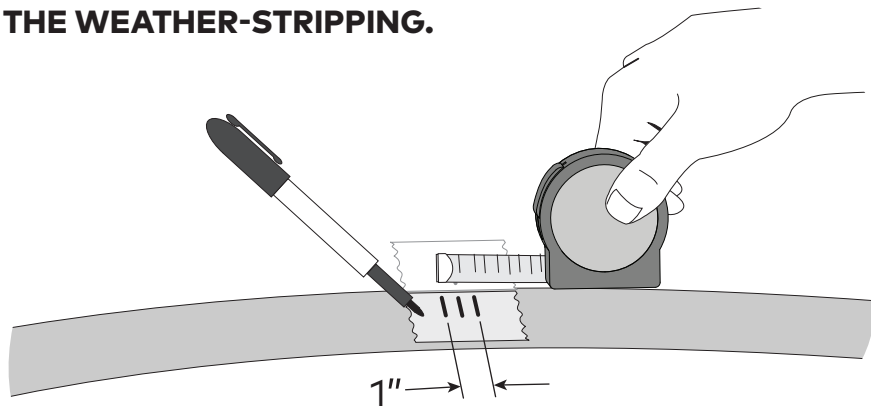

2X

6 TRIM THE UNDERSIDE OF THE WEATHER-STRIPPING.



WARNING: Do not trim the topside of the weather stripping! In this step you must cut away the underside portion of the weather-stripping as directed below.

Use the marks you made on the topside of the weather-stripping in step 5 as a guide and cut away the underside of the weather-stripping as shown.

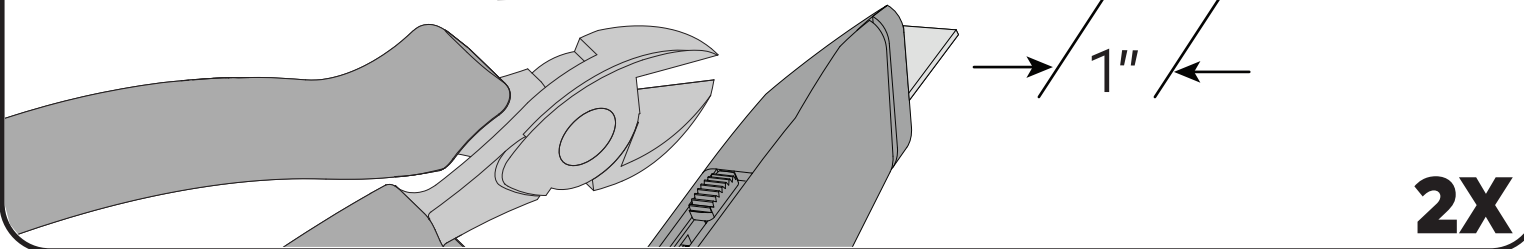

7 INSTALL THE CENTER PUNCH.

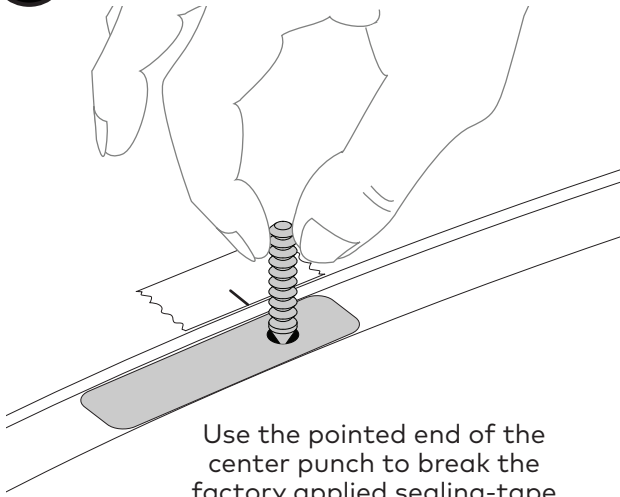

Use the pointed end of the center punch to break the factory applied sealing-tape to reveal the hole beneath the sealing-tape that you identified and marked in step 3.

With the pointed end of the center punch facing upward, screw the center punch into the hole until the point is slightly higher than the roof of the vehicle.

TIP: If threading the center punch is difficult, clean out the threads by threading one of the bolts from this kit in and out a couple of times.

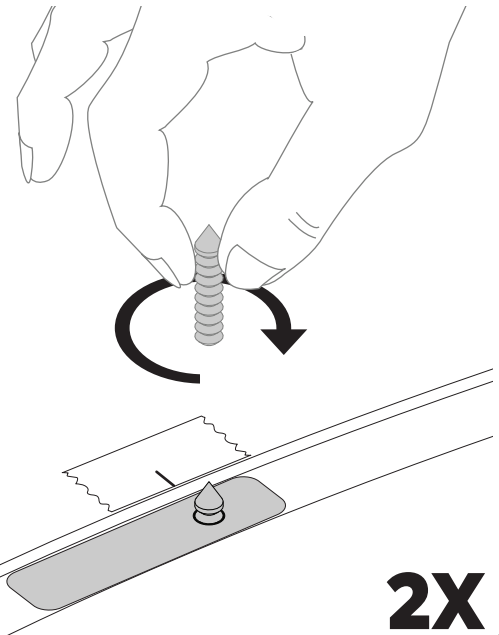

8 MARK THE WEATHER-STRIPPING WITH THE CENTER PUNCH.



CAUTION: Do not damage your vehicle with the mallet.

- Carefully align and reinstall the weather-stripping once again.
- Use a rubber mallet to carefully hit the center punch beneath the weather-stripping.
- Verify that a mark has been made to the underside of the weather-stripping.
- Remove the weather-stripping from the vehicle.

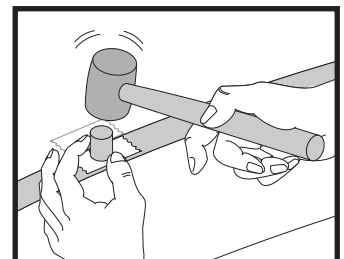
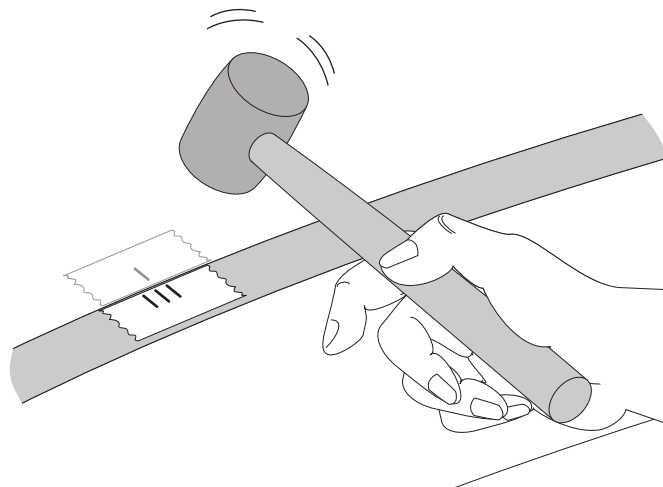

TIP: use a wooden dowel or wood block to help ensure that you do not damage your vehicle.

2X

9 DRILL A HOLE THROUGH THE WEATHER-STRIPPING.

Find the puncture you made in step 8 on the weather-stripping and use a drill to drill a 3/8" hole through the weather-stripping.

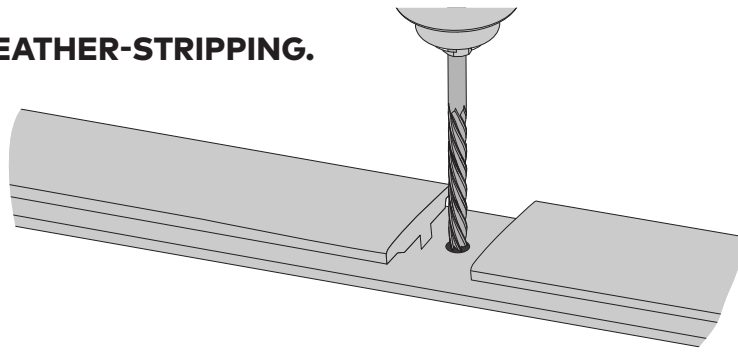

2X

10 APPLY SILICONE TO THE HOLES.



WARNING: If you do not adequately apply the silicone sealant to the holes then water from outside of the vehicle will enter the cab.

- Remove the center punch from the hole.
- Generously apply the silicone into the hole and fill it until it mounds up slightly above the surface.

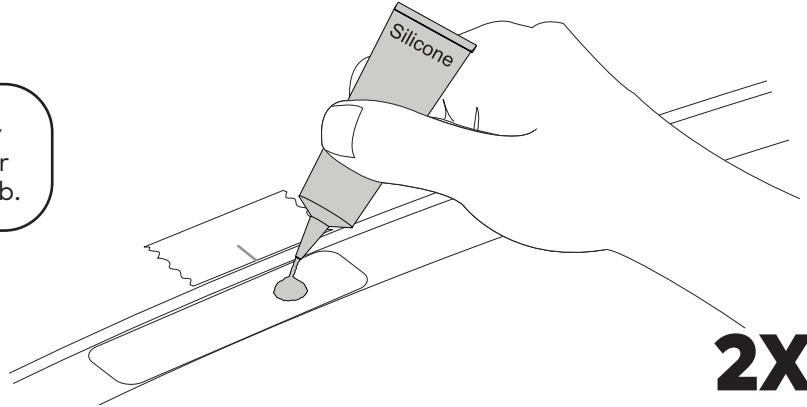

2X

11 INSTALL THE WEATHER-STRIPPING.

- Remove the masking tape you installed in steps 3 and 4 from the weather-stripping and your vehicle.
- Carefully align and install the weather-stripping.
- Press the end piece back into place making sure it is properly seated.

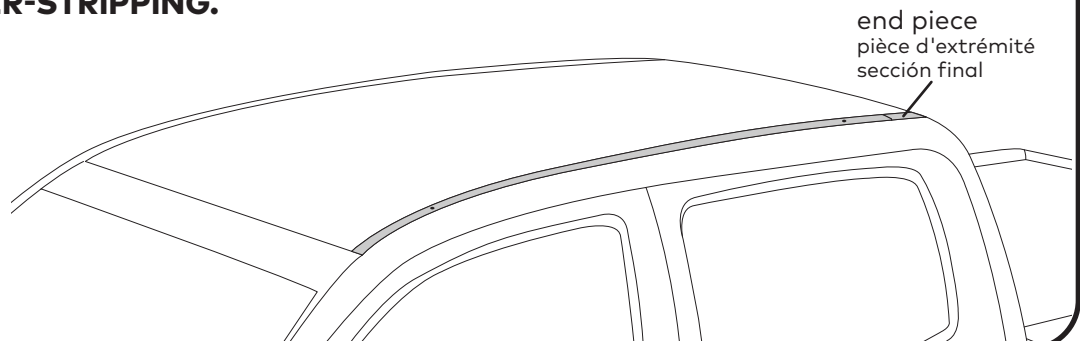

12 INSTALL THE PAD AND BASE.

- Install a pad over the hole in the weather-stripping being sure to orient it as shown.
- Install a base over the pad.

NOTE: You may notice a gap between the pad and the vehicle at the front. This is normal and will vary depending on vehicle.

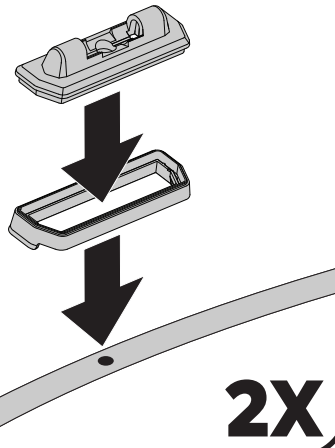

2X

13 INSTALL THE WASHER AND SCREW.

- Use the wrench to install a washer and screw being sure to install the washer convex side down as shown.
- Tighten until snug but do not fully tighten the screw yet.

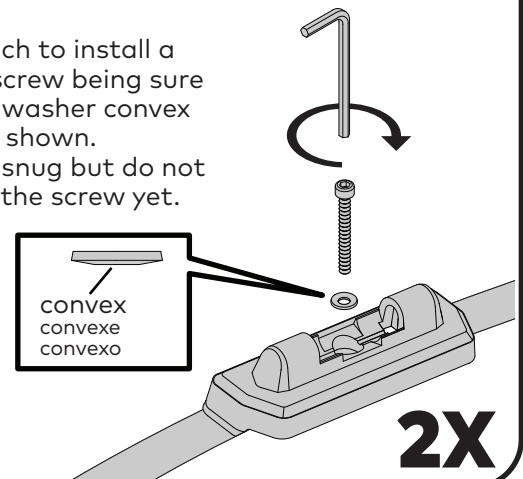

2X

14 REPEAT THE PROCESS FOR THE PASSENGER SIDE.

Use steps 1 through 13 as a guide to modify the passenger side weather-stripping and install the landing pads in the same manner that you just performed for the driver side.

15 ADJUST LANDING PAD POSITIONS THEN TIGHTEN THEM DOWN.

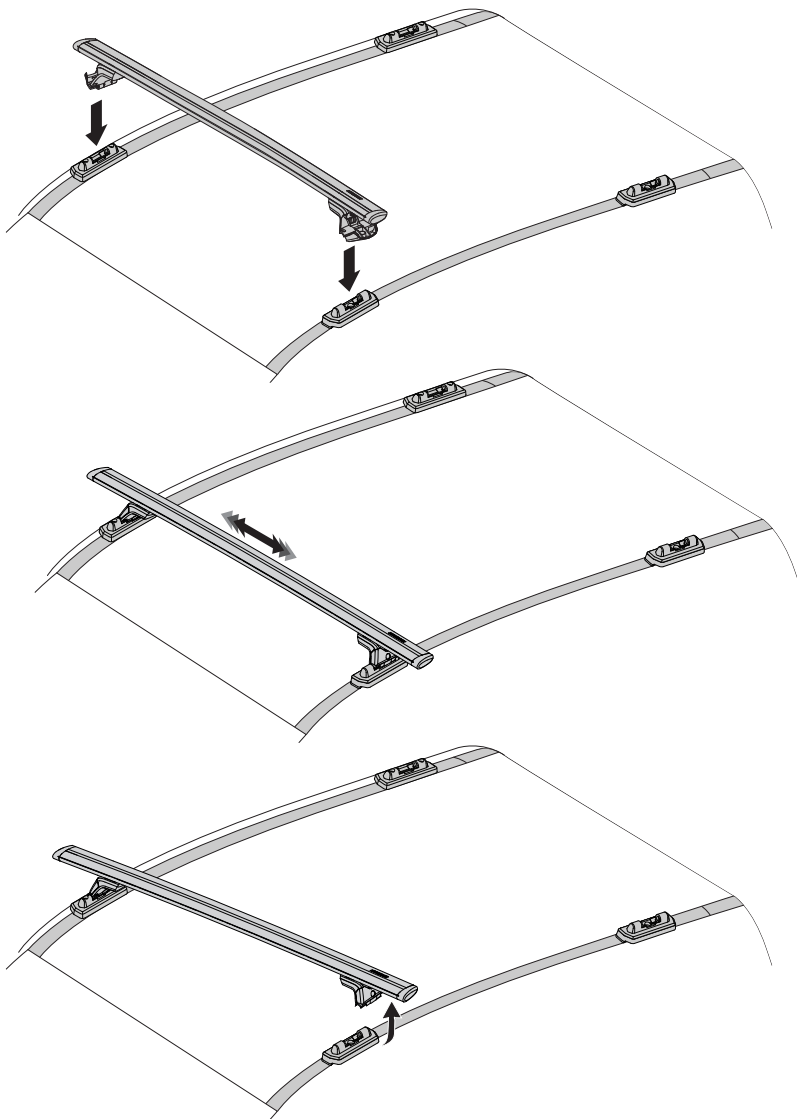

- Using your tower instructions as a reference, carefully place an assembled crossbar with towers onto the Landing Pads.
- Align the position of the Landing Pads to allow your SkyLine or Control Towers to fully close.
- Center the crossbar and fully torque your SkyLine or Control towers to the crossbars according to the tower instructions.
- Open one SkyLine or Control Tower cover and lift it up while the opposite tower is still engaged.
- While holding the SkyLine or Control Tower above the Landing Pad fully tighten the Landing Pad with the long handle of wrench as shown to 1.5 Nm.
- Repeat the process again for the other Landing Pads to ensure they have not changed position.
- Re-insert the SkyLine or Control Tower into the Landing Pad, fully tighten the tower (refer to tower instructions) and close the cover.

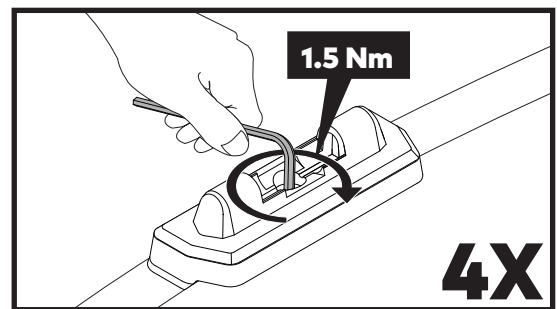

If you are installing Yakima LockNLoad platform ensure your left and right landing pads are installed parallel to one another

16 INSTALL COVERS WHEN RACK IS NOT ATTACHED.

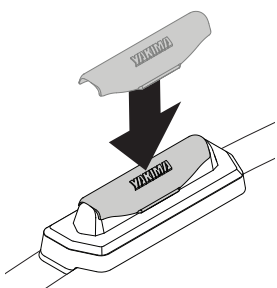

Using the covers will help keep the bases free of debris.

4X

17



READ THESE WARNINGS!

- Make sure your SkyLine or Control Towers, with bars installed, seat completely with the Landing Pad. If they do not seat properly, repeat step 15.
- Be sure all the hardware is secured according to instructions. Failure to perform safety checks before driving away can result in property damage, personal injury, or death.
- Attachment hardware can loosen over time. Check and tighten, if necessary, before each use.
- The Landing Pad top must remain installed at all times to assist in keeping the weather-stripping in position.



**DO NOT EXCEED
MAXIMUM WEIGHT LIMIT
FOR YOUR VEHICLE.**