

NOTE: CROSSBAR SPREAD IS FIXED.

## CONTENTS

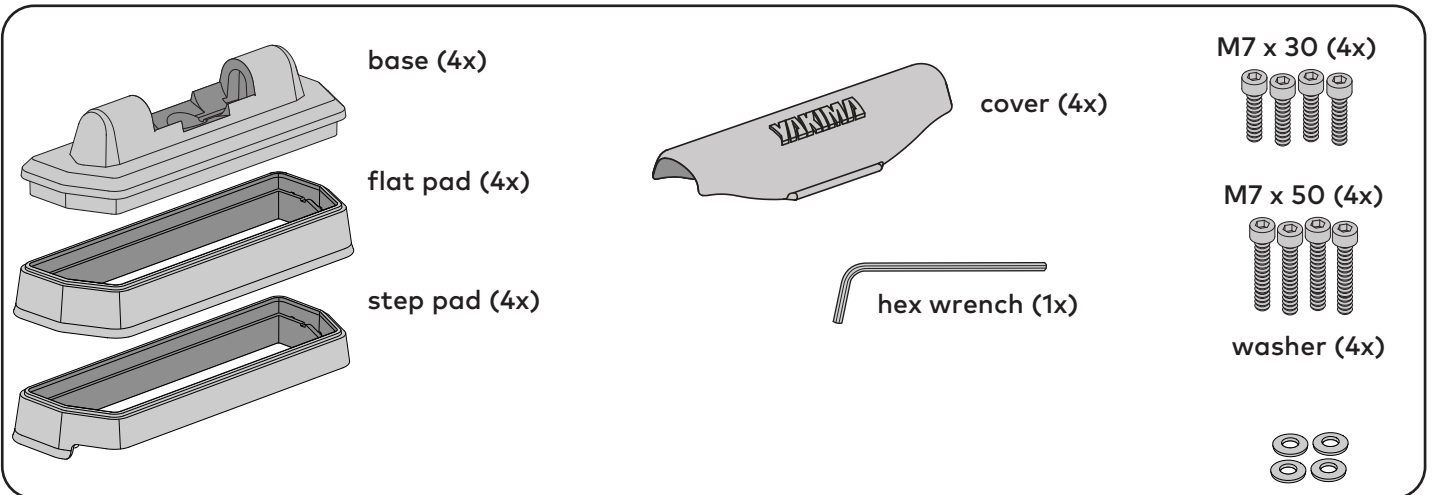

base (4x)

flat pad (4x)

step pad (4x)

cover (4x)

hex wrench (1x)

M7 x 30 (4x)

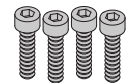

M7 x 50 (4x)



washer (4x)



REFER TO YAKIMA SKYLINE OR CONTROL TOWER INSTRUCTIONS FOR IMPORTANT WARNING AND LOAD LIMITATIONS, AND YAKIMA'S LIMITED WARRANTY.



Landing Pad 25 has a load limit of 165 lbs. (75 kg) or 220 lbs. (100 kg) when paired with Yakima HD Bars.

First look up your vehicle online at [yakimatech.com](http://yakimatech.com). You will find hardware and base pads specific to your vehicle listed in the measurements section or fit notes section. These will be the parts used for installation. Use this worksheet to check off which are required for your vehicle.

HARDWARE		PADS	
<input type="checkbox"/>	 M7 X 30mm hardware	<input type="checkbox"/>	 stepped pad
<input type="checkbox"/>	 M7 X 50mm hardware	<input type="checkbox"/>	 flat pad

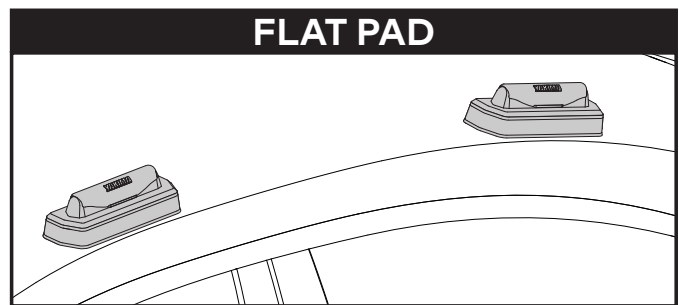
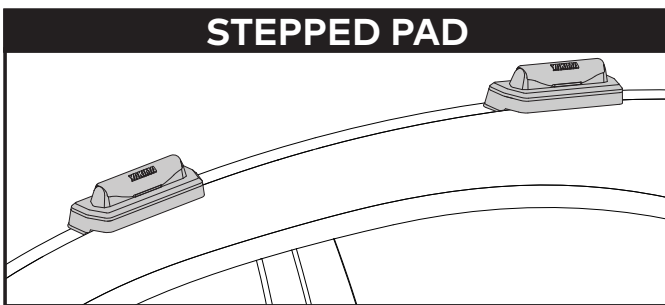

**1** Thoroughly clean your vehicle's roof.

**2** Open the cover-plates. Consult your vehicle's owner's manual to determine how your cover plates are opened or removed. This will vary from vehicle to vehicle.

**4X**

**3** Prepare threads.

Be sure the threads are clear of paint by carefully threading your fastener in and out of the hole a few times while blowing away any debris that accumulates.

**NOTE:** If there are multiple holes in the front pocket, use the forward-most holes. Use the rear-most in the rear pockets to gain maximum crossbar spread.

**NOTE:** Some vehicles have a plug in the threads which must be removed.

**4X**

**4****Install pads to bases.**

Attach each pad to each base.

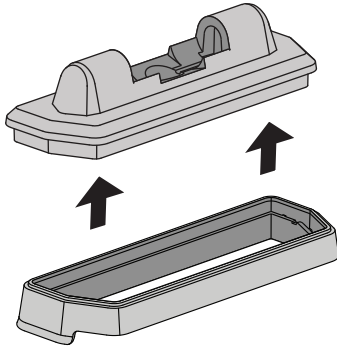
**4X****Attach Landing Pads using your vehicles specific hardware identified on page 2. (steps 5 through 8)****5****Place Landing Pad over each roof pocket making sure arrows face away from the middle of your vehicle.**

BE SURE TO USE  
THE CORRECT PADS  
AND HARDWARE  
TO AVOID VEHICLE  
DAMAGE!

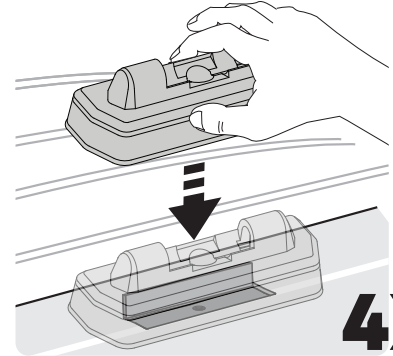
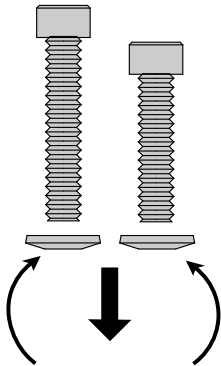
**4X****6****Install the metal washer on each bolt with the concave side facing up.**Concave side up. **4X****7****Using the 5mm hex wrench, guide fastener with washer through Landing Pad, and into the threaded mounting point in the roof.**

DO NOT ALLOW EDGES  
OF PAD TO CURL  
UNDER!

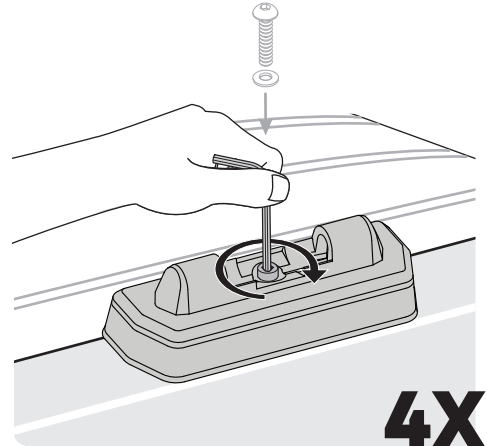
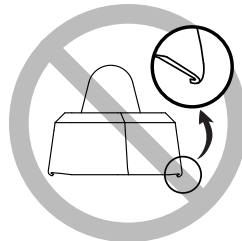
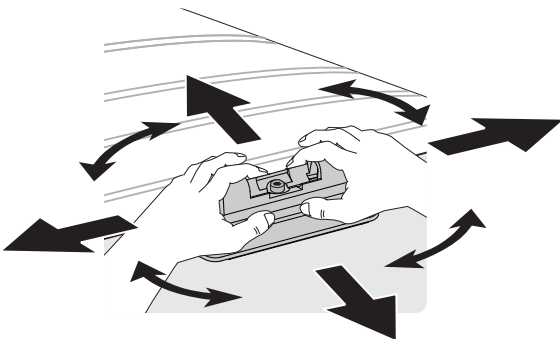
**4X****8****Jostle and rotate Landing Pad in all directions to ensure it is snug, but also allows a small amount of adjustment to prepare for final alignment and tightening in steps 9 through X.****Adjust landing pad positions then tighten them down. (steps 9 through 12)****9****Using your SkyLine or Control Tower instruction as a reference, carefully place a bar and towers assembly onto the landing pads.**

Align position of  
Landing Pads to  
allow SkyLine or  
Control Towers to  
fully close.

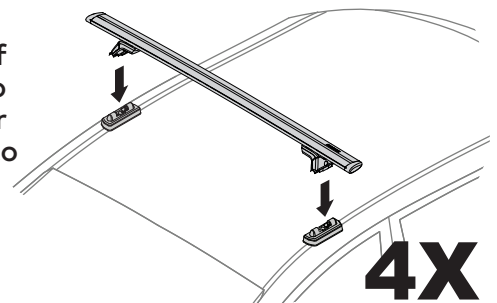
**4X**

**10**

Center cross bars and attach SkyLine or Control Towers to crossbars according to your SkyLine or Control Tower instructions.

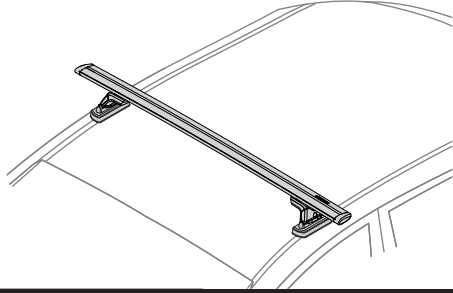
**11**

Open one SkyLine or Control Tower cover, and lift it up while the opposite tower is still engaged.

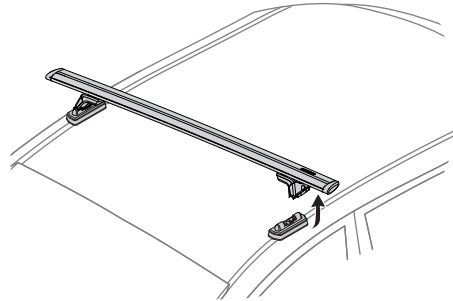
**12**

While holding the SkyLine or Control Tower above the Landing Pad, fully tighten Landing Pad to 1.5 Nm (13.3 in lb) (use the long end of the wrench as shown).

Repeat the process again for the other Landing Pads to ensure they have not changed position.

Re-insert SkyLine or Control Tower into the Landing Pad, fully tighten tower (refer to tower instruction) and close cover.

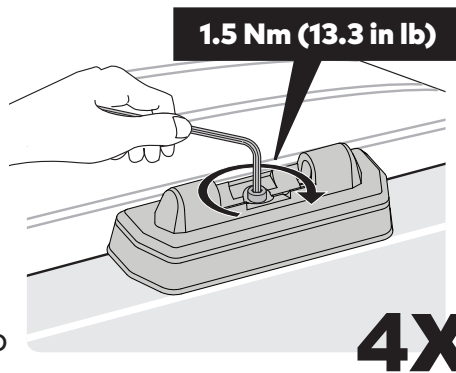

**!**  
DO NOT OVER TIGHTEN AS DAMAGE TO THE ROOF MAY OCCUR.

**13**

Install covers when rack is not attached.

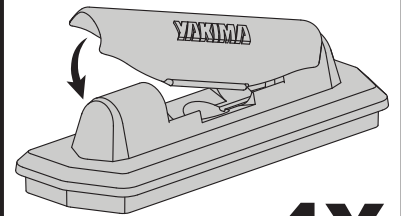

**4X**  
USING THE COVERS WILL HELP KEEP THE BASES FREE OF DEBRIS.

**14**

## READ THESE WARNINGS!



MAKE SURE SKYLINE OR CONTROL TOWERS, WITH BARS INSTALLED, SEAT COMPLETELY WITH LANDING PAD. IF THEY DO NOT SEAT PROPERLY, REPEAT STEPS 9-12.

- BE SURE ALL HARDWARE IS SECURED ACCORDING TO INSTRUCTIONS. FAILURE TO PERFORM SAFETY CHECKS BEFORE DRIVING AWAY CAN RESULT IN PROPERTY DAMAGE, PERSONAL INJURY, OR DEATH.
- ATTACHMENT HARDWARE CAN LOOSEN OVER TIME. CHECK AND TIGHTEN IF NECESSARY, BEFORE EACH USE.
- TO AVOID DAMAGE YOUR VEHICLE'S FINISH REMOVE AND CLEAN LANDING PADS AND MOUNTING POINTS PERIODICALLY AS ROAD SEDIMENT WILL ACCUMULATE OVER TIME.



DO NOT EXCEED MAXIMUM WEIGHT LIMIT FOR YOUR VEHICLE.

**Continue with SkyLine or Control Tower installation.**

## IMPORTANT WARNINGS

### Rack Installation

Inadequately secured loads and incorrectly mounted roof racks and accessory racks can come loose during travel and cause serious accidents! Therefore, installation, handling and use must be carried out in accordance with product and vehicle instructions.

In addition to these instructions, review the mounting instructions for the roof rack and the operating instructions of the vehicle.

These instructions should be kept together with the vehicle's operating instructions and carried in the vehicle when in use and en route.

For your own safety, you should only use roof racks that are authorized for use with your vehicle.

For roof racks that do not specify the distance between the front and rear crossbars, the distance shall be at least 700 mm or as large as possible. Please note that changes (e.g. additional drill holes) to the accessory rack's attachment system are not permissible.

Check attachment hardware and load for tight fit and function:

- Before the start of any journey.
- After driving a short distance following rack or load install.
- At regular intervals on longer journeys.
- More frequently on rough terrain.
- After interruption of a journey during which the vehicle was left unsupervised (check for damage due to outside intervention).

### Rack Loading

Do not exceed the maximum load specified for the roof rack, accessory rack or the maximum load recommended by the vehicle manufacturer.

Max Roof Load = weight of roof rack + weight of accessory racks + weight of load.

Load shall be uniformly distributed with the lowest possible center of gravity.

Load should not substantially extend beyond the loading surface of the roof rack.

### Vehicle Driving and Regulations

The speed driven must be suited to the load transported and to official speed limits. In the absence of any speed limits, we recommend a maximum speed of 80 mph (130 km/h).

When transporting any load, the speed of the vehicle must take into account all conditions such as the state of the road, the surface of the road, traffic conditions, wind, etc. Vehicle handling, cornering, braking and sensitivity to side winds will change with the addition of roof top loads.

If this product is off-road certified, it is designed and intended to be used on forest service roads, access roads or other non-technical terrains at moderate speeds. It is not to be used while rock-crawling, jumping, bogging, or other technical off-road terrains. When using off-road certified products with non-off-road certified products, always follow the warnings and restrictions stated in the non-off-road certified product instructions.

### Maintenance

The accessory rack should be carefully cleaned and maintained, particularly during the winter months. Use only a solution of water and standard car wash liquid without any alcohol, bleach or ammonium additives.

For reasons of fuel economy and the safety of other road users, the accessory rack and roof rack should be removed when not in use.

Periodically inspect accessory rack for damage. Replace lost, damaged, or worn parts. Use only original spare parts obtained from a stocking specialist, dealer, or manufacturer.

Any changes made to the roof racks and accessory racks as well as the use of spare parts or accessories other than those supplied by the manufacturer will lead to the lapsing of the manufacturer's warranty and liability for any material damage or accidents. You should observe these instructions to the letter and only use the original parts supplied.

**Record Your Key Number:**

(located on the set of locking keys)

--	--	--	--