

YAKIMA

Kickstand

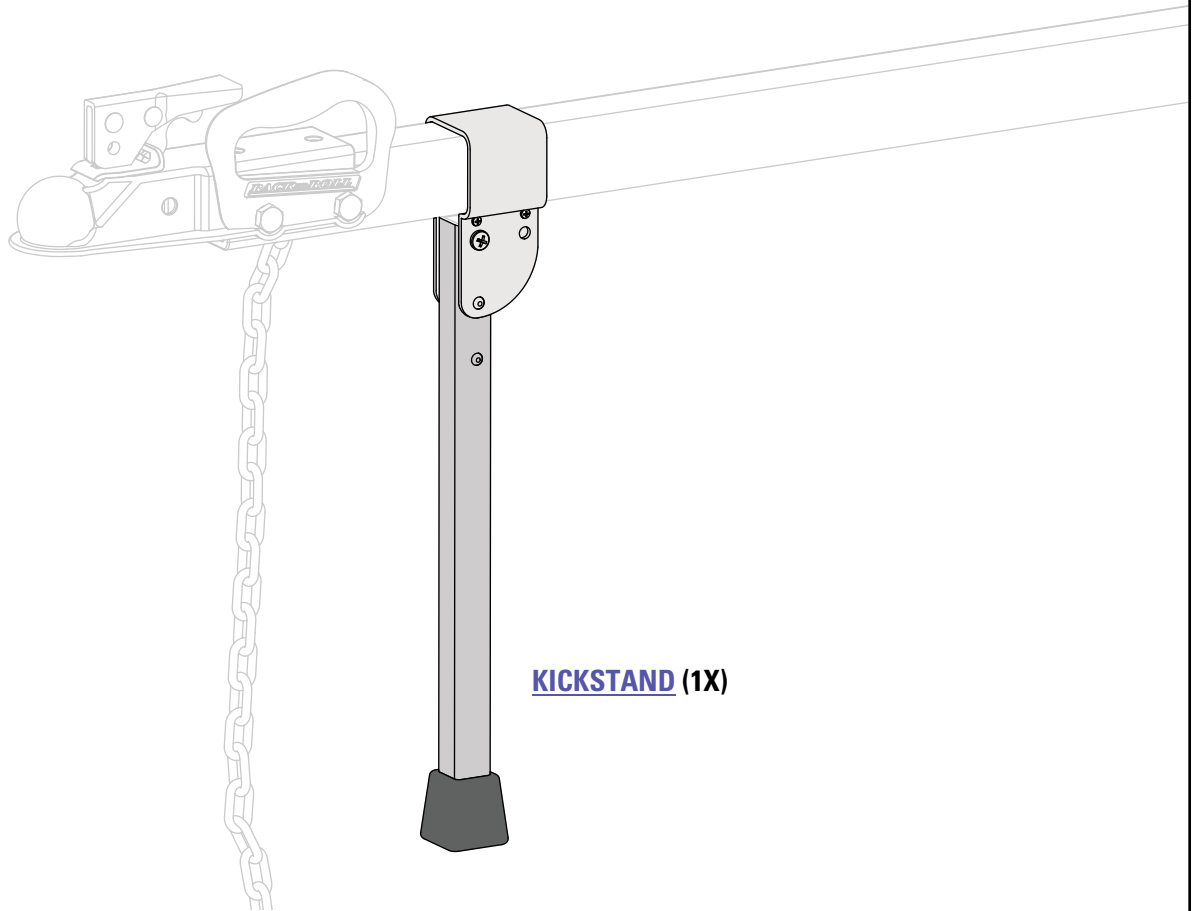

KICKSTAND (1X)



IMPORTANT WARNING

IT IS CRITICAL THAT ALL YAKIMA RACKS AND ACCESSORIES BE PROPERLY AND SECURELY ATTACHED TO YOUR VEHICLE. IMPROPER ATTACHMENT COULD RESULT IN AN AUTOMOBILE ACCIDENT, AND COULD CAUSE SERIOUS BODILY INJURY OR DEATH TO YOU OR TO OTHERS. YOU ARE RESPONSIBLE FOR SECURING THE RACKS AND ACCESSORIES TO YOUR CAR, CHECKING THE ATTACHMENTS PRIOR TO USE, AND PERIODICALLY INSPECTING THE PRODUCTS FOR ADJUSTMENT, WEAR, AND DAMAGE. THEREFORE, YOU MUST READ AND UNDERSTAND ALL OF THE INSTRUCTIONS AND CAUTIONS SUPPLIED WITH YOUR YAKIMA PRODUCT PRIOR TO INSTALLATION OR USE. IF YOU DO NOT UNDERSTAND ALL OF THE INSTRUCTIONS AND CAUTIONS, OR IF YOU HAVE NO MECHANICAL EXPERIENCE AND ARE NOT THOROUGHLY FAMILIAR WITH THE INSTALLATION PROCEDURES, YOU SHOULD HAVE THE PRODUCT INSTALLED BY A PROFESSIONAL INSTALLER.

1 Slide the kickstand into place.

With the tongue separated from the trailer slide the Kickstand onto the tongue.

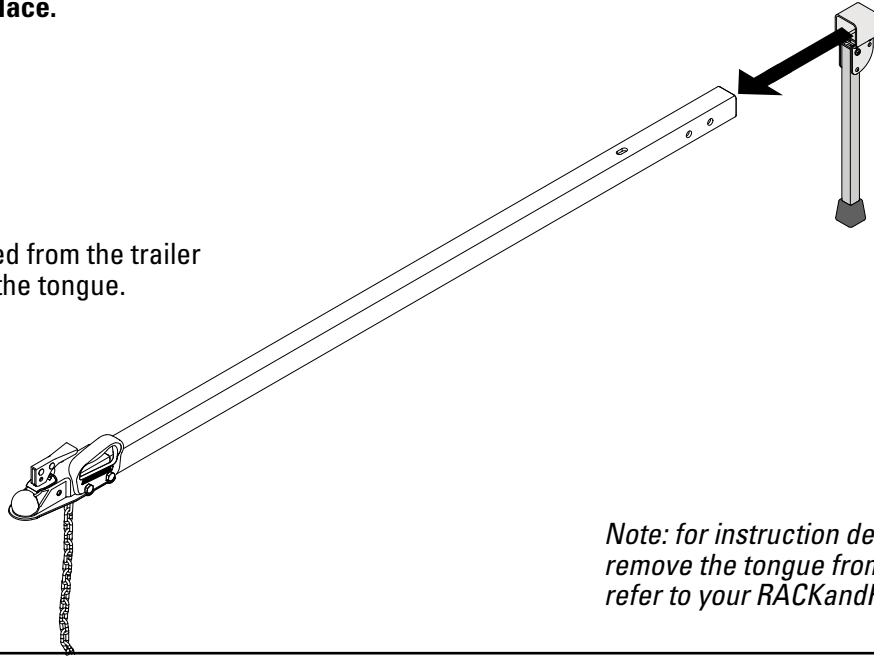

Note: for instruction detailing how to remove the tongue from the trailer refer to your RACKandROLL manual.

2 Tighten down the kickstand.

Locate the two upper most screws on the kickstand.

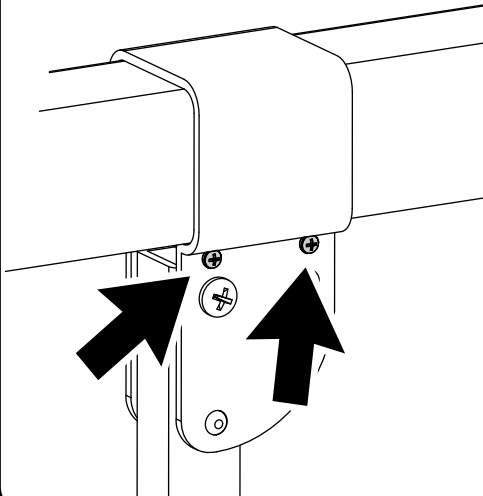

Using a crosshead head screwdriver tighten down the screws. Use a wrench to keep the nuts on the other side from turning while you tighten the screws.

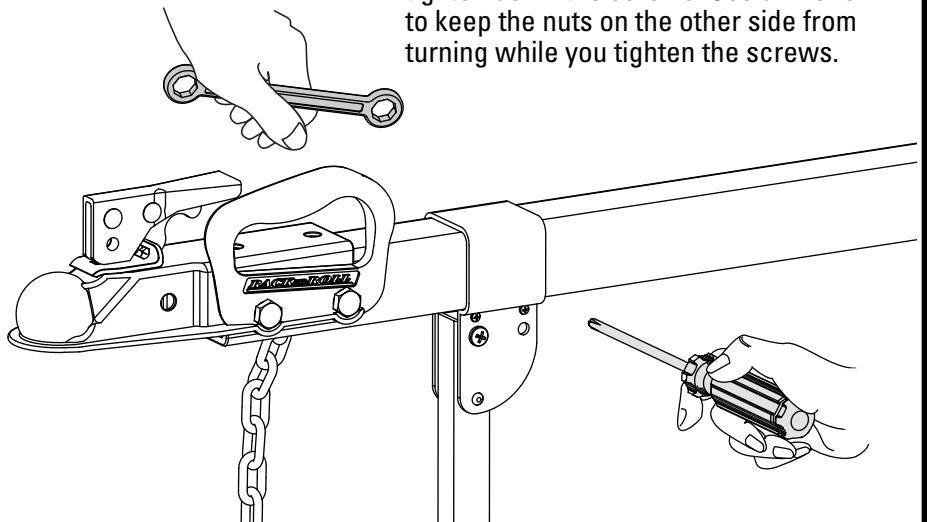

3 Stowing the kickstand.

Press the silver buttons to release the kickstand.

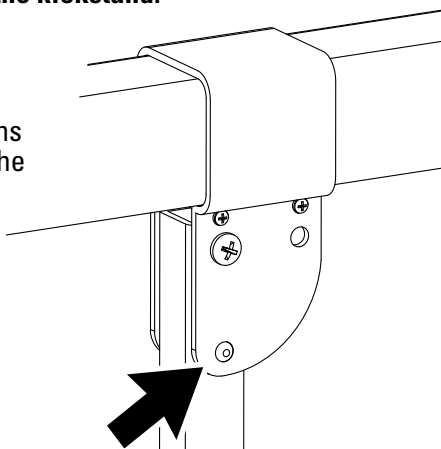

Fold the kickstand up.

Whether it is in the up or down position be sure it locks into position.

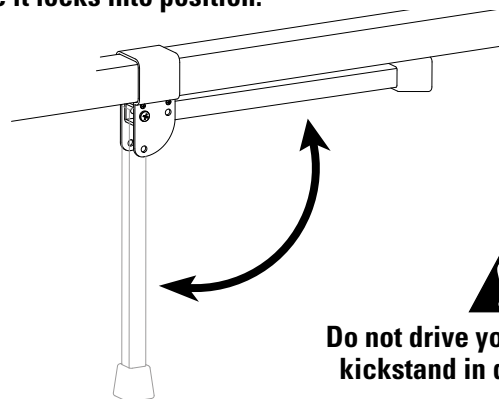

Do not drive your vehicle with kickstand in down position.

