

YAKIMA

RATCHETING

Bow/Stern Tie-down

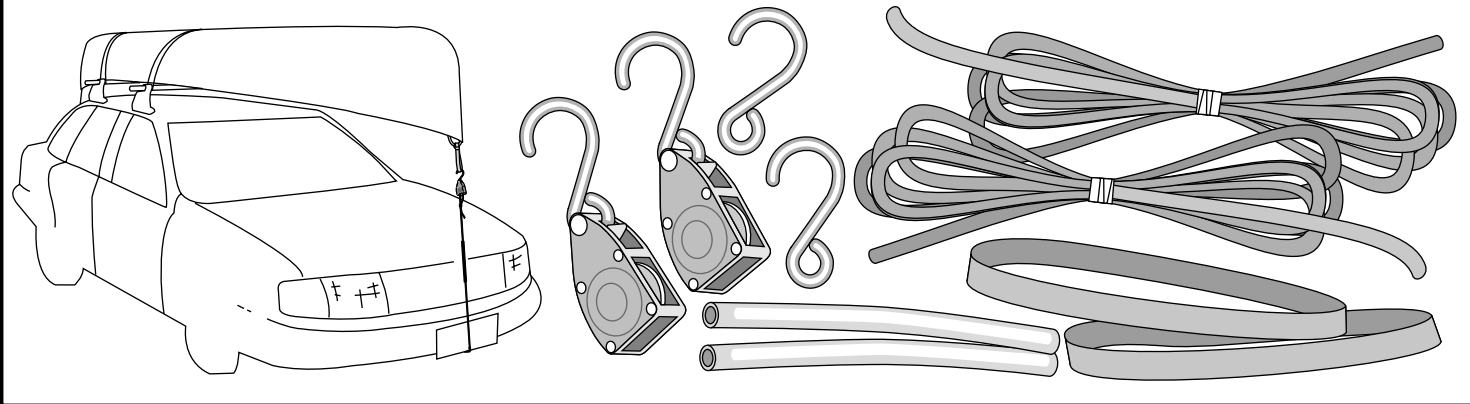

IMPORTANT WARNING! IT IS CRITICAL THAT ALL YAKIMA RACKS AND ACCESSORIES BE PROPERLY AND SECURELY ATTACHED TO YOUR VEHICLE. IMPROPER ATTACHMENT COULD RESULT IN AN AUTOMOBILE ACCIDENT, AND COULD CAUSE SERIOUS BODILY INJURY OR DEATH TO YOU OR TO OTHERS. YOU ARE RESPONSIBLE FOR SECURING THE RACKS AND ACCESSORIES TO YOUR CAR, CHECKING THE ATTACHMENTS PRIOR TO USE, AND PERIODICALLY INSPECTING THE PRODUCTS FOR ADJUSTMENT, WEAR, AND DAMAGE. THEREFORE, YOU MUST READ AND UNDERSTAND ALL OF THE INSTRUCTIONS AND CAUTIONS SUPPLIED WITH YOUR YAKIMA PRODUCT PRIOR TO INSTALLATION OR USE. IF YOU DO NOT UNDERSTAND ALL OF THE INSTRUCTIONS AND CAUTIONS, OR IF YOU HAVE NO MECHANICAL EXPERIENCE AND ARE NOT THOROUGHLY FAMILIAR WITH THE INSTALLATION PROCEDURES, YOU SHOULD HAVE THE PRODUCT INSTALLED BY A PROFESSIONAL INSTALLER SUCH AS A QUALIFIED GARAGE OR AUTO BODY SHOP.

1 Tie a secure knot onto the plain hook.

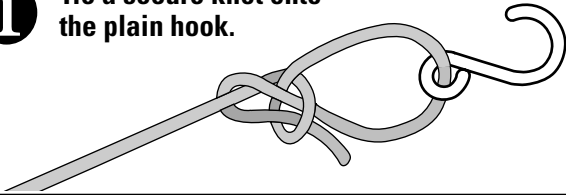

2 Slide the rope cover onto the rope.

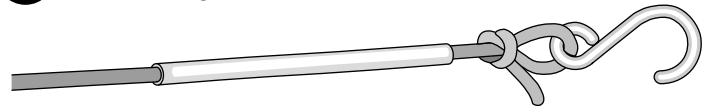

2 RACHET/HOOK: Feed the free end of the rope, rotating the wheel until the rope exits at the bottom.

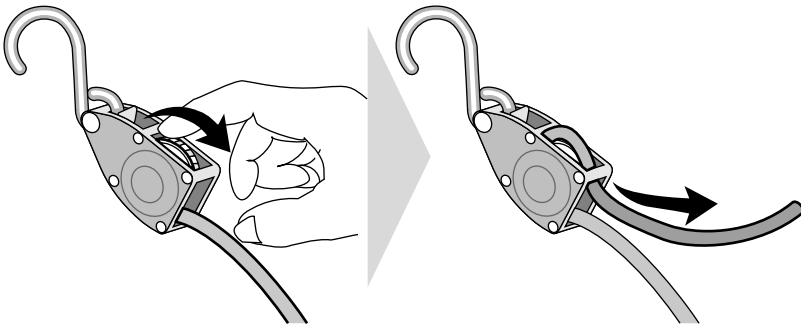

3 Attach the strap to a secure point on the boat.



4 Attach ratchet/hook to strap.

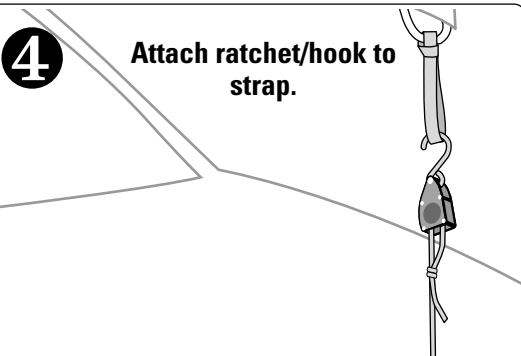

5 Secure the plain hook end to tow loop, frame hole, or metal part of bumper.

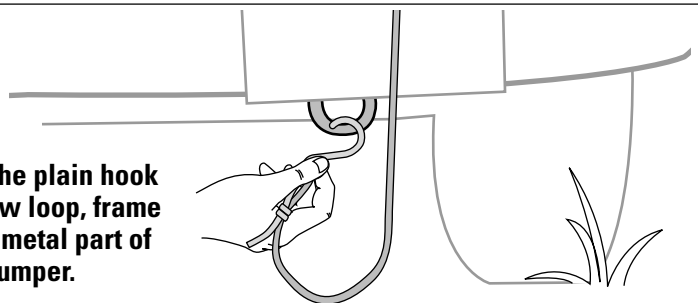

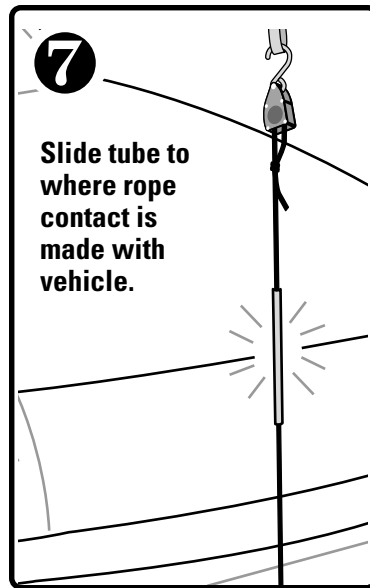
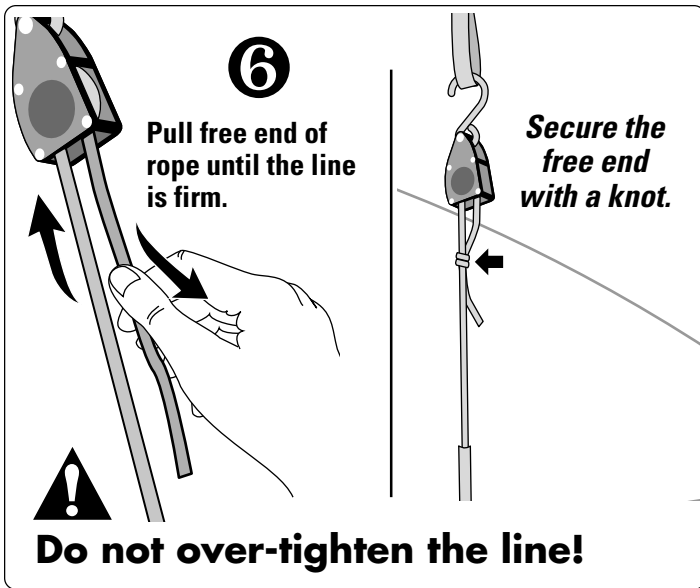

8 Repeat the installation for second tie-down.

Secure front and rear of long loads to ends of vehicle for safe transport. Failure to do so can result in property damage, personal injury, or death.

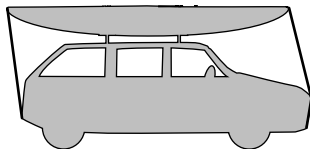

LOAD LIMITATIONS

Do not exceed maximum load of 150 lbs. for each tie-down.



Failure to perform these safety checks before driving away can result in property damage, personal injury, or death.

- Attachment hardware can loosen after the first 5 miles, and again after every 25 miles. Check before each use and again after traveling. Tighten if necessary.
- Be sure all hardware is secured according to instructions.
- Do not use if rope is frayed or worn, or if ratchet does not function.
- Keep rope clear of hot exhaust.
- Not for use with drive-through car wash.