

# YAKIMA

# LockUp

## HITCH LOCK & CABLE LOCK

Lock your carrier to the hitch receiver—lock your bikes to the carrier.

CABLE LOOP

PIN

CABLE LOCK

HITCH LOCK

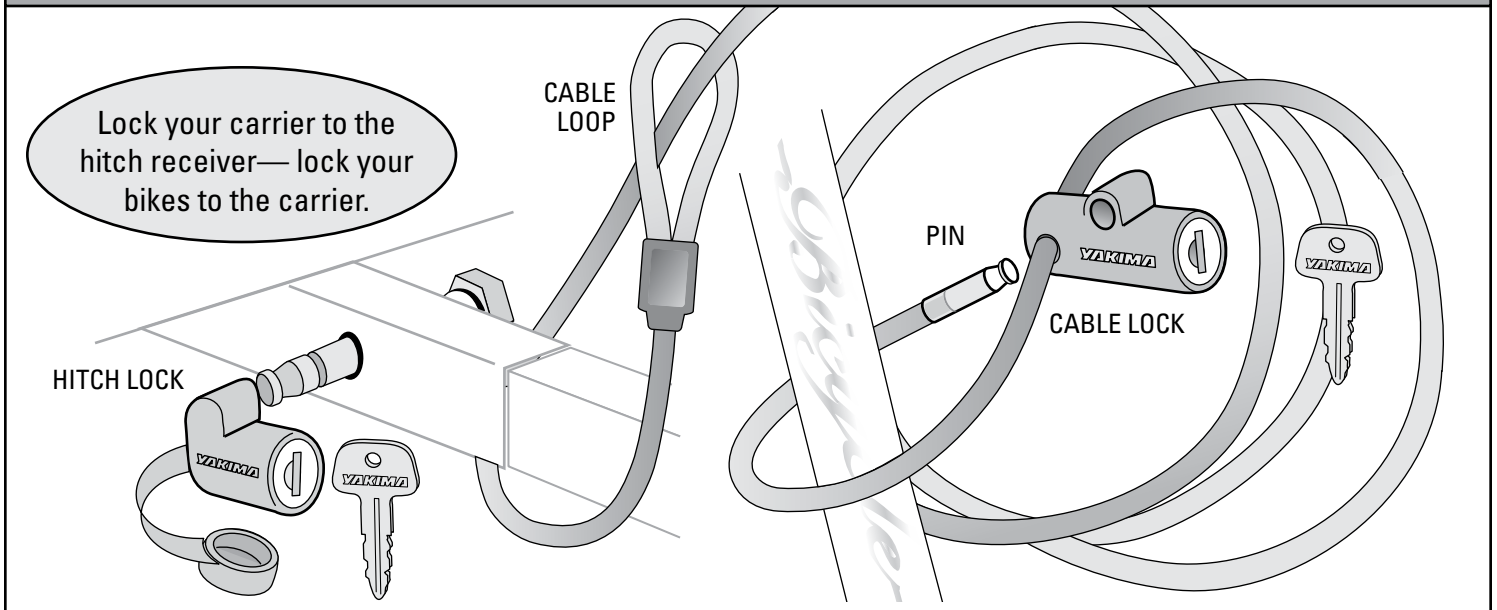

### Lock the CARRIER to the receiver:

**1**

- Remove hitch pin from the hitch bolt.
- Attach hitch lock.

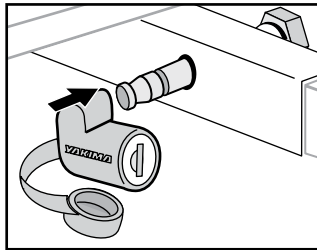
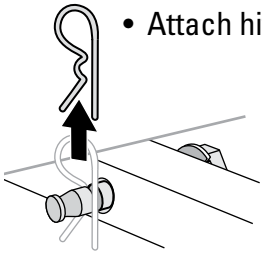

**2**

- Insert the key and **LOCK THE Lock.**

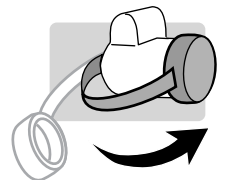
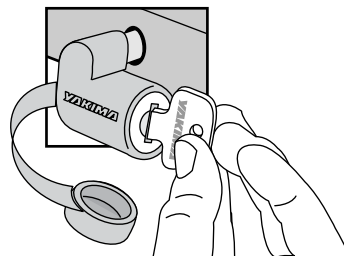

Close the lock cap.

### Lock the BIKE to the carrier:

**3**

- **THREAD THE CABLE THROUGH EACH BIKE WHEEL AND ALL BIKE FRAMES.**

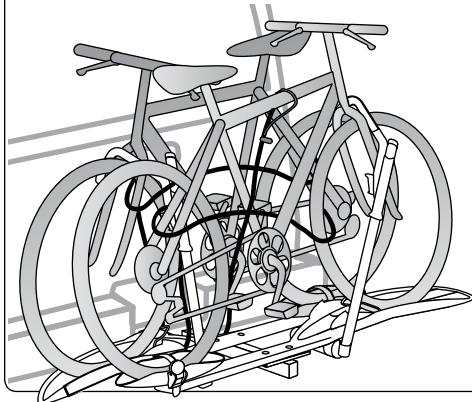

Insert the pin into the lock and lock it.

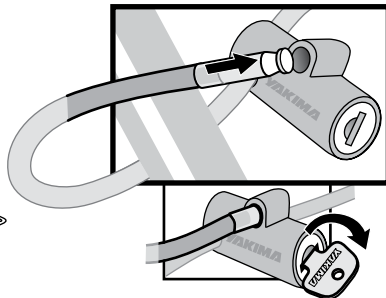

**4**



**VERIFY THAT THE PIN IS SECURE BY PULLING ON THE LOCKED CABLE.**

- Be sure to pass the cable through all bike frames and wheels.
- Keep lock and pin free of debris.
- Lubricate locks periodically with a lock lubricant.

LOVE IT TILL YOU LEAVE IT  
**LIFETIME**  
WARRANTY