

Input Voltage	Max Power Draw Red – 48" / 60"	Max Power Draw White – 48" / 60"
12-15V DC	13W / 18W	10W / 12W

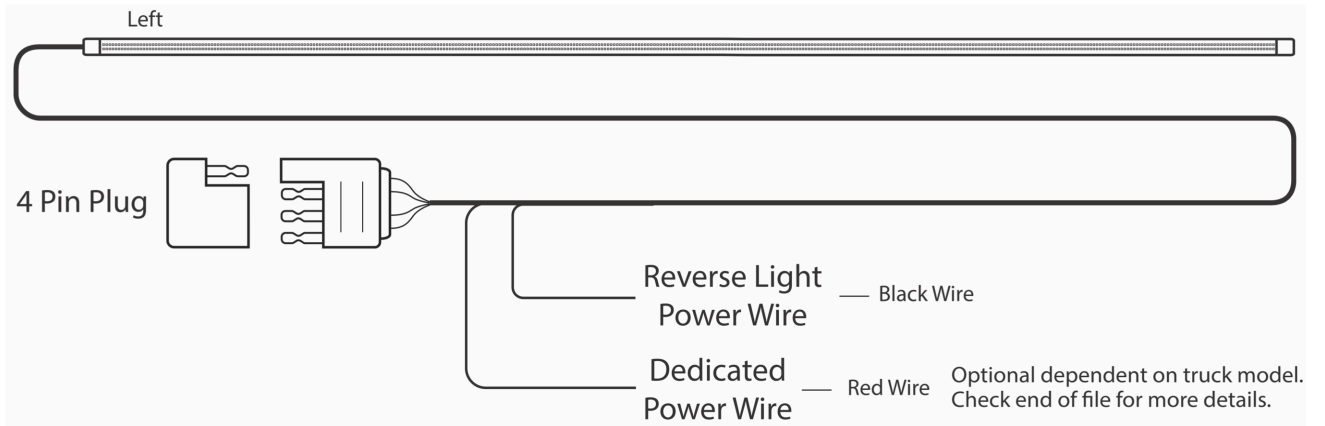

## Mounting Instructions

### Permanent Mounting:

1. **Test light bar:** Before mounting, plug light bar into 4 pin trailer plug. With the vehicle off, turn on hazards and check operation.
2. **Prep mounting surface:** Using isopropyl alcohol, thoroughly clean the mounting surface. Let dry. Any dirt or debris left on the paint will prevent the light bar from adhering properly.
3. **Position light bar:** Remove red tape backing and loosely position the light bar onto the vehicle. Do not press firmly! Step back to ensure that light bar is centered and straight. Once in position, firmly and thoroughly press onto the vehicle. *Please note that the wiring must exit towards the **LEFT** side of the vehicle.*

### Removable Mounting:

4. **Test light bar:** Before mounting, plug light bar into 4 pin trailer plug. With the vehicle off, turn on hazards and check operation.
5. **Prep mounting surface:** Using isopropyl alcohol, thoroughly clean the mounting surface. Let dry.
6. **Install brackets:** Evenly space and snap the brackets onto the light bar. With the brackets snapped onto the light bar, use masking tape and loosely position the bar into place on the vehicle. Ensure light bar is centered and straight and mark the position of each bracket. Remove the light bar and using the self-tapping screws, secure the brackets to the vehicle.
7. **Install light bar:** Insert the top of the bar into the brackets first and then push the bottom of light bar into the brackets. *Please note that the wiring must exit towards the **LEFT** side of the vehicle.*

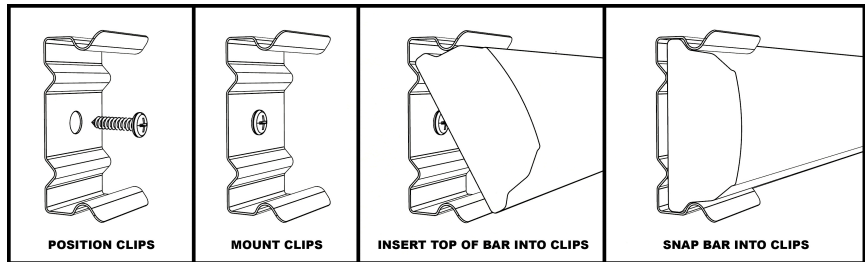

## Wiring Options

### For Trucks without Trailer Detection:

1. Plug the 4 pin plug on the truck tailgate light bar into the 4 pin trailer plug on the truck.
2. Wire in reverse light. Using the supplied red scotchlok, tap the additional black wire into the center wire on the 7 pin plug or into the factory reverse light positive wire behind one of the tail lights. See service manual for vehicle's reverse + wire color.
3. Power on vehicle and test functionality.

### For Trucks with Trailer Detection:

1. Remove the tail lights from the vehicle to gain access to the wiring.
2. Cut off the 4 pin plug from the truck tailgate light.
3. Using the supplied scotchlocks, tap the black, red, and green wire into its corresponding wire behind the **left** side tail light. See diagram to the right for plug pinout.
4. The yellow wire will be tapped into the turn signal positive wire on the **right** side of the vehicle. The included extension wire is to reach the right side of the vehicle. Use one of the scotchlocks to extend the yellow wire and another scotchlok to tap into the right side turn signal positive wire.
5. Wire in reverse light. Using the supplied red scotchlok, tap the additional black wire into the center wire on the 7 pin plug or into the factory reverse light positive wire behind one of the tail lights. See service manual for vehicle's reverse + wire color.
6. Secure any loose wiring and reinstall the tail lights.
7. Power on vehicle and test functionality.

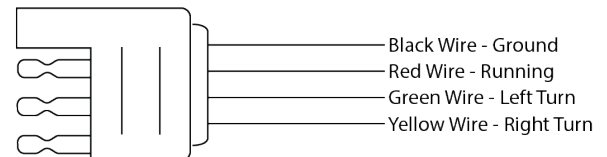

### If truck shows any of the following issues, the **dedicated power wire** will need to be connected to 12V.

- Trailer detection warning
- Trailer light out warning
- Tail lamp out warning
- Blind spot detection warning
- Flickering of light bar on any function

Take the RED wire coming directly from the tail gate bar and connect to a constant fused 12V power. This could be directly to the + battery terminal with a dedicated inline fuse or the 12V wire on the 7 pin trailer plug. Please note: 12V wire on the 7 pin trailer plug must be switched to constant-on power to ensure proper function.