

PART NO. E8161

TOLERANCES UNLESS SPECIFIED		
TWO PLACE DECIMALS +/- .015	THREE PLACE DECIMALS +/- .005	ANGLES +/- 1°

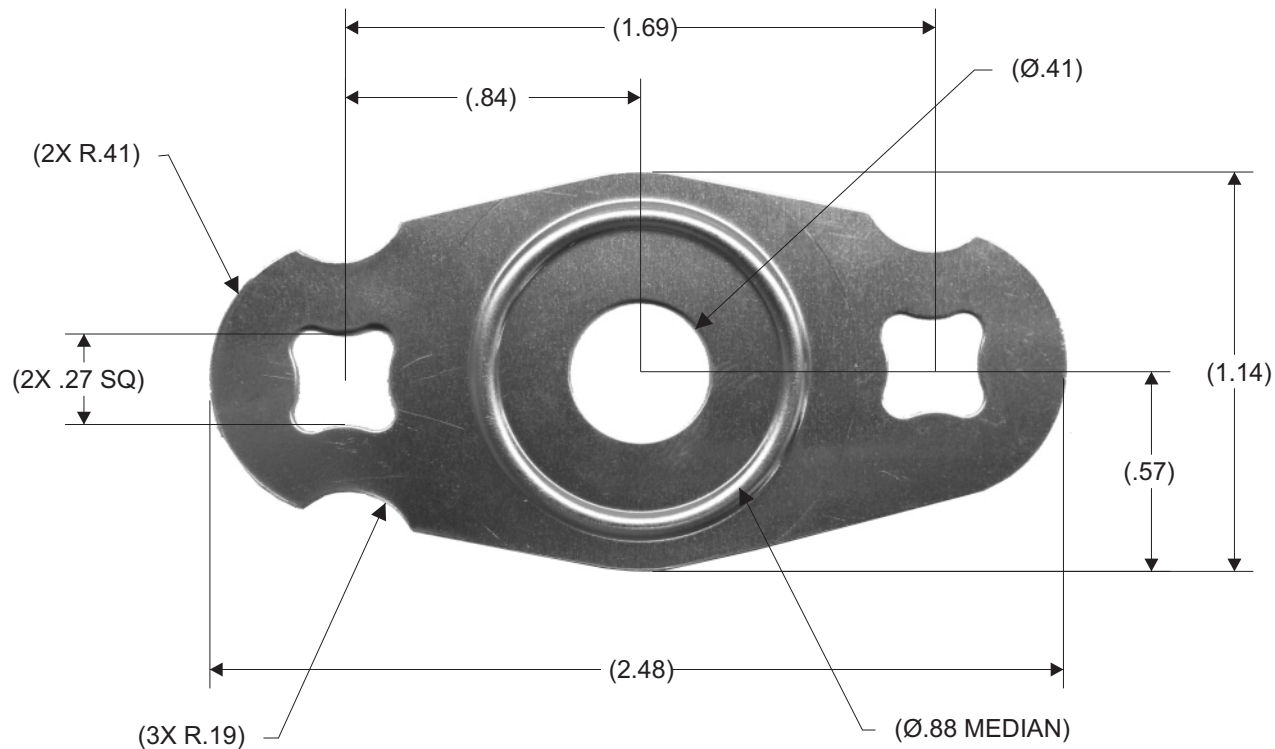

NOTES:
 1. MATERIAL THICKNESS: .012
 RAISED AREA: .025.
 2. MATERIAL: STAINLESS STEEL

REPLACES OE# CG-747 4G7Z-9D476-AA

					MATERIAL	N/A	SCALE	NTS			
							DATE	5/19/11		DWN. BY	PJG
					FINISH	N/A	ENGINEER	5/19/11		JS	
							APPROVED	5/19/11		TDS	
	RELEASE DRAWING	32539A	5/20/11	PJG			PURCH.	<input type="checkbox"/>	PROD.	<input type="checkbox"/>	TITLE
L	REVISION	CN	DATE	BY	CAD REF.	N/A	MODEL				PART NO.
											E8161

Looking for dependable replacement emission control parts? Rely on WVE for quality and long-lasting products.