

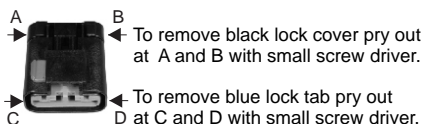

**PLEASE READ THE FOLLOWING NOTICE BEFORE INSTALLATION.**

This instruction sheet is for 4, 3, and 2 wire connectors.

**Connector needs to be disassembled to insert wires**



Note: There are different wire sizes. Match the wire size to your original wire harness and install the same size wire into the new connector in the same order as the original connector.

**Assemble Components In Order**

1. Insert wires into back of connector.
2. Slide rubber gasket onto the wires and push into back of connector.
3. Slide black lock cover onto back of connector.
4. Push blue lock tab into front of connector.

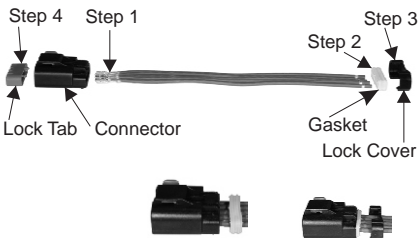

**For the best connection**

Slide heat shrink tube onto each wire of the new connector. Solder new connector to the vehicle harness, then slide the heat shrink tube over the solder connections and with a heat gun heat the shrink tube to seal the connections.