

# Brace-lower control arm to swaybar

### Application:

Front lower control arm to swaybar brace to suit:

- **Ford Mustang 2005-2008**

*Always refer to current catalogue for complete application listing.*

### Specifications:

4-point Alloy brace with mounting brackets and hardware.

### Contents:

- 1 x brace
- 2 x bracket
- 4 x bolt, M12 x 25mm long
- 2 x bolt, M12 x 45mm long (**Shelby Cobra only**)
- 2 x spacers (**Shelby Cobra only**)
- 2 x nut, M12 nyloc
- 6 x washer, M12 flat
- 4 x washer, M12 spring

### Fitting Instructions:

Please read complete fitting instructions and check kit components prior to fitment. These instructions are to be used in conjunction with workshop manual. It is recommended that all work be carried out by a qualified technician.

1. Undo front swaybar chassis mounts, and move swaybar back and away from its mounts.
2. Place new brackets in position between chassis mounts and D-bushes.
3. Re-fit swaybar and tighten to manufacturer's torque specification.
4. Place alloy brace in position, using new brackets as the front mounting and cross-member holes near lower control arm front bush as the rear mounting. Secure using hardware supplied. Recommended torque setting 60Nm.
5. Check & re-tension all fittings again after 100km's but no more than 200km's.

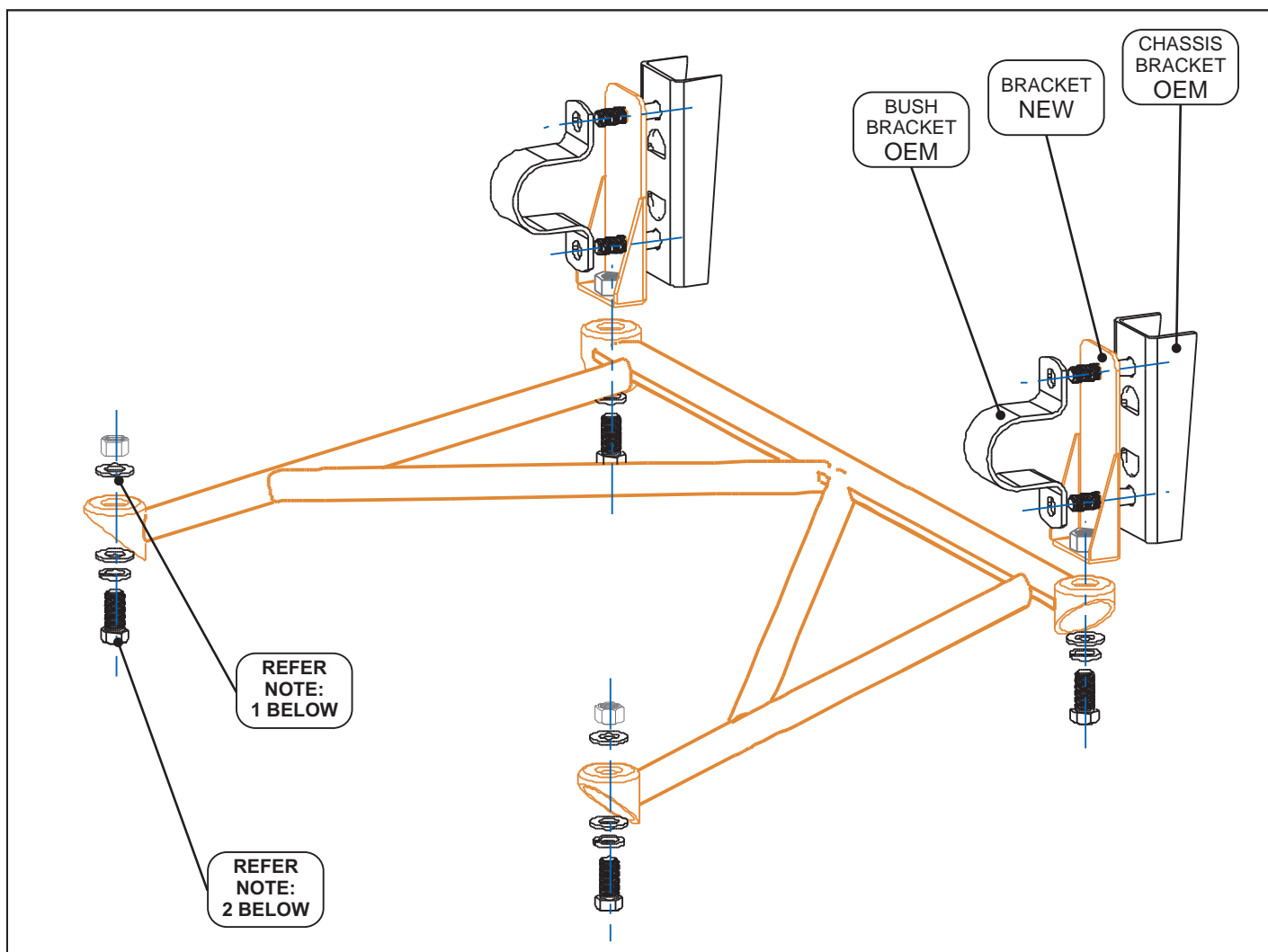

**NOTE 1:** If installing brace on a Shelby Cobra then spacers must be used on the rear of the brace, otherwise discard.

**NOTE 2:** Only use the 45mm long bolts on the rear of the brace when installing on a Shelby Cobra, otherwise discard.

**Warning:** Please drive carefully while you accustom yourself to the changed vehicle behaviour.