

Installation Guide

Rear Differential Rear Bush

Suits: 200SX, S14-S15, R32-33-34, 300ZX
With Rear 2 Bolt Mount only

(Always refer to the current catalogue for complete application listings)

N.B: Supplied Optional Spacer.

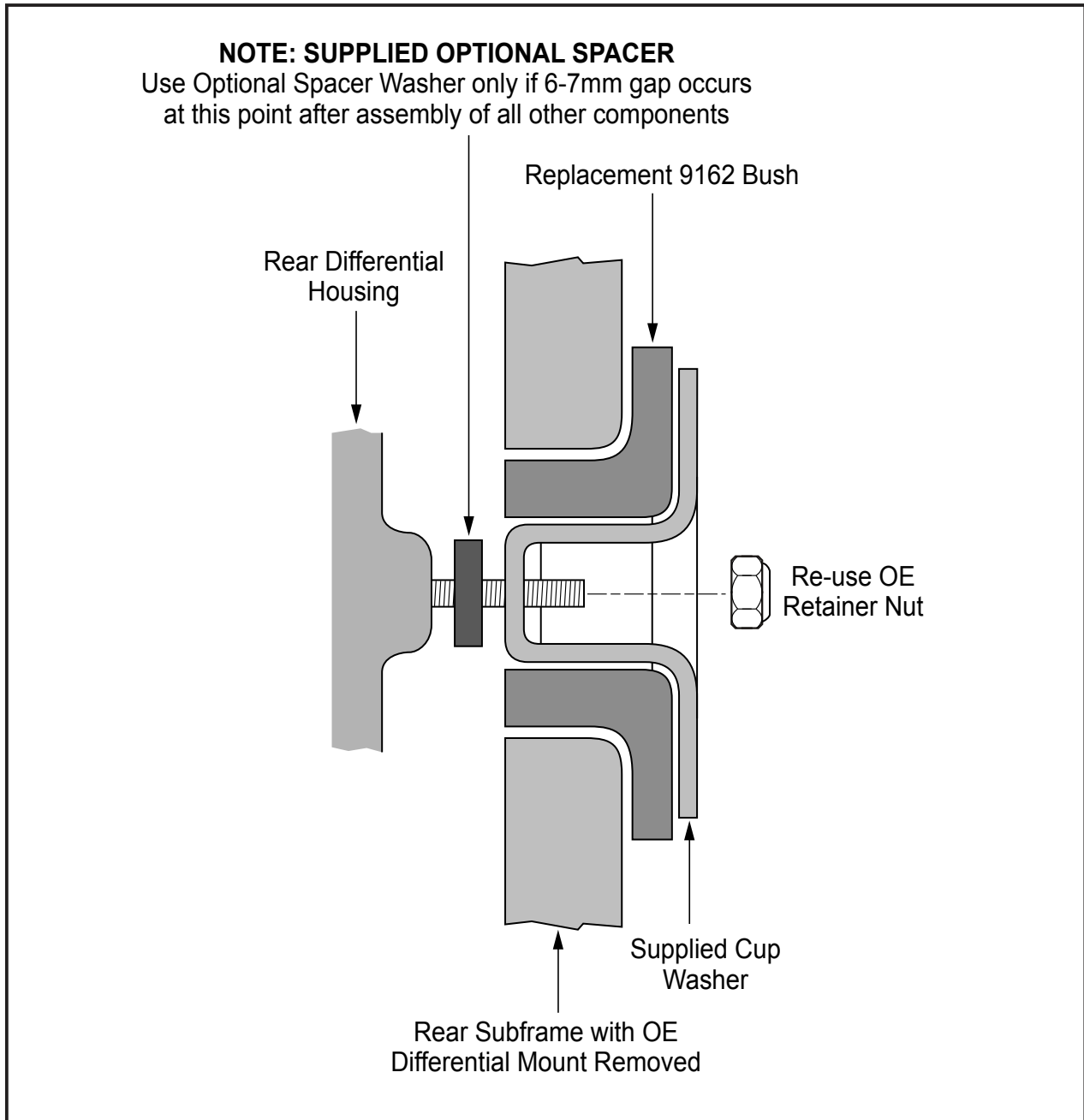

N.B: It is recommended that a licenced workshop or trades person carry out the above procedure and that workshop manual and relevant safety procedures are followed in addition to the above.