



SIGNATURE OF QUALITY

AUTOMOTIVE PRODUCTS, INC.

INSTRUCTIONS

APPLICATION: 1993-98 JEEP GRAND CHEROKEE 4 DOOR

STEP BAR ASSEMBLIES 25-1020 25-1025					

ITEM	QTY	CONTENTS	TOOLS
1,2	2	STEP BAR, PASSENGER (1) AND DRIVER (2)	3/4" SOCKET 3/4" WRENCH 9/16" SOCKET 9/16" WRENCH RATCHET TORQUE WRENCH
3,4	2	FRONT BRACKET, PASSENGER (3) AND DRIVER (4)	
5,6	2	REAR BRACKET, PASSENGER (5) AND DRIVER (6)	
7	2	MOUNT PLATE	
8	4	1/2 13 X 1.75" HEX HEAD BOLT	
9	4	1/2 13 X 1.00" HEX HEAD BOLT	
10	8	1/2" FLAT WASHER	
11	8	1/2" LOCK WASHER	
12	4	3/8 16 X 1.25" HEX HEAD BOLT	
13	8	3/8" FLAT WASHER	
14	4	3/8" LOCK WASHER	
15	4	3/8 16 HEX NUT	

- STEP 1. Remove the contents from box and check for damage. Verify all parts are present. Read instructions completely before beginning.
- STEP 2. Attach step bars to brackets using 1/2" fasteners as shown. Leave loose.
- STEP 3. Attach brackets to suspension mounts on vehicle as shown. Make sure step bar and brackets are properly aligned with vehicle and tighten all fasteners. Recommended torque values are 64 Ft. Lbs. for 1/2 fasteners and 26 Ft. Lbs. for 3/8" fasteners.

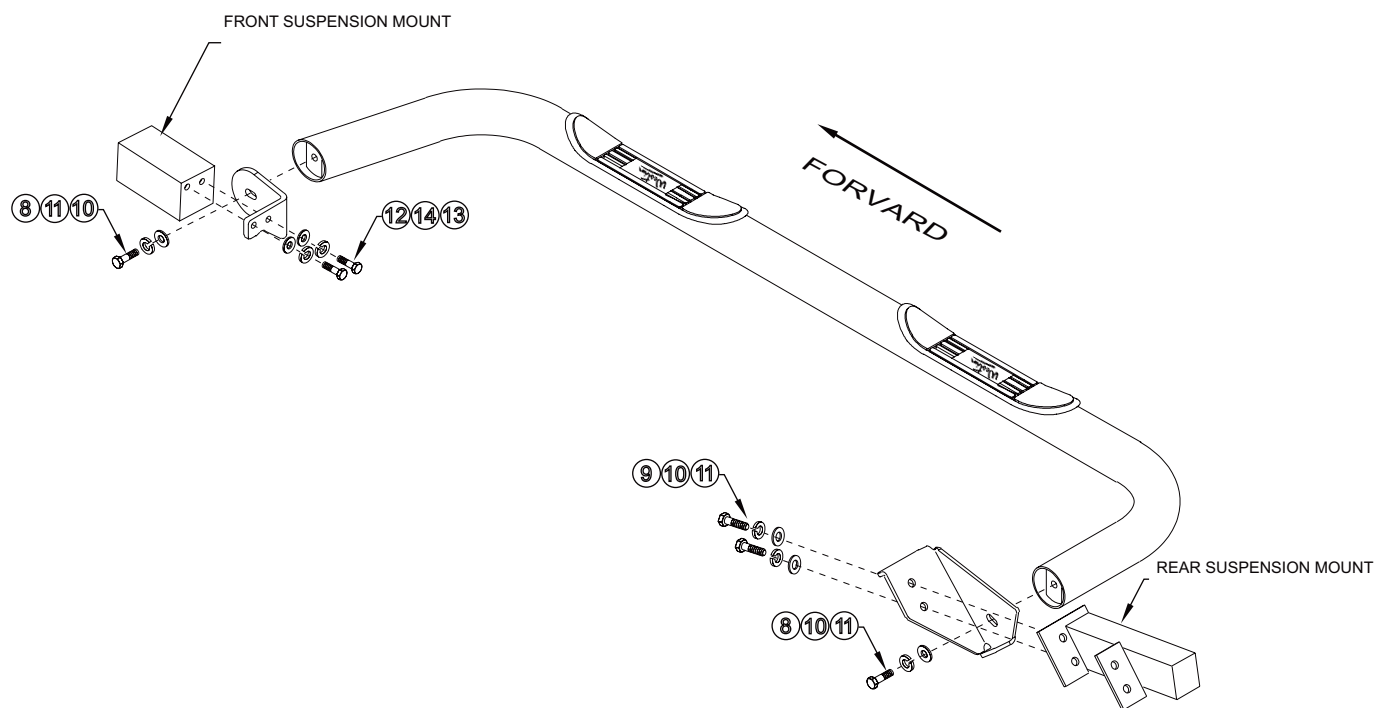

INSTALLATION VIEW OF PASSENGER SIDE SHOWN, DRIVER SIDE OPPOSITE

When it comes to quality side steps and nerf bars, Westin is the brand you can depend on.