



SIGNATURE OF QUALITY

AUTOMOTIVE PRODUCTS, INC.

INSTRUCTIONS

APPLICATION: 1982-97 FORD RANGER REGULAR CAB

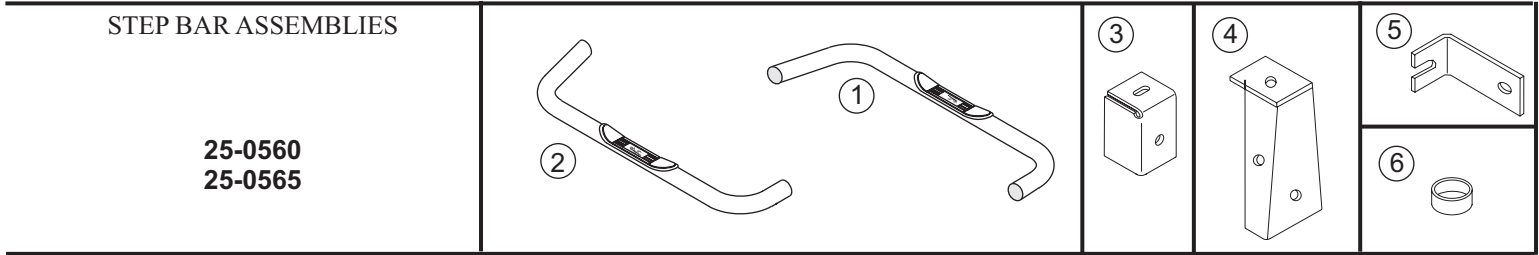

ITEM	QTY	CONTENTS	TOOLS
1,2	2	STEP BAR, PASSENGER (1) AND DRIVER (2)	3/4" SOCKET 3/4" WRENCH 19MM SOCKET RATCHET TORQUE WRENCH
3	2	FRONT BRACKET	
4	2	REAR BRACKET	
5	2	SUPPORT BRACE	
6	4	SPACER TUBE	
7	4	1/2 13 X 1.75" HEX HEAD BOLT	
8	2	1/2 13 X 1.50" HEX HEAD BOLT	
9	8	1/2" FLAT WASHER	
10	6	1/2" LOCK WASHER	
11	2	1/2 13 HEX NUT	
12	4	1/2" EXTERNAL TOOTH LOCK WASHER	
13	4	M12 1.75 HEX NUT	

- STEP 1. Remove the contents from box and check for damage. Verify all parts are present. Read instructions completely before beginning.
- STEP 2. Attach brackets to step bar using 1/2" fasteners as shown. Leave loose.
- STEP 3. Attach step bar to body mounts as shown.
- STEP 4. Loosen existing hex nut near rear body mount and slip rear brace behind hex nut. Attach other end of rear brace to bracket using 1/2" fasteners as shown.
- STEP 5. Repeat installation for opposite side.
- STEP 6. Make sure step bar and brackets are properly aligned with vehicle and tighten all fasteners. Recommended torque value is 64 Ft. Lbs. for 1/2" fasteners.

FINISH PROTECTION

Westin products have a high quality finish that must be cared for like any other exposed finish on the vehicle. Protect the finish with a non abrasive automotive wax, (e.g. Pure Carnauba) on a regular basis. The use of any soap, polish or wax that contains an abrasive is detrimental, as the compounds scratch the finish and open it to corrosion.

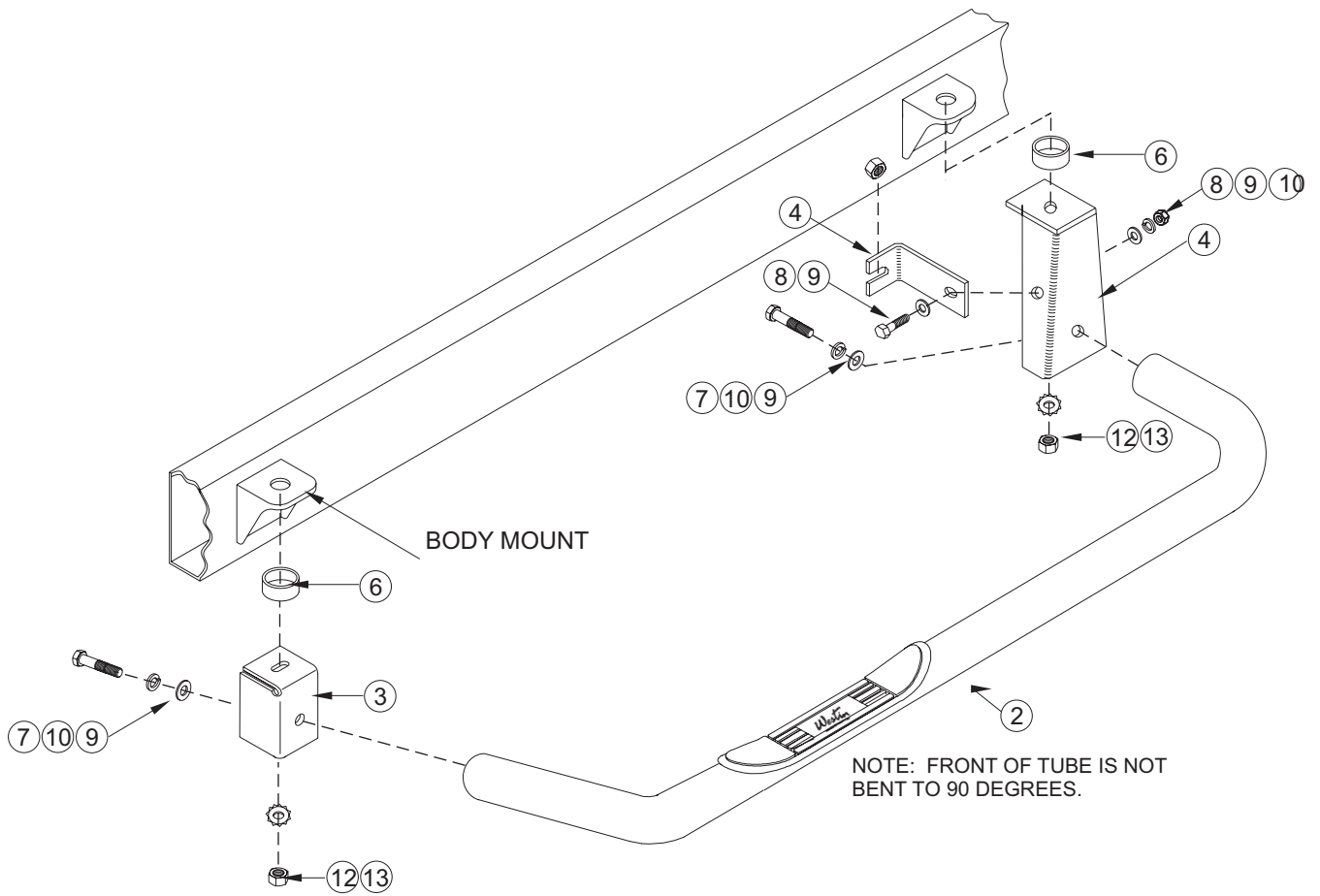

INSTALLATION VIEW OF DRIVER SIDE SHOWN, PASSENGER SIDE OPPOSITE