



SIGNATURE OF QUALITY

INSTRUCTIONS

APPLICATION: 2000-07 CHEVY TAHOE/ GMX YUKON 1500 SERIES

AUTOMOTIVE PRODUCTS, INC.

STEP BAR ASSEMBLIES

23-3000

23-3005

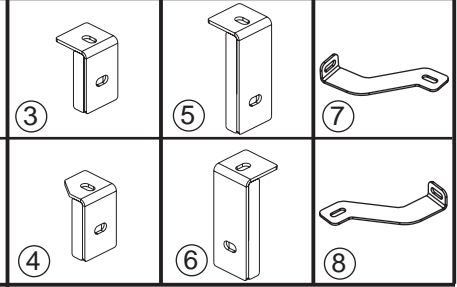
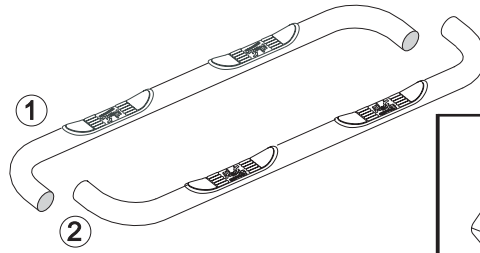

ITEM	QTY	CONTENTS	TOOLS
1	1	PASSENGER SIDE STEP BAR (PINK SLEEVE)	3/4" SOCKET 3/4" WRENCH 9/16" SOCKET 18MM SOCKET 19MM SOCKET 21MM SOCKET EXTENSION RATCHET TORQUE WRENCH
2	1	DRIVER SIDE STEP BAR	
3,4	2	FRONT BRACKET, PASSENGER (3) AND DRIVER (4)	
5,6	2	REAR BRACKET, PASSENGER (5) AND DRIVER (6)	
7,8	2	FRONT SUPPORT BRACE, PASSENGER (7) AND DRIVER (8)	
9	2	NUT PLATE	
10	4	3" PLASTIC RINGS, BLACK	
11	4	M12 1.75 X 120MM HEX HEAD BOLT	
12	4	M12 FLAT WASHER	
13	4	1/2 13 X 2.00" HEX HEAD BOLT	
14	4	1/2" FLAT WASHER	
15	8	1/2" LOCK WASHER	
16	2	3/8 16 X 1.50" HEX HEAD BOLT	
17	2	3/8" FLAT WASHER	
18	2	3/8" LOCK WASHER	
19	2	SPACER WASHER	
		NOTE: IF VEHICLE APPLICATION IS 2006 07, THEN NOT ALL FASTENERS WILL BE USED.	

- STEP 1. Remove the contents from box and check for damage. Verify all parts are present. Read instructions completely before beginning.
NOTE: Passenger side tube is packaged in a pink sleeve.
- STEP 2. Remove front and rear body mount bolts located under cab of vehicle. **DO NOT DISCARD!** Keep existing washers and rubber bushings in place.
NOTE: For 06'-UP vehicles, use existing factory body mount bolts to attach brackets to the vehicle (bolts and washers supplied in kit are not required). For all other applications, use bolts and washers provided in the kit and discard the factory body mount bolts.
- STEP 3. Attach the front and rear brackets to the body mounts using the proper fasteners. Leave loose.
- STEP 4. Slide nut plate into large slot on the underside of vehicle frame (behind front body mount). Center nut side of plate on the small hole in front of large slot. **SEE FIGURE 1.**
- STEP 5. Attach front support brace with one spacer washer between brace and frame. Secure front support brace to the nut plate using 3/8" fasteners. **SEE FIGURE 2.**
- STEP 6. Attach the 3" black plastic rings to the end of the bars before attaching to brackets. Attach step bar to brackets using 1/2" fasteners as shown. Make sure step bar and brackets are properly aligned and tighten fasteners. Recommended torque values are 74 Ft.Lbs. for factory bolts, 64 Ft.Lbs. for 1/2"fasteners, 79 Ft.Lbs. for M12 fasteners and 26 FT.LBS. for 3/8" fasteners.

PRODUCT SPECIFICATIONS: Step Bars have a 300 lbs. weight capacity.
PRODUCT CARE: Westin products have a high quality finish that must be cared for like any other exposed finish on the vehicle. Protect the finish with a non-abrasive automotive wax, (e.g. Pure Carnauba) on a regular basis. The use of any soap, polish or wax that contains an abrasive is detrimental, as the compounds scratch the finish and open it to corrosion.

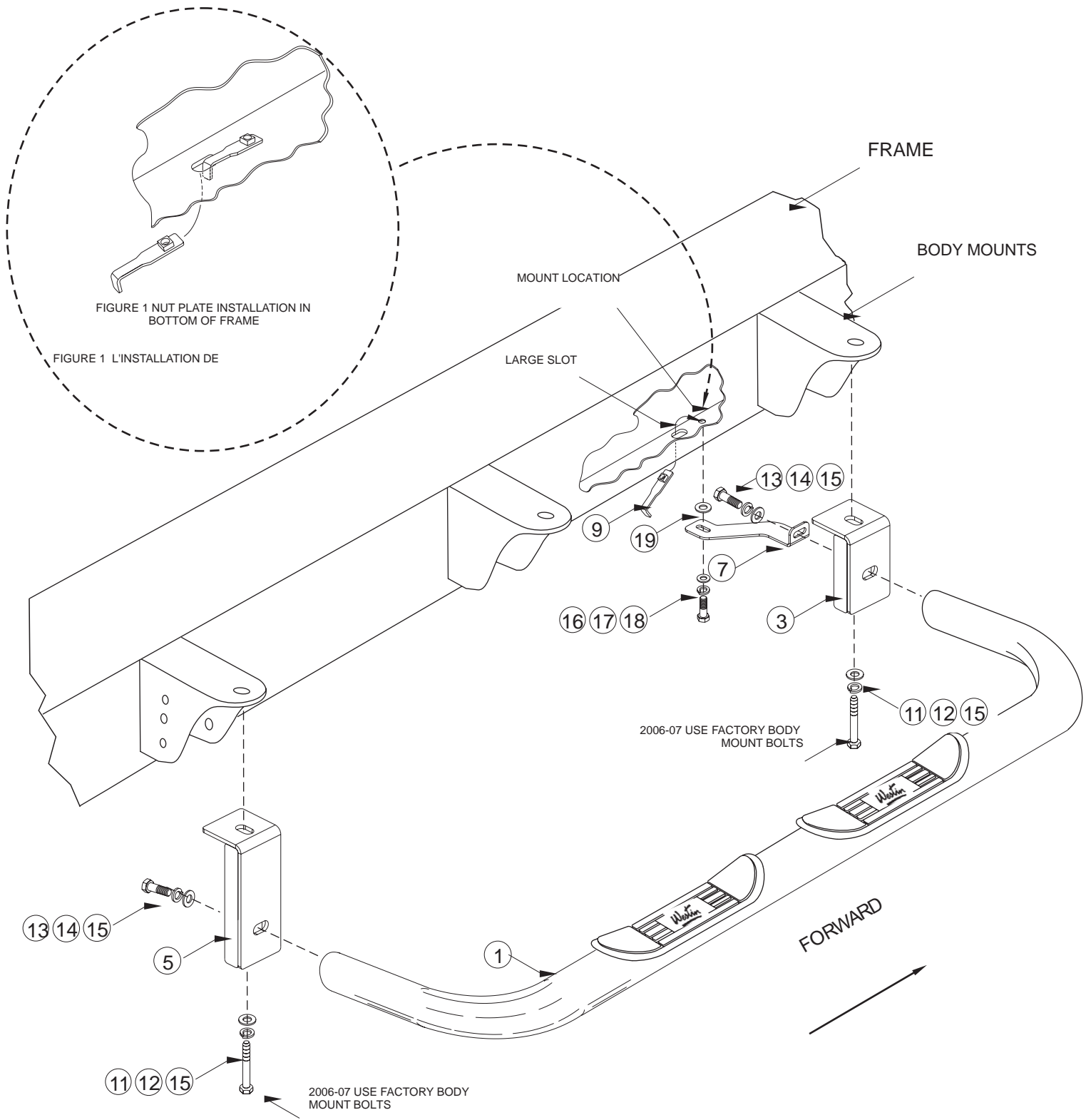

FIGURE 2 INSTALLATION VIEW OF PASSENGER SIDE SHOWN, DRIVER SIDE OPPOSITE