



AUTOMOTIVE PRODUCTS, INC.

# INSTRUCTIONS

APPLICATION: 2004-08 DODGE DURANGO  
2007-08 CHRYLSEER ASPEN

STEP BAR ASSEMBLIES  23-2630 23-2635						
---	--	--	--	--	--	--

ITEM	QTY	CONTENTS	TOOLS
1,2	2	STEP BAR, PASSENGER (1) AND DRIVER (2)	3/4" SOCKET 19MM SOCKET 18MM SOCKET 17MM SOCKET RATCHET TORQUE WRENCH
3	2	FRONT BRACKET	
4,5	2	SUPPORT BRACE, PASSENGER (4) AND DRIVER (5)	
6,7	2	REAR BRACKET. PASSENGER (6) AND DRIVER (7)	
8	2	M10 BOLT PLATE	
9	4	1/2-13 X 2.00" HEX HEAD BOLT	
10	4	1/2" FLAT WASHER	
11	4	1/2" LOCK WASHER	
12	2	M10 FLAT WASHER	
13	2	M10 LOCK WASHER	
14	2	M10-1.5 HEX NUT	
15	2	PLASTIC WASHER	

- STEP 1.** Remove the contents from box and check for damage. Verify all parts are present. Read instructions completely before beginning.
- STEP 2.** Remove existing body mount bolts. Body mount bolts will be used for step bar installation.
- STEP 3.** Install front bracket to body mount using factory hardware. Install rear bracket, secure using factory hardware. Hand tighten only. **SEE FIGURE 2.**
- STEP 4.** Determine passenger and driver support braces. Attach plastic washer to bolt plate. Insert bolt plate into slotted hole on the bottom of frame. Attach support brace to bolt plate using M10 fasteners as shown. **SEE FIGURES 1 AND 2.** Leave loose. Attach support brace to the back side of the front bracket and to step bar tube using the 1/2-13 x 2.00" bolt, 1/2" lock washer, and 1/2" flat washer as shown. **SEE FIGURE 2.**  
**NOTE:** Support brace will not sit flat against the bracket or the frame. When the bolts are tightened, the support brace will conform to the bracket and the frame.
- STEP 5.** Attach step bar to rear bracket using the 1/2-13 x 2.00" bolt, 1/2" lock washer, and 1/2" flat washer as shown. **SEE FIGURE 2.**
- STEP 6.** Repeat installation for passenger side.
- STEP 7.** Make sure step bar and brackets are properly aligned and tighten all fasteners. Recommended torque values are 64 FT. LBS. for 1/2" fasteners and 32 FT.LBS for M10 fasteners.

### FINISH PROTECTION

Westin products have a high quality finish that must be cared for like any other exposed finish on the vehicle. Protect the finish with a non-abrasive automotive wax, (e.g. Pure Carnauba) on a regular basis. The use of any soap, polish or wax that contains an abrasive is detrimental, as the compounds scratch the finish and open it to corrosion.

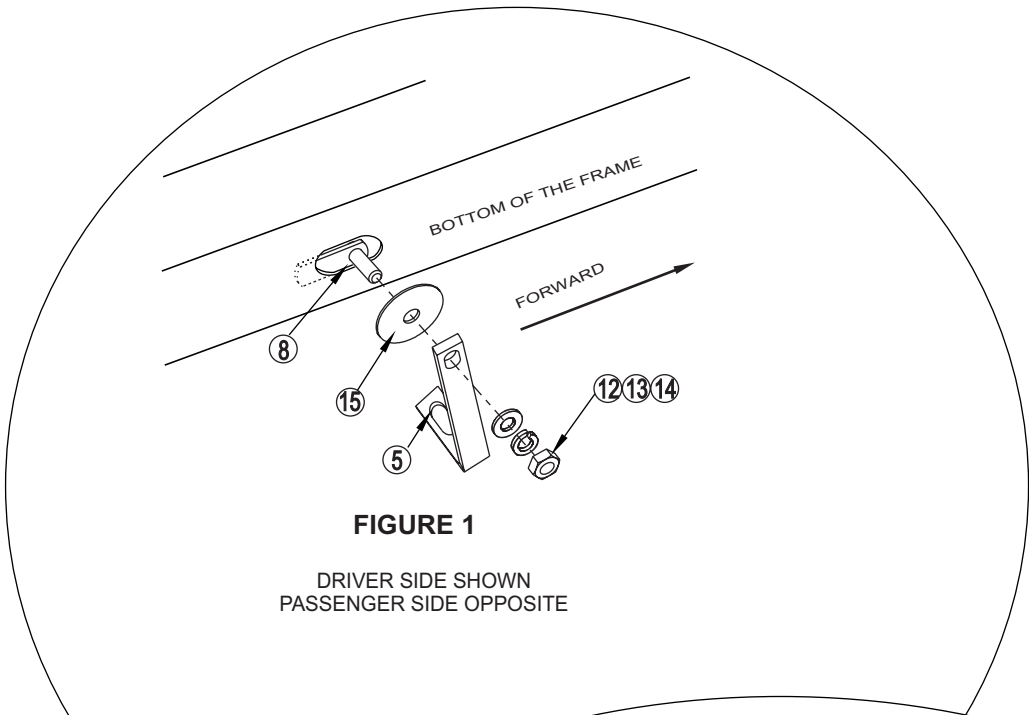

**FIGURE 1**

DRIVER SIDE SHOWN  
PASSENGER SIDE OPPOSITE

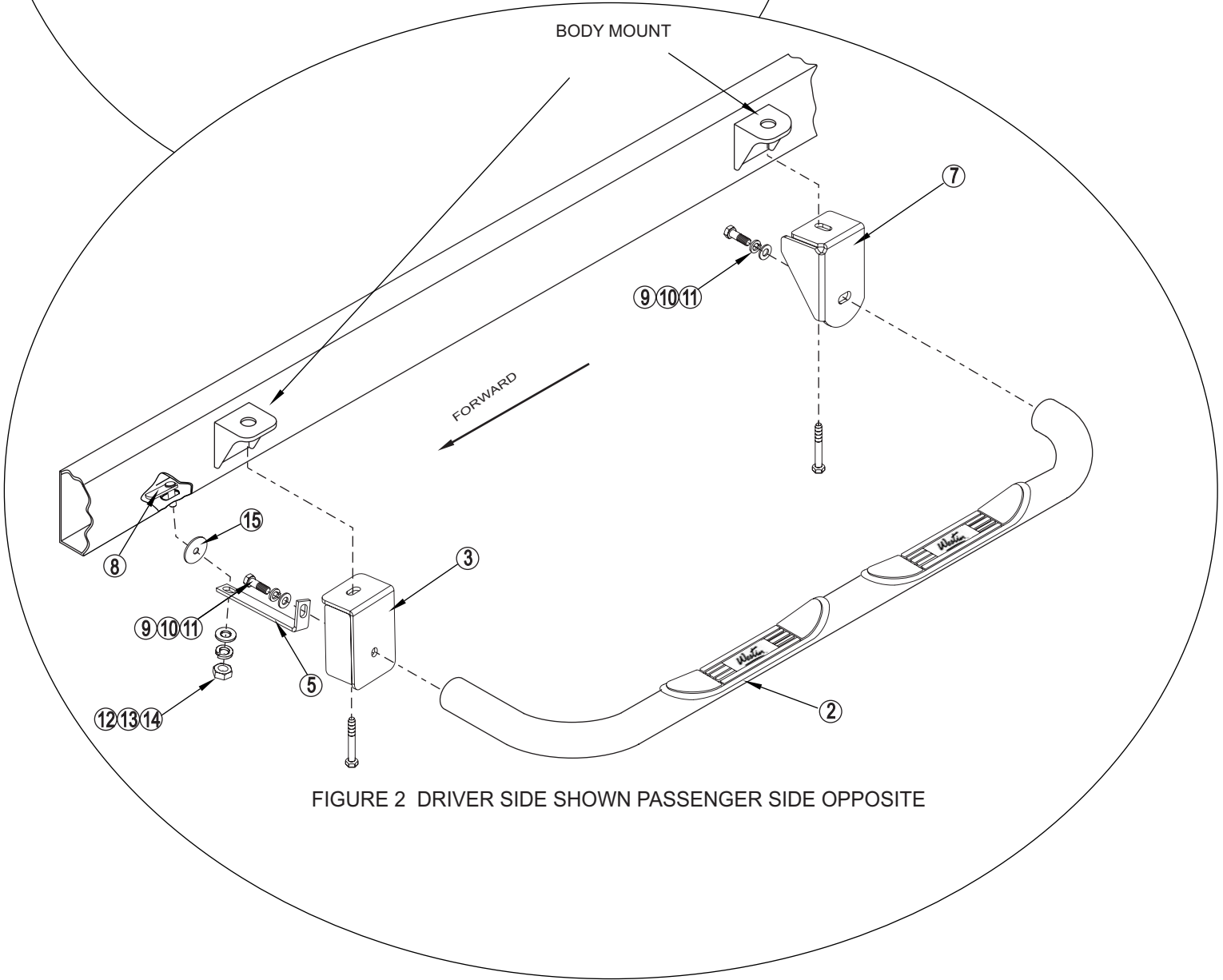

**FIGURE 2 DRIVER SIDE SHOWN PASSENGER SIDE OPPOSITE**