



INSTALLATION INSTRUCTIONS

APPLICATION: 1999 - UP FORD RANGER 4 - DOOR
 1999 - UP MAZDA TRUCK 4 - DOOR

AUTOMOTIVE PRODUCTS, INC.

STEP BAR
 ASSEMBLIES

23-1550
 23-1555

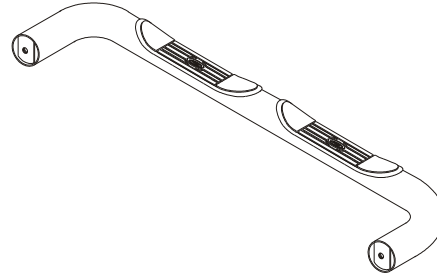

QTY	PARTS KIT CONTENTS DESCRIPTION	TOOLS REQUIRED
1	STEP BAR - DRIVER SIDE	3/4" SOCKET 9/16" SOCKET 9/16" WRENCH TORQUE WRENCH RATCHET
1	STEP BAR - PASSENGER SIDE	
1	FRONT BRACKET - DRIVER SIDE	
1	FRONT BRACKET - PASSENGER SIDE	
1	REAR BRACKET - DRIVER SIDE	
1	REAR BRACKET - PASSENGER SIDE	
1	NUT PLATE ASSY - DRIVER SIDE	
1	NUT PLATE ASSY - P ASSENGER SIDE	
1	SUPPORT STRAP - DRIVER SIDE	
1	SUPPORT STRAP - PASSENGER SIDE	
1	BACKING PLATE ASSY - DRIVER SIDE	
1	BACKING PLATE ASSY - P ASSENGER SIDE	
4	1/2 -13 X 2.50" LG. HEX HEAD BOLT	
4	1/2" FLAT WASHER, ZINC PLATED	
4	1/2" LOCK WASHER, ZINC PLATED	
12	3/8 -16 X 1.25" LG. HEX HEAD BOLT	
20	3/8" FLAT WASHER, ZINC PLATED	
12	3/8" LOCK WASHER, ZINC PLATED	
8	3/8 -16 HEX NUT	

- STEP 1. Remove the contents from the box and check for any damage. Verify all parts against parts list.
- STEP 2. Read and understand instructions completely before beginning installation.
- STEP 3. Install Front Brackets using hardware supplied and by following Figures 1 through 3.
- STEP 4. Mount Backing Plate to vehicle as shown in Figure 4.
- STEP 5. Attach Rear Bracket to vehicle and Backing Plate as shown in Figure 5.
- STEP 6. Attach Step Bars to Mounting Brackets.
- STEP 7. Tighten and torque 3/8" Fasteners to 30 FT. LBS. And 1/2" Fasteners to 65 FT. LBS.

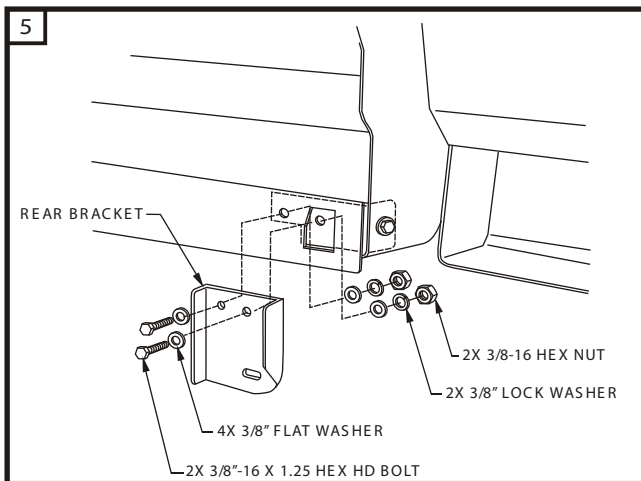
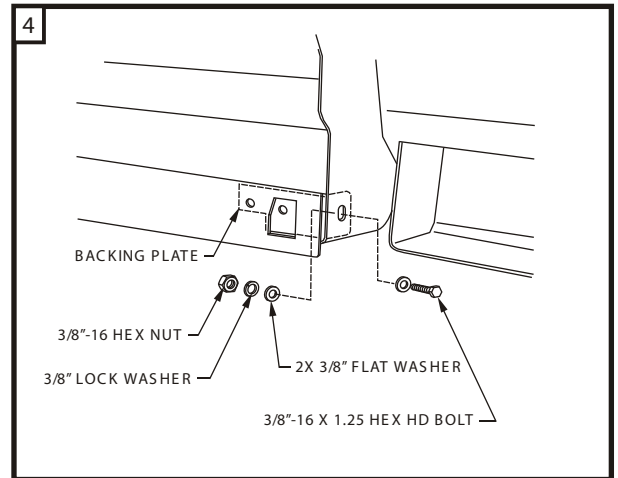
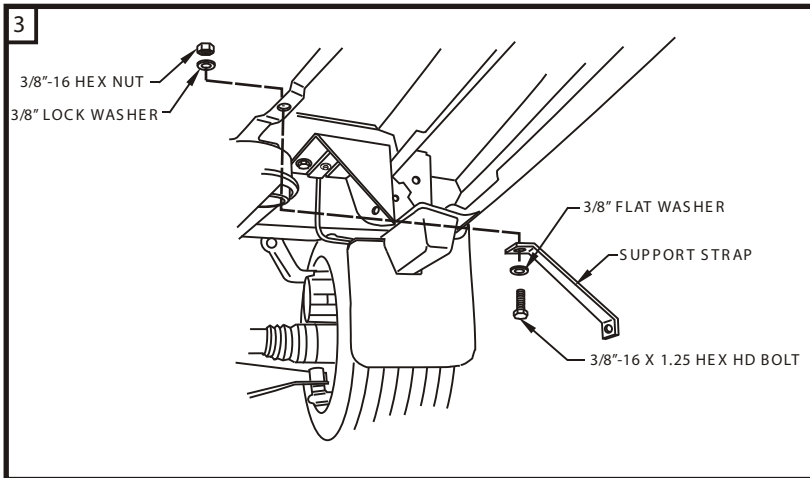
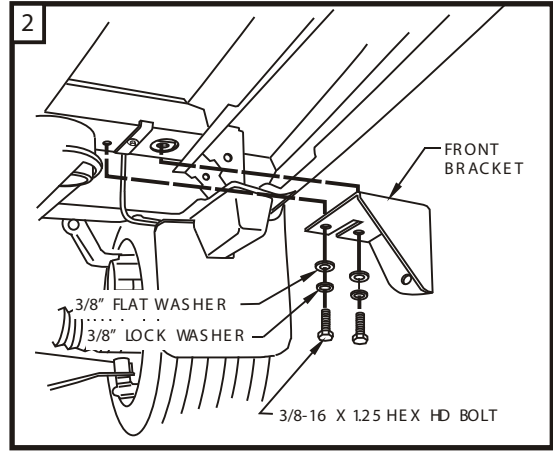
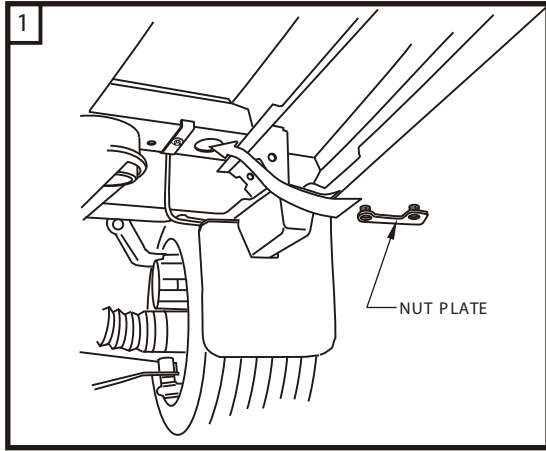

NOTE: INSTRUCTIONS SHOWN ARE FOR PASSENGER SIDE INSTALLATION. DRIVER SIDE INSTALLATION IS OPPOSITE.

Finish protection - Westin products have a high quality finish that must be cared for like any other exposed finish on the vehicle. Protect the finish with a non-abrasive automotive wax (pure carnauba, for example) on a regular basis. The use of cleaner wax or any compound which contains an abrasive is detrimental, as the compound scratches the finish and opens it to corrosion.