



SIGNATURE OF QUALITY

INSTALLATION INSTRUCTIONS

APPLICATION: 2008 TOYOTA HIGHLANDER

AUTOMOTIVE PRODUCTS, INC.

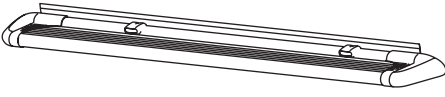
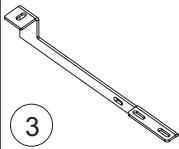
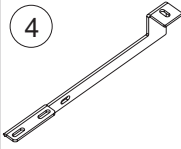
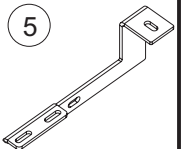
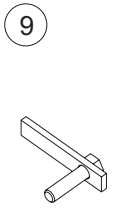
MOUNT KIT 27-1855	SURE-GRIP OPTIONAL					
SURE-GRIP BOARDS 27-6120 27-6125 27-6520	LIGHT KIT 27-6000					

ITEM	QTY	CONTENTS	TOOLS
1,2	2	STEP BOARD, PASSENGER (1) AND DRIVER (2) (PURCHASED SEPARATELY)	1/2" SOCKET 3/4" SOCKET 9/16" SOCKET RATCHET TORQUE WRENCH
3,4	2	FRONT BRACKET, PASSENGER (3) AND DRIVER (4)	
5,6	2	REAR BRACKET, PASSENGER (5) AND DRIVER (6)	
7,8	4	SUPPORT BRACE, PASSENGER (7) AND DRIVER (8)	
9	2	1/2" BOLT PLATE ASSEMBLY	
10	2	1/2" FLAT WASHER	
11	2	1/2" LOCK WASHER	
12	2	1/2-13 HEX NUT	
13	6	3/8-16 BRIDGE WELD NUT	
14	8	3/8-16 X 1.25" HEX HEAD BOLT	
15	2	3/8-16 X .75" HEX HEAD BOLT	
16	2	3/8" INTERNAL TOOTH LOCK WASHER	
17	14	3/8" FLAT WASHER	
18	8	3/8" LOCK WASHER	
19	8	3/8-16 HEX NUT	
20	8	5/16-18 X .75" SQUARE HEAD BOLT	
21	8	5/16" FLAT WASHER	
22	8	5/16-18 LOCK NUT	

- STEP 1. Remove the contents from box and check for damage. Verify all parts are present. Read instructions completely before beginning. It is strongly recommended to install the Sure Grip Gap Strip for these vehicle applications.
- STEP 2. Remove rubber plugs from rear mounting locations. Thread 3/8-16 x 1.25" hex head bolt through bridge weld nut. Insert assembled 3/8" bolt plate and 1/2" bolt plate as shown. **SEE FIGURE 1.**
- STEP 3. Attach support brace and rear bracket to bolt plates.
- STEP 4. Attach support brace to the rear brackets using 3/8" fasteners as shown. **SEE FIGURE 1.**
- STEP 5. Assemble support brace as shown in figure 2 leaving fasteners very loose. **NOTE:** Protruding end of bridge nut must face up.
- STEP 6. Remove rubber plugs from front mounting locations. Thread 3/8-16 x 1.25" hex head bolt through bridge weld nut. Insert assembled 3/8" bolt plate into inner hole and slide the bridge weld nut of the support brace assembly into outer hole. Be sure to keep the bridge nut assembled so as to not lose bridge nut in rocker panel.
- STEP 7. Attach front bracket to bolt plate and then to support brace using 3/8" fasteners. **SEE FIGURE 3.**
- STEP 8. Insert square head bolts as shown. (2 per slot, 4 per board). **SEE FIGURE 5.**
- NOTE:** For lighted boards, run wiring harness prior to attaching board to brackets (refer to Step 8). **SEE FIGURES 5 AND 6.** Run longer wire harness on passenger side.
- STEP 9. For Sure-Grip Running Boards, slide closure strip as shown. Set lights (if purchased) in appropriate location. Attach to Sure-Grip Running Board as shown. **SEE FIGURE 4.** Drill hole through plastic strip and run wires as shown. **SEE FIGURE 7.**
- STEP 10. Attach board to brackets as shown. Make sure board and brackets are properly aligned and tighten fasteners. Recommended torque values are 10 FT.LBS. for 5/16" square head fasteners, 26 FT.LBS. for 3/8" fasteners, and 64 FT. LBS for 1/2" fasteners. **SEE FIGURE 8.**

NOTE: For lighted version of Step board, remove plastic cover from each end of under side of Step board. Proceed to Steps 11 and 12.

WARNING: INSTALLING LIGHT HARNESS REQUIRES SPLICING INTO VEHICLES ELECTRICAL SYSTEM. WESTIN RECOMMENDS USING A PROFESSIONAL FOR THIS INSTALLATION. NOTE: AVOID AREAS OF EXCESSIVE HEAT, VIBRATION, PINCH OR ROTATION WHEN SECURING HARNESS TO VEHICLE. CAUTION: ALWAYS USE A FUSED (+) POSITIVE SUPPLY SOURCE. UNDERCOAT SEAL FOR HARSH WEATHER.

HINT: Step boards: For Longevity, check rubber seals before installation. Rubber grommets around red and blue wires going into rear sockets, should be inserted and recessed about 1/4". **NOTE:** Remove bulbs and apply white grease into sockets and replace bulbs. Apply RTV Silicone where lights go into socket. Install lights and run wire loom as shown. **SEE FIGURE 6.** For Sure-Grip Running Boards, run wire loom down center as shown. **SEE FIGURE 5.**

- STEP 11. Determine whether your vehicle has a positive or negative switching courtesy system or an auxiliary light source (most Fords). Obtain an accurate wiring diagram for your vehicle's courtesy light system.

For positive and negative switching:

Locate a pass-through point (usually under carpet at driver side door sill) for the wire harness. Locate main courtesy wire (usually wire lead to dome light). **NOTE:** If you do not use the main courtesy wire, lights will only function when one door is open. Route wire harness so that the 2 female connections (from step board) are nearest to pass thru point.*Connect opposite step board lead to either connection. Connect the splicing lead to remaining female socket and route one wire thru pass thru point. **SEE FIGURE 9.**

VERY IMPORTANT - Double check that your system has positive or negative switching.

For positive switching only: Connect positive wire to main courtesy system, (usually wire lead to dome light). **TEST CONTINUITY BEFORE CONNECTING BY OPENING AND CLOSING ALL DOORS.** Ground remaining wire.

For negative switching only: Connect negative wire to main courtesy system, (usually wire lead to dome light but sometimes from dome light to courtesy ECU). **TEST GROUND CONTINUITY BEFORE CONNECTING BY OPENING AND CLOSING ALL DOORS.** Connect remaining wire to battery using a 5A fuse.

TEST SOURCE BEFORE CONNECTING. Connect splicing leads to aux light source. test step board lights for proper function by opening and closing doors.

- STEP 12. Under-coat board, brackets and electrical wires, connections and lenses for harsh weather conditions. Reinstall plastic cover on underside of Step boards.

INSTALLATION IS COMPLETE.

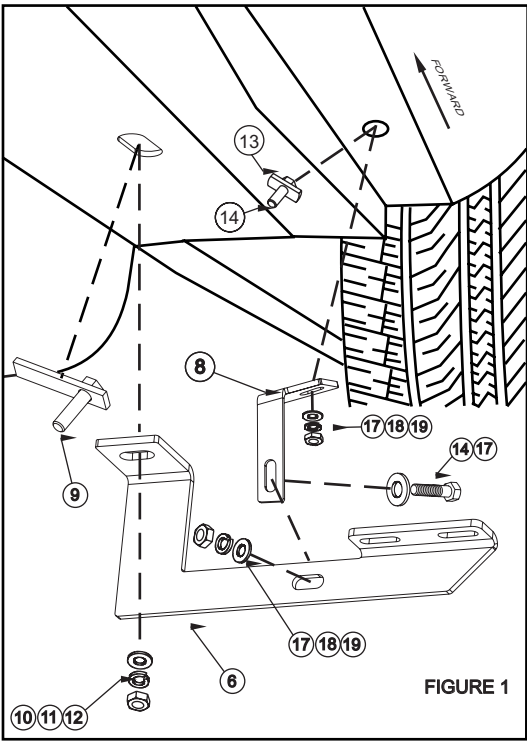

FIGURE 1

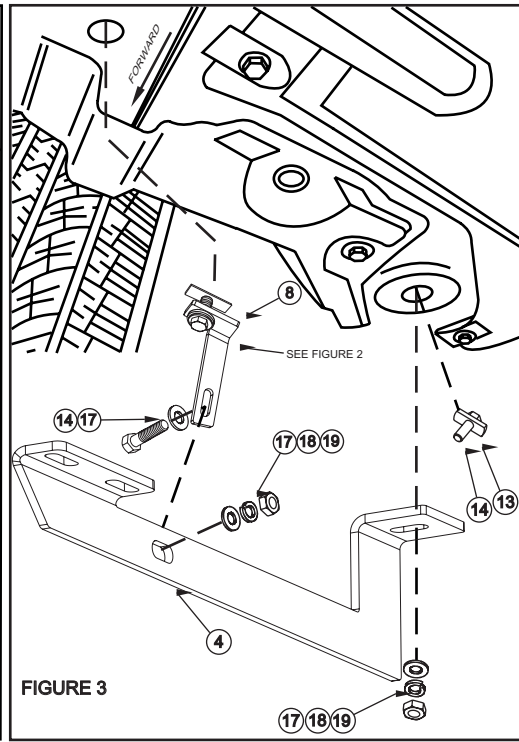

FIGURE 3

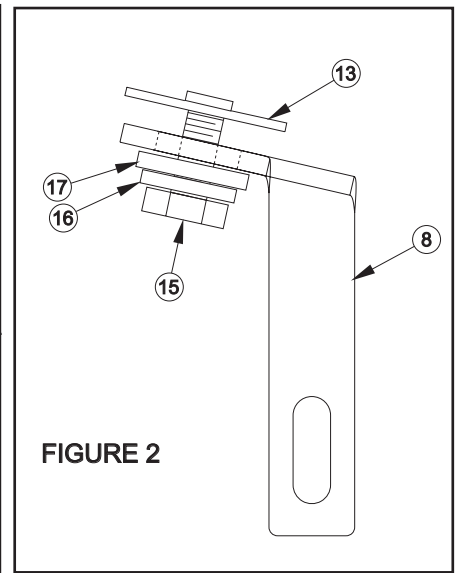

FIGURE 2

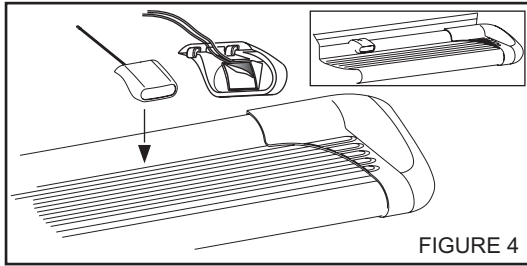

FIGURE 4

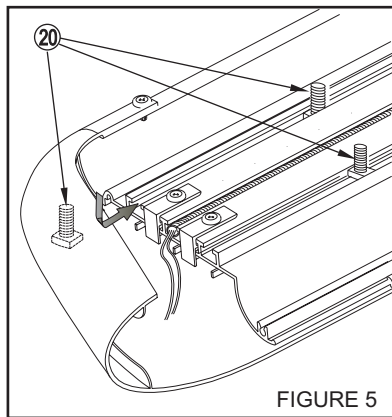

FIGURE 5

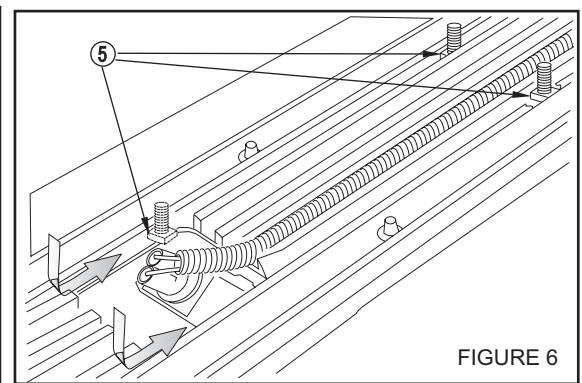

FIGURE 6

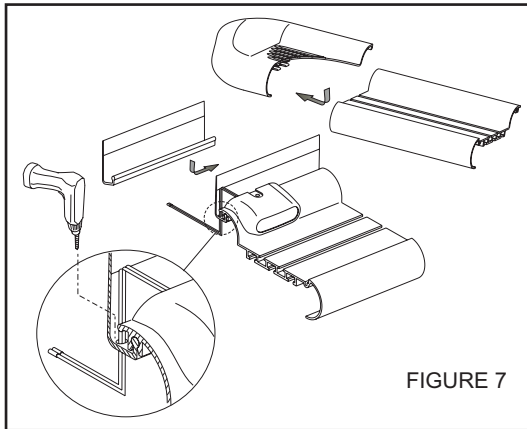

FIGURE 7

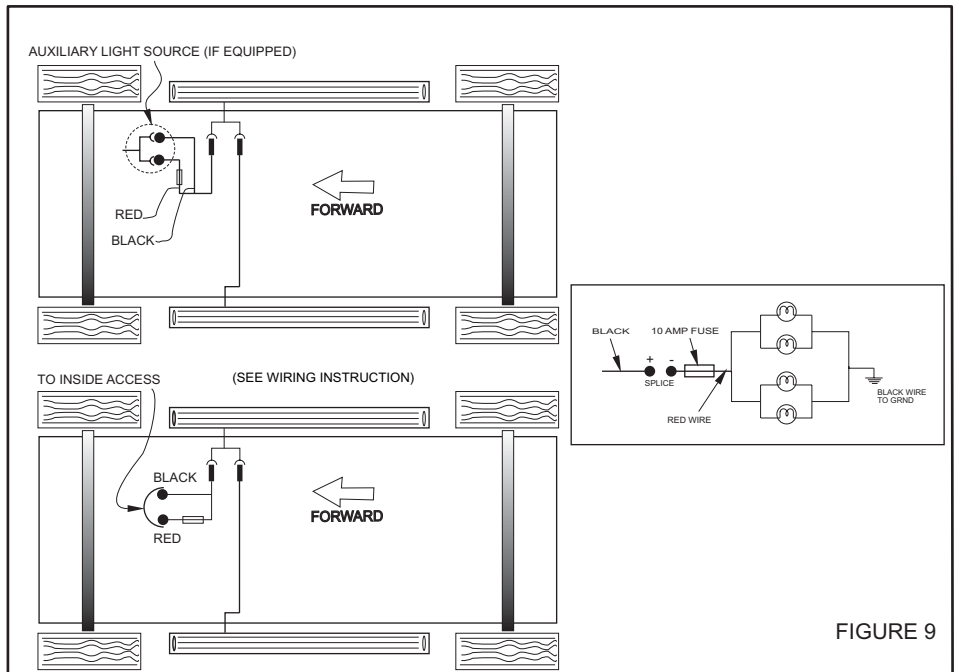

FIGURE 9

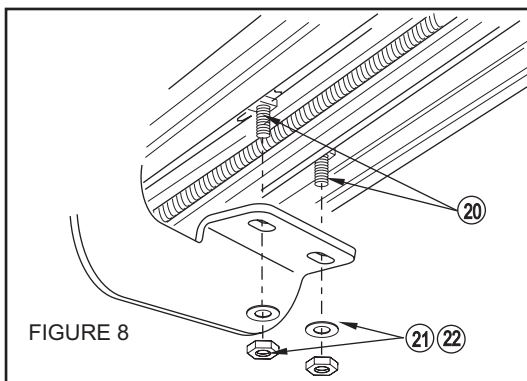

FIGURE 8