



SIGNATURE OF QUALITY

AUTOMOTIVE PRODUCTS, INC.

INSTALLATION INSTRUCTIONS

APPLICATION: 2001-10 SILVERADO/SIERRA 2500/3500 HD EXTENDED & CREW CAB
 2002-10 SILVERADO/SIERRA 1500 HD CREW CAB
 1999-10 SILVERADO/SIERRA EXTENDED CAB 1500/2500 LD
 2004-10 SILVERADO/SIERRA 1500 LD CREW CAB

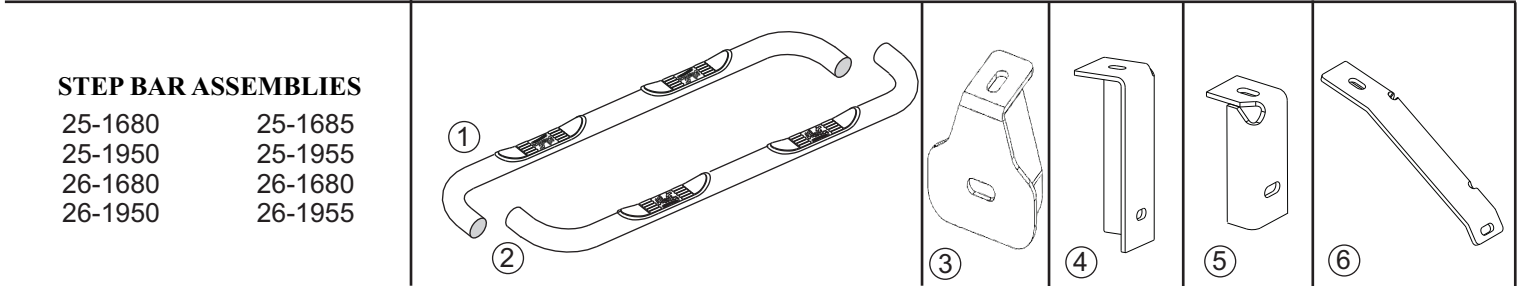

ITEM	QTY	CONTENTS	TOOLS
1,2	2	STEP BAR, PASSENGER (1) AND DRIVER (2)	3/4" SOCKET 3/4" WRENCH 9/16" SOCKET 19MM SOCKET 21MM SOCKET EXTENSION TORQUE WRENCH RATCHET
3	2	FRONT BRACKET	
4	2	REAR BRACKET (EXTENDED CAB ONLY)	
5	2	REAR BRACKET (CREW CAB)	
6	2	CENTER BRACKET	
7	6	M12-1.75 X 120MM HEX HEAD BOLT	
8	4	1/2-13 X 1.75" HEX HEAD BOLT	
9	10	1/2" FLAT WASHER	
10	10	1/2" LOCK WASHER	
11	2	3/8-16 x 1.00" HEX HEAD BOLT	
12	2	3/8" FLAT WASHER	
13	2	3/8" LOCK WASHER	

- STEP 1.** Remove contents from box and check for damage. Verify all parts are present. Read instructions completely before beginning.
- STEP 2.** Remove drivers side body mount bolts located under cab of vehicle. Keep existing washers and rubber bushings in place. Attach front bracket as shown. Leave loose.
NOTE: For 06'-UP trucks, use existing factory body mount bolts to attach all brackets to the vehicle (bolts and washers supplied in kit are not required). For all other applications, use bolts and washers provided in the kit and discard the factory body mount bolts.
- STEP 3.** Position front bracket up to the front body mount and attach with the appropriate fasteners. Adjust bracket in towards the frame so there is at least 1/8" clearance between the brackets and the body mount pocket. Hand tighten. **SEE FIGURE 1 AND 2.**
IMPORTANT NOTE: BRACKETS WILL NOT BE EXTENDED ALL THE WAY OUT WHEN FULLY TIGHTENED. As you tighten up the brackets, make sure you maintain the desired clearance between the bracket and the body mount pocket.
- STEP 4.** Attach brackets as shown. Hand tighten. **SEE FIGURE 1.**
- STEP 5.** Attach step bar as shown. Hand tighten. The step pad closer to the bend goes to the rear of the vehicle. **SEE FIGURE 1.**
- STEP 6.** Make sure step bar and brackets are properly aligned and tighten fasteners. Recommended torque values are 74 Ft.Lbs. for factory bolts, 50-55 Ft.Lbs. for 1/2" fasteners, 40-45 Ft.Lbs. for M12 fasteners and 20-25 FT.LBS. for 3/8" fasteners. **NOTE:** Westin advises the installer to use a thread lubricant such as Permatex Anti-Seize on the 1/2-13 bolt threads for stainless steel applications.
- STEP 7.** Repeat for passenger side.

FINISH PROTECTION
 Westin products have a high quality finish that must be cared for like any other exposed finish on the vehicle. Protect the finish with a non-abrasive automotive wax, (e.g. Pure Carnauba) on a regular basis. The use of any soap, polish or wax that contains an abrasive is detrimental, as the compounds scratch the finish and open it to corrosion.

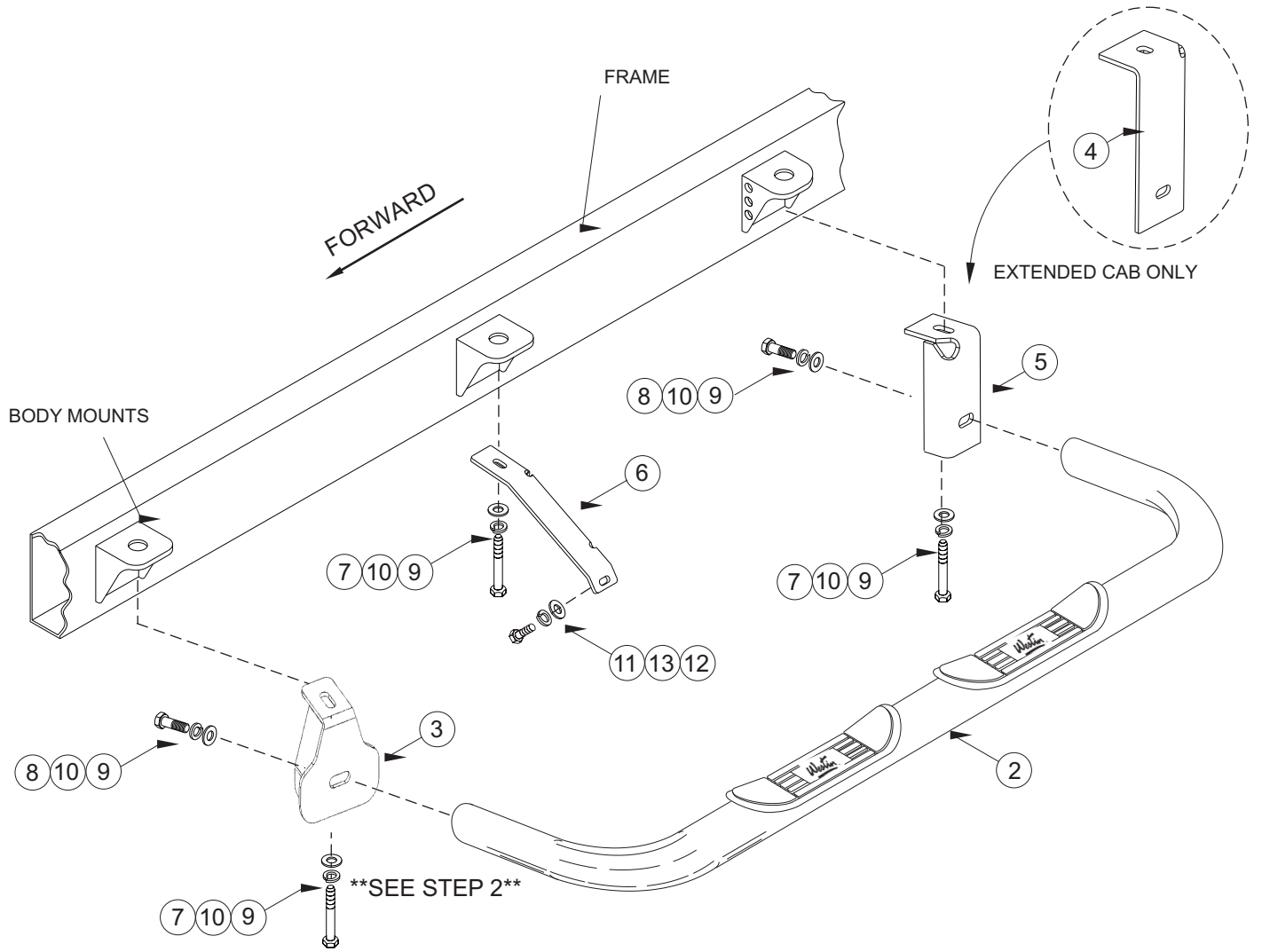

FIGURE 1
 INSTALLATION VIEW OF DRIVER SIDE SHOWN, PASSENGER SIDE OPPOSITE

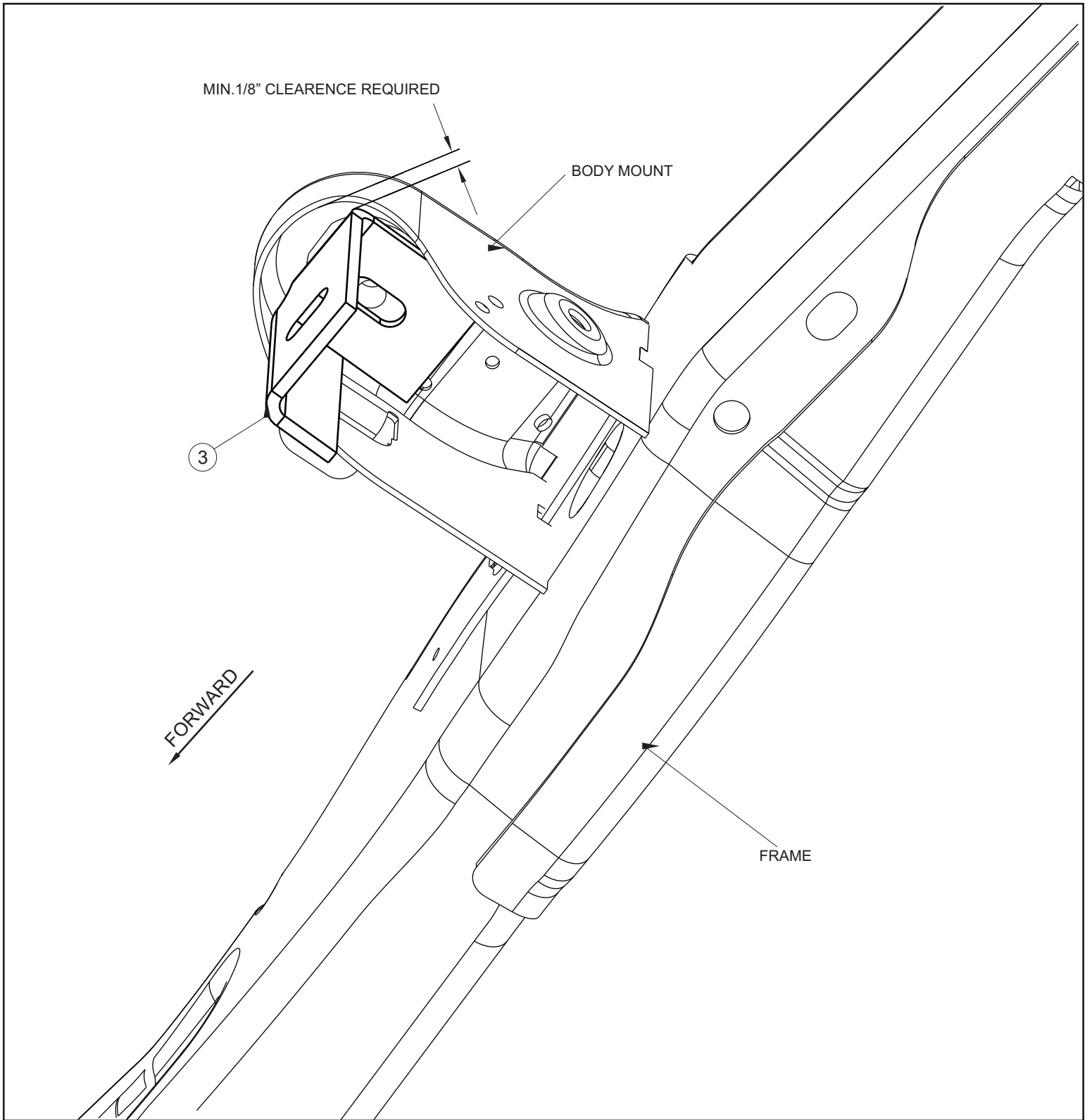

FIGURE 2 DRIVER SIDE FRONT BODY MOUNT