

Westin

SIGNATURE OF QUALITY

AUTOMOTIVE PRODUCTS, INC.

INSTALLATION INSTRUCTIONS

APPLICATION: 1999-UP JEEP GRAND CHEROKEE

STEP BAR ASSEMBLIES

25-1470
25-1475
26-1470
26-1475

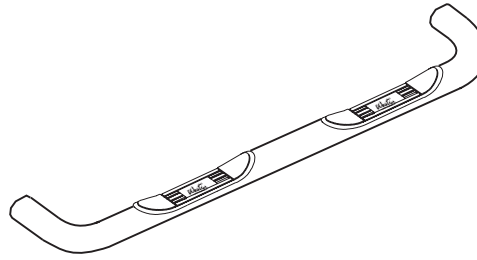

ITEM	QTY	CONTENTS	TOOLS
1	2	STEP BAR, PASSENGER AND DRIVER	3/4" SOCKET 3/4" WRENCH RATCHET TORQUE WRENCH
2	2	FRONT BRACKET, PASSENGER AND DRIVER	
3	2	REAR BRACKET, PASSENGER AND DRIVER	
4	4	THREADED MOUNT PLATE	
5	4	1/2-13 X 1.75" HEX HEAD BOLT	
6	8	1/2-13 X 1.25" HEX HEAD BOLT	
7	12	1/2" FLAT WASHER	
8	12	1/2" LOCK WASHER	

- STEP 1. Remove the contents from box and check for damage. Verify all parts are present. Read instructions completely before beginning.
- STEP 2. Determine passenger and driver brackets. Attach front and rear brackets to step bars using 1/2" fasteners as shown. Leave loose. **NOTE:** Long leg of step bar goes to front.
- STEP 3. Attach front/rear brackets to front/rear suspensions mounts using 1/2" fasteners and threaded mount plates as shown.
- STEP 4. Make sure step bar is properly aligned with vehicle body. Torque 1/2" fasteners to 65 FT.LBS.

FINISH PROTECTION

Westin products have a high quality finish that must be cared for like any other exposed finish on the vehicle. Protect the finish with a non-abrasive automotive wax, (e.g. Pure Carnauba) on a regular basis. The use of any soap, polish or wax that contains an abrasive is detrimental, as the compounds scratch the finish and open it to corrosion.

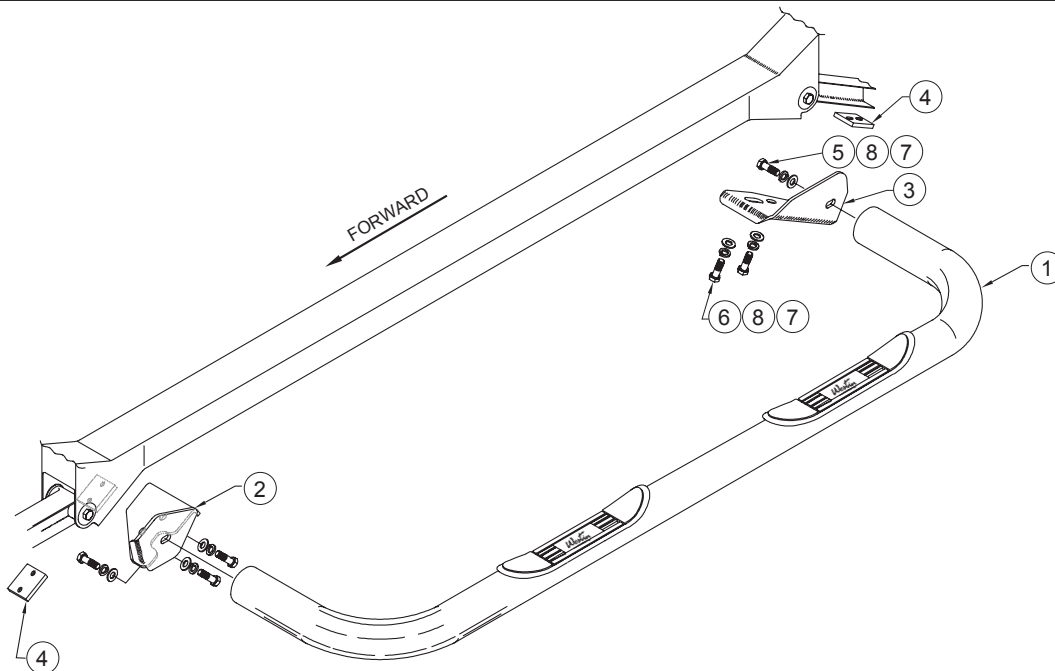

Choose reliable running boards offered on our website.