



SIGNATURE OF QUALITY

AUTOMOTIVE PRODUCTS, INC.

INSTALLATION INSTRUCTIONS

APPLICATION: 1997-04 FORD F-150/250LD REGULAR/ 1999-04 SUPER CAB 4DOOR (04' HERITAGE)
1997-98 FORD F-150/250LD SUPER CAB 3DR

STEP BAR ASSEMBLIES							
25-1100	25-1105						26-1100
25-1110	25-1115	26-1110					
25-1430	25-1435	26-1430					

ITEM	QTY	CONTENTS	TOOLS
1,2	2	STEP BARS, PASSENGER (1) AND DRIVER (2)	3/4" SOCKET 3/4" WRENCH 9/16" SOCKET RATCHET TORQUE WRENCH
3,4	2	FRONT BRACKET, PASSENGER (3) AND DRIVER (4)	
5,6	2	REAR BRACKET, PASSENGER (5) AND DRIVER (6)	
7	2	FRONT STRAP	
8,9	2	REAR STRAP, PASSENGER (8) AND DRIVER (9)	
10	4	1/2-13 X 2.00" HEX HEAD BOLT	
11	4	1/2-13 X 1.50" HEX HEAD BOLT	
12	12	1/2" FLAT WASHER	
13	8	1/2" LOCK WASHER	
14	4	1/2-13 HEX NUT	
15	8	3/8" FLAT WASHER	
16	8	3/8" LOCK WASHER	
17	8	3/8-16 HEX NUT	
18	4	BOLT PLATE (LARGE)	
19	1	BOLT PLATE (SMALL)	

- STEP 1. Remove contents from box and check for damage. Verify all parts are present. Read instructions completely before beginning.
- STEP 2. Remove existing plugs from underside of cab as shown. SEE FIGURE 1.
- STEP 3. Insert bolt plates as shown. SEE FIGURES 1 AND 5.
NOTE: 97-98 Extended cab driver side rear bracket uses smaller bolt plate and lower bracket holes. SEE FIGURES 2 AND 6.
- STEP 4. Install front and rear brackets as shown. Hand tighten. SEE FIGURES 1-2.
- STEP 5. Attach front and rear straps as shown. Hand tighten. SEE FIGURES 3-4.
- STEP 6. Attach step bar as shown. SEE FIGURES 1-4.
NOTE: 2-door vehicle applications have the step pad located on the tubes closer to the front of the vehicle. 3-door vehicle applications have the single step pad tube on the drivers side of the vehicle. 4-door vehicle applications have two step pads on each bar. One step pad is closer to the bend than the other step pad. The step pad closer to the bend goes to the rear of the vehicle.
- STEP 7. Make sure step bar and brackets are properly aligned and tighten fasteners. Recommended torque values are 64 Ft.Lbs. for 1/2" fasteners and 26 FT.LBS. for 3/8" fasteners.
NOTE: Westin advises the installer to use a thread lubricant on the 1/2-13 bolt threads for stainless steel applications.

FINISH PROTECTION

Westin products have a high quality finish that must be cared for like any other exposed finish on the vehicle. Protect the finish with a non-abrasive automotive wax, (e.g. Pure Carnauba) on a regular basis. The use of any soap, polish or wax that contains an abrasive is detrimental, as the compounds scratch the finish and open it to corrosion.

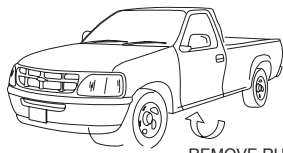

REMOVE RUBBER PLUGS BEFORE INSTALL.
(SEE FIGURE 5 & 6)

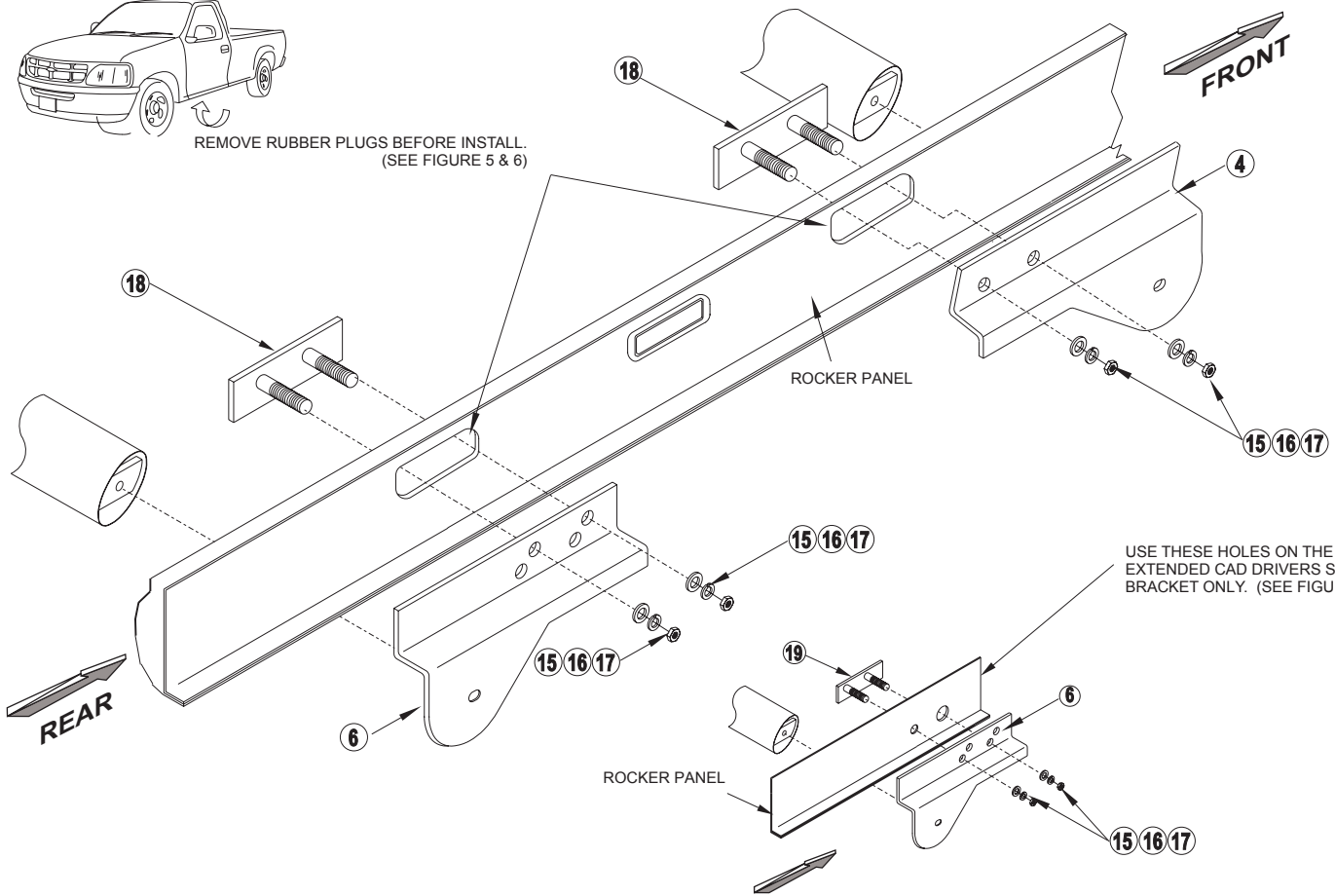

FIGURE 1 DRIVER SIDE REG CAB SHOWN

FIGURE 2 DRIVER SIDE EXTENDED CAB, REAR SHOWN

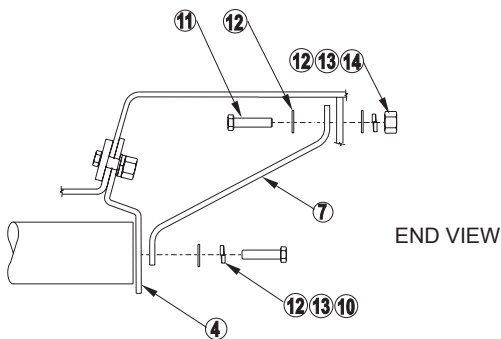
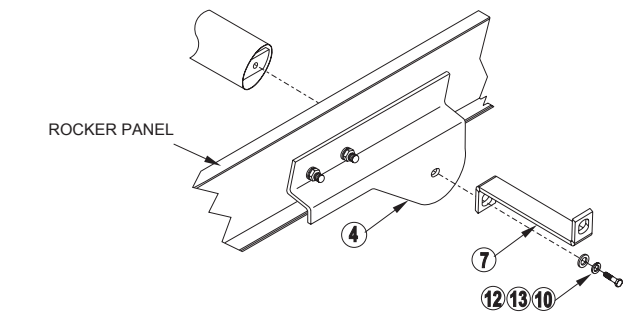

FIGURE 3 DRIVER SIDE SHOWN (FRONT BRACE)

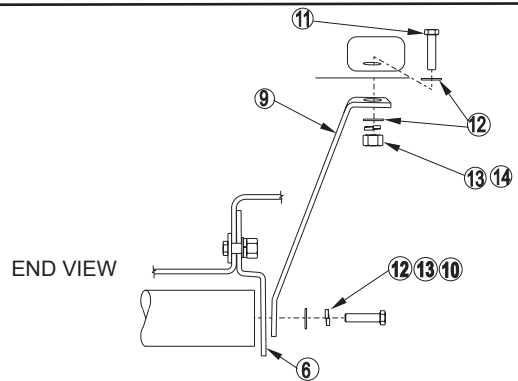
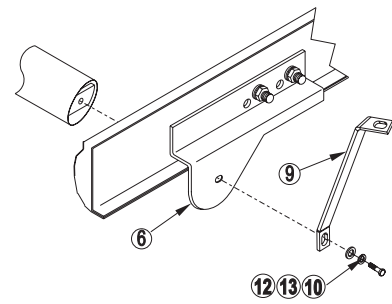

FIGURE 4 DRIVER SIDE SHOWN (REAR BRACE)



STEP 1. STEP REMOVE THE RUBBER PLUG

STEPS 2,3 AND 4. INSERT BOLT PLATE AS SHOWN.



BOLT PLATE INSTALLATION FIGURE 5



STEP 1. STEP REMOVE THE RUBBER PLUGS

STEPS 2,3 AND 4. INSERT BOLT PLATE AS SHOWN



1997-98 EXTENDED CAB 3 DOOR DRIVER SIDE REAR ONLY. BOLT PLATE INSTALLATION FIGURE 6