



SIGNATURE OF QUALITY

AUTOMOTIVE PRODUCTS, INC.

INSTALLATION INSTRUCTIONS

APPLICATION: 1997-06 JEEP WRANGLER

2005-06 JEEP WRANGLER UNLIMITED

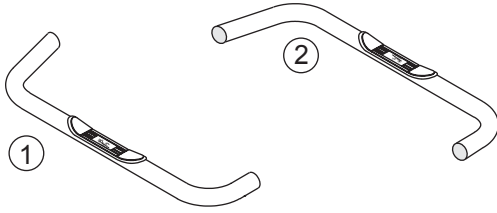
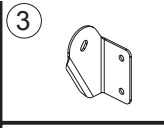
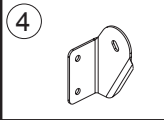
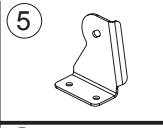
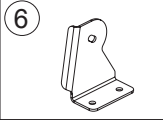
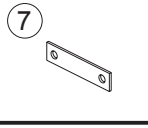
STEP BAR ASSEMBLIES							
25-0970	25-0975						
25-2850	25-2855						

ITEM	QTY	CONTENTS	TOOLS
1,2	2	STEP BAR, PASSENGER (1) AND DRIVER (2)	3/4" SOCKET 3/4" WRENCH RATCHET TORQUE WRENCH
3,4	2	FRONT BRACKET, PASSENGER (3) AND DRIVER (4)	
5,6	2	REAR BRACKET, PASSENGER (5) AND DRIVER (6)	
7	4	MOUNT PLATE	
8	4	1/2-13 X 1.75" HEX HEAD BOLT	
9	8	1/2-13 X 1.00" HEX HEAD BOLT	
10	12	1/2" FLAT WASHER	
11	12	1/2" LOCK WASHER	

STEP 1. Remove the contents from box and check for damage. Verify all parts are present. Read instructions completely before beginning.

NOTE: Wrangler Sport models must have factory step pad removed for installation.

STEP 2. Attach step bars to brackets using 1/2" fasteners as shown. Leave loose.

STEP 3. Place threaded mount plates through underside of suspension so that the holes line up as shown. Attach brackets to mount plates using 1/2" fasteners as shown. SEE FIGURE. Make sure step bar and brackets are properly aligned with vehicle and tighten all fasteners. Recommended torque value is 64 Ft. Lbs. for 1/2" fasteners.

FINISH PROTECTION

Westin products have a high quality finish that must be cared for like any other exposed finish on the vehicle. Protect the finish with a non-abrasive automotive wax, (e.g. Pure Carnauba) on a regular basis. The use of any soap, polish or wax that contains an abrasive is detrimental, as the compounds scratch the finish and open it to corrosion.

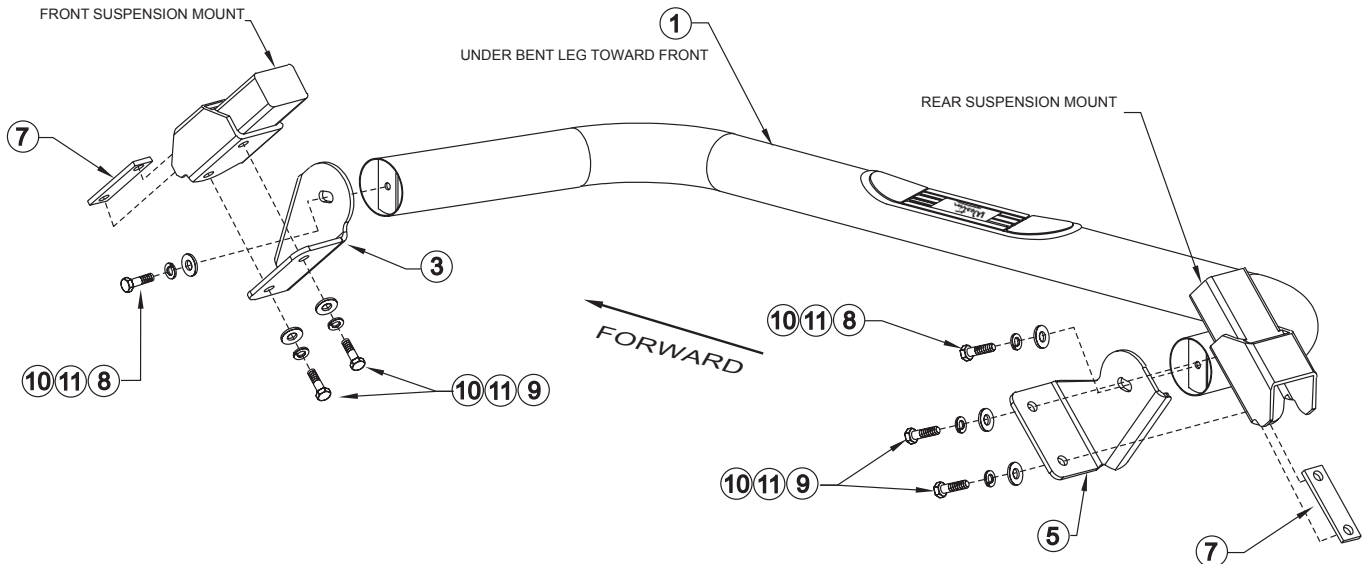

INSTALLATION VIEW OF PASSENGER SIDE SHOWN, DRIVER SIDE OPPOSITE

Choose reliable running boards offered on our website.