

Westin

SIGNATURE OF QUALITY

AUTOMOTIVE PRODUCTS, INC.

INSTALLATION INSTRUCTIONS

APPLICATION: 2007-UP JEEP WRANGLER UNLIMITED 2/4 DOORS

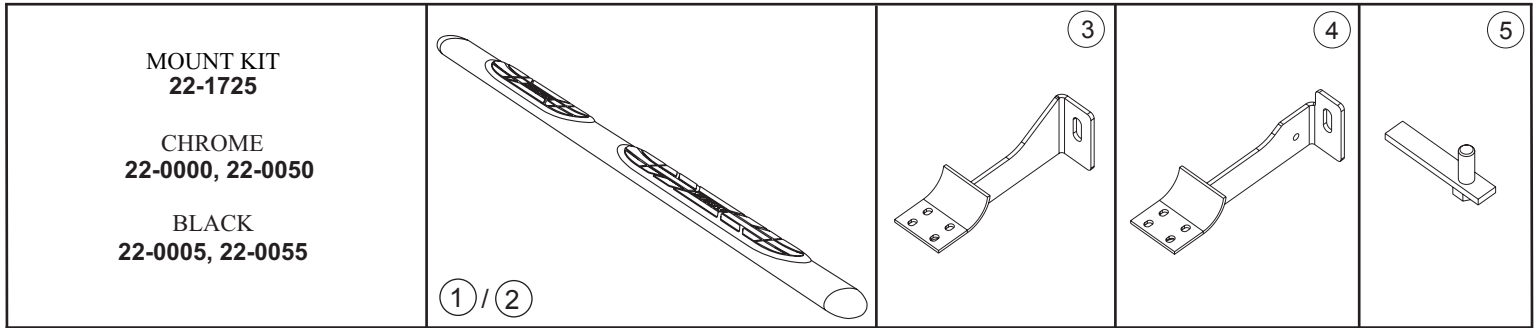

ITEM	QTY	CONTENTS	TOOLS
1,2	2	STEP BAR, PASSENGER (1) AND DRIVER (2)	3/4" SOCKET 3/4" WRENCH 7/32" HEX WRENCH RATCHET TORQUE WRENCH
3	2	FRONT BRACKET	
4	2	REAR BRACKET	
5	1	BOLT PLATE	
6	1	SQUARE PLASTIC WASHER	
7	5	SPACER WASHER	
8	3	1/2-13 X 4.50" HEX HEAD BOLT	
9	4	1/2" FLAT WASHER	
10	4	1/2" LOCK WASHER	
11	4	1/2-13 HEX NUT	
12	8	1/4-20 X .75 T-HEAD BOLT	
13	8	1/4" FLAT WASHER	
14	8	1/4-20 NYLON INSERT LOCK NUT	

- STEP 1.** Remove the contents from box and check for damage. Verify all parts are present. Read instructions completely before beginning.
- STEP 2.** Determine front and rear brackets.
CAUTION: Exhaust system maybe hot. Some of the installation will be close to the exhaust system.
- STEP 3.** Locate hole on drivers side of frame in front of the rear tire. **SEE FIGURE 1.** Attach the spacer washer to the 1/2-13 x 4.50" hex head bolt. Insert bolt through the backside of frame. Place another spacer washer on the front side of frame. Attach drivers side rear bracket to bolt and secure with a 1/2" fasteners. Leave loose. **SEE FIGURE 1.**
- STEP 4.** Locate front hole on drivers side of frame behind the front tire. **SEE FIGURE 2.** Attach the spacer washer to the 1/2-13 x 4.50" hex head bolt. Insert bolt through the backside of frame. Attach drivers side front bracket to bolt and secure with a 1/2" fasteners. Leave loose. Repeat for passenger side.
- STEP 5.** Locate rear hole on passengers side of frame. **SEE FIGURE 3.** Insert bolt plate through square opening on the backside of frame. Secure in place with plastic washer. Place spacer washer over the plastic washer. Attach drivers side rear bracket to bolt and secure with a 1/2" fasteners. Leave loose. **SEE FIGURE 4.**
- STEP 6.** Slide t-head bolts on step bar as shown (2 per slot, 4 per bar). Place step bar on saddle with long step pad forward and end cap screw facing inward. Assemble with 1/4" fasteners. **SEE FIGURES 5 AND 6.** Repeat for opposite side.
- STEP 7.** Make sure step bar and brackets are properly aligned and tighten fasteners. Recommended torque values are 64 FT.LBS for 1/2" fasteners and 7 FT.LBS. for 1/4" fasteners.

FINISH PROTECTION

Westin products have a high quality finish that must be cared for like any other exposed finish on the vehicle. Protect the finish with a non-abrasive automotive wax, (e.g. Pure Carnauba) on a regular basis. The use of any soap, polish or wax that contains an abrasive is detrimental, as the compounds scratch the finish and open it to corrosion.

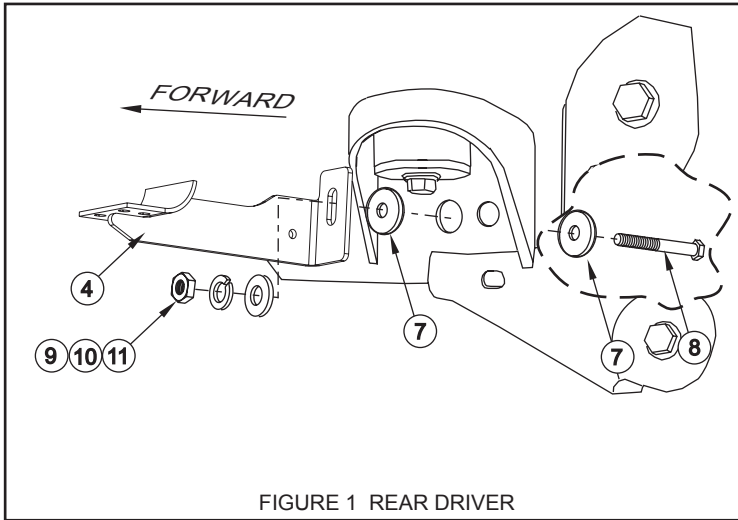

FIGURE 1 REAR DRIVER

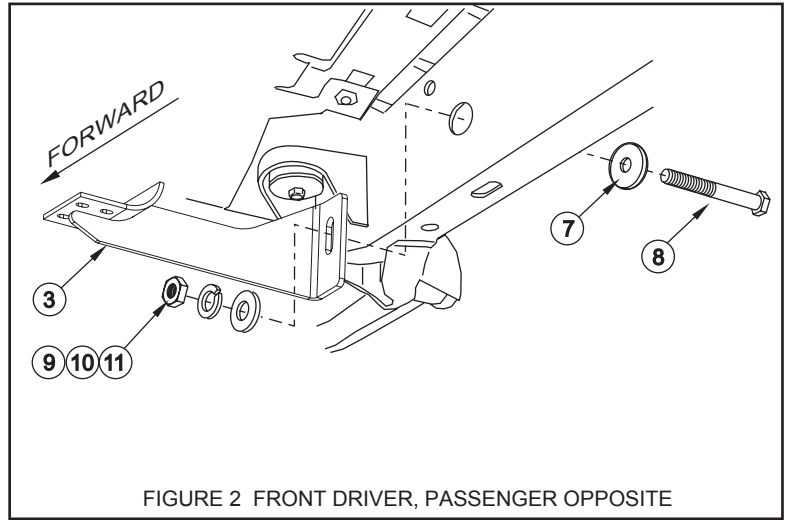

FIGURE 2 FRONT DRIVER, PASSENGER OPPOSITE

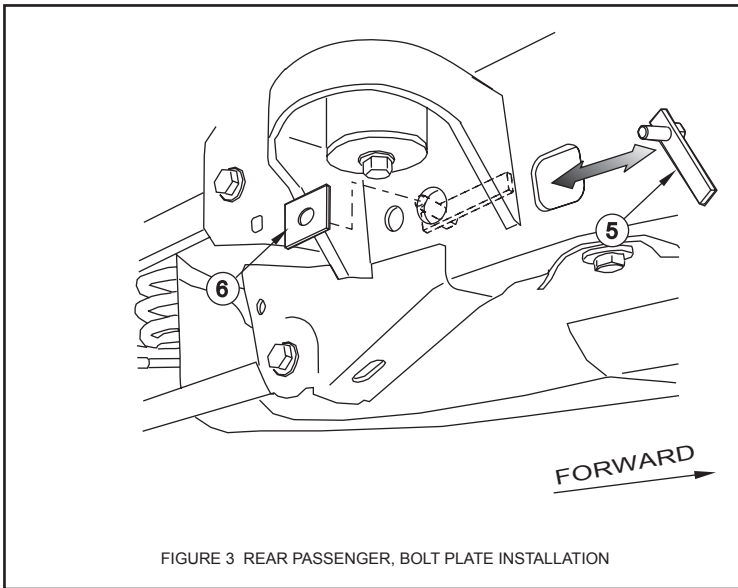

FIGURE 3 REAR PASSENGER, BOLT PLATE INSTALLATION

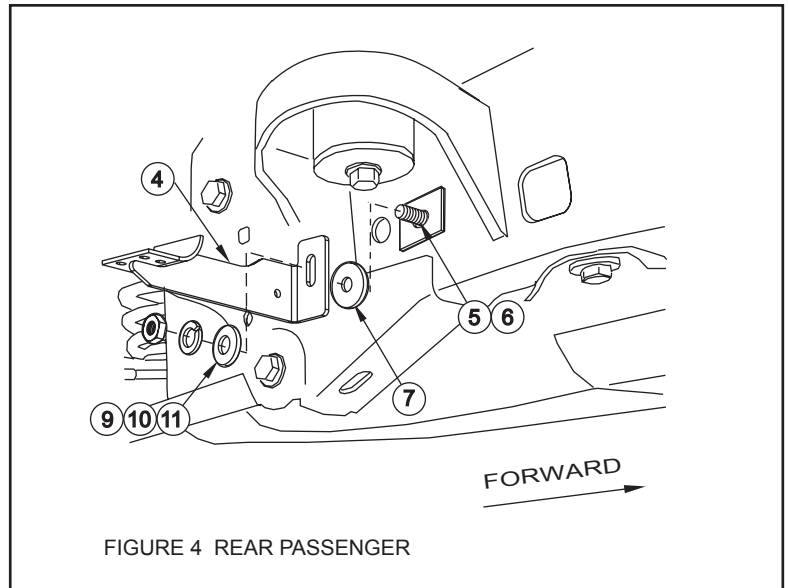

FIGURE 4 REAR PASSENGER

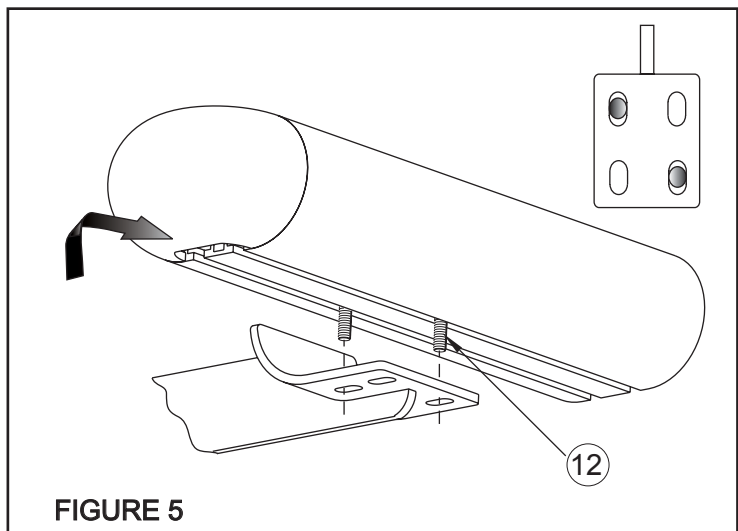

FIGURE 5

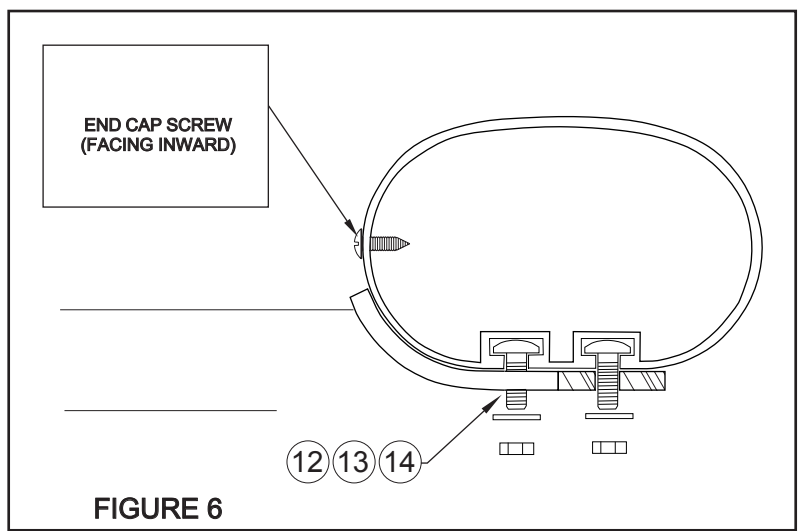

FIGURE 6