





SIGNATURE OF QUALITY

AUTOMOTIVE PRODUCTS, INC.

## INSTALLATION INSTRUCTIONS

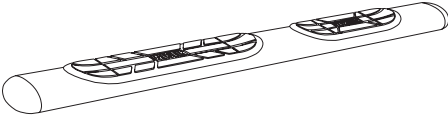
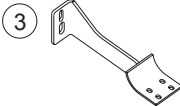
APPLICATION: 2006-UP FORD EXPLORER 4 DOOR  
2007-UP FORD EXPLORER SPORT TRAC

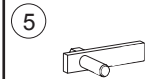
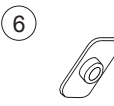
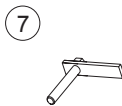
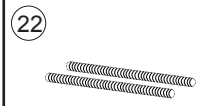
MOUNT KIT 22-1575					
EXPLORER 22-0020 22-0025	EXPLORER SPORT TRAC 22-0030 22-0035				

ITEM	QTY	CONTENTS	TOOLS
1,2	2	STEP BAR, PASSENGER (1) AND DRIVER (2)	3/4" SOCKET 3/4" DEEP WELL SOCKET 9/16" SOCKET 7/16" SOCKET 3/4" WRENCH RATCHET TORQUE WRENCH
3	2	MOUNT ASSEMBLY PASSENGER	
4	2	MOUNT ASSEMBLY DRIVER	
5	1	1/2-13 x 1.50" BOLT PLATE ASSEMBLY (FRONT PASSENGER SIDE)	
6	1	BOLT PLATE (REAR PASSENGER SIDE)	
7	1	1/2-13 x 3.00" BOLT PLATE ASSEMBLY (FRONT DRIVER SIDE)	
8	1	1/2-13 X 6.00" HEX HEAD BOLT	
9	3	1/2" FLAT WASHER	
10	5	1/2" LOCK WASHER	
11	5	1/2-13 HEX NUT	
12	1	3/8-16 X 2.00" HEX HEAD BOLT	
13	1	3/8" FLAT WASHER	
14	1	3/8" LOCK WASHER	
15	1	3/8-16 HEX NUT	
16	8	1/4-20 X .75 T-HEAD BOLT	
17	8	1/4" FLAT WASHER	
18	8	1/4-20 NYLON INSERT LOCK NUT	
19	3	SPACER WASHER	
20	2	SQUARE PLASTIC WASHER	
21	1	ROUND PLASTIC WASHER	
22	4	PROTECTIVE TUBING FOR BRAKE LINES	

- STEP 1. Remove the contents from box and check for damage. Verify all parts are present. Read instructions completely before beginning.
- STEP 2. Determine passenger and driver brackets.
- STEP 3. Locate the rectangular hole along the side of the frame behind the front tire on the drivers side.
- STEP 4. Attach square plastic washer to the 1/2-13 x 3.00" bolt plate assembly. Insert bolt plate into rectangular hole as shown. **SEE FIGURES 1 AND 4.** Secure bolt plate to vehicle frame using the spacer washer, 1/2" lock washer, and 1/2-13 hex nut. Torque to 65 Ft.Lbs.
- STEP 5. Install protective tubing over the two brake lines above and below the bolt plate. **SEE FIGURE 5.** Install front driver side bracket over the bolt and secure with 1/2" flat washer, lock washer and hex nut as shown. **SEE FIGURES 4 AND 5.** Leave loose. **NOTE:** Make sure brake lines are not under contact points of bracket and spacer washer.
- STEP 6. Locate the round hole along the side of the frame in front of the rear tire on the drivers side.
- STEP 7. Attach the large spacer washer to the 1/2-13 x 6.00" hex head bolt. Insert bolt through hole on backside of frame. Place another spacer washer on the front side of frame. Center bolt and spacer washers and secure with 1/2" lock washer and hex nut. Torque to 65 Ft.Lbs. **SEE FIGURES 4 AND 6.**
- STEP 8. Install protective tubing over the two brake lines above and below the bolt. **SEE FIGURE 6. NOTE:** Make sure brake lines are not under contact points of bracket and spacer washer. Install driver side rear bracket over bolt using 1/2" fasteners as shown. Leave loose. **SEE FIGURES 4 AND 6.**
- STEP 9. Locate the rectangular hole along the side of the frame behind the front tire on the passengers side.
- STEP 10. Attach square plastic washer to the 1/2-13 x 1.50" bolt plate assembly. Insert bolt plate into rectangular hole as shown. **SEE FIGURES 3 AND 7.** Install passenger side front bracket over the bolt and secure with 1/2" flat washer, lock washer hex nut as shown. Leave loose.
- STEP 11. Locate the round hole along the side of the frame in front of the rear tire on the passenger side.
- STEP 12. Thread bolt plate onto 3/8-16 x 2.00" bolt and torque to 30 ft-lbs. **SEE FIGURE 10.** Attach the round plastic washer to the 3/8" bolt plate assembly. Insert bolt plate into round hole as shown. **SEE FIGURES 2 AND 7.** Install passenger side rear bracket over the bolt and secure with 3/8" flat washer, lock washer and hex nut as shown. Leave loose. **SEE FIGURE 7.**
- STEP 13. Slide T-head bolts on step bar as shown (2 per slot, 4 per bar. **SEE FIGURE 8.** Place step bar on saddle with long step pad forward and end cap screw facing inward. Assemble with 1/4" fasteners. **SEE FIGURE 9.**
- STEP 14. Make sure step bar and brackets are properly aligned and tighten fasteners. Recommended torque values are 64 FT.LBS. for 1/2" fasteners, 26 FT.LBS. for 3/8" fasteners and 7 FT.LBS. for 1/4" fasteners.

**FIGURE 1 DRIVER SIDE FRONT**

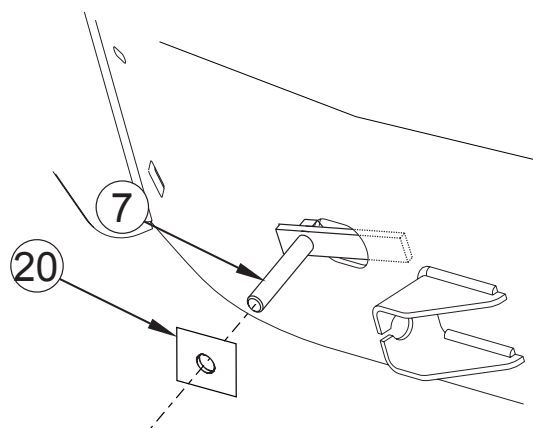

**FIGURE 2 PASSENGER SIDE REAR**

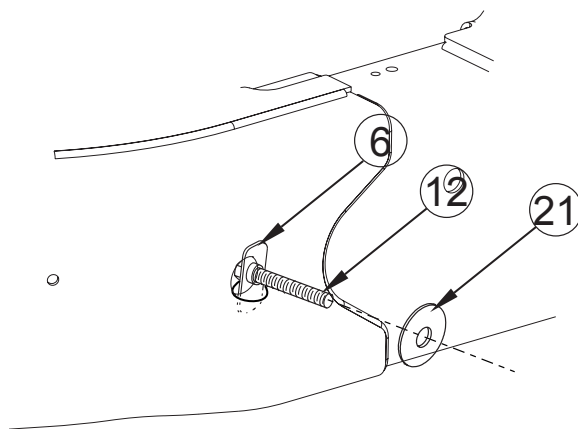

**FIGURE 3 PASSENGER SIDE FRONT**

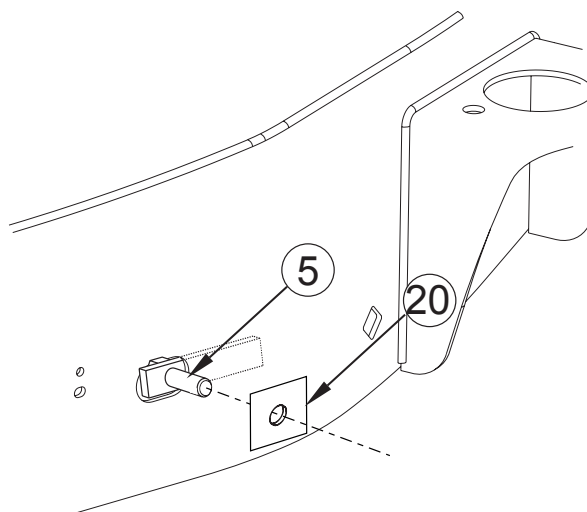

**FIGURE 4 DRIVER SIDE SHOWN**

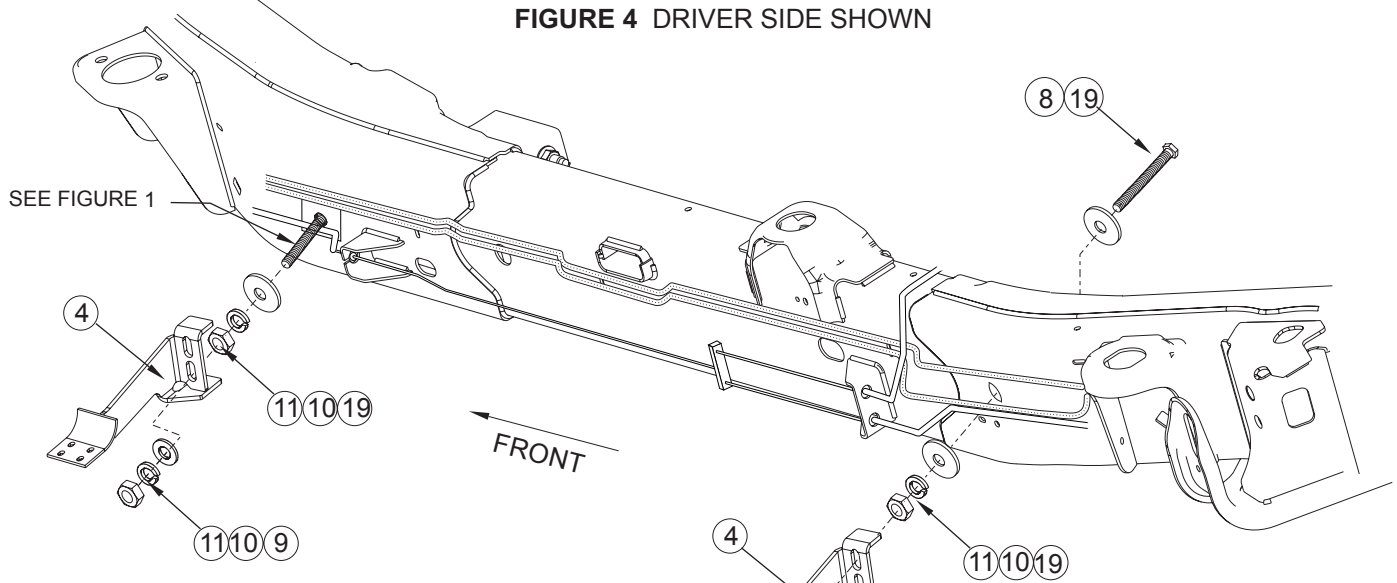

**FIGURE 5 FRONT DRIVER**

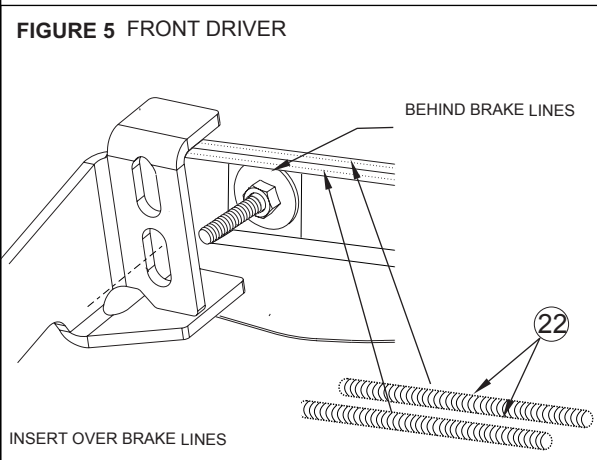

**FIGURE 6 REAR DRIVER**

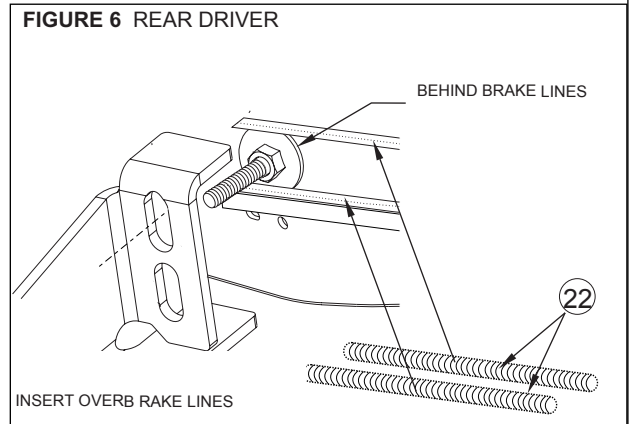

**FIGURE 7 PASSENGER SIDE SHOWN**

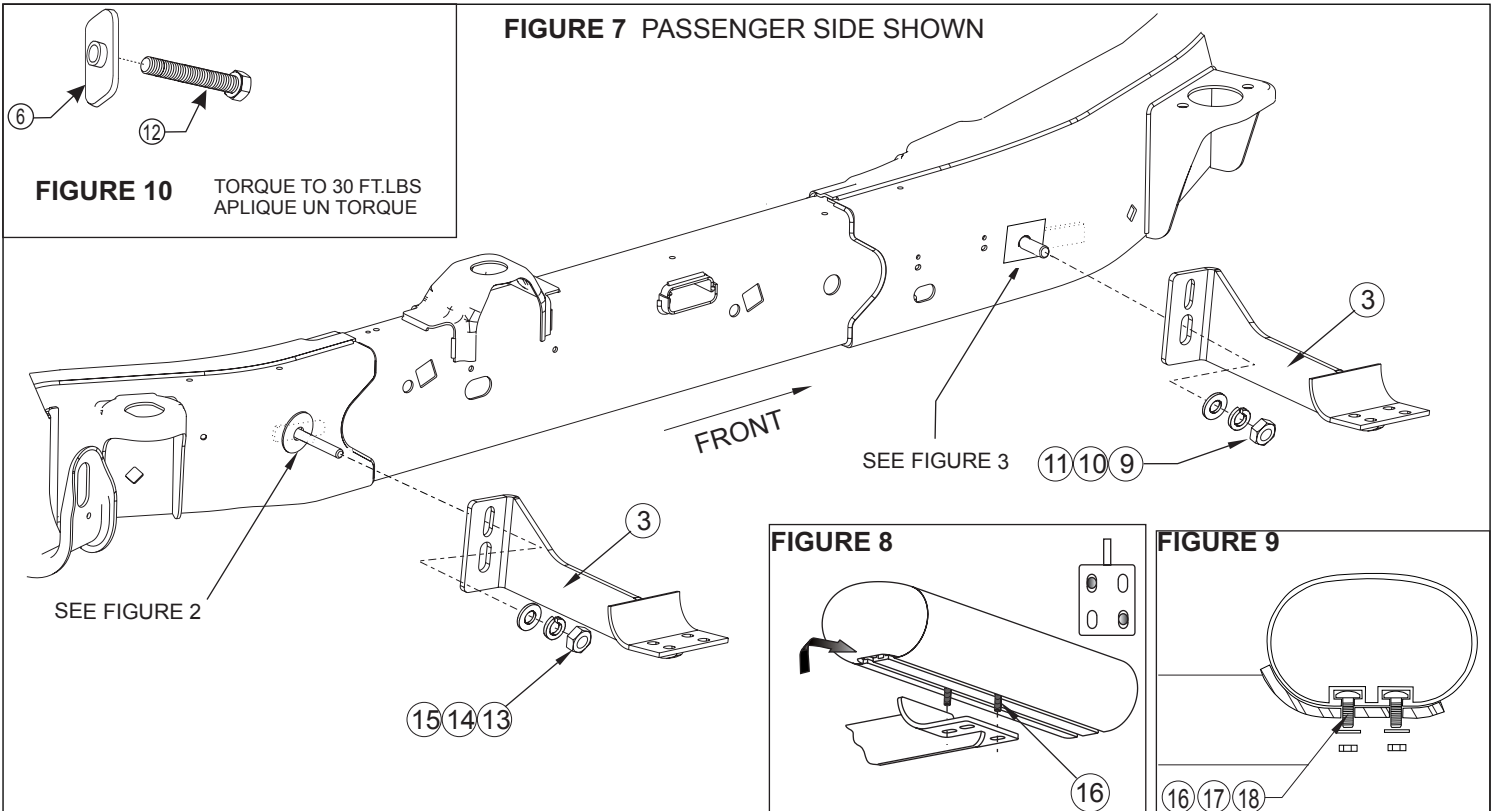

**FIGURE 10** TORQUE TO 30 FT.LBS  
APLIQUE UN TORQUE

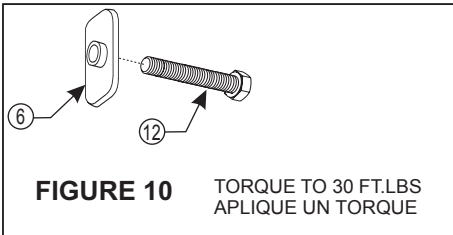

**FIGURE 8**

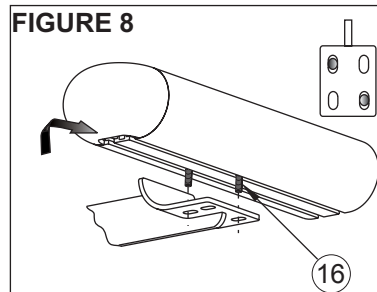

**FIGURE 9**

