



SIGNATURE OF QUALITY

AUTOMOTIVE PRODUCTS, INC.

PRO TRAXX OVAL STEP BARS

APPLICATION: 2007-2014 CHEVY/GMC SILVERADO/SIERRA 1500/2500/3500
D-CAB / EXT / CREW CAB (EXCLUDING DIESEL MODELS)

APP PART # 21-21680, 21-21685, 21-21950, 21-21955, 21-23710, 21-23715, 21-23720, 21-23725, 21-51680, 21-51685, 21-51950, 21-51955, 21-53710, 21-53715, 21-53720, 21-53725
PRO TRAXX OVAL STEP BARS

| ITEM | QUANTITY | DESCRIPTION | TOOLS NEEDED |
|------|----------|----------------------------|-------------------------|
| 1,2 | 2 | STEP BARS | TORQUE WRENCH |
| 3 | 6 | MOUNTING BRACKETS | 12MM SOCKET |
| 4 | 6 | M8 HEX HEAD CAP SCREWS | 13MM SOCKET |
| 5 | 6 | M8 FLAT WASHERS | HEX KEY TOOL (INCLUDED) |
| 6 | 6 | M8 LOCK WASHERS | |
| 7 | 6 | M8 FLANGED HEX CAP SCREW | |
| 8 | 6 | M8 TOOTHED LOCK WASHERS | |
| 9 | 12 | M8 NUT CLIPS | |
| 10 | 12 | M10 BUTTON HEAD CAP SCREWS | |
| 11 | 12 | M10 TOOTHED LOCK WASHERS | |
| 12 | 12 | M10 FLAT WASHERS | |

ANTI-SEIZE LUBRICANT MUST BE USED ON ALL STAINLESS STEEL FASTENERS TO PREVENT THREAD DAMAGE AND GALLING

Remove contents from box, verify if all parts listed are present and free from damage. Carefully read and understand all instructions before attempting installation.

D-CAB / EXTENDED CAB:

- Starting at the drivers side of the vehicle locate the existing circular hole in the rocker panel towards the front of the vehicle. Remove the rubber plug from the bigger hole to access the smaller diameter hole and insert (1) M8 nut clip over the hole (item 9). (FIG. 1 & 2)
- Locate the existing hole in the pinch weld and place (1) M8 clip nut onto the hole. (FIG. 2)
- Attach (1) mounting bracket (item 3) to the previously installed nut clip in step 1 using (1) M8 hex head cap screw (item 4), (1) M8 lock washer (item 6), and (1) M8 flat washer (item 5). Attach the mounting bracket to the pinch weld nut clip using (1) M8 flanged hex cap screw (item 7), and (1) M8 toothed lock washer (item 8) (FIG. 3). Do not fully tighten at this time.
- Repeat steps 1, 2 and 3 for the center and rear mounting brackets.
- Take the drivers side step bar (item 1) and place it on the mounting cradles then attach the step bar using (6) M10 button head cap screws (item 10), (6) M10 toothed lock washers (item 11), and (6) M10 flat washers (item 12) (FIG. 8). *Note: the drivers side step tube will be packaged in a clear poly tube and the passenger side will be packaged in a red poly tube, the Westin logo should face outward when installed.*
- Align and adjust as needed then tighten all hardware at this time. Torque all M8 hardware to 15-20 ft-lbs, and M10 to 30-35 ft-lbs (FIG. 9).
- Follow the same steps to install the passenger side mounting brackets and step bar.

CREW CAB:

- Starting from the drivers side of the vehicle locate the threaded hole located in the rocker panel towards the front of the vehicle. (FIG. 4) Take (1) mounting bracket (item 3) and attach it to the threaded hole using (1) M8 hex head cap screw (item 4), (1) M8 lock washer (item 6), and (1) M8 flat washer (item 5). Locate the existing welded nut on the pinch weld and attach the mounting bracket to the pinch weld using (1) M8 flanged hex cap screw (item 7), and (1) M8 toothed lock washer (item 8), (FIG. 5). Do not fully tighten at this time.
- Repeat step 1 for the center mounting bracket.

CARE INSTRUCTIONS

- REGULAR WAXING IS RECOMMENDED. DO NOT USE ANY TYPE OF POLISH OR WAX THAT MAY CONTAIN ABRASIVES
- STAINLESS STEEL PRODUCTS CAN BE CLEANED WITH MILD SOAP AND WATER. STAINLESS STEEL POLISH SHOULD BE USED TO POLISH SMALL SCRATCHES.
- GLOSS BLACK FINISHES SHOULD BE CLEANED WITH MILD SOAP AND WATER

CREW CAB continued:

3. Locate the existing circular hole in the rocker panel towards the rear of the vehicle. Remove the rubber plug from the bigger hole to access the smaller diameter hole and insert (1) M8 nut clip over the hole (item 9). (FIG. 6 & 7)
4. Locate the existing hole in the pinch weld and place (1) M8 clip nut onto the hole. (FIG. 7)
5. Attach (1) mounting bracket (item 3) to the previously installed nut clip in step 3 using (1) M8 hex head cap screw (item 4), (1) M8 lock washer (item 6), and (1) M8 flat washer (item 5). Attach the mounting bracket to the pinch weld using (1) M8 flanged hex cap screw (item 7), and (1) M8 toothed lock washer (item 8) (FIG. 3). Do not fully tighten at this time.
6. Take the drivers side step bar (item 1) and place it on the mounting cradles then attach the step bar using (6) M10 button head cap screws (item 10), (6) M10 toothed lock washers (item 11), and (6) M10 flat washers (item 12) (FIG. 8). *Note: the drivers side step tube will be packaged in a clear poly tube and the passenger side will be packaged in a red poly tube, the Westin logo should face outward when installed.*
7. Align and adjust as needed then tighten all hardware at this time. Torque all M8 hardware to 15-20 ft-lbs, and M10 to 30-35 ft-lbs (FIG. 10).
8. Follow the same steps to install the passenger side mounting brackets and step bar.

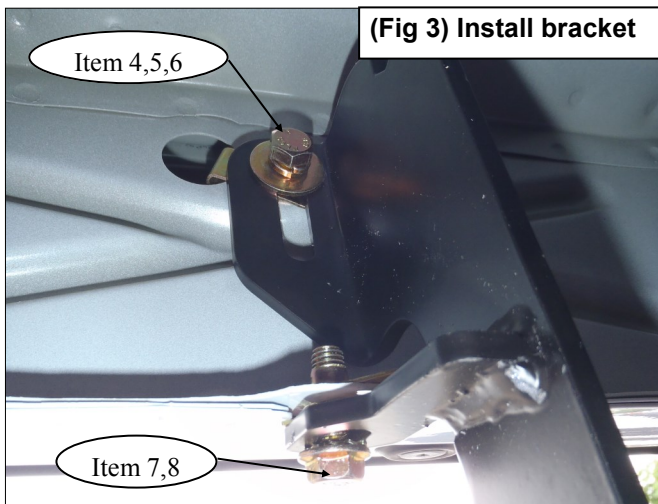
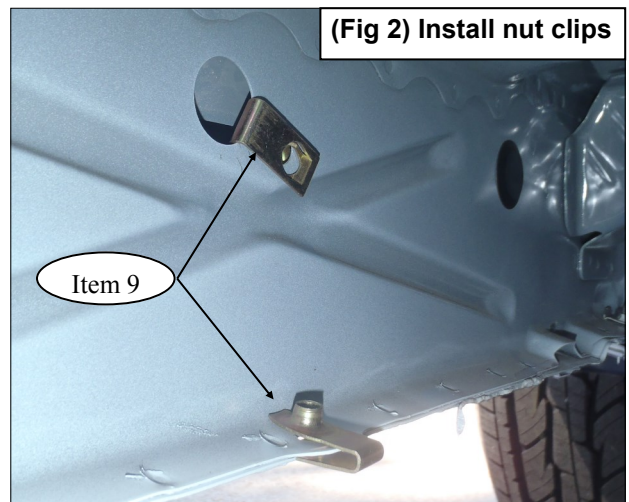

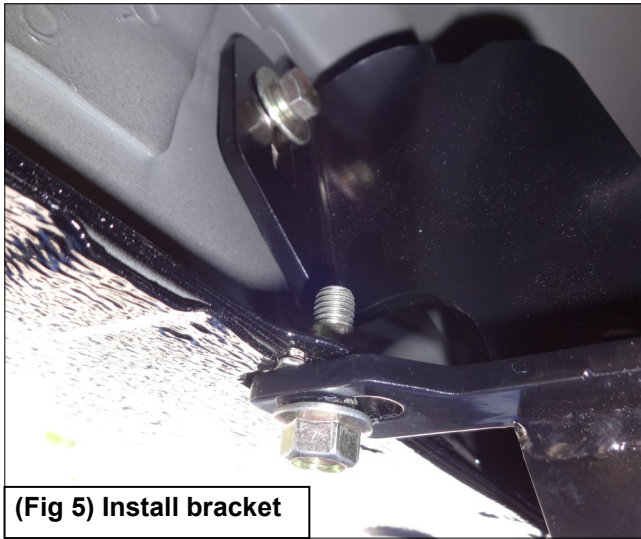

(Fig 5) Install bracket

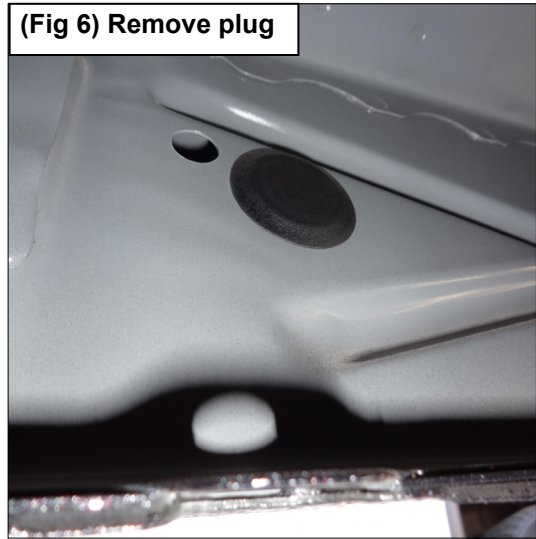

(Fig 6) Remove plug

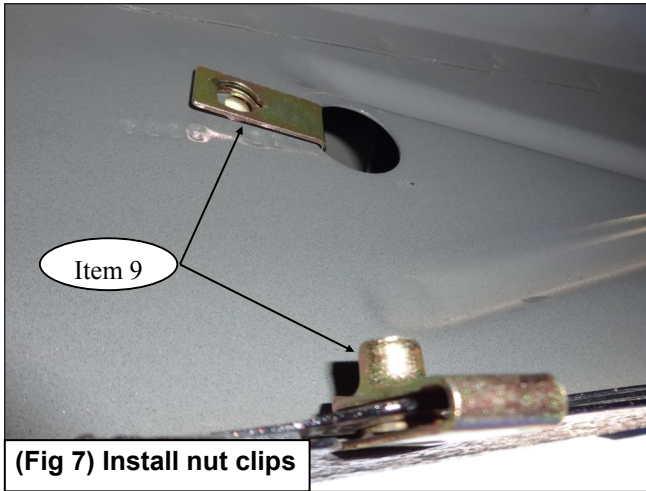

(Fig 7) Install nut clips

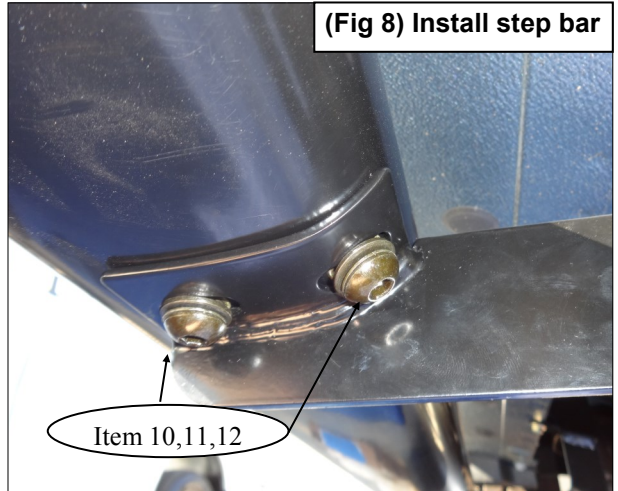

(Fig 8) Install step bar

Item 10,11,12



(Fig 9) Installation complete



(Fig 10) Installation complete