



INSTALLATION INSTRUCTIONS

OUTLAW SKID PLATE
APPLICATION:
2015-2017 Ford F-150
PART NUMBER:
58-71015

CONTENT			
ITEM	QUANTITY	DESCRIPTION	TOOLS NEEDED
1	1	SKID PLATE	5 MM ALLEN
2,3	2	FRAME BRACKET, DRIVER (2) AND PASSENGER (3)	13MM WRENCH
4	1	CROSS MEMBER BRACKET	19MM SOCKET
5,6	2	SUPPORT TUBE, DRIVER (5) AND PASSENGER (6)	15MM SOCKET
7	2	M12 DOUBLE NUT PLATE	RATCHET
8	2	M10 U-CLIP (BLACK ZINC)	TORQUE WRENCH
9	8	M10 SPLIT LOCK WASHER (BLACK ZINC)	
10	6	M8 U-CLIP (BLACK ZINC)	
11	6	M8 BUTTON HEAD HEX BOLT (BLACK ZINC)	
12	14	M10 FLAT WASHER (BLACK ZINC)	
13	2	M10 HEX HEAD BOLT (BLACK ZINC)	
14	6	M10 HEX NUT (BLACK ZINC)	
15	6	M10 HEX HEAD BOLT (BLACK ZINC)	
16	6	M8 SPLIT LOCK WASHER (BLACK ZINC)	
17	6	M8 FLAT WASHER (BLACK ZINC)	
18	4	M12 FLAT WASHER (BLACK ZINC)	
19	4	M12 SPLIT LOCK WASHER (BLACK ZINC)	
20	4	M12 HEX HEAD BOLT (BLACK ZINC)	
ANTI-SEIZE LUBRICANT MUST BE USED ON ALL STAINLESS STEEL FASTENERS TO PREVENT THREAD DAMAGE AND GALLING			

CARE INSTRUCTIONS

- REGULAR WAXING IS RECOMMENDED. DO NOT USE ANY TYPE OF POLISH OR WAX THAT MAY CONTAIN ABRASIVES.
- STAINLESS STEEL PRODUCTS CAN BE CLEANED WITH MILD SOAP AND WATER. STAINLESS STEEL POLISH SHOULD BE USED TO POLISH SMALL SCRATCHES.
- GLOSS BLACK FINISHES SHOULD BE CLEANED WITH MILD SOAP AND WATER.



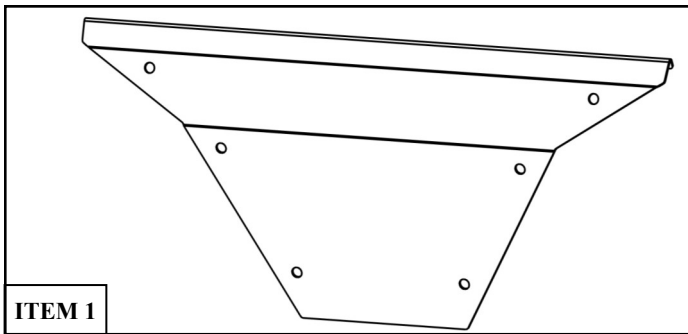

ITEM 1

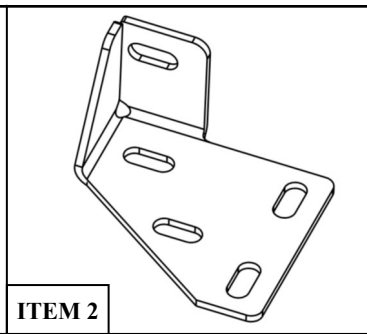

ITEM 2

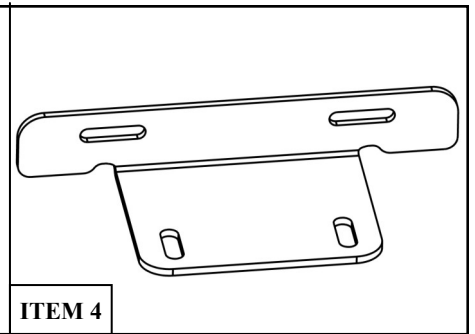

ITEM 4

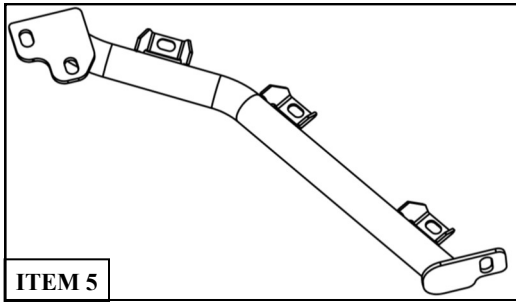

ITEM 5

PROCEDURE

1. Remove contents from box, verify if all parts listed are present and free from damage. Carefully read and understand all instructions before attempting installation.

Failure to identify damage before installation could lead to a rejection of any claim.

2. Remove the bolt indicated in **Figure 1** on the driver side of the vehicle along with the attached hex nut, split lock washer, and flat washer. Repeat procedure on the passenger side. *Note:* Driver's side shown.
3. Position frame brackets (2 & 3) and loosely reinstall the hardware removed in step 1 (M12 serrated bolt). See **Figure 2**. *Note:* Do not tighten hardware until the end of installation.

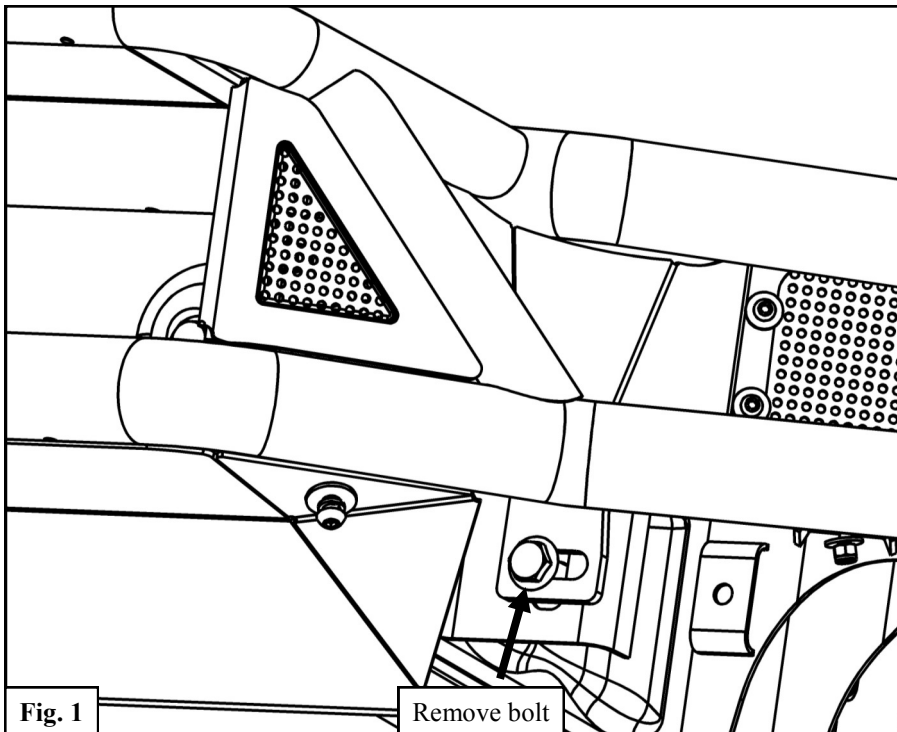

Fig. 1

Remove bolt

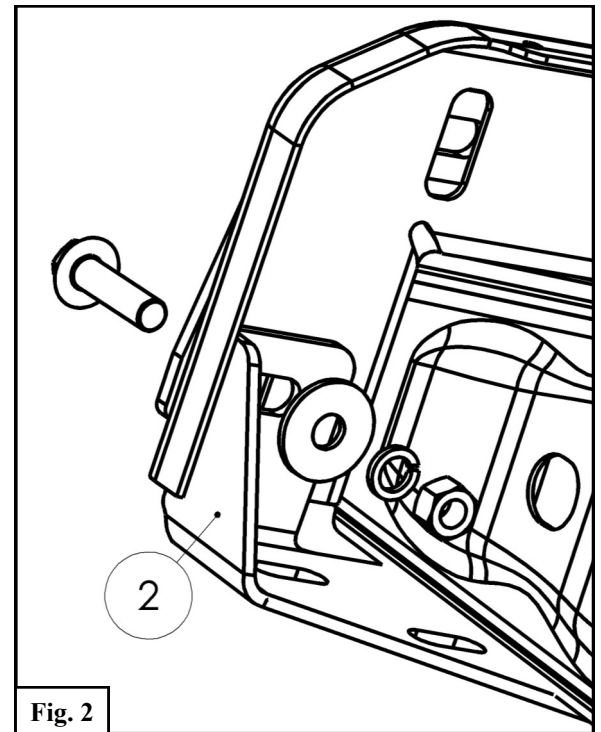
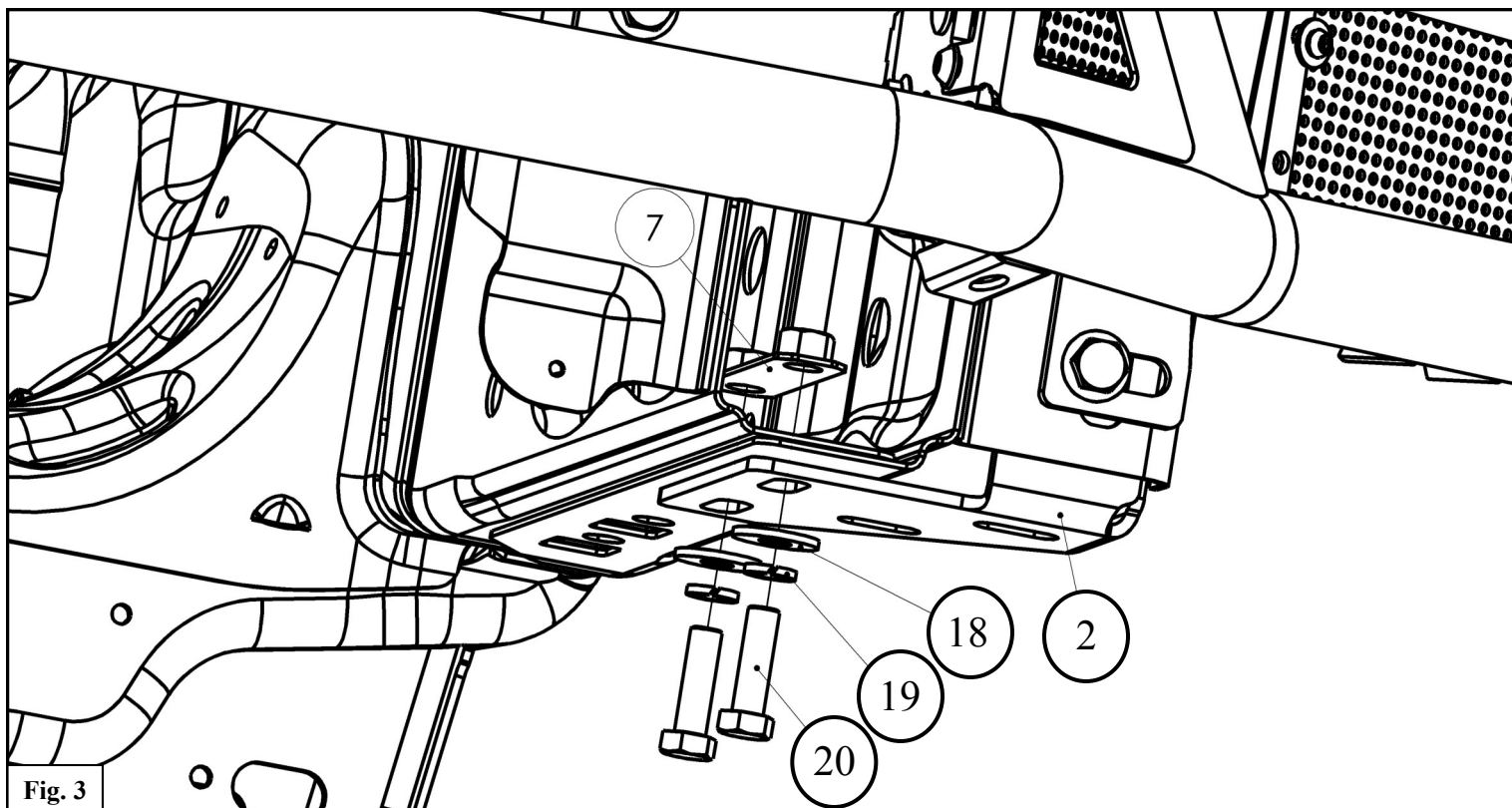
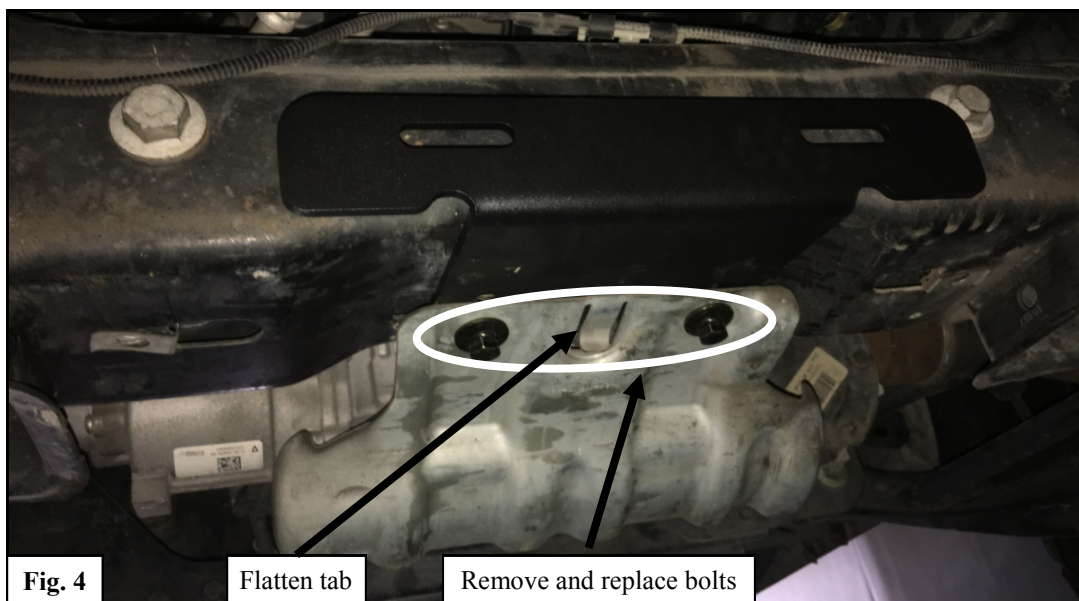

Fig. 2

- Slide the M12 double nut plates (7) inside the frame and loosely install the supplied M12 hardware (18-20) as shown in **Figure 3**. *Note:* Driver's side shown.



- Remove the factory bolts in the locations indicated in **Figure 4**, remove protective plate, and flatten the tab indicated in **Figure 4**.
- Position the crossmember bracket (4) and protective plate as shown in **Figure 4** making sure to leave room between the crossmember bracket and the front of the frame.
- Replace the hardware removed in step 5 by loosely installing the M10 hardware (9, 12, and 13). *Note:* stock M10 U-clips may be replaced with provided M10 U-clips.



8. Install the support tubes (5 & 6) according to **Figures 5 & 6** using the supplied M10 serrated hardware (9, 12, 14, and 15).

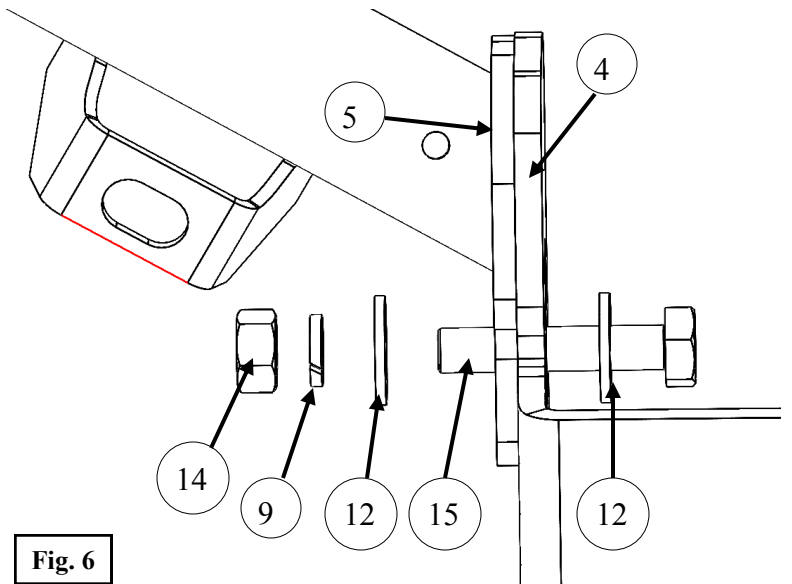
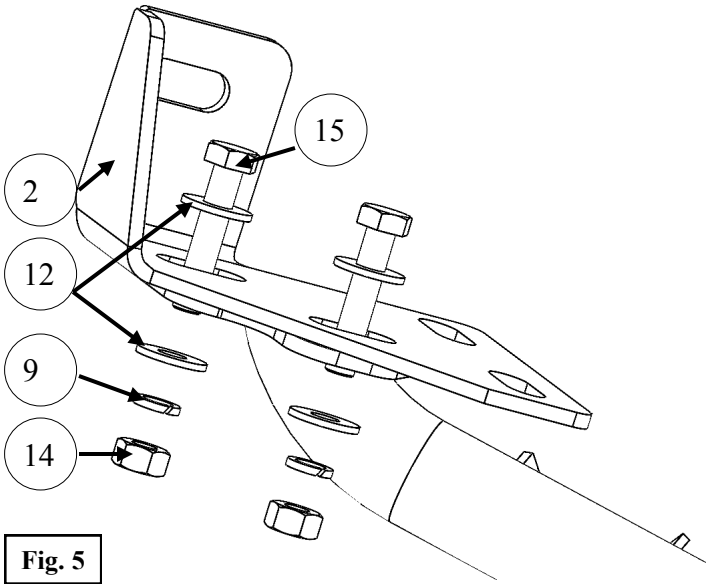

9. Insert U-clips onto the tabs welded to the support tubes (5 & 6) according to **Figure 7**.

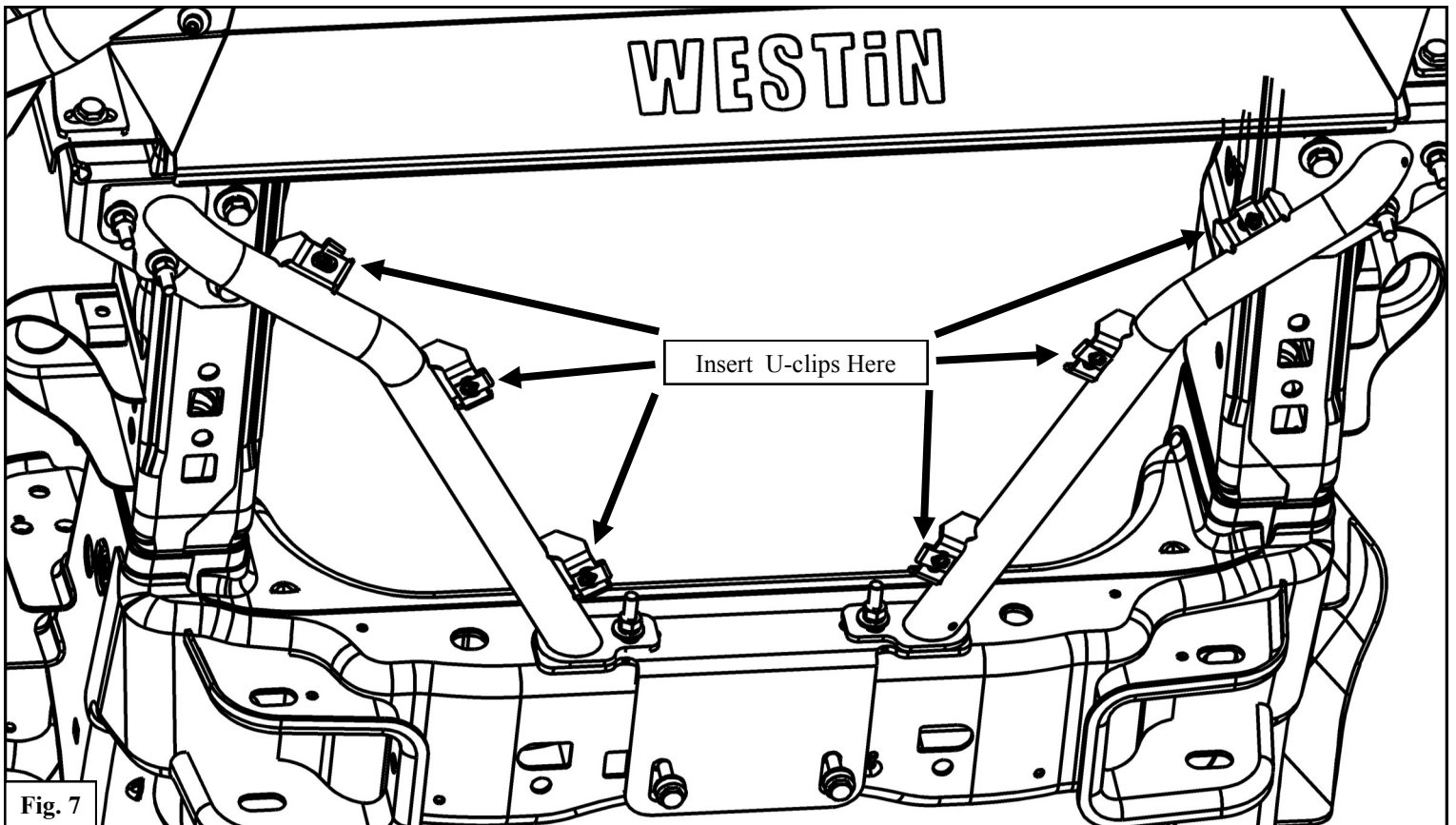

6. Mount lower skid plate (1) according to **Figures 8 & 9** using the supplied M8 hardware (11, 16, and 17) on each U-clip.
7. Once all hardware has been installed in the desired position, tighten according to the following specifications. M12 hardware to 50-55 ft-lbs, M10 hardware to 30-35 ft-lbs, and M8 hardware to 15-18 ft-lbs.

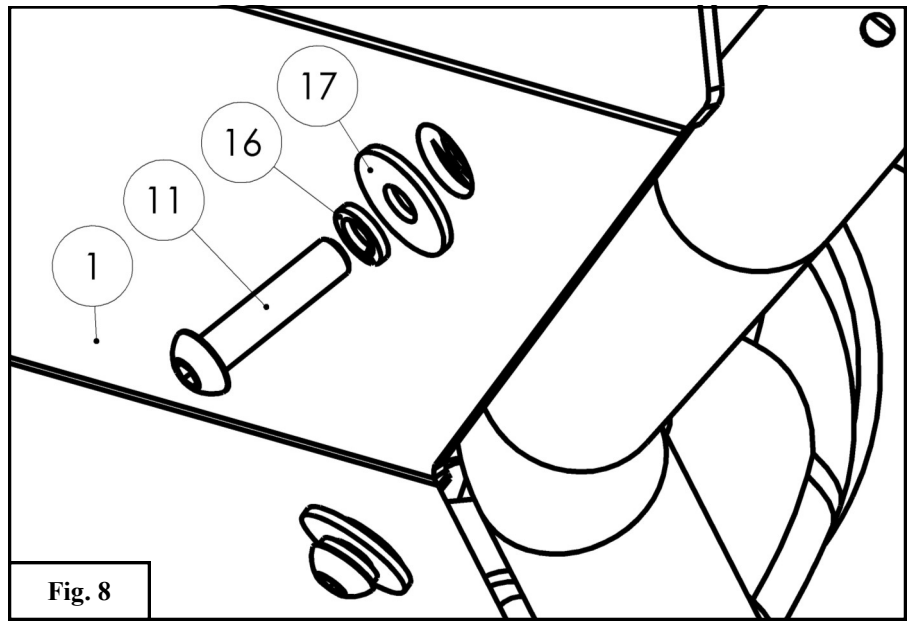

Fig. 8

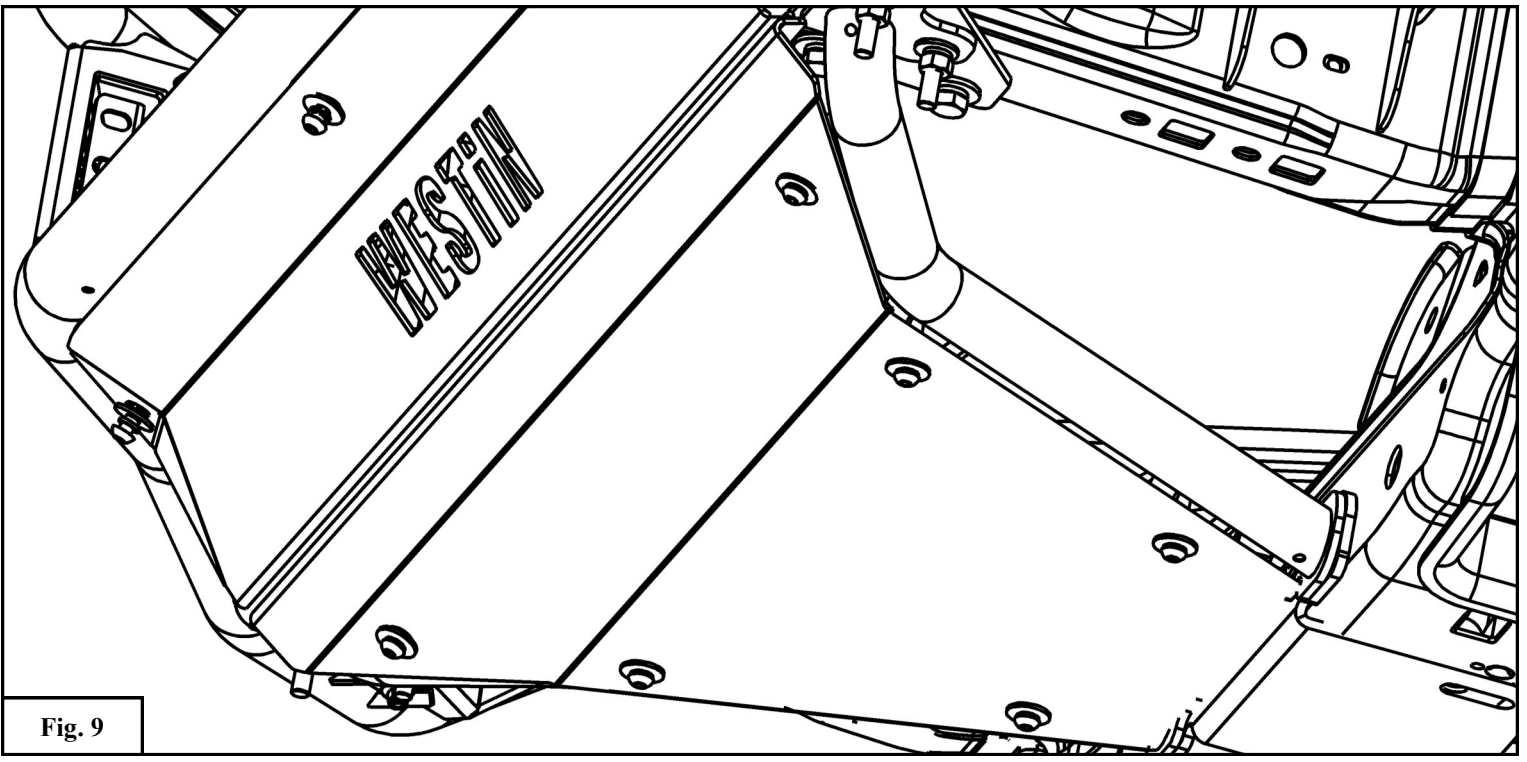

Fig. 9

Installation Complete



WESTiN

Check out a selection of off-road bumpers offered in our online store.