

INSTALLATION INSTRUCTIONS

PRO-SERIES FRONT BUMPER



APPLICATION:
Ford F-150 2021
PART NUMBER:
58-411245

| CONTENT | | | |
|---------|----------|---------------------------------|---------------|
| ITEM | QUANTITY | DESCRIPTION | TOOLS NEEDED |
| 1 | 1 | PRO-SERIES FRONT BUMPER | ALLEN |
| 2 | 1 | WINCH TRAY | 10MM SOCKET |
| 3 | 1 | MAIN DRIVER MOUNTING BRACKET | 10MM WRENCH |
| 4 | 1 | MAIN PASSENGER MOUNTING BRACKET | 18MM SOCKET |
| 5 | 1 | LED COVER | 18MM WRENCH |
| 6 | 1 | DRIVER LED MOUNTING BRACKET | 19MM SOCKET |
| 7 | 1 | PASSENGER LED MOUNTING BRACKET | 19MM WRENCH |
| 8 | 2 | SENSOR PLATE A | 21MM SOCKET |
| 9 | 2 | SENSOR PLATE B | RATCHET |
| 10 | 1 | CENTER DRIVER MESH COVER | TORQUE WRENCH |
| 11 | 1 | CENTER PASSENGER MESH COVER | |
| 12 | 1 | OUTTER DRIVER MESH COVER | |
| 13 | 1 | OUTTER PASSENGER MESH COVER | |
| 14 | 2 | DOUBLE M12 NUT PLATE | |
| 15 | 2 | M12 BOLT PLATE | |
| 16 | 10 | M12 SERRATED FLANGE HEX NUT | |
| 17 | 12 | M12 HEX HEAD BOLT | |
| 18 | 4 | M12 LOCK WASHER | |
| 19 | 22 | M12 FLAT WASHER | |
| 20 | 4 | M6 HEX SOCKET BUTTON HEAD SCREW | |
| 21 | 4 | M6 FLAT WASHER | |
| 22 | 16 | M6 SERRATED FLANGE HEX NUT | |
| 23 | 12 | M6 SOCKET COUNTERSUNK SCREW | |

ANTI-SEIZE LUBRICANT MUST BE USED ON ALL STAINLESS STEEL FASTENERS TO PREVENT THREAD DAMAGE AND GALLING

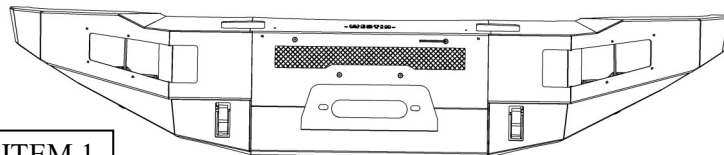

ITEM 1



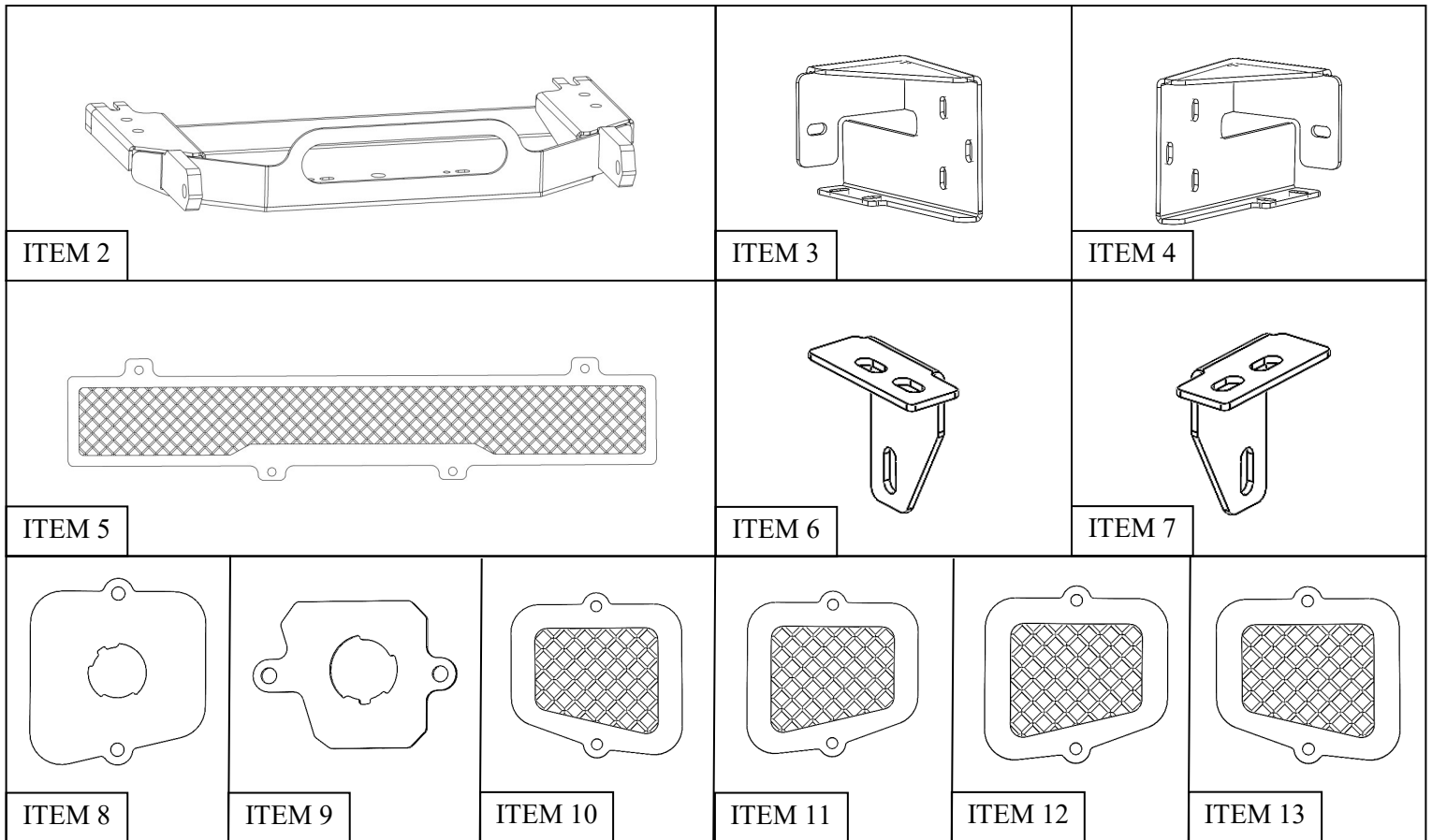

PROCEDURE

1. Remove contents from box, verify if all parts listed are present and free from damage. Carefully read and understand all instructions before attempting installation. **Failure to identify damage before installation could lead to a rejection of any claim.**
2. Remove the two small trim screws from the plastic trim pieces on both sides of the vehicle. See **Figure 1**.
3. Starting on either side, carefully pull and remove the front fascia panel shown in **Figure 2**.
4. On the inner side of the bumper, near the vehicle frame on both sides, remove the three nuts from the locations shown in **Figure 3**. **Note:** Assistance may be needed with bumper removal.

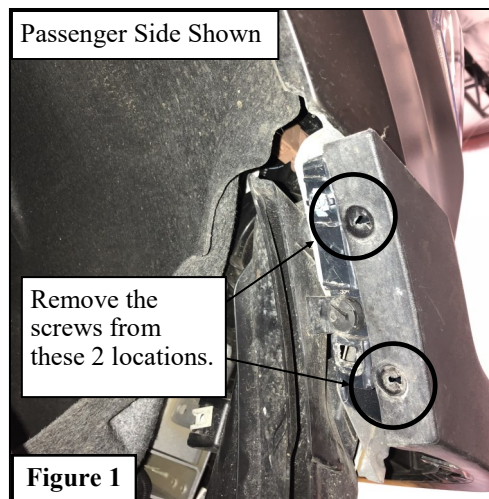

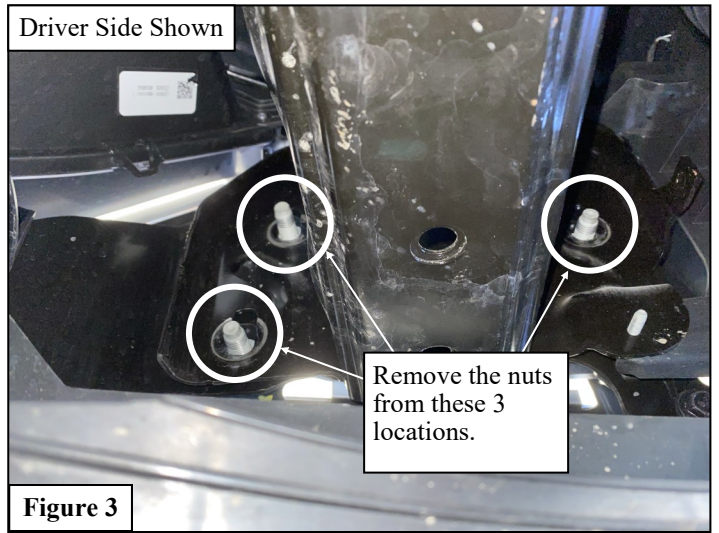

5. Loosely install the Winch Tray (2) to the bottom of the frame using the supplied M12 Bolt Plate (15). Align bolt plate with OE tow hook holes on frame.
6. Install the supplied Driver and Passenger Main Brackets (3, 4) onto the frame using the supplied M12 Hardware (14, 16-19). See **Figures 4-5** for reference. *Note: The frame is "sandwiched" by the Winch Tray (2) and the Driver and Passenger Main Brackets (3, 4). Also, the M12 Double Nut Plate (14) is slid inside the frame. See **Figure 6** for reference.*

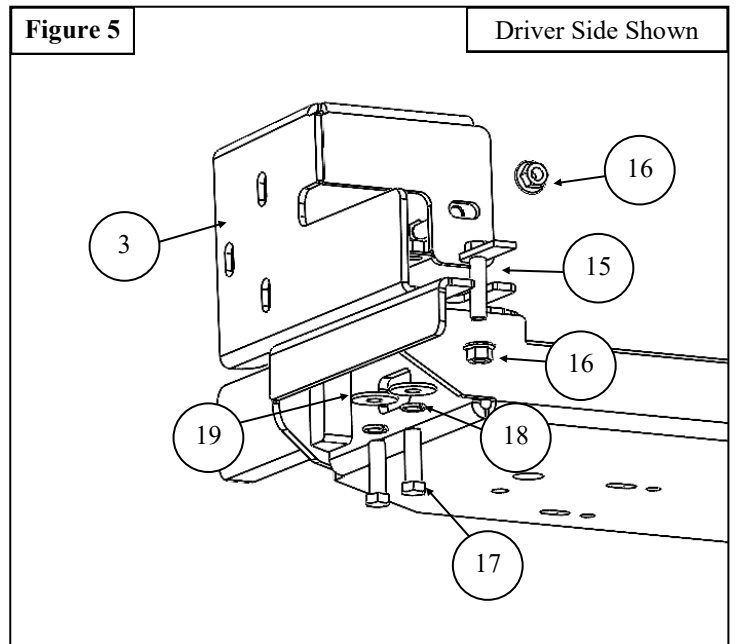
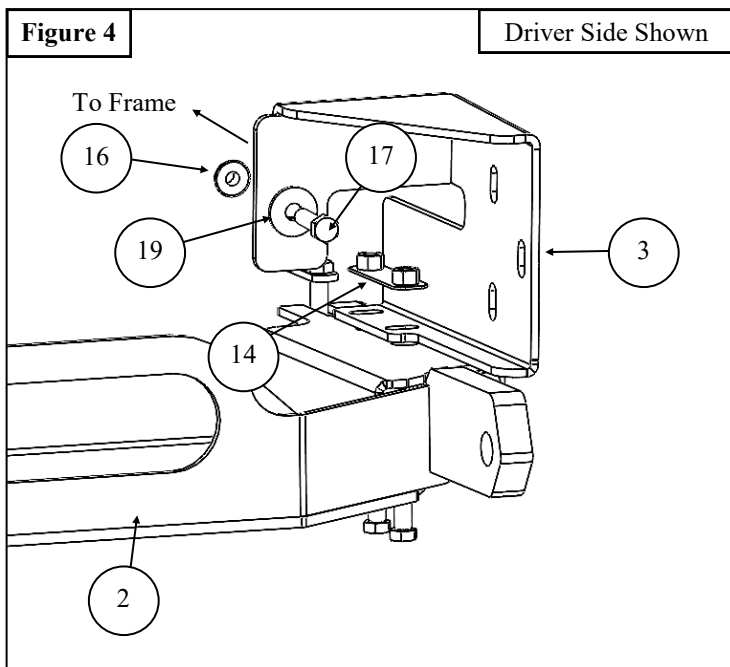

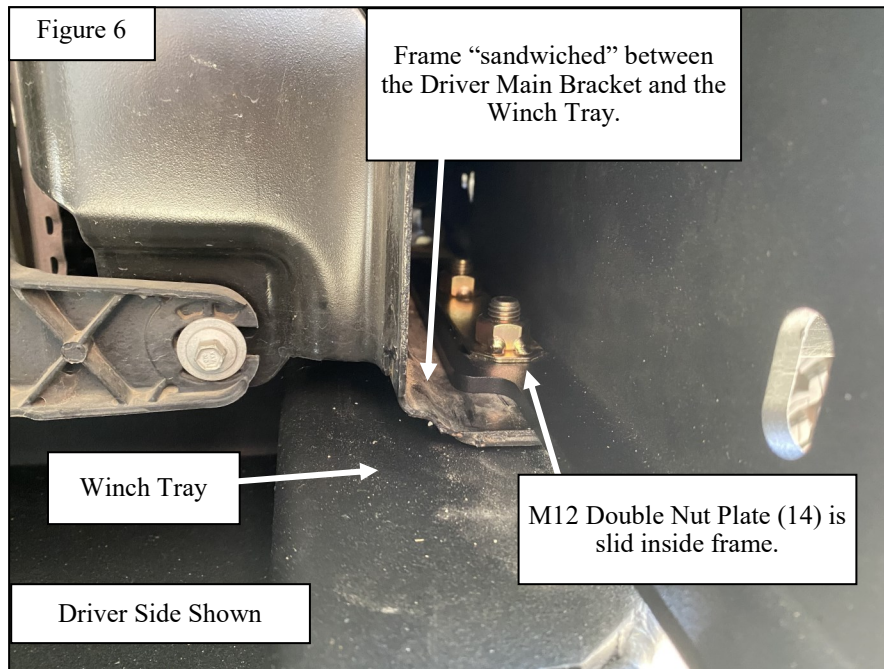

7. Mount your winch and winch accessories at this time.
8. If installing a light bar, install using the supplied LED light brackets and supplied M6 hardware, if applicable. Install light per manufacturers recommendation. See **Figure 7** for reference.
9. If you are not installing light bar, install the led light mesh cover using supplied M6 hardware. See **Figure 8** for reference.

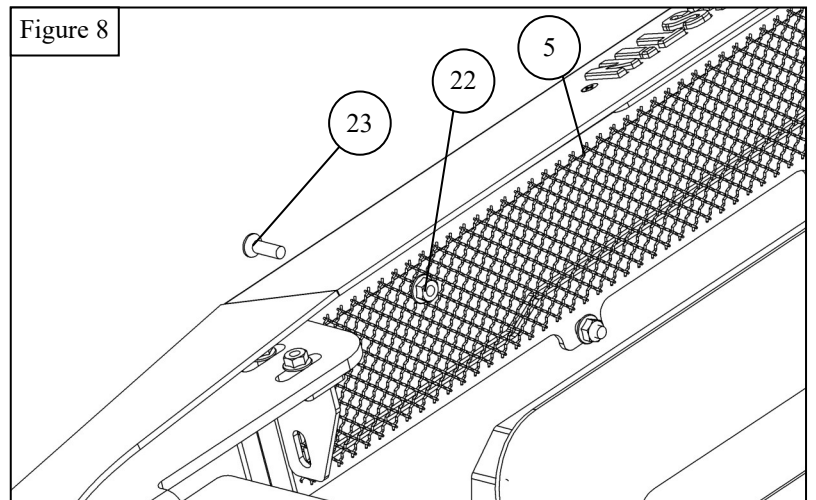
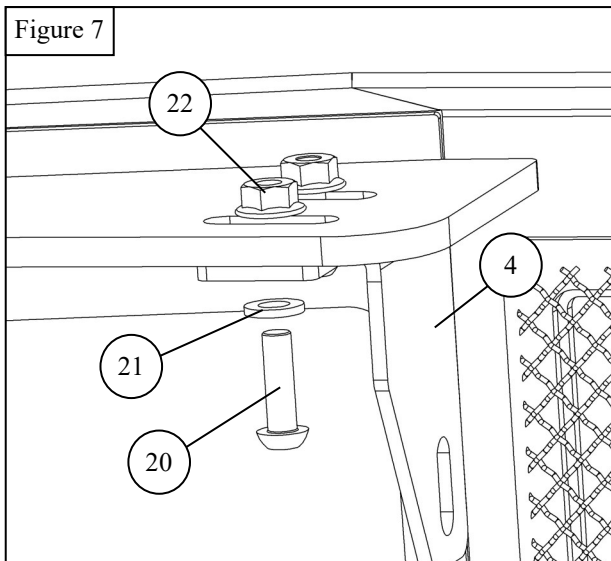

10. If using sensors, install the optional sensor plates in place of the mesh covers with the provided M6 hardware.
11. Remove the sensors and retainers from the stock bumper. Install the factory sensor retainer into each of the sensor plates from the front. See **Figures 9-12** for reference.
12. Carefully route the wiring harness throughout the bumper.
13. **If you are not installing sensors**, install mesh covers A and B using supplied M6 hardware. See **Figure 12**.

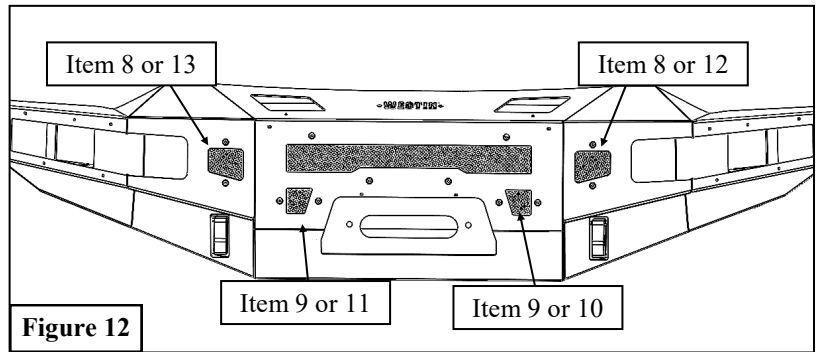
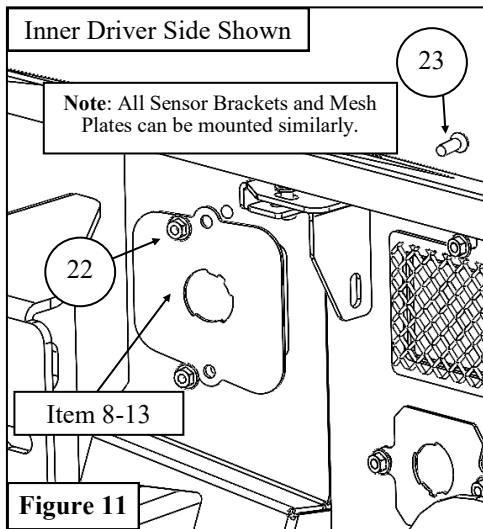
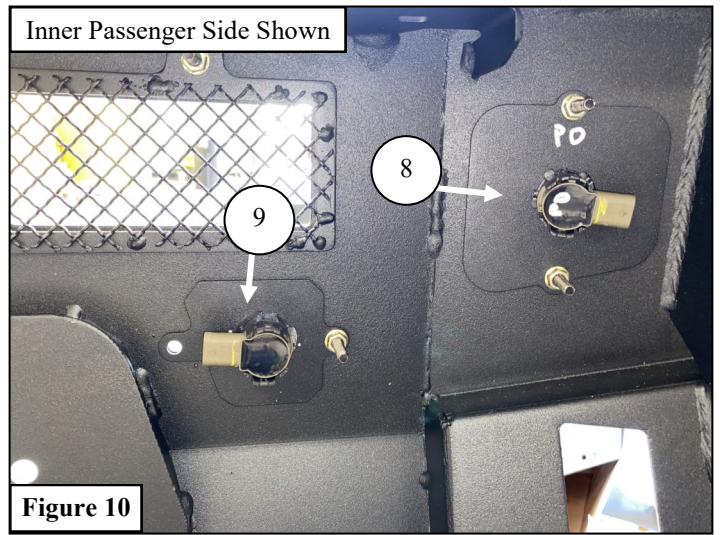
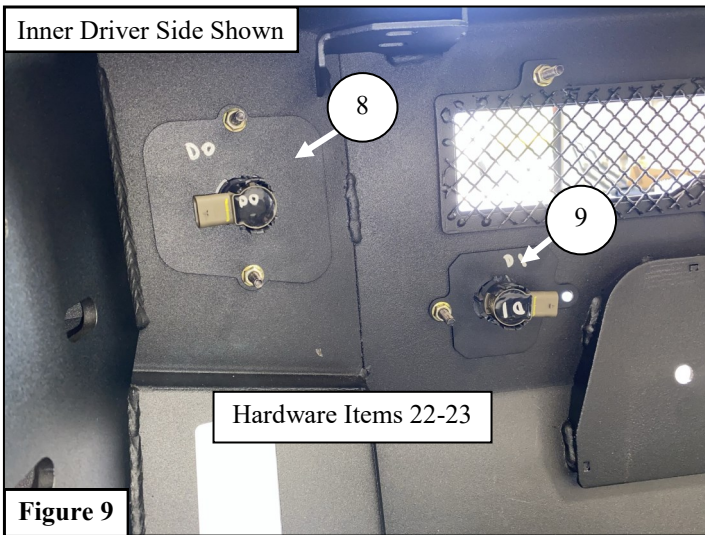

14. Measure the inner distance of the Main Driver and Passenger Mounting Brackets. Make sure the distance matches the outer distance on the bumper mounting locations. (About 36 inches) See Figure 13.

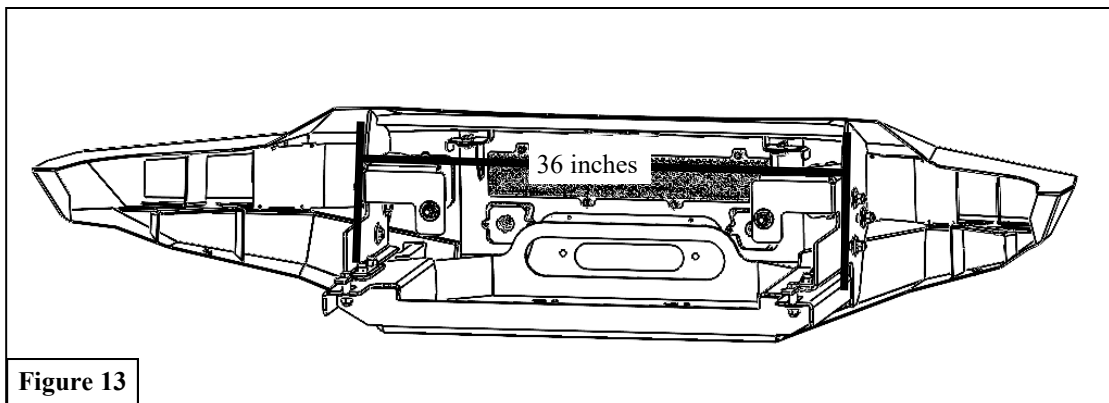

15. With help, loosely assemble the bumper assembly to the Main Mounting Brackets using supplied M12 hardware. See **Figure 14** for reference.
16. Adjust and align the bumper as needed and tighten all hardware as specified: M6 to 5-7 ft-lbs, M12 to 50 ft-lbs.

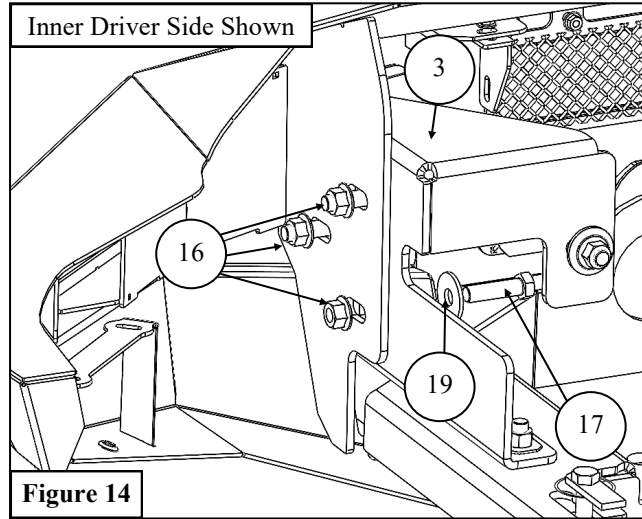

Figure 14

INSTALLATION COMPLETE



LED lights and winch sold separately.

CARE INSTRUCTIONS

- REGULAR WAXING IS RECOMMENDED. DO NOT USE ANY TYPE OF POLISH OR WAX THAT MAY CONTAIN ABRASIVES.
- STAINLESS STEEL PRODUCTS CAN BE CLEANED WITH MILD SOAP AND WATER. STAINLESS STEEL POLISH SHOULD BE USED TO POLISH SMALL SCRATCHES.
- GLOSS BLACK FINISHES SHOULD BE CLEANED WITH MILD SOAP AND WATER.

