

# INSTALLATION INSTRUCTIONS



## HDX GRILLE GUARD

**APPLICATION:**  
2019 GMC Sierra 1500  
**PART NUMBER:**  
57-3965, 57-3960

1	1	HDX GRILLE GUARD ASSEMBLY	RATCHET
2,3	2	LOWER MOUNTING BRACKET—DRIVER & PASSENGER	10MM SOCKET
4,5	2	UPPER SUPPORT STRAP—DRIVER & PASSENGER	12MM SOCKET
6	2	LOWER SUPPORT BRACKET	16MM SOCKET
7	6	M12 HEX HEAD CAP SCREW SHORT (YELLOW ZINC)	18MM SOCKET
8	2	M12 HEX HEAD CAP SCREW LONG (YELLOW ZINC)	ALLEN WRENCH
9	8	M12 SPLIT LOCK WASHER (YELLOW ZINC)	TORQUE WRENCH
10	14	M12 FLAT WASHER SMALL (YELLOW ZINC)	FLAT HEAD SCREW-DRIVER
11	2	M12 FLAT WASHER LARGE (YELLOW ZINC)	
12	8	M12 HEX NUT (YELLOW ZINC)	CUTING TOOL
13	2	M10 BUTTON HEAD BOLT (BLACK) (SS*)	
14	2	M10 BELLVILLE WASHER (BLACK) (SS*)	
15	2	M10 SERRATED FLANGE NUT (BLACK) (SS*)	
16	6	M12 BUTTON HEAD BOLT (BLACK) (SS*)	
17	6	M12 SERRATED FLANGE NUT (BLACK) (SS*)	
18	6	M12 BELLVILLE WASHER (BLACK) (SS*)	

**\*Raw Stainless Steel hardware is for polished stainless grille guards**

**ANTI-SEIZE LUBRICANT MUST BE USED ON ALL STAINLESS STEEL FASTENERS TO PREVENT THREAD DAMAGE AND GALLING**

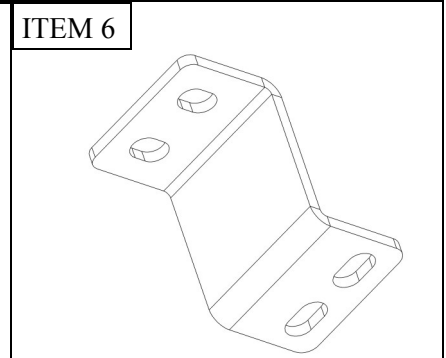
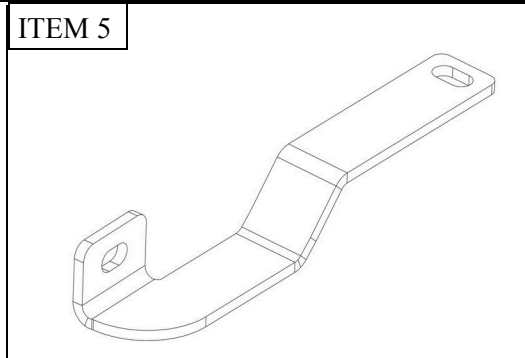
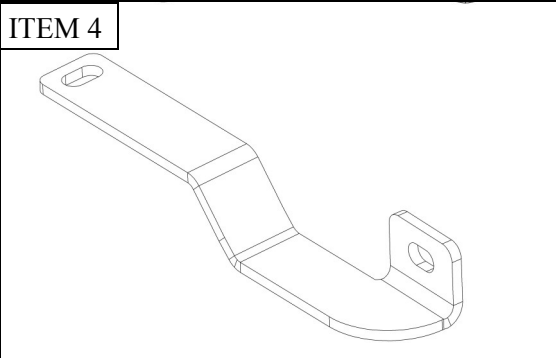
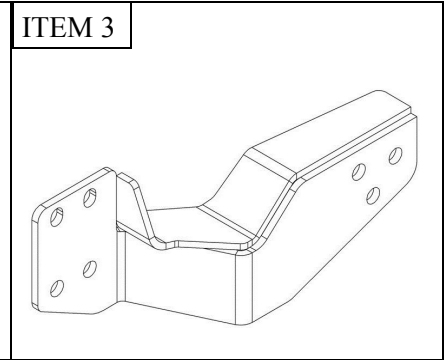
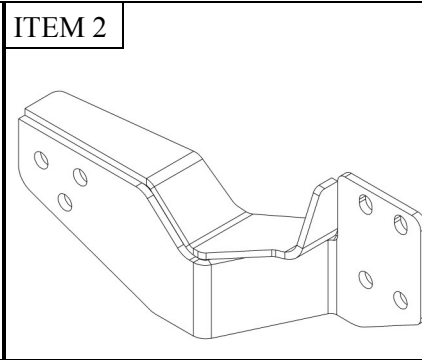
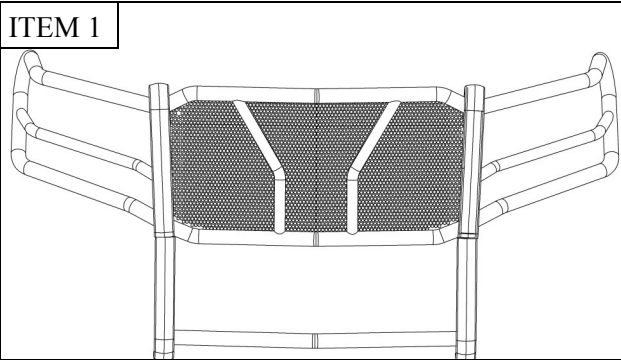

## PROCEDURE

1. Remove contents from box, verify if all parts listed are present and free from damage.  
Carefully read and understand all instructions before attempting installation.  
**Failure to identify damage before installation could lead to a rejection of any claim.**

2. Start by removing the fender trim on both sides. **See Figure 1.**
3. Remove the indicated bolt in **Figure 2** in order to remove the bumper trim.

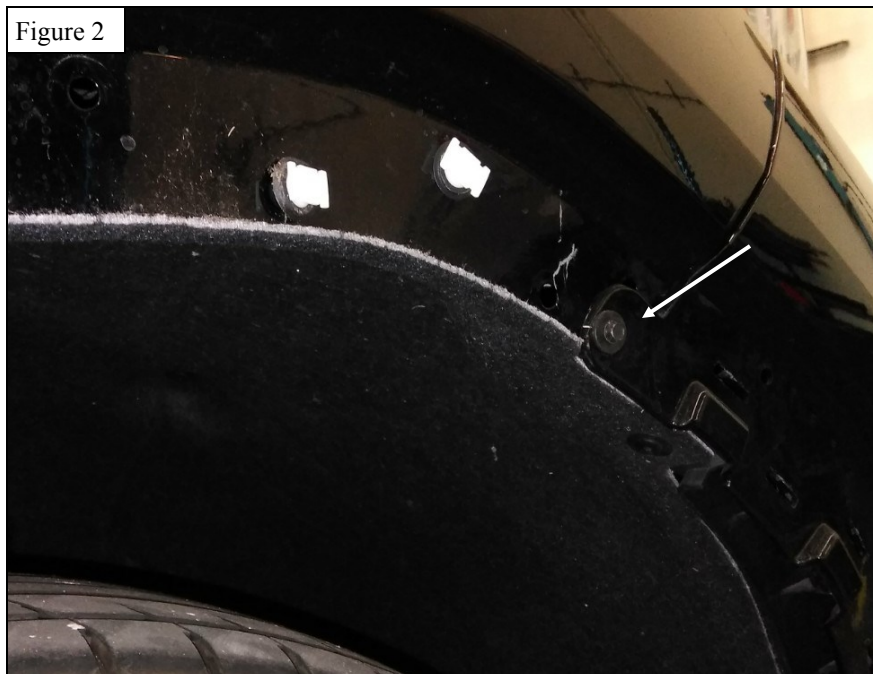
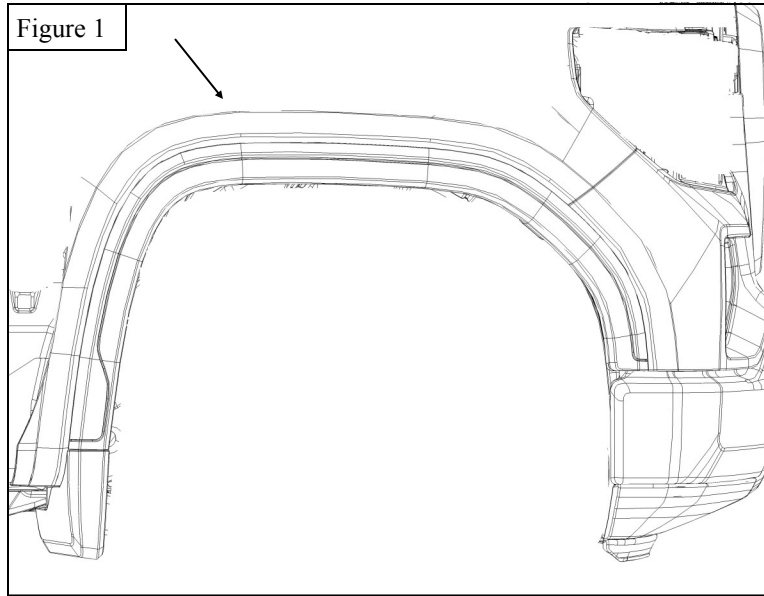

3. Remove the two screws from the inner fender trim as indicated in **Figures 3-4**
4. Using a trim removal tool or large flat head screwdriver, carefully pry on the bumper trim to pop out the retainer clips holding it on. Work your way to the middle starting from either side.

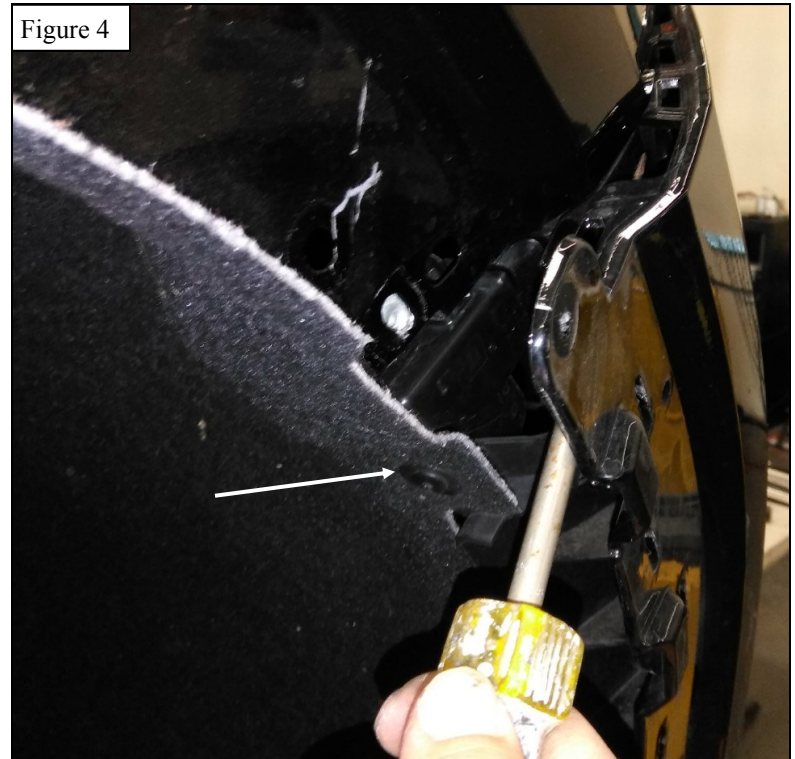

5. Moving to the front fog light pods, remove the bolt behind each pod, you will have to pry part of the rim to access this bolt.
6. Remove the center bolt holding on the bumper trim (above the front license plate area). **See Figure 5**
7. Then using a flat head screwdriver, pop out the remaining retainer clips. Remove the bumper trim. **See Figures 6-8**

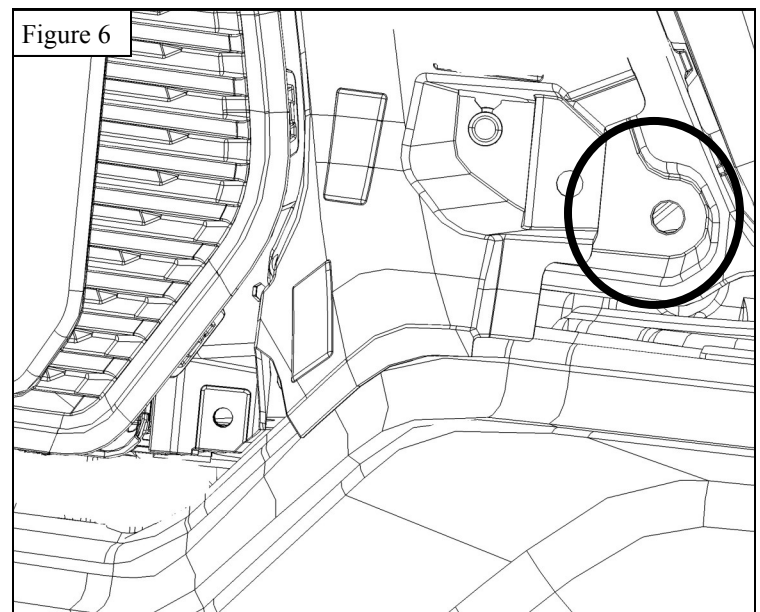
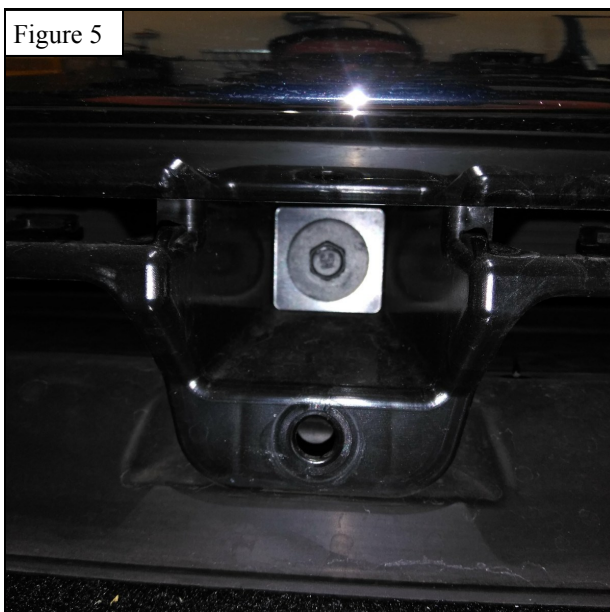

8. Remove the upper cover under the hood using a trim removal tool. There are multiple retainers that hold this piece on. See **Figure 9**.

Figure 7



Figure 8

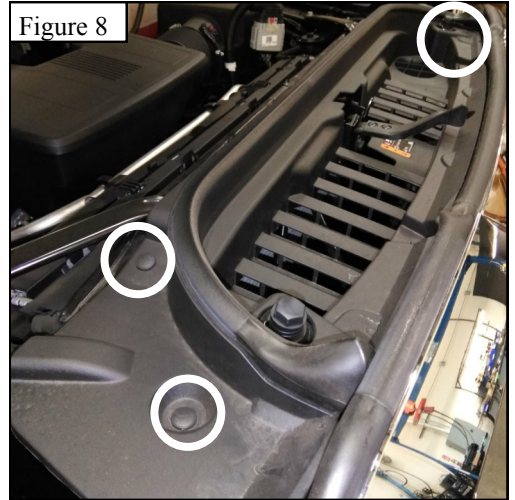

9. Remove bolts attaching grille to vehicle. See **Figure 9**.  
10. Pry grille wings of vehicle. See **Figure 10**.  
11. Pry clip attaching the bottom of the grille to the vehicle. See **Figure 11**.

Figure 9



Figure 10



Figure 11

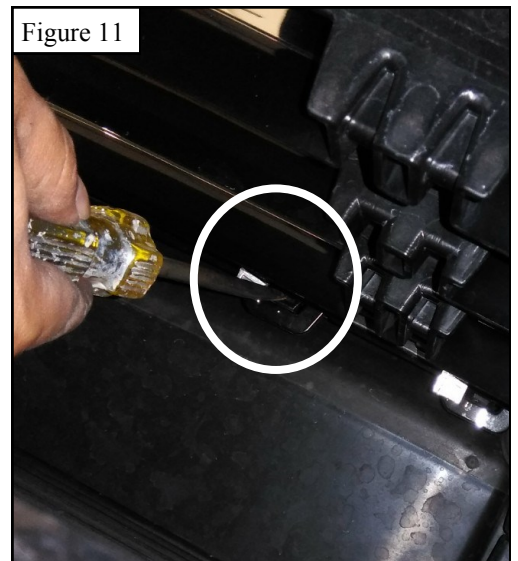

12. Remove the passenger bumper bolt as indicated in **Figure 12**. Slide the upper support strap in between the grille and bumper. Loosely install the upper support strap, reusing the factory bolt. Repeat on the driver side. **See Figures 12-13.**

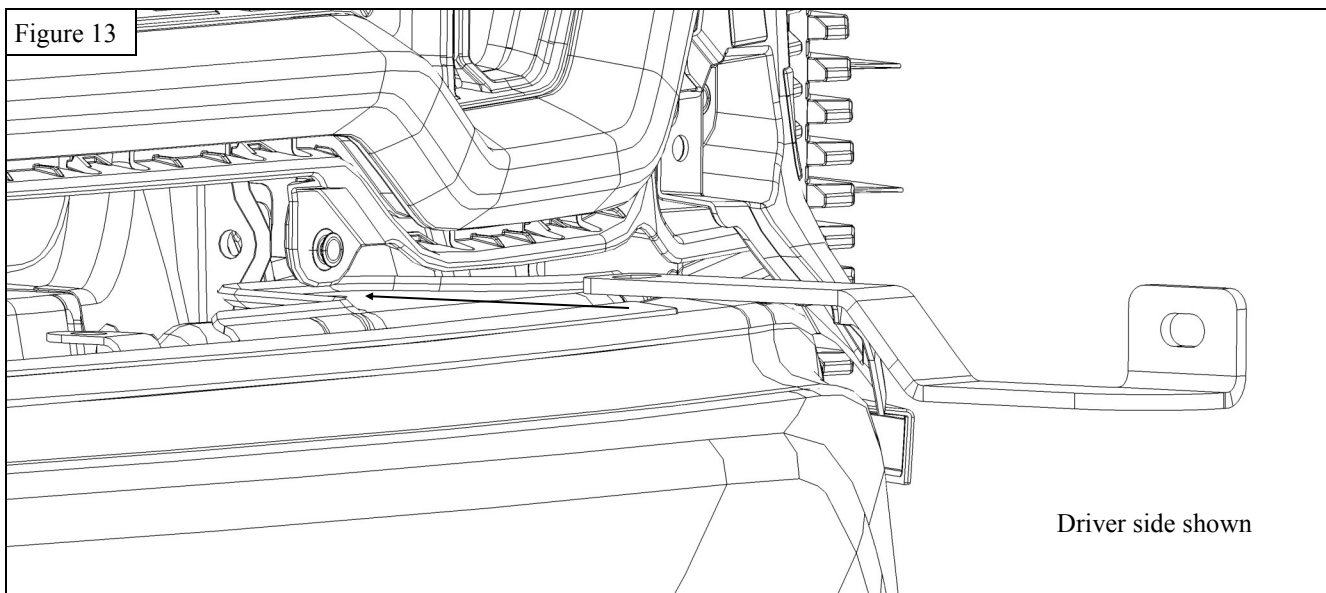

13. Measure from the outside face to the outer face of the other support bracket (where the brackets will meet the grille guard). Ensure that the measurement is 40.5 inches. Tighten down the factory bumper bolts. **See Figure 14**

14. Replace the bumper trim that was previously removed.

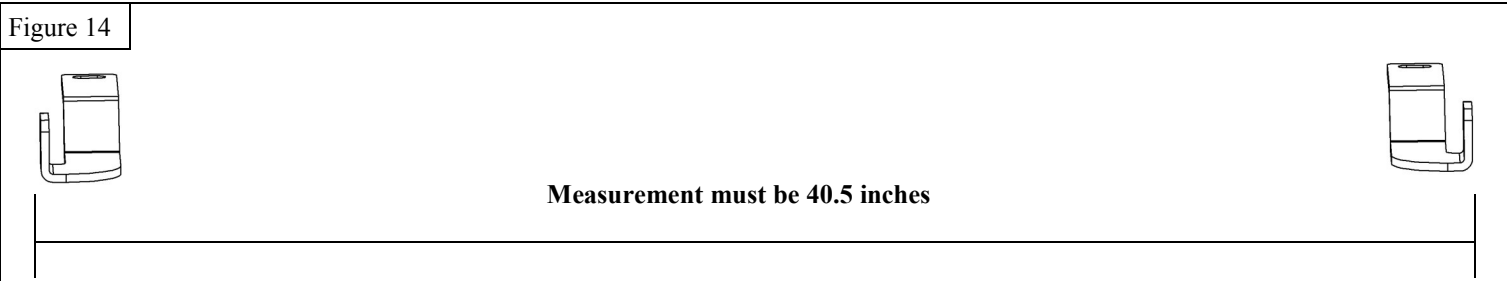

**Note: Front Valence trimming will be required!**

15. You will need to trim the valence around the light pod area. Using the diagrams below, cut out the area in order to clear-  
ance the lower mounting bracket. Cut out the shape of the bracket with a little extra room using the dimensions from the  
diagrams below.

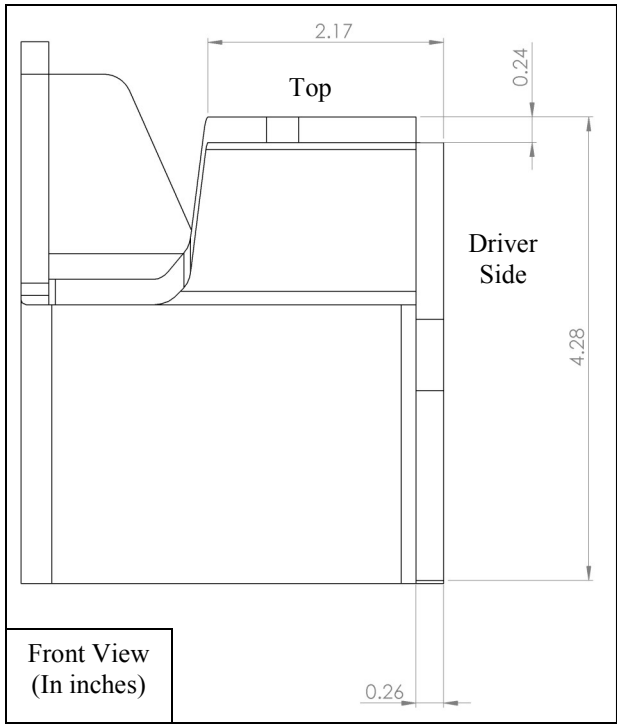
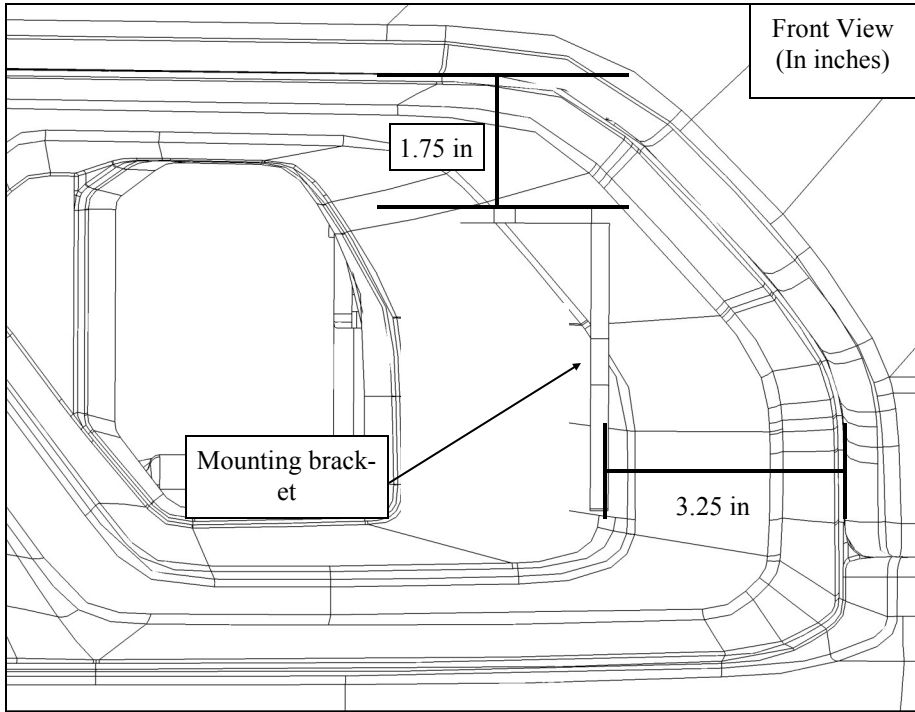

16. Using supplied M12 hardware, loosely install the lower mounting and support bracket on to each side of the frame. See Figure 13-14.

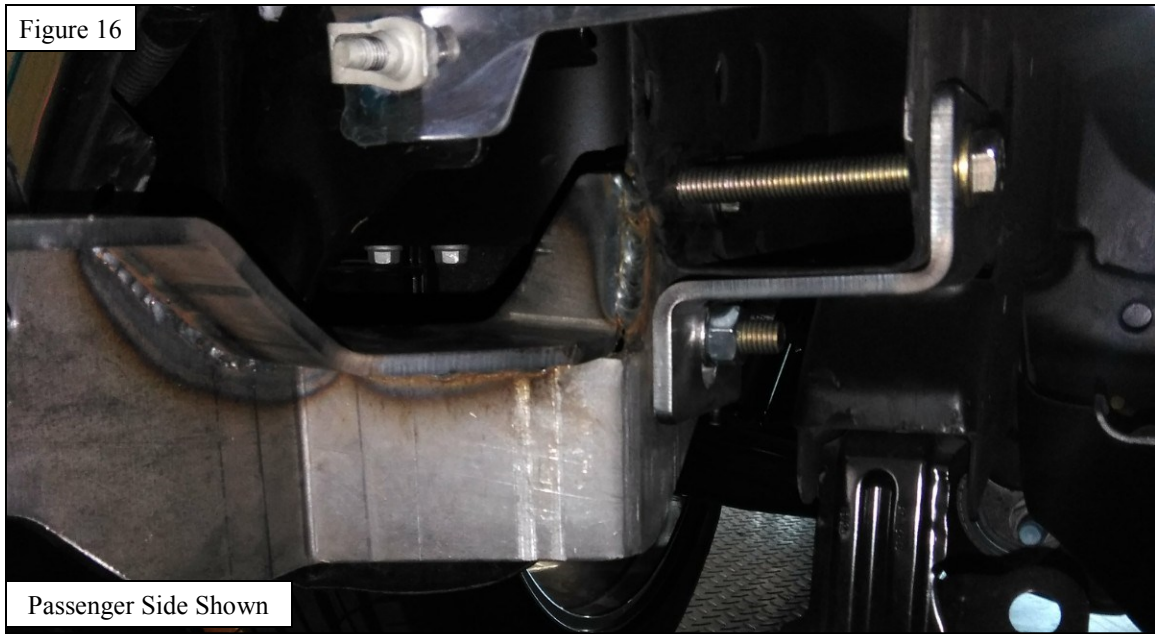
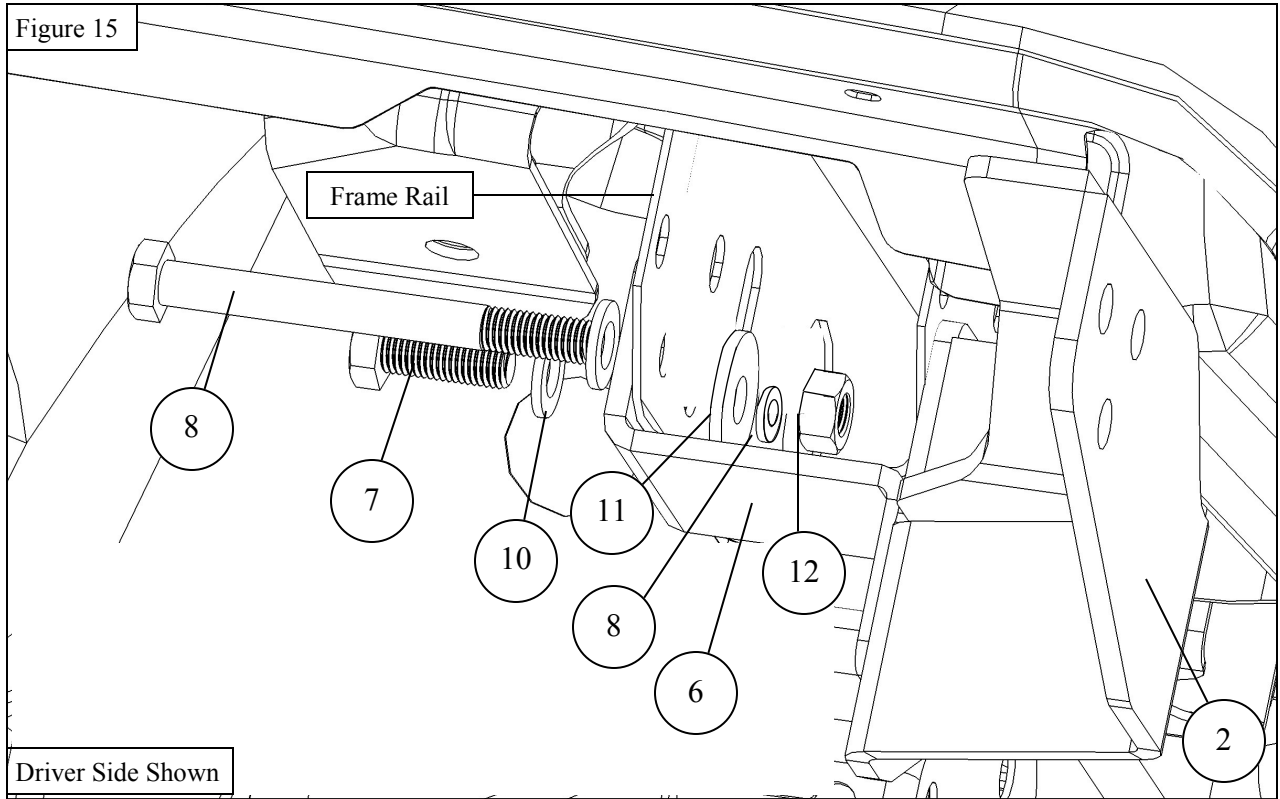

17. With help, loosely assemble the grille guard using supplied M10 and M12 hardware. **See Figure 15.**  
18. Align Grille Guard as needed and then torque as specified: M10 to 35-40 ft-lbs and M12 to 55-60 ft-lbs.

Figure 17

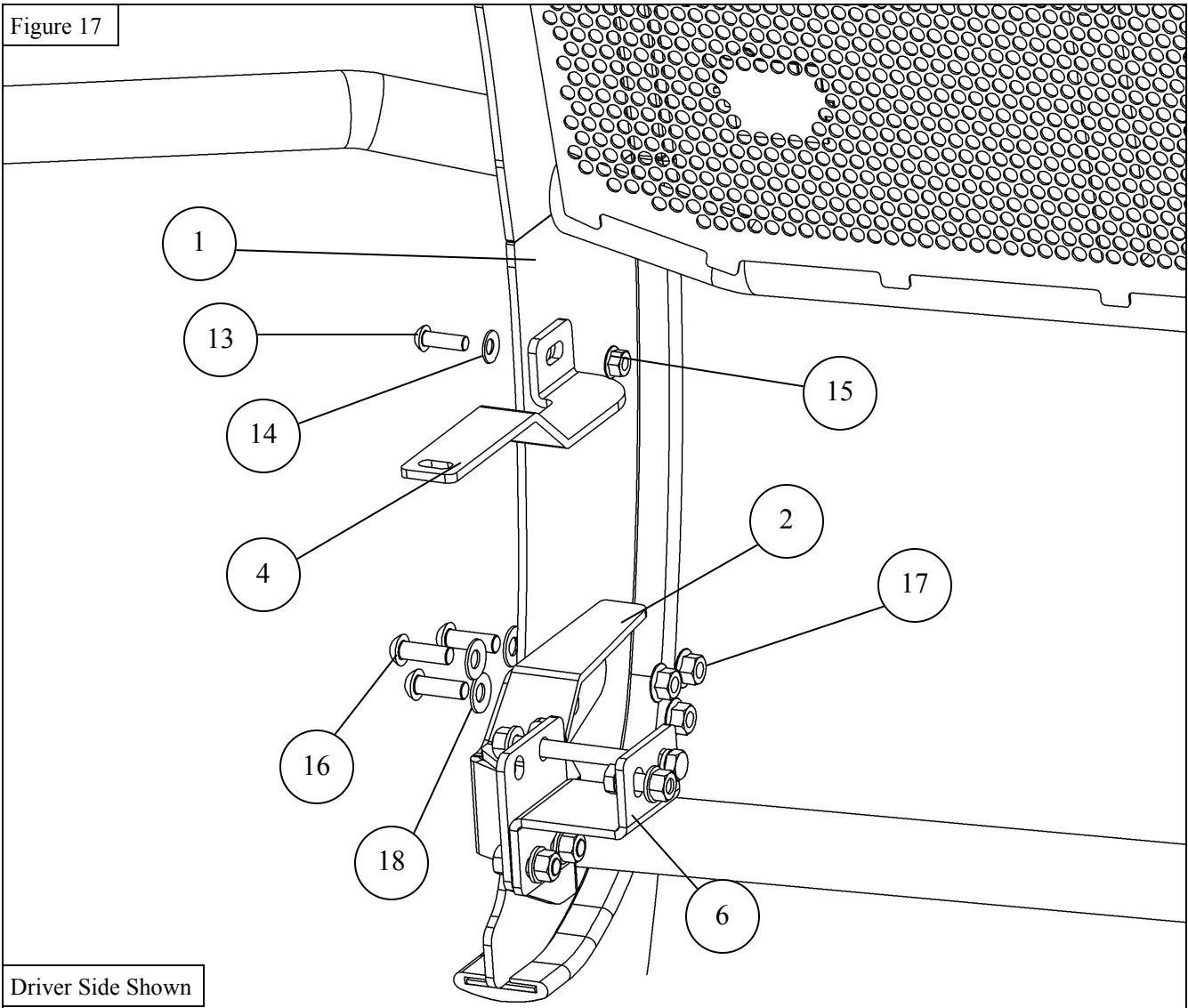

Driver Side Shown



**INSTALLATION COMPLETE**



©2019 WESTIN AUTOMOTIVE PRODUCTS, INC. ALL RIGHTS RESERVED

#### CARE INSTRUCTIONS

- REGULAR WAXING IS RECOMMENDED. DO NOT USE ANY TYPE OF POLISH OR WAX THAT MAY CONTAIN ABRASIVES.
- STAINLESS STEEL PRODUCTS CAN BE CLEANED WITH MILD SOAP AND WATER. STAINLESS STEEL POLISH SHOULD BE USED TO POLISH SMALL SCRATCHES.
- GLOSS BLACK FINISHES SHOULD BE CLEANED WITH MILD SOAP AND WATER.

**WESTIN**