



AUTOMOTIVE PRODUCTS,

# INSTALLATION INSTRUCTIONS

## ULTIMATE BULL BAR

### APPLICATION:

2016 Chevrolet Silverado 1500

### PART NUMBER:

32-3870, 32-3875

ITEM	QUANTITY	DESCRIPTION	TOOLS NEEDED
1	1	ULTIMATE BULL BAR ASSEMBLY	18MM WRENCH
2,3	2	MOUNT BRACKET, DRIVER (2) AND PASSENGER (3)	18MM SOCKET
4	4	M12 HEX HEAD CAP SCREW (YELLOW ZINC)	9/16 WRENCH
5	8	M12 FLAT WASHER (YELLOW ZINC)	RATCHET
6	4	M12 SPLIT LOCK WASHER (YELLOW ZINC)	TORQUE WRENCH
7	4	M12 HEX NUT (YELLOW ZINC)	ALLEN WRENCH
8	4	3/8-16 HEX SOCKET BUTTON HEAD SCREW (BLACK ZINC OR RAW) S/S	
9	8	3/8 SAE FLAT WASHER (BLACK ZINC OR RAW) S/S	
10	4	3/8 SPLIT LOCK WASHER (BLACK ZINC OR RAW) S/S	
11	4	3/8-16 HEX NUT (BLACK ZINC OR RAW) S/S	

**ANTI-SEIZE LUBRICANT MUST BE USED ON ALL STAINLESS STEEL FASTENERS TO PREVENT THREAD DAMAGE AND GALLING**

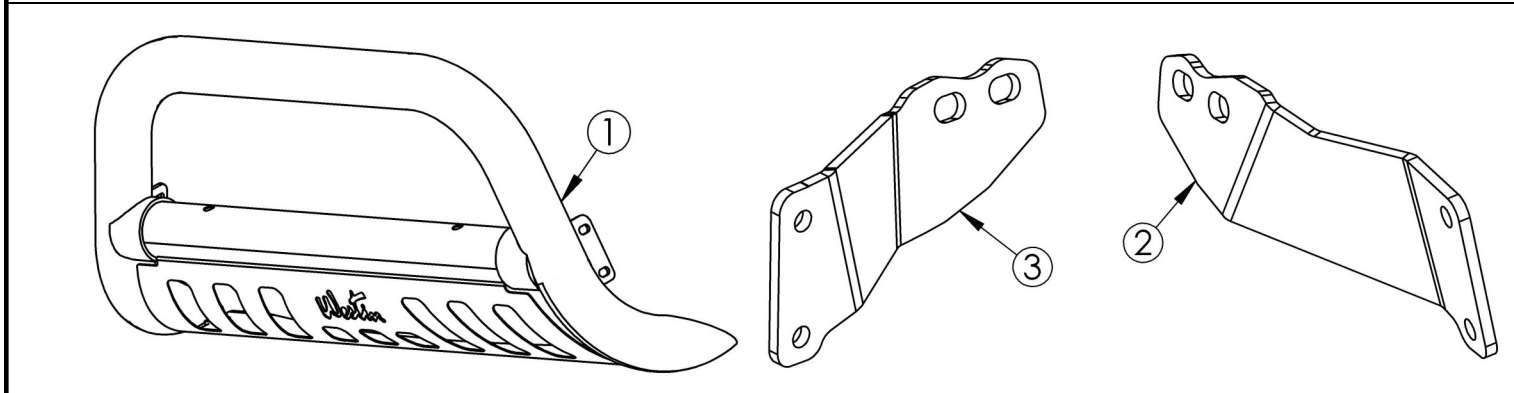

### PROCEDURE

1. Remove contents from box, verify if all parts listed are present and free from damage. Carefully read and understand all instructions before attempting installation.  
**Failure to identify damage before installation could lead to a rejection of any claim.**
2. *For models with factory tow hooks:* The driver side tow hook bolt must either be cut or the bumper must be removed to complete the Bull Bar installation.
3. *For models with factory tow hooks:* If removing bumper see **Figures 1 and 2**.
4. *For models with factory tow hooks:* Remove the tow hook bolts and the foam tow hook covers. Tow hooks cannot be reinstalled with application. See **Figures 3 and 4**.
5. *For models without factory tow hooks:* Trim the tow hook pockets in the front valance.



Thank you for choosing Westin products.

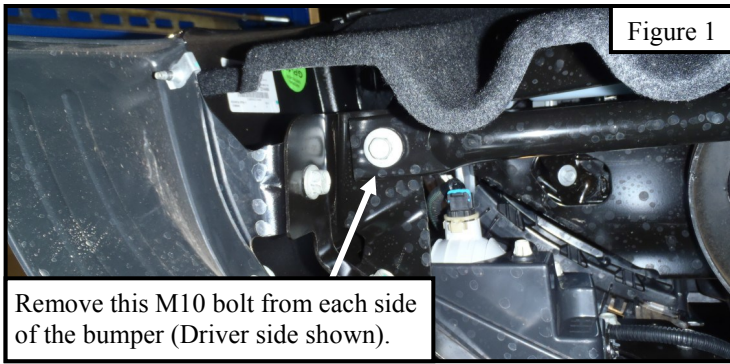

Remove this M10 bolt from each side of the bumper (Driver side shown).

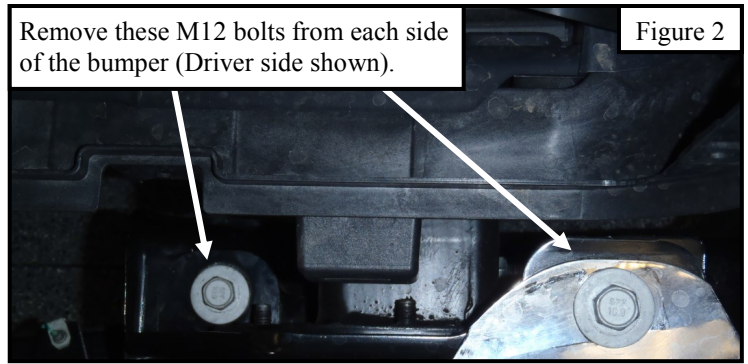

Remove these M12 bolts from each side of the bumper (Driver side shown).

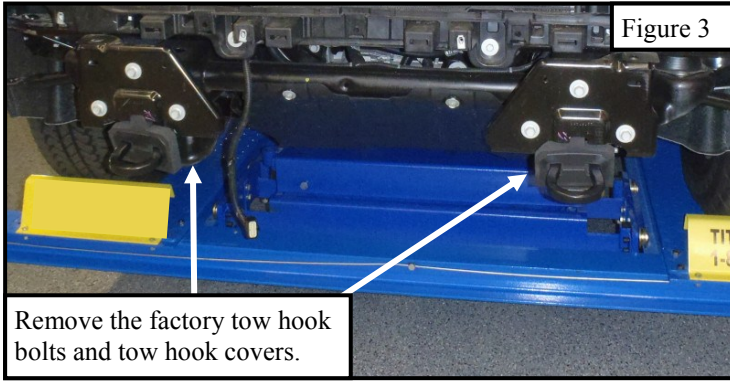

Remove the factory tow hook bolts and tow hook covers.

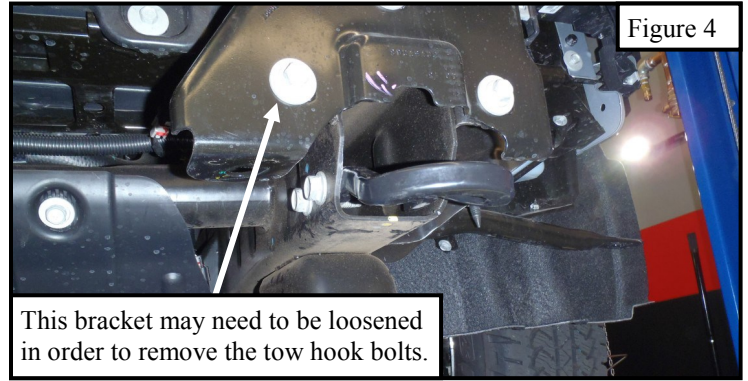

This bracket may need to be loosened in order to remove the tow hook bolts.

6. Locate (1) mount bracket (Item 2/3). Loosely install brackets using the provided M12 hardware. Repeat for other side. See **Figure 5**.
7. Reinstall bumper (if removed). Trim tow hook pockets as necessary.
8. With assistance loosely install the Ultimate Bull Bar Assembly (Item 1) onto the previously installed brackets. Loosely bolt bull bar to brackets using the provided 3/8" hardware. See **Figure 6**.
9. Align and adjust the bull bar and brackets as necessary then tighten and torque all fasteners as follows: M12 to 50-55 ft-lbs, 3/8" to 25-30 ft-lbs.

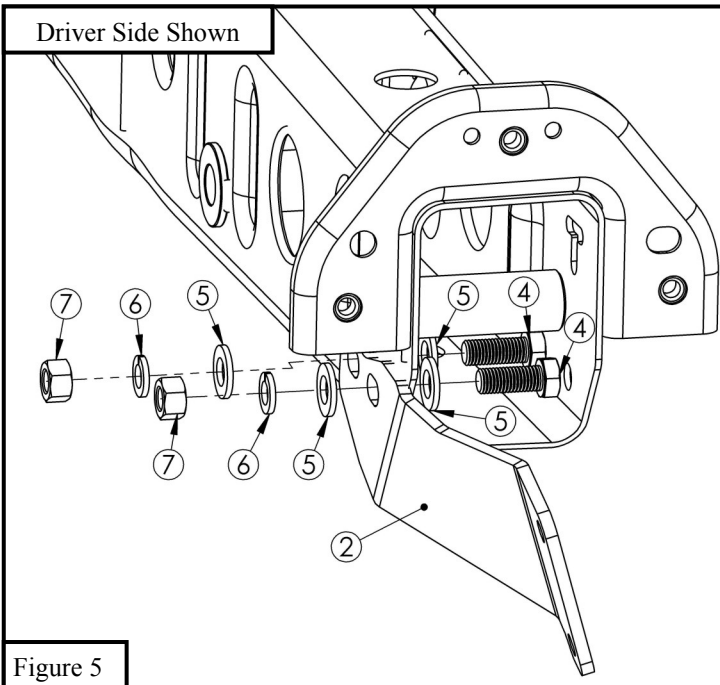

Figure 5

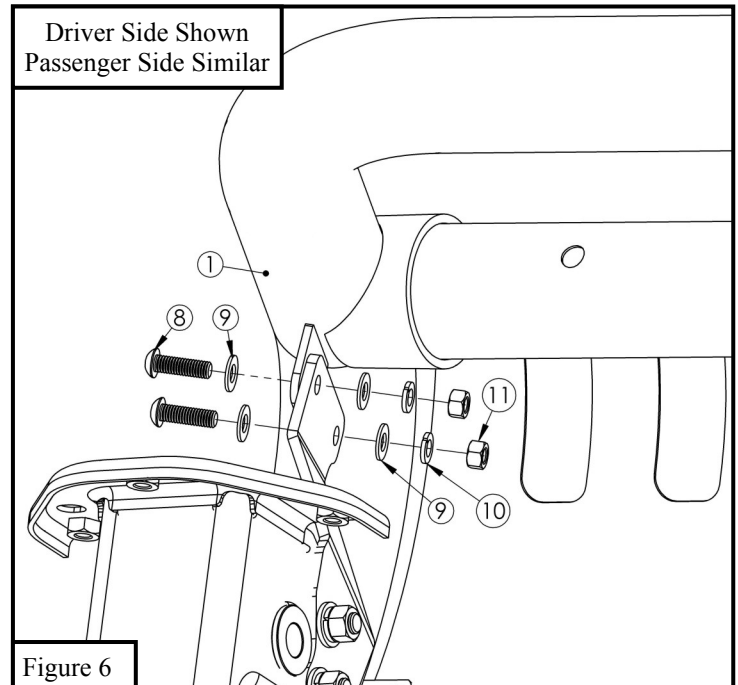
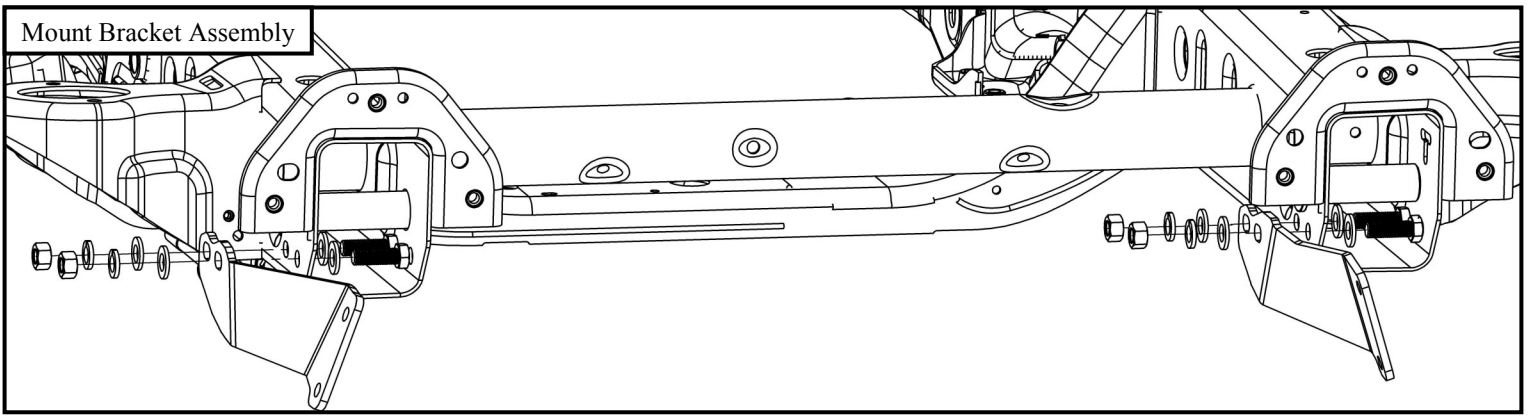

Figure 6



#### CARE INSTRUCTIONS

- REGULAR WAXING IS RECOMMENDED. DO NOT USE ANY TYPE OF POLISH OR WAX THAT MAY CONTAIN ABRASIVES.
- STAINLESS STEEL PRODUCTS CAN BE CLEANED WITH MILD SOAP AND WATER. STAINLESS STEEL POLISH SHOULD BE USED TO POLISH SMALL SCRATCHES.
- GLOSS BLACK FINISHES SHOULD BE CLEANED WITH MILD SOAP AND WATER.

**Westin.**  
SIGNATURE OF QUALITY

Thank you for choosing Westin products.



SIGNATURE OF QUALITY

AUTOMOTIVE PRODUCTS, INC.



# WARNING



Failure to follow these instructions could lead to death, personal injury, and / or property damage.

**FASTENERS:**

All Westin supplied fasteners must be utilized and installed in accordance with the installation instructions and apply torque to the specifications as defined. **DOUBLE CHECK ALL FASTENERS BEFORE INITIAL USE, AND PERIODICALLY IN THE FUTURE TO ENSURE PROPER FUNCTION AND SAFETY.**

**DRILLING:**

Most Westin products do not require drilling for installation. If drilling is defined as required, use caution when drilling a vehicle. **FAILURE TO REVIEW AN AREA TO BE DRILLED MAY RESULT IN PERSONAL INJURY AND/OR INJURY TO OTHERS AS WELL AS VEHICLE DAMAGE.**

**EYE PROTECTION:**

**ALWAYS WEAR SAFETY GLASSES OR GOGGLES DURING THE INSTALLATION PROCESS TO AVOID PERSONAL INJURY.**

**MAXIMUM TOWING/CARRYING CAPACITY:**

The Westin Receiver Hitches will have a visible tow rating label affixed directly on the product. User should never exceed the vehicle manufacturers maximum tow and weight rating regardless of the capacity of the hitch. **FAILURE TO FOLLOW THESE GUIDELINES WILL VOID THE WESTIN WARRANTY AND MAY RESULT IN PERSONAL INJURY AND/OR INJURY TO OTHERS AS WELL AS VEHICLE DAMAGE.**



SIGNATURE OF QUALITY

Thank you for choosing Westin products.