

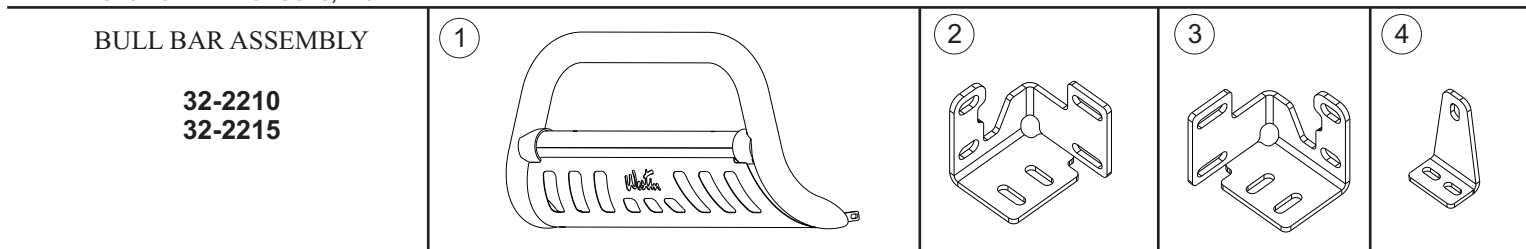

INSTRUCTIONS

APPLICATION: 2006-08 TOYOTA FJ CRUISER

AUTOMOTIVE PRODUCTS, INC.



ITEM	QTY	CONTENTS	TOOLS
1	1	BULL BAR ASSEMBLY	9/16" SOCKET 9/16" WRENCH 3/4" SOCKET 3/4" WRENCH 14MM SOCKET 14MM WRENCH 19MM SOCKET RATCHET TORQUE WRENCH
2, 3	2	BRACKET, PASSENGER (2) AND DRIVER (3)	
4	2	SUPPORT BRACE	
5	2	PLASTIC PLUG	
6	4	RUBBER BUMPER	
7	4	3/8-16 X 1.25" HEX HEAD BOLT, STAINLESS STEEL	
8	8	3/8" FLAT WASHER, STAINLESS STEEL	
9	4	3/8" LOCK WASHER, STAINLESS STEEL	
10	4	3/8-16 HEX NUT, STAINLESS STEEL	
11	4	3/8-16 X 5.00" HEX HEAD BOLT, YELLOW ZINC	
12	8	3/8" FLAT WASHER, YELLOW ZINC	
13	4	3/8" LOCK WASHER, YELLOW ZINC	
14	4	3/8-16 HEX NUT, YELLOW ZINC	
15	4	1/2-13 X 1.25" HEX HEAD BOLT, STAINLESS STEEL	
16	10	1/2" FLAT WASHER, STAINLESS STEEL	
17	6	1/2" LOCK WASHER, STAINLESS STEEL	
18	4	1/2-13 HEX NUT, STAINLESS STEEL	
19	2	M12-1.25 X 30MM HEX HEAD BOLT	
20	2	SPACER PLATES(2010-UP MODEL YEARS ONLY)	

- STEP 1.** Remove the contents from box and check for damage. Verify all parts are present. Read instructions completely before beginning. NOTE: Westin advises the installer to use a thread lubricant on all of the stainless steel fasteners.
- STEP 2.** NOTE: It will be necessary to remove the front license plate and bracket. If local/state laws requires a license plate, license plate relocation kit 32-0055 is available.
- STEP 3.** Position brackets onto bottom surface of frame using 3/8" yellow zinc fasteners. Leave loose. SEE FIGURES 2 AND 3.
- STEP 4.** Attach support brace to brackets using 3/8" stainless steel fasteners. Attach support brace to frame using M12 fasteners. Leave loose. SEE FIGURE 3.
- STEP 5.** Attach Bull Bar to mount brackets using 1/2" fasteners. Level and adjust Bull Bar as desired and tighten all fasteners. SEE FIGURE 4. Recommended torque values are 37 Ft. Lbs. for 1/2" fasteners, 17 Ft. Lbs. for 3/8" stainless steel fasteners, 26 Ft.Lbs. for 3/8" yellow zinc fasteners and 55 Ft. Lbs. for M12 fasteners.
- LIGHT INSTALLATION:** Insert threaded stud on base of the light through hole in cross tube. Using a ratchet, extension and socket for correct size of nut supplied, insert through large clearance hole in bottom of cross tube. Thread nut and washers on stud and tighten. SEE FIGURE 1. NOTE: A short socket, not a deep well works best to get the nut started.
- NOTE:** Fits most 6" round or rectangle lights. Some lights may require replacing included mount/isolator with rubber

FINISH PROTECTION

Westin products have a high quality finish that must be cared for like any other exposed finish on the vehicle. Protect the finish with a non-abrasive automotive wax, (e.g. Pure Carnuba) on a regular basis. The use of any soap, polish or wax that contains an abrasive is detrimental, as the compounds scratch the finish and open it to corrosion.

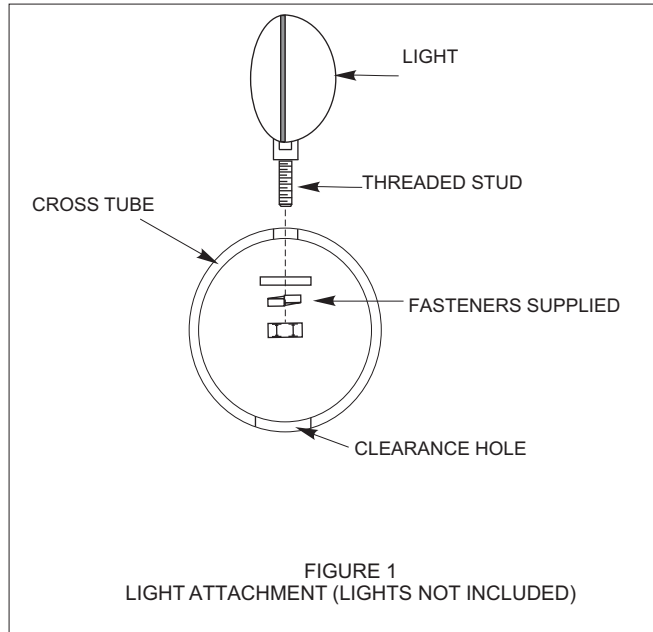

FIGURE 2 DRIVER SIDE SHOWN, PASSENGER SIDE OPPOSITE

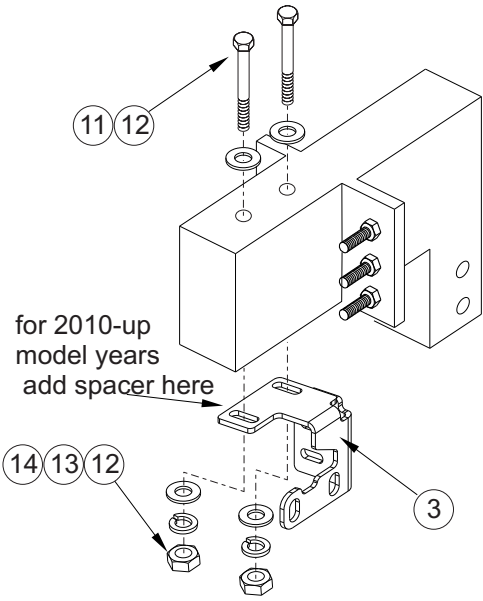

FIGURE 3 DRIVER SIDE SHOWN, PASSENGER SIDE OPPOSITE

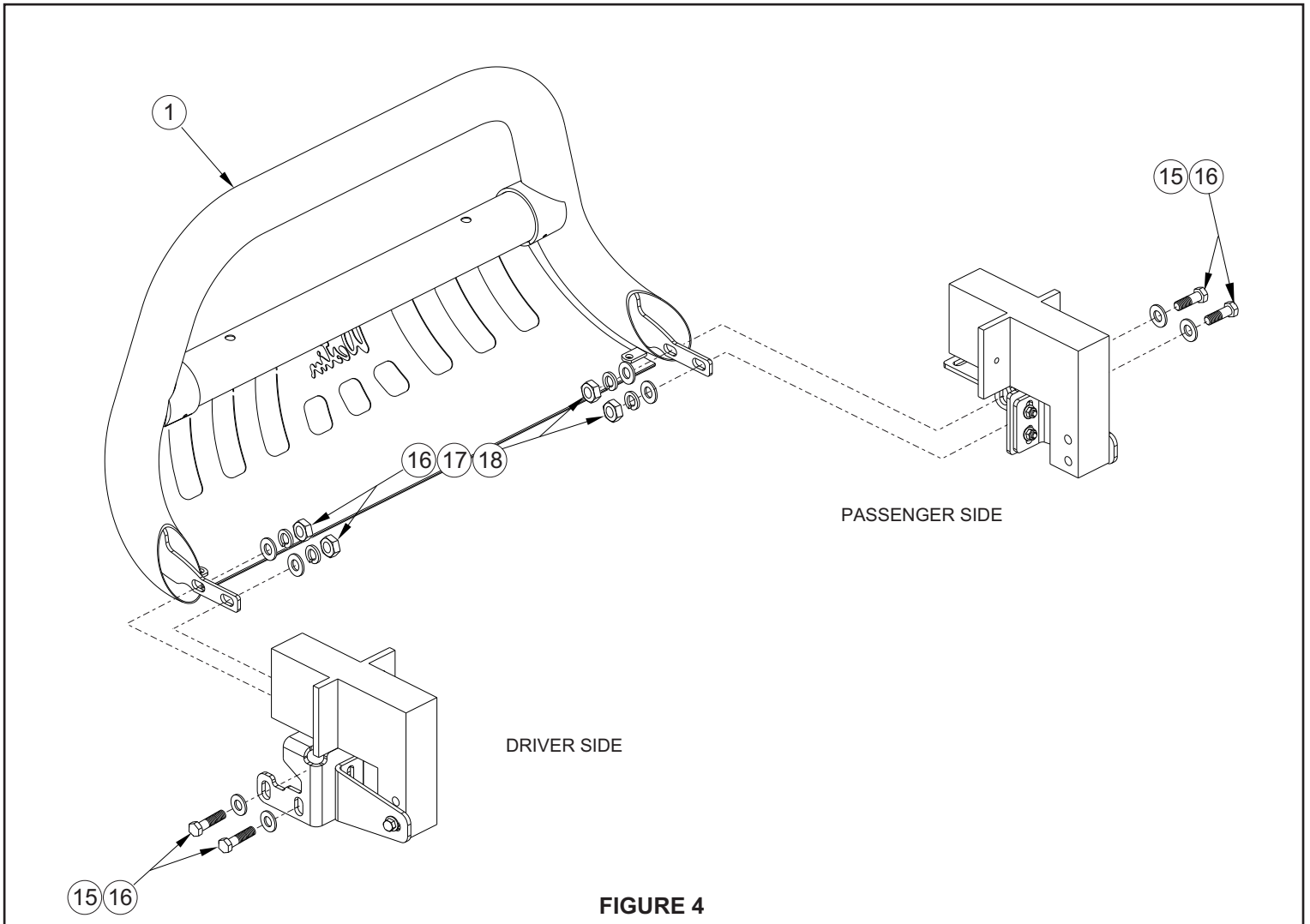
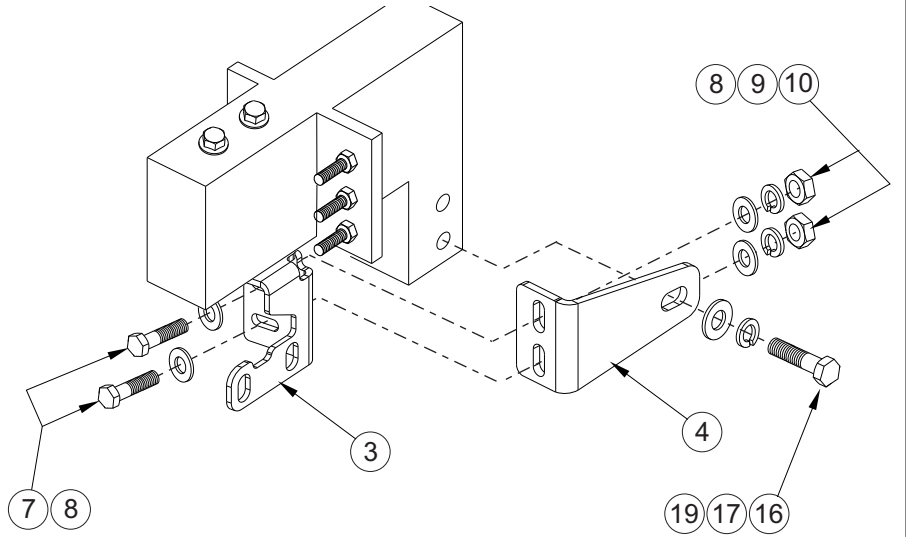

FIGURE 4