

INSTALLATION INSTRUCTIONS

E- SERIES BULL BAR



APPLICATION:
2019 Ford Ranger
PART NUMBER:
31-3980, 31-3985

| CONTENT | | | |
|---------|----------|---------------------------------------|---------------|
| ITEM | QUANTITY | DESCRIPTION | TOOLS NEEDED |
| 1 | 1 | BULL BAR | 13MM SOCKET |
| 2 | 1 | DRIVER MOUNTING BRACKET | 17MM SOCKET |
| 3 | 1 | PASSENGER MOUNTING BRACKET | 13MM WRENCH |
| 4 | 1 | DRIVER SUPPORT STRAP | 17MM WRENCH |
| 5 | 1 | PASSENGER SUPPORT STRAP | RATCHET |
| 6 | 4 | M12 HEX HEAD BOLT (BLACK ZINC) | TORQUE WRENCH |
| 7 | 4 | M12 SPLIT LOCK WASHER (BLACK ZINC) | CUTTING TOOL |
| 8 | 4 | M12 FLAT WASHER (BLACK ZINC) | |
| 9 | 4 | M12 SERRATED FLANGE BOLT (BLACK ZINC) | |
| 10 | 4 | M12 SERRATED FLANGE NUT (BLACK ZINC) | |
| 11 | 2 | M8 BUTTON HEAD BOLT (BLACK ZINC) | |
| 12 | 2 | M8 SPLIT LOCK WASHER (BLACK ZINC) | |
| 13 | 2 | M8 FLAT WASHER (BLACK ZINC) | |
| 14 | 2 | M8 HEX HEAD BOLT (YELLOW ZINC) | |
| 15 | 2 | M8 SPLIT LOCK WASHER (YELLOW ZINC) | |
| 16 | 2 | M8 FLAT WASHER (YELLOW ZINC) | |

ANTI-SEIZE LUBRICANT MUST BE USED ON ALL STAINLESS STEEL FASTENERS TO PREVENT THREAD DAMAGE AND GALLING

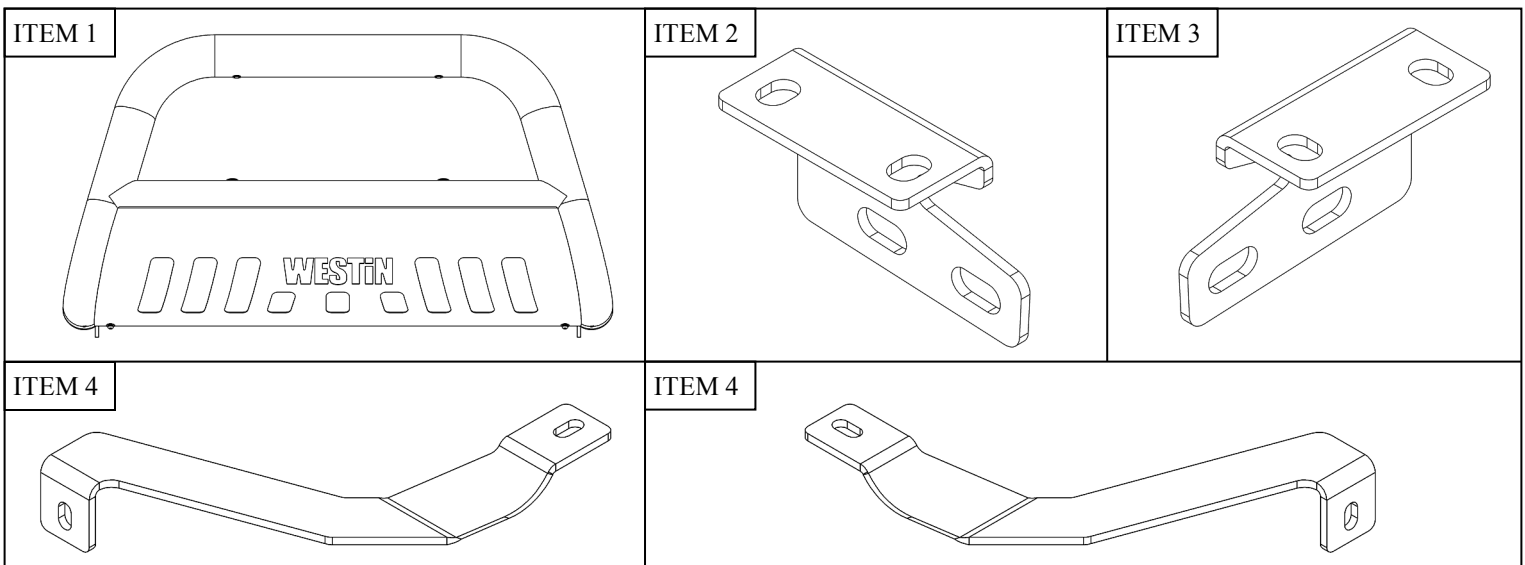

PROCEDURE

1. Remove contents from box, verify if all parts listed are present and free from damage.
Carefully read and understand all instructions before attempting installation.
Failure to identify damage before installation could lead to a rejection of any claim.

2. If equipped, remove the factory tow hooks. See **Figure 1**. *Note: Factory tow hooks cannot be re-used.*

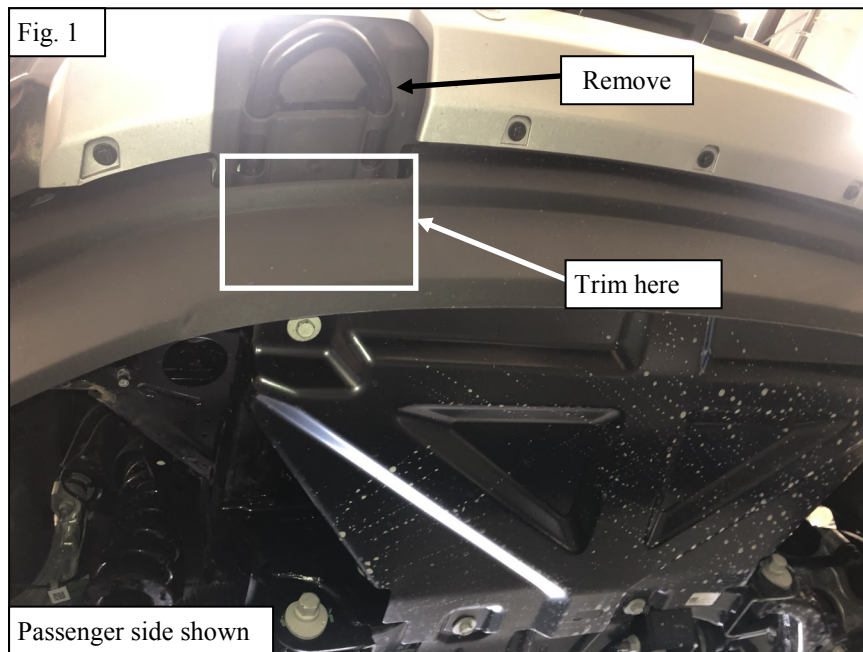

3. Using The supplied M12 hardware (items 6-8), loosely install the mounting brackets (items 2-3) in the tow hook mounting locations. See **Figures 2-3**. Trim front valence as necessary.

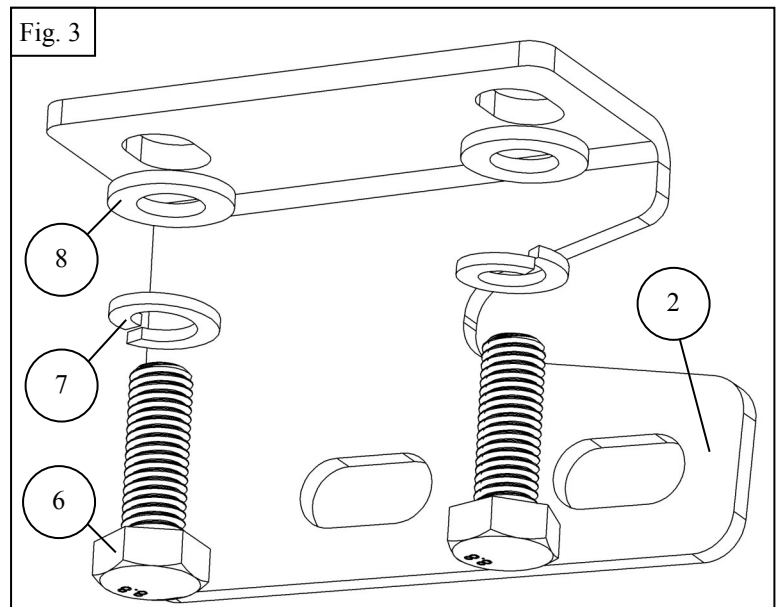
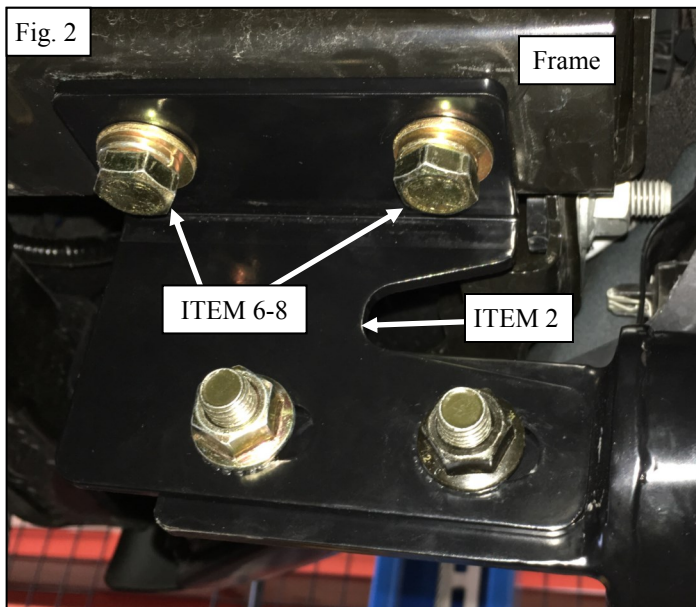

4. Remove factory bolt and loosely install the driver support strap (item 4) on to the top side of the bumper mount using the supplied M8 hardware (items 14-16). Start by rotating the strap and sliding it in just above the bumper between the driver side bumper mount and the driver side door. Slide the support strap into place and use factory weld nut to install.
Note: The space between the bumper and grille may be too small to slide the bracket through. If this is the case, loosen the hardware holding the bumper on to slide the bracket in. Tighten bumper hardware after support straps have been installed. See Figures 4-6
5. Repeat the process on the passenger side.

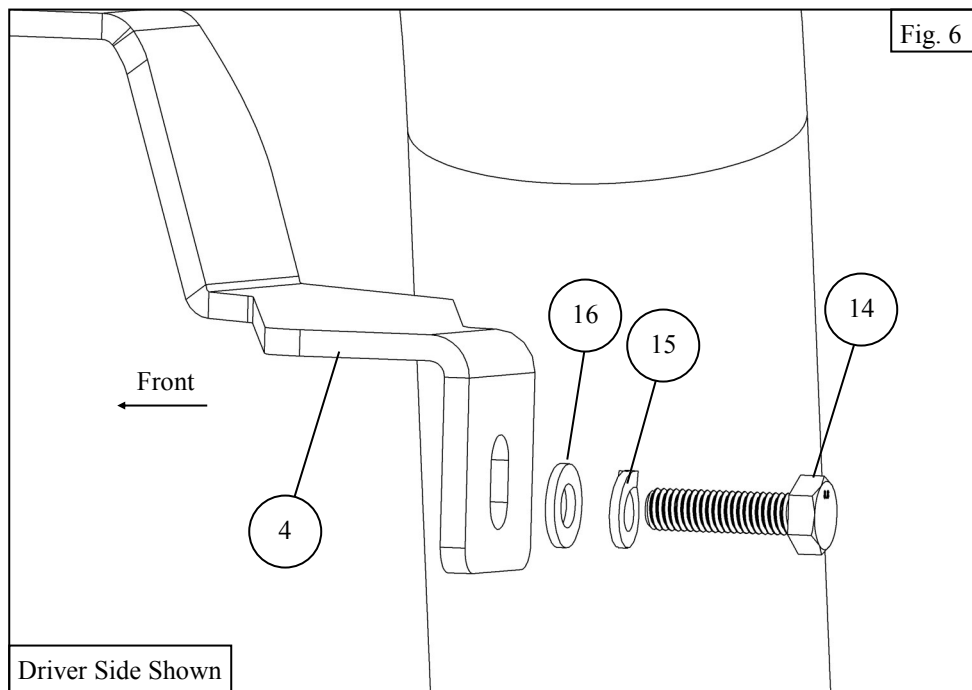
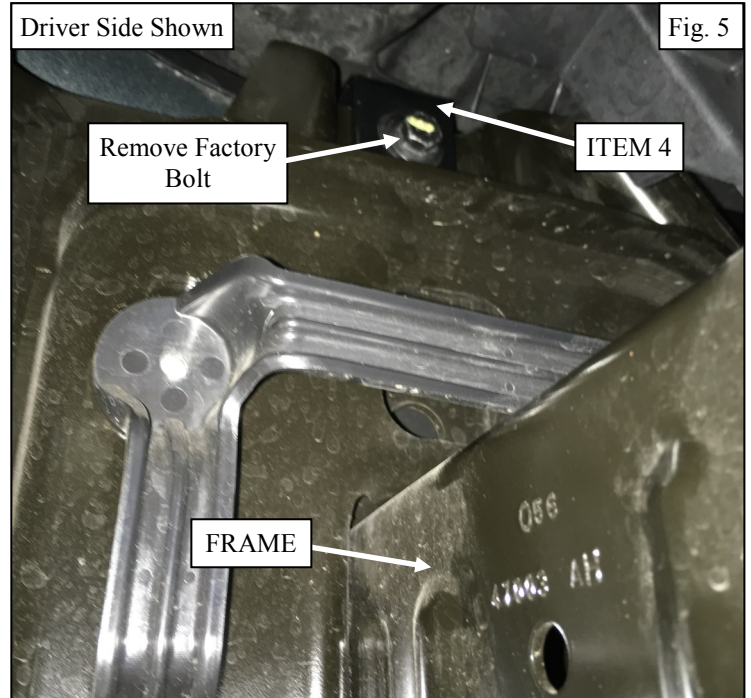
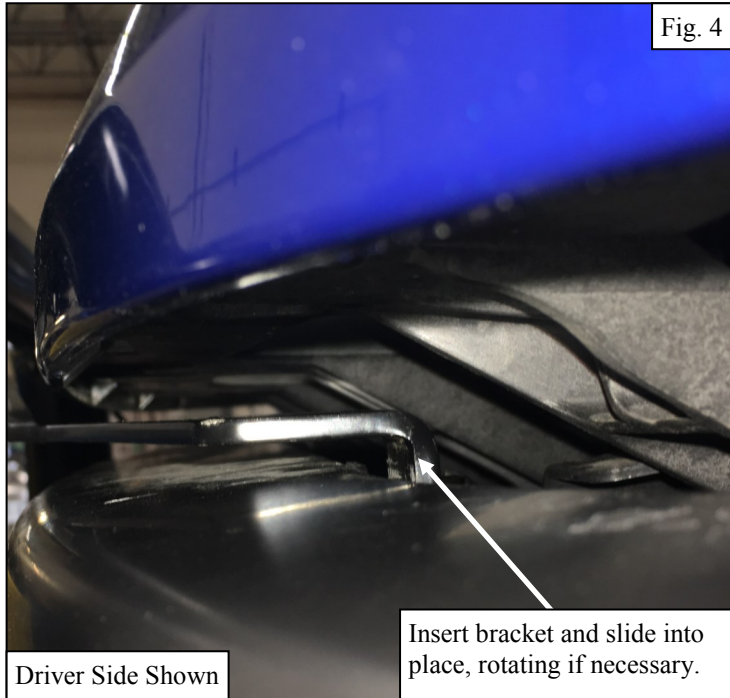

6. With the brackets now in place, loosely install the bull bar using the supplied M8 and M12 hardware. See **Figures 7-8**.

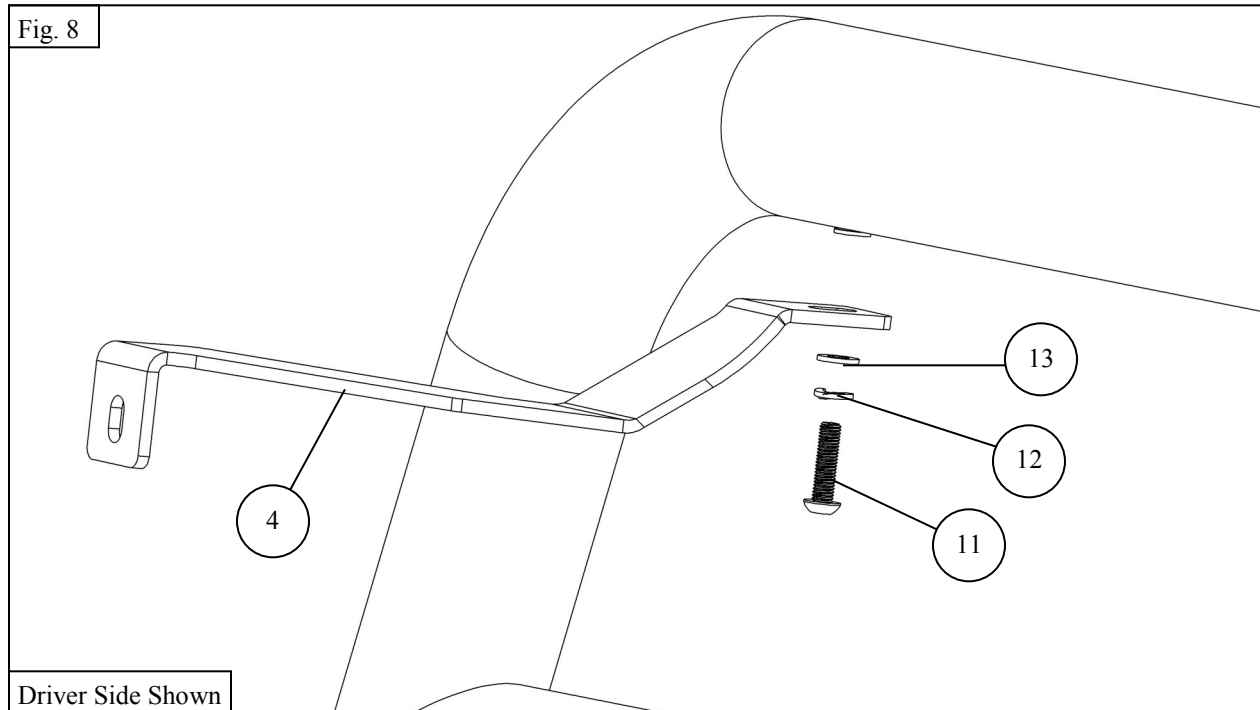
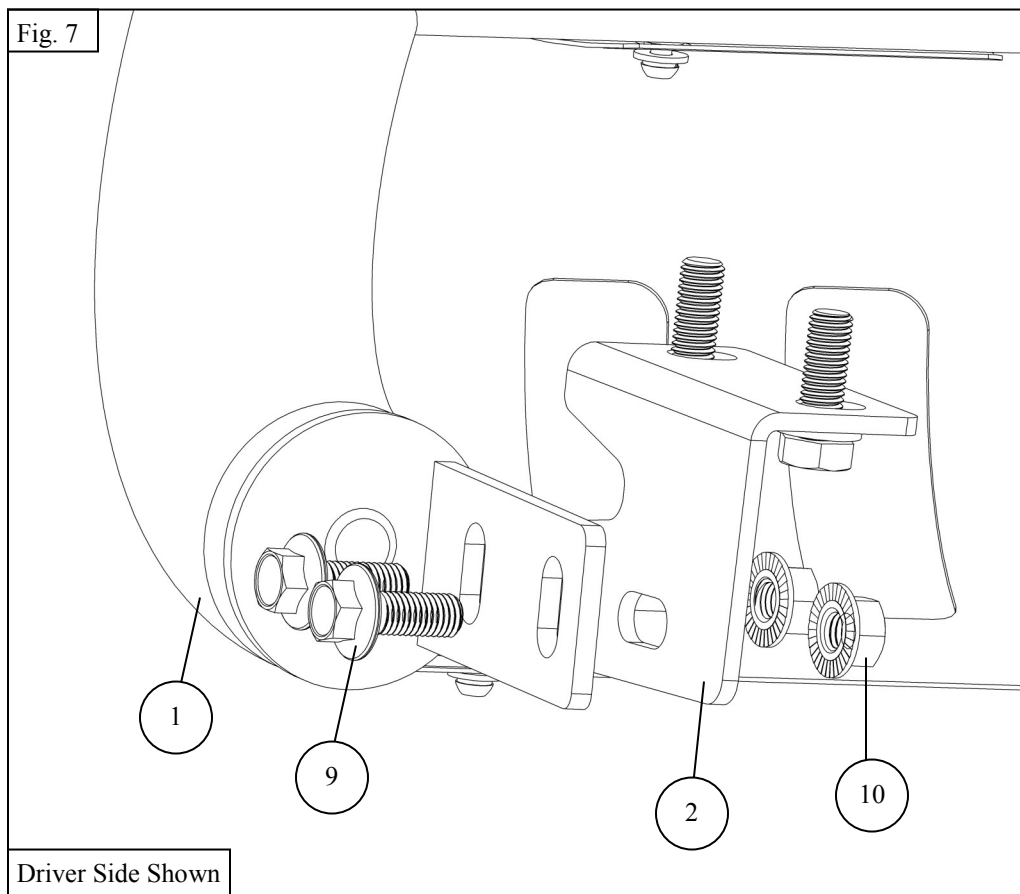

7. Adjust the bull bar as needed and torque all hardware as specified: M8 to 15-18 ft-lbs, M12 to 45-50 ft-lbs.

INSTALLATION COMPLETED



CARE INSTRUCTIONS

- REGULAR WAXING IS RECOMMENDED. DO NOT USE ANY TYPE OF POLISH OR WAX THAT MAY CONTAIN ABRASIVES.
- STAINLESS STEEL PRODUCTS CAN BE CLEANED WITH MILD SOAP AND WATER. STAINLESS STEEL POLISH SHOULD BE USED TO POLISH SMALL SCRATCHES.
- GLOSS BLACK FINISHES SHOULD BE CLEANED WITH MILD SOAP AND WATER.

WESTIN