







SIGNATURE OF QUALITY

INSTRUCTIONS

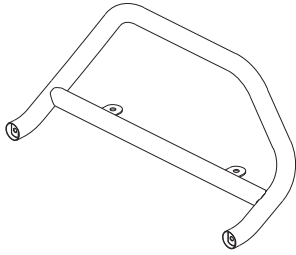
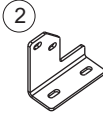
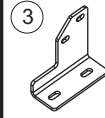
APPLICATION: 2005-08 CHEVROLET EQUINOX; 2002-07 SATURN VUE;
2006-08 PONTIAC TORRENT

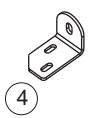
AUTOMOTIVE PRODUCTS, INC.

<p>SAFARI BAR ASSEMBLY</p> <p>30-0020 30-0025</p> <p>MOUNT KIT</p> <p>30-1375</p>				
				

ITEM	QTY	CONTENTS	TOOLS
1	1	SAFARI BAR ASSEMBLY (PURCHASED SEPARATELY)	3/4" SOCKET
2,3	2	TOP BRACKET, PASSENGER (2) AND DRIVER (3)	3/4" WRENCH
4,5	2	BOTTOM BRACKET, PASSENGER (4) AND DRIVER (5)	9/16" SOCKET
6	2	1/2-13 X 2.00" HEX HEAD BOLT	9/16" WRENCH
7	2	1/2" FLAT WASHER	RATCHET
8	2	1/2" LOCK WASHER	SMALL FLAT SCREWDRIVER
9	4	3/8-16 X 1.25" HEX HEAD BOLT	TAP WRENCH
10	8	3/8" SAE FLAT WASHER	TORQUE WRENCH
11	4	3/8" USS FLAT WASHER	UTILITY KNIFE
12	8	3/8" LOCK WASHER	
13	8	3/8-16 HEX NUT	
14	2	U-BOLT	

- STEP 1.** Remove the contents from box and check for damage. Verify all parts are present. Read instructions completely before beginning.
- 2005-UP Chevrolet Equinox and 2006-UP Pontiac Torrent**
- STEP 2.** Remove lower air dam from bumper by removing twelve push type fasteners and four screws.
- STEP 3.** Attach top and bottom mount brackets as shown. Leave loose. It will be necessary to cut a notch in the bumper cover where top brackets contact.
- STEP 4.** Attach Safari Bar to brackets as shown. Center and level Safari Bar. Torque top bracket U-bolt fasteners to 20 FT.LBS.
- STEP 5.** Remove Safari Bar and bottom mount brackets.
- STEP 6.** Measure the location of top brackets from center of vehicle and relay dimensions to air dam. Verify dimensions by holding air dam to vehicle and then cut lower air dam to allow clearance for top mount brackets. Re-install air dam using previously removed push type fasteners and screws.
- STEP 7.** Reinstall bottom mount brackets and Safari Bar. Make sure Safari Bar and brackets are properly aligned and tighten fasteners. Recommended torque values for 3/8" fasteners to 20 FT.LBS and 1/2" stainless steel fasteners to 43 FT.LBS.
- 2002-05 Saturn Vue**
- STEP 2.** Remove lower air dam from bumper by removing nine push type fasteners.
- STEP 3.** Attach top and bottom mount brackets as shown. Leave loose. It will be necessary to cut a notch in the bumper cover where top brackets contact.
- STEP 4.** Attach Safari Bar to brackets as shown. Center and level Safari Bar. Torque top bracket U-bolt fasteners to 20 FT.LBS.
- STEP 5.** Remove Safari Bar and bottom mount brackets.
- STEP 6.** Measure the location of top brackets from center of vehicle and relay dimensions to air dam. Verify dimensions by holding air dam to vehicle and then cut lower air dam to allow clearance for top mount brackets. Re-install air dam using previously removed push type fasteners.
- STEP 7.** Reinstall bottom mount brackets and Safari Bar. Make sure Safari Bar and brackets are properly aligned and tighten fasteners. Recommended torque values for 3/8" fasteners to 20 FT.LBS and 1/2" stainless steel fasteners to 43 FT.LBS.
- 2006-UP Saturn Vue**
- STEP 2.** Locate top bracket mount holes in frame
- STEP 3.** Cut lower air dam where necessary to allow brackets to slide through.
- STEP 4.** Attach top and bottom mount brackets as shown. Leave loose.
- STEP 5.** Attach Safari Bar to brackets as shown. Make sure Safari Bar and brackets are properly aligned and tighten fasteners. Recommended torque values for 3/8" fasteners to 20 FT.LBS and 1/2" stainless steel fasteners to 43 FT.LBS.

FINISH PROTECTION

Westin products have a high quality finish that must be cared for like any other exposed finish on the vehicle. Protect the finish with a non-abrasive automotive wax, (e.g. Pure Carnauba) on a regular basis. The use of any soap, polish or wax that contains an abrasive is detrimental, as the compounds scratch the finish and open it to corrosion.

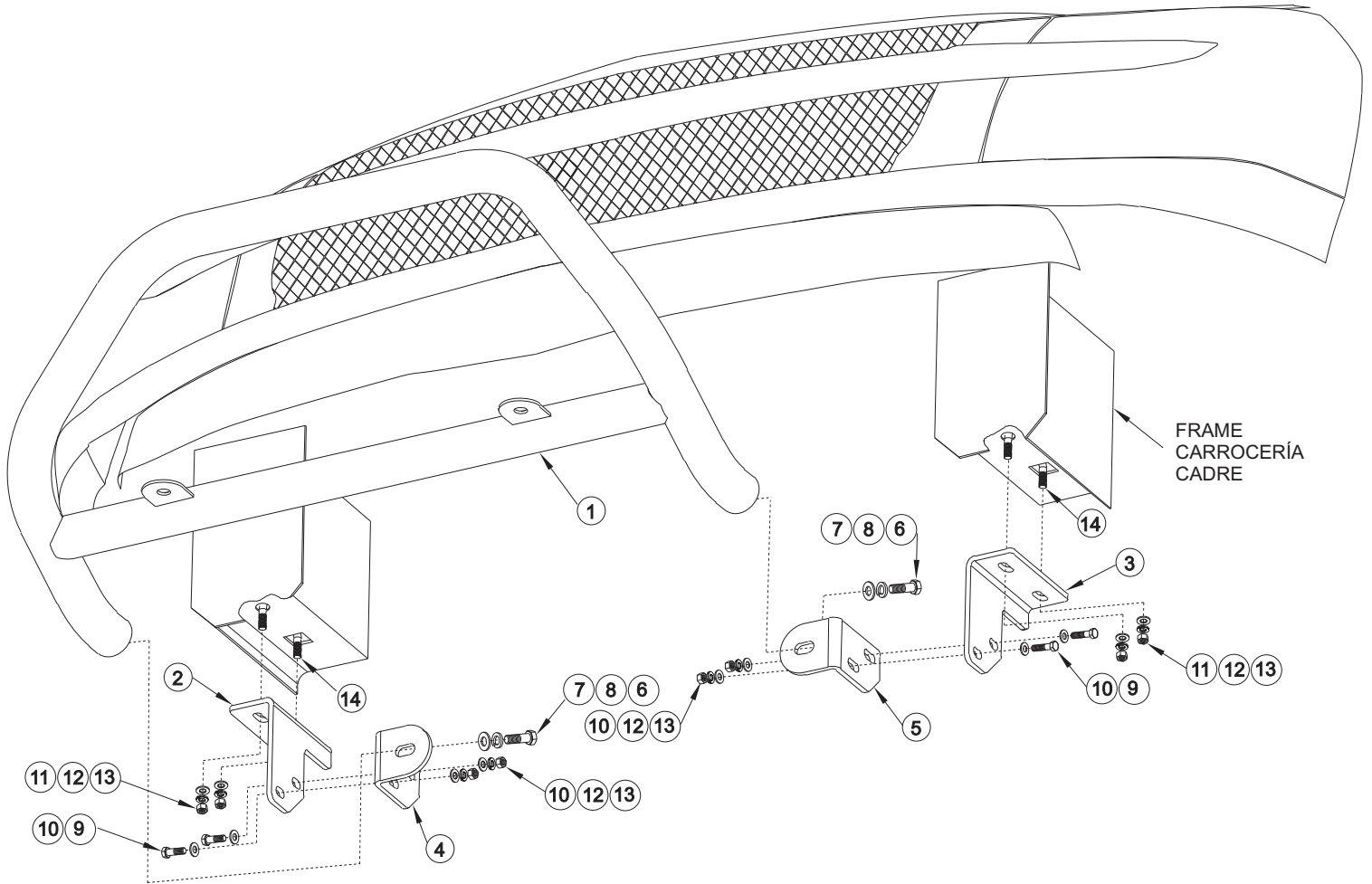

FIGURE 1

Westin.
SIGNATURE OF QUALITY

AUTOMOTIVE PRODUCTS, INC.

Thank You for choosing Westin products.

Shop for quality Westin products on our website.

Buy grille guards and bull bars in our online store.