



SIGNATURE OF QUALITY

INSTRUCTIONS

APPLICATION: 2003-08 HONDA PILOT

AUTOMOTIVE PRODUCTS, INC.

SAFARI BAR ASSEMBLY

30-0000 30-0005

MOUNT KIT

30-1255

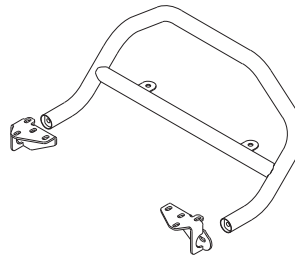

ITEM	QTY	CONTENTS	TOOLS
1	1	SAFARI BAR ASSEMBLY (PURCHASED SEPARATELY)	3/4" WRENCH
2,3	2	BRACKET, PASSENGER (2) AND DRIVER(3)	9/16" SOCKET
4	2	1/2-13 X 2.00" HEX HEAD BOLT	9/16" WRENCH
5	6	1/2" FLAT WASHER	17MM SOCKET
6	2	1/2" LOCK WASHER	17MM WRENCH
7	2	3/8-16 X 1.00" HEX HEAD BOLT	14MM SOCKET
8	4	3/8" FLAT WASHER	14MM WRENCH
9	2	3/8" LOCK WASHER	RATCHET
10	2	3/8-16 HEX NUT	SMALL FLAT SCREWDRIVER
11	2	10MM PUSH TYPE RETAINER	TORQUE WRENCH
12	2	8MM PUSH TYPE RETAINER	UTILITY KNIFE

- STEP 1. Remove the contents from box and check for damage. Verify all parts are present. Read instructions completely before beginning.
- STEP 2. Determine passenger and driver brackets.
- STEP 3. Remove 16 push type retainers from lower splash shield. Remove plastic splash shield to gain access to mounting locations.
- STEP 4. Locate and remove fasteners that hold frame brace and bumper brackets to vehicle using a 17mm and 14mm socket and ratchet. **SEE FIGURE 1.**
- STEP 5. Install brackets between lower radiator support and top of frame brace using (2) 1/2" flat washers on top of bracket's frame brace slots and existing bolts previously removed. Install using 3/8" fasteners per bracket. **SEE FIGURE 1. NOTE:** It may be necessary to loosen body mount bolt holding frame brace to gain enough clearance to slide brackets in place.
- STEP 6. Temporarily attach the Safari Bar using 1/2" fasteners as shown. Level and adjust Safari Bar as desired and tighten all fasteners. Recommended torque values are 26 Ft. Lbs. for 3/8" fasteners, 35 Ft. Lbs. for 10mm fasteners, and 61 for 12mm fasteners.
- STEP 7. Remove Safari Bar.
- STEP 8. Cut plastic splash shield to accommodate brackets. See cutting reference for guidelines on cutting.
- STEP 9. Re-install splash shield and all push type retainers.
- STEP 10. Re-attach Safari Bar. Level and adjust Safari Bar as desired and tighten 1/2" fasteners to 64 Ft. Lbs.

CUTTING INSTRUCTIONS - (Recommendation only, sizes are approximate)

The template works best if placed on the top side of the splash shield (the side towards the vehicle). Locate two oval slots that measure 3 3/8" x 1 3/16". Cut out template and place over the appropriate slots. Hold in place using masking tape. Drill 1/4" holes at each of the small

FINISH PROTECTION

Westin products have a high quality finish that must be cared for like any other exposed finish on the vehicle. Protect the finish with a non-abrasive automotive wax, (e.g. Pure Carnauba) on a regular basis. The use of any soap, polish or wax that contains an abrasive is detrimental, as the compounds scratch the finish and open it to corrosion.

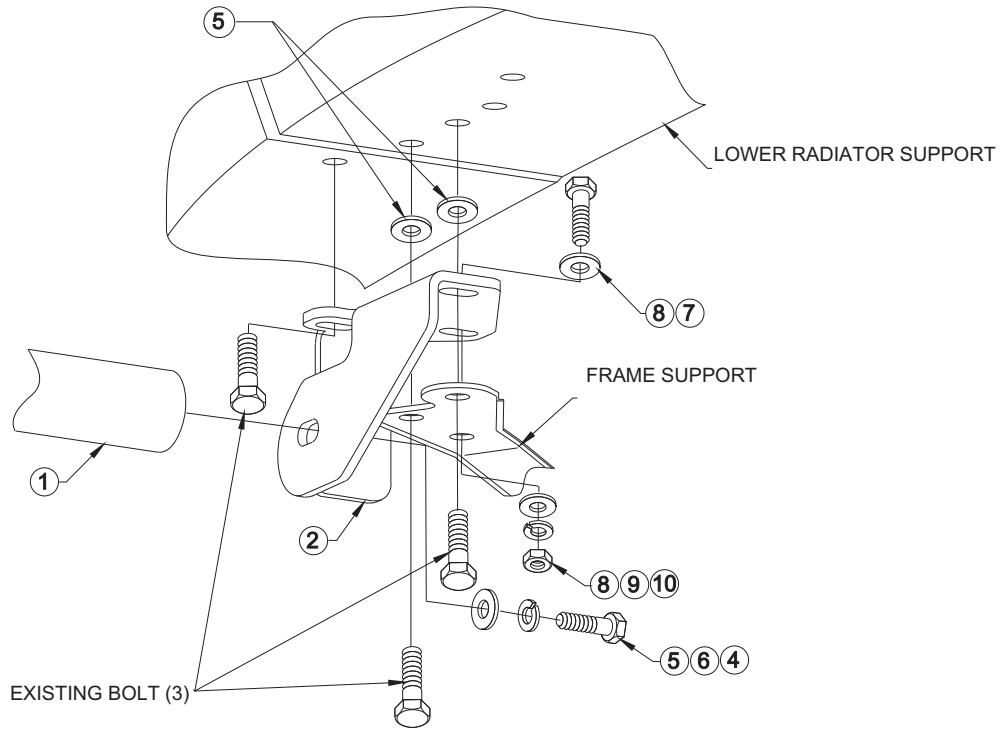
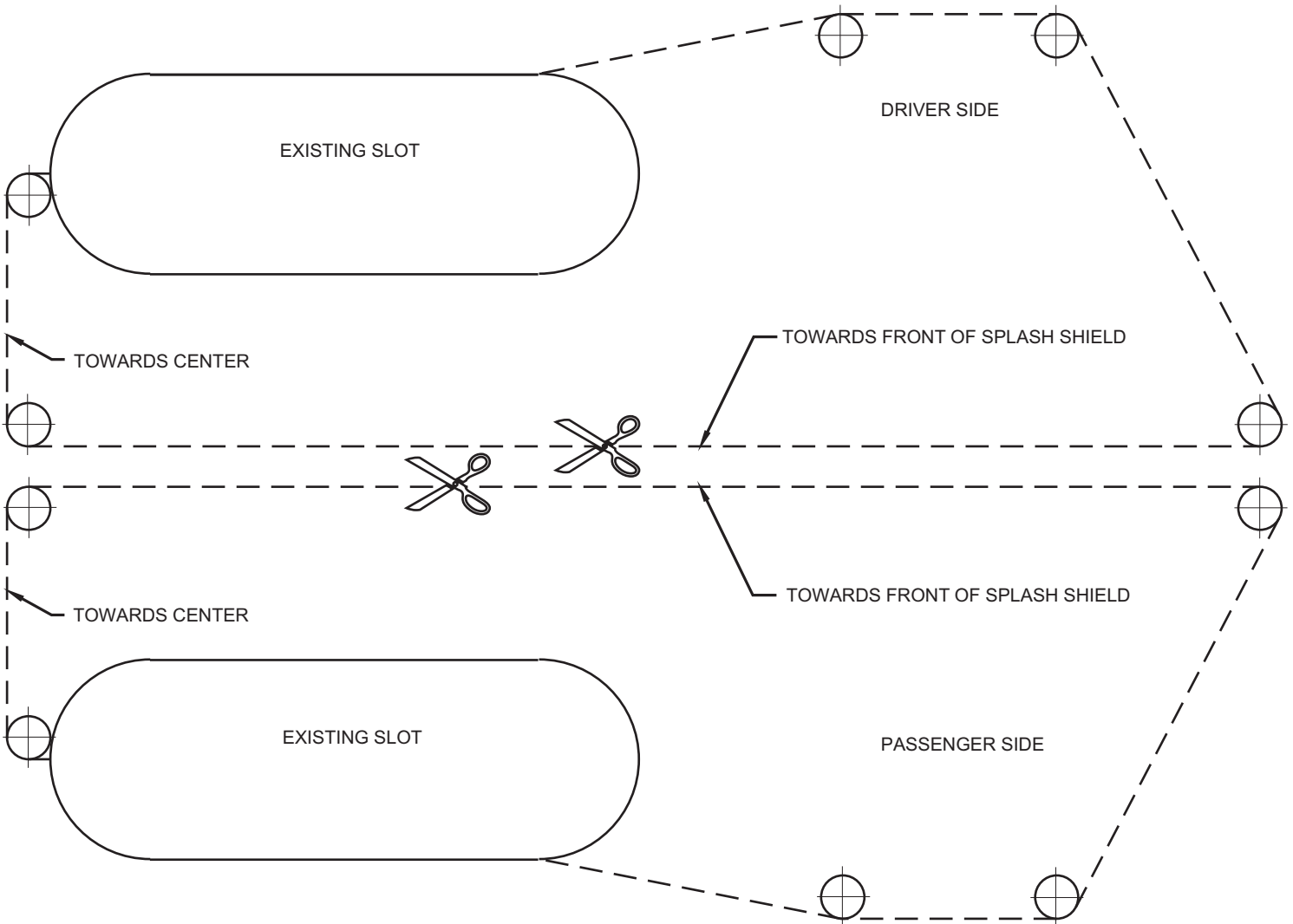

FIGURE 1 INSTALLATION VIEW OF PASSENGER SIDE, DRIVER SIDE OPPOSITE



Thank You for choosing Westin products.