



INSTRUCTIONS

APPLICATION: 2002-06 HONDA CRV

AUTOMOTIVE PRODUCTS, INC.

<p>SAFARI BAR ASSEMBLY</p> <p>30-0020 30-0025</p> <p>MOUNT KIT</p> <p>30-1235</p>	<p>①</p>	<p>④</p>	<p>⑤</p>	<p>②</p>	<p>③</p>
---	----------	----------	----------	----------	----------

ITEM	QTY	CONTENTS	TOOLS
1	1	SAFARI BAR ASSEMBLY (PURCHASED SEPARATELY)	3/4" SOCKET 3/4" WRENCH 1/2" SOCKET 1/2" WRENCH 10MM SOCKET 17MM SOCKET RATCHET SMALL FLAT SCREWDRIVER TORQUE WRENCH UTILITY KNIFE
2,3	2	BRACKET, PASSENGER (2) AND DRIVER (3)	
4,5	2	SUPPORT BRACE, PASSENGER (4) AND DRIVER (5)	
6	2	1/2-13 X 2.00" HEX HEAD BOLT	
7	4	1/2-13 X 1.00" HEX HEAD BOLT	
8	6	1/2" FLAT WASHER	
9	6	1/2" LOCK WASHER	
10	4	1/2" EXTERNAL-INTERNAL TOOTH LOCK WASHER	
11	4	1/2-13 HEX NUT	
12	2	5/16-18 X 1.75" HEX HEAD BOLT	
13	2	5/16" FLAT WASHER	
14	2	5/16" LOCK WASHER	
15	2	5/16" FLANGE LOCK NUT	
16	2	14MM FLAT WASHER	
17	2	14MM LOCK WASHER	
18	2	10MM PUSH TYPE RETAINER	

- STEP 1. Remove the contents from box and check for damage. Verify all parts are present. Read instructions completely before beginning.
- STEP 2. Determine passenger and driver brackets.
- STEP 3. Remove (16) push type retainers and (2) 6mm bolts from lower splash shield. Remove plastic splash shield to gain access to mounting locations.
- STEP 4. Locate (4) 14mm holes in lower radiator support. Attach brackets using 1/2" and 5/16" fasteners as shown. Leave loose.
CAUTION: Wheels must be supported to support sub-frame to the unibody to avoid misalignment for re-attachment.
- STEP 5. Remove the 14mm under carriage bolt and attach brace using existing 14mm bolt and supplied 14mm lock washer and flat washer per side. Repeat for opposite side. **SEE FIGURE 1.**
- STEP 6. Temporarily attach Safari Bar using 1/2" fasteners. Center and level. Hand tighten. Torque bracket bolts only. Hand tighten 14mm brace and remove Safari Bar.
- STEP 7. Cut plastic splash shield to accommodate brackets and attachment of Safari Bar. See cutting instructions for guidelines on cutting.
- STEP 8. Re-install the splash shield using 6mm bolts and all push type retainers.
- STEP 9. Re-attach Safari Bar using 1/2" fasteners previously removed. Make sure Safari Bar and brackets are properly aligned and tighten fasteners. Recommended torque values are 88 Ft.Lbs. for 14mm fasteners, 64 Ft.Lbs. for 1/2" fasteners, and 16 Ft.Lbs. for 5/16" fasteners. **NOTE:** 14mm fastener can be tightened through existing hole in splash shield.

CUTTING INSTRUCTIONS - (Recommendation only, sizes are approximate)

The template works best if placed on the bottom side of the splash shield (the side away from the vehicle). Locate two oval slots that measure 3/8" x 11/16". Cut out templates and slot reference (leave slot reference attached to cut template) and place over the appropriate slots. Hold in place using masking tape. Position splash shield in place and verify templates are in correct location. Move if necessary. Drill 1/4" holes at the corners. Cut the splash shield from drilled hole to drilled hole. It may be necessary to use a straight edge to ensure a straight cut. Additional trimming may be required when splash shield is reinstalled.

FINISH PROTECTION

Westin products have a high quality finish that must be cared for like any other exposed finish on the vehicle. Protect the finish with a non-abrasive automotive wax, (e.g. Pure Carnauba) on a regular basis. The use of any soap, polish or wax that contains an abrasive is detrimental, as the compounds scratch the finish and open it to corrosion.

THIS SIDE OF TEMPLATE IS FOR PASSENGER SIDE
FLIP TEMPLATE OVER TO MARK DRIVER SIDE

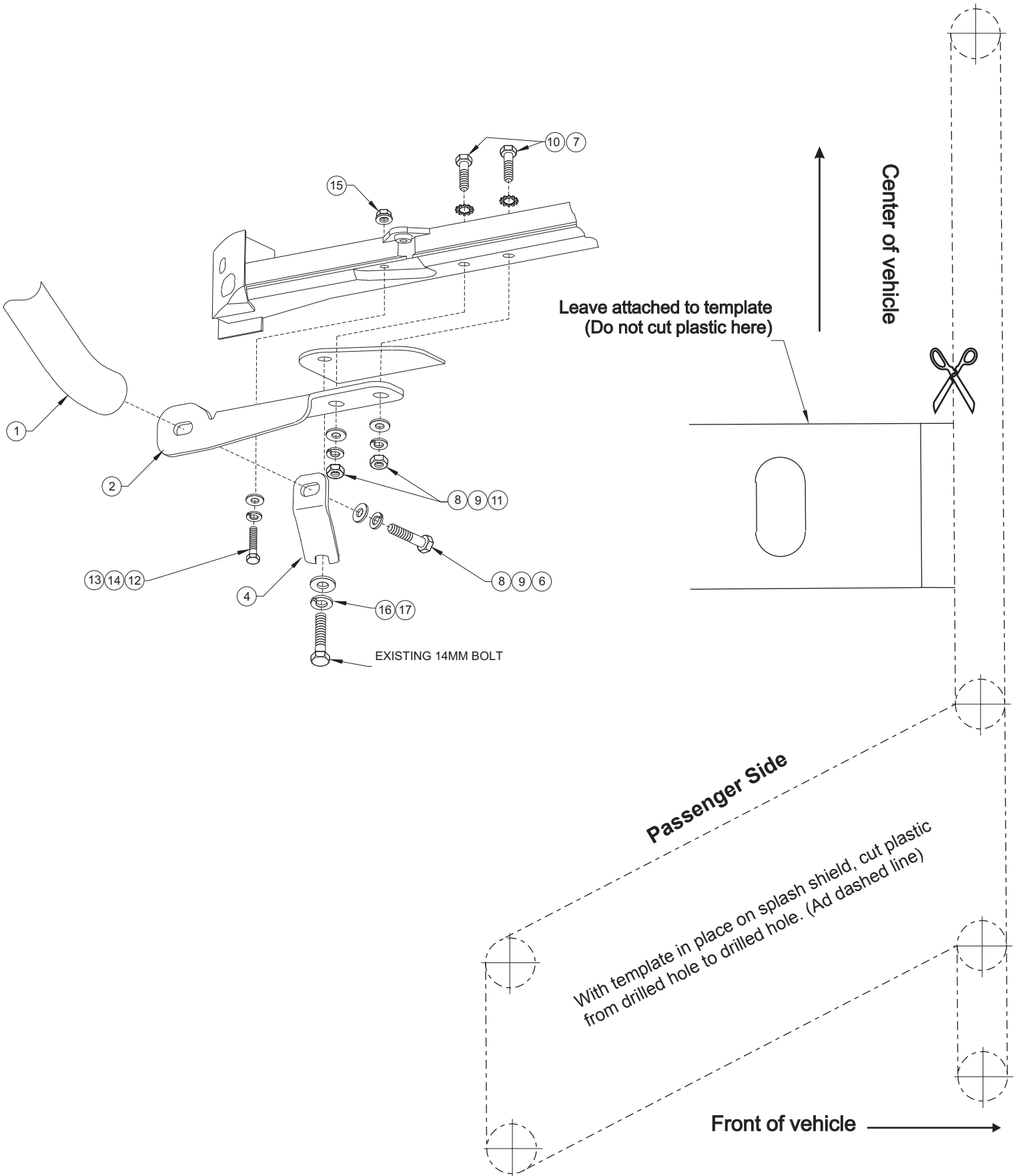

Thank You for choosing Westin products.

Shop for quality Westin products on our website.

Buy grille guards and bull bars in our online store.