



SIGNATURE OF QUALITY

AUTOMOTIVE PRODUCTS, INC.

INSTRUCTIONS

APPLICATION: 2001-08 FORD RANGER/RANGER "EDGE"
2001-08 MAZDA B-SERIES

SAFARI BAR ASSEMBLY

30-0020 30-0025

MOUNT KIT

30-1165

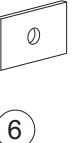
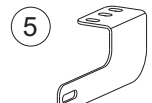
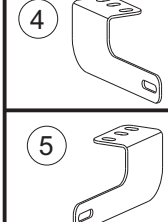
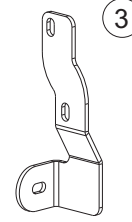
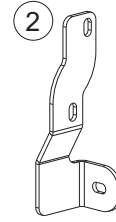
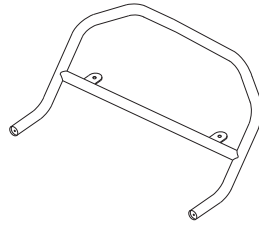

ITEM	QTY	CONTENTS	TOOLS
1	1	SAFARI BAR ASSEMBLY (PURCHASED SEPARATELY)	3/4" SOCKET 3/4" WRENCH 9/16" SOCKET 9/16" WRENCH 1/2" SOCKET 10MM SOCKET RATCHET RATCHET EXTENSION TORQUE WRENCH
2,3	2	BRACKET, PASSENGER (2) AND DRIVER (3)	
4,5	2	SUPPORT BRACE, PASSENGER (4) AND DRIVER (5)	
6	2	BACKING PLATE	
7	2	1/2-13 X 4.00" HEX HEAD BOLT	
8	2	1/2-13 X 2.00" HEX HEAD BOLT	
9	6	1/2" FLAT WASHER	
10	4	1/2" LOCK WASHER	
11	2	1/2-13 HEX NUT	
12	2	3/8-16 X 1.50" HEX HEAD BOLT	
13	4	3/8" FLAT WASHER	
14	2	3/8" LOCK WASHER	
15	2	3/8-16 HEX NUT	
16	4	5/16-18 X 1.00" SELF TAPPING SCREW	

- STEP 1. Remove the contents from box and check for damage. Verify all parts are present. Read instructions completely before beginning.
- STEP 2. Attach brackets to outside face of frame members with 1/2" fasteners and backing plate as shown. Leave loose. **SEE FIGURES 1 AND 2.**
- STEP 4. Attach support brace using holes in bottom face of vehicle frame. **SEE FIGURE 1. NOTE:** If vehicle has a plastic shroud mounted to bottom of frame, remove bolts with 10mm socket and remove "push type" fasteners from shroud. Place support brace against bottom of frame, reinstall plastic shroud with factory bolts and replace "push type" fasteners with 5/16" self tapping screw. Leave loose.
- STEP 5. Attach support bracket to mount bracket using 3/8" fasteners. **SEE FIGURE 1.**
- STEP 6. Attach safari bar using 1/2" fasteners. **SEE FIGURE 1-3.**
- STEP 7. Level and adjust Safari Bar as desired and tighten all fasteners. Recommended torque values are 64 Ft. Lbs. for 1/2" fasteners, 26 Ft. Lbs. for 3/8" fasteners, 10 Ft. Lbs. for 6mm fasteners, and 15 Ft. Lbs. for 5/16" fasteners.

FINISH PROTECTION

Westin products have a high quality finish that must be cared for like any other exposed finish on the vehicle. Protect the finish with a non-abrasive automotive wax, (e.g. Pure Carnauba) on a regular basis. The use of any soap, polish or wax that contains an abrasive is detrimental, as the compounds scratch the finish and open it to corrosion.

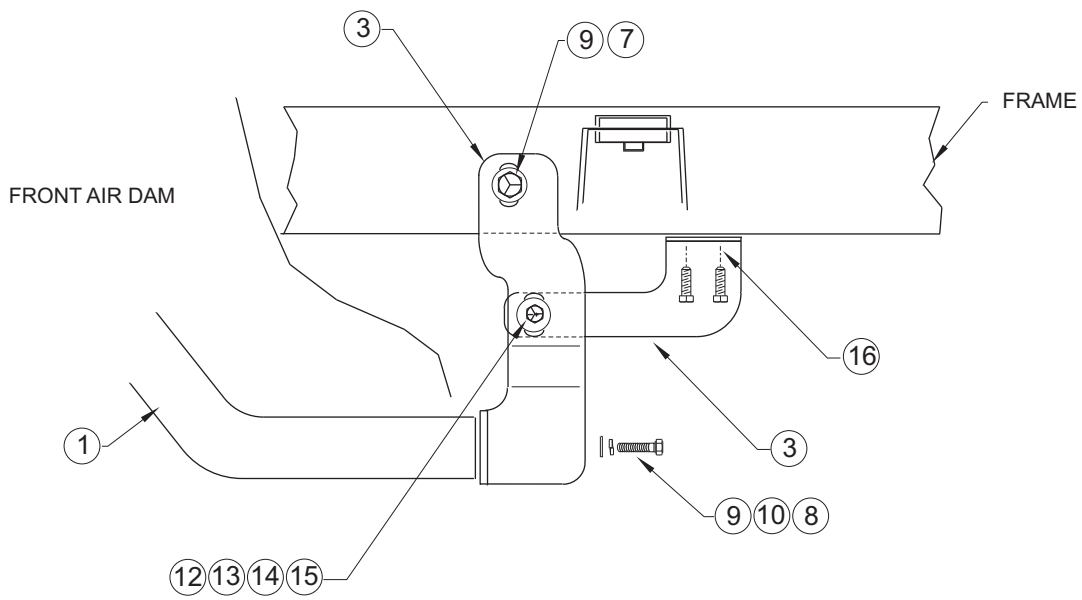

FIGURE 1 INSTALLATION VIEW OF DRIVER SIDE SHOWN

FIGURE 2 INSTALLATION VIEW OF DRIVER SIDE SHOWN

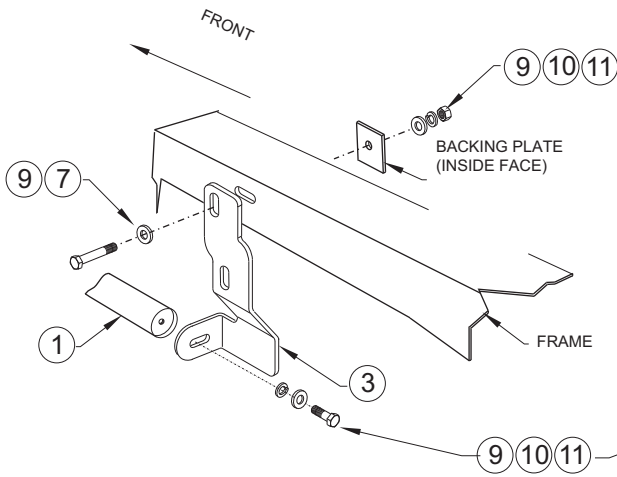
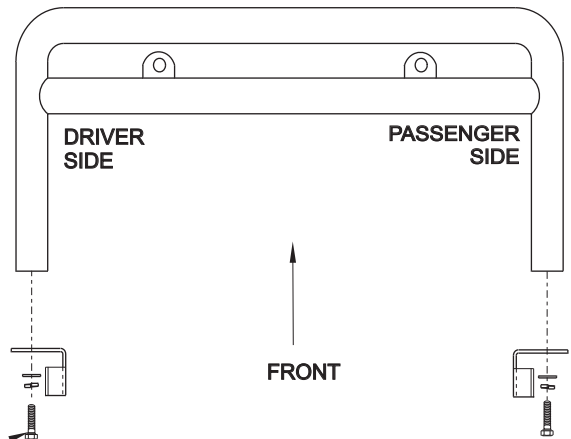

FIGURE 3 TOP VIEW



Thank You for choosing Westin products.