



SIGNATURE OF QUALITY

INSTRUCTIONS

APPLICATION: 2001-07 FORD ESCAPE/MAZDA TRIBUTE/MERCURY MARINER

AUTOMOTIVE PRODUCTS, INC.

SAFARI BAR ASSEMBLY

30-0020 30-0025

MOUNT KIT

30-1155

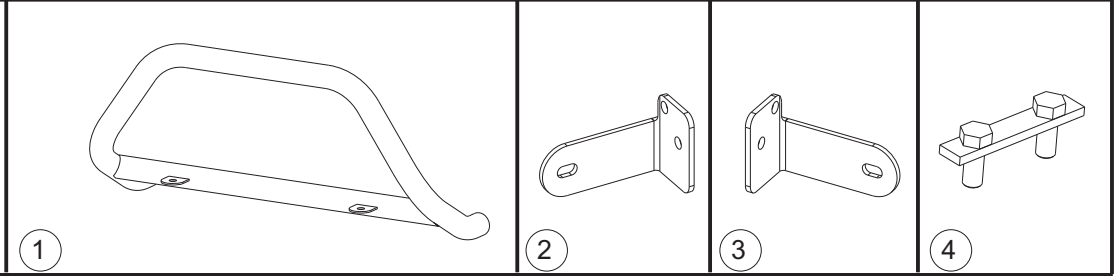

ITEM	QTY	CONTENTS	TOOLS
1	1	SAFARI BAR ASSEMBLY (PURCHASED SEPARATELY)	3/4" SOCKET 3/4" WRENCH 10MM SOCKET RATCHET TORQUE WRENCH UTILITY KNIFE
2,3	2	BRACKET, PASSENGER (2) AND DRIVER (3)	
4	2	BOLT PLATE	
5	2	1/2-13 X 2.00" HEX HEAD BOLT	
6	6	1/2" FLAT WASHER	
7	6	1/2" LOCK WASHER	
8	4	1/2-13 HEX NUT	

- STEP 1. Remove the contents from box and check for damage. Verify all parts are present. Read instructions completely before beginning.
- Ford Escape and Mazda Tribute**
- STEP 2. Remove one 6MM bolt from each side of lower airdam located outside of each tie down loop.
- Mercury Mariner**
- STEP 2. Trim each side of the lower airdam level with the bottom of bumper to a distance of 6 1/8" in from the inside face of the tie down loops.
- STEP 3. Attach brackets to tie down loops using bolt plates and 1/2" fasteners as shown. Hand tighten. **SEE FIGURE 2. NOTE:** Brackets attach to inside face of tie down loop.
- STEP 4. Attach Safari Bar to brackets using 1/2" fasteners as shown. Hand tighten. **SEE FIGURE 1.**
- STEP 5. Make sure Safari Bar and brackets are properly aligned and tighten fasteners. Recommended torque values are 64 Ft. Lbs. for 1/2" fasteners.
- STEP 6. Reinstall 6MM bolts and torque to 6 Ft. Lbs.

FINISH PROTECTION

Westin products have a high quality finish that must be cared for like any other exposed finish on the vehicle. Protect the finish with a non-abrasive automotive wax, (e.g. Pure Carnauba) on a regular basis. The use of any soap, polish or wax that contains an abrasive is detrimental, as the compounds scratch the finish and open it to corrosion.

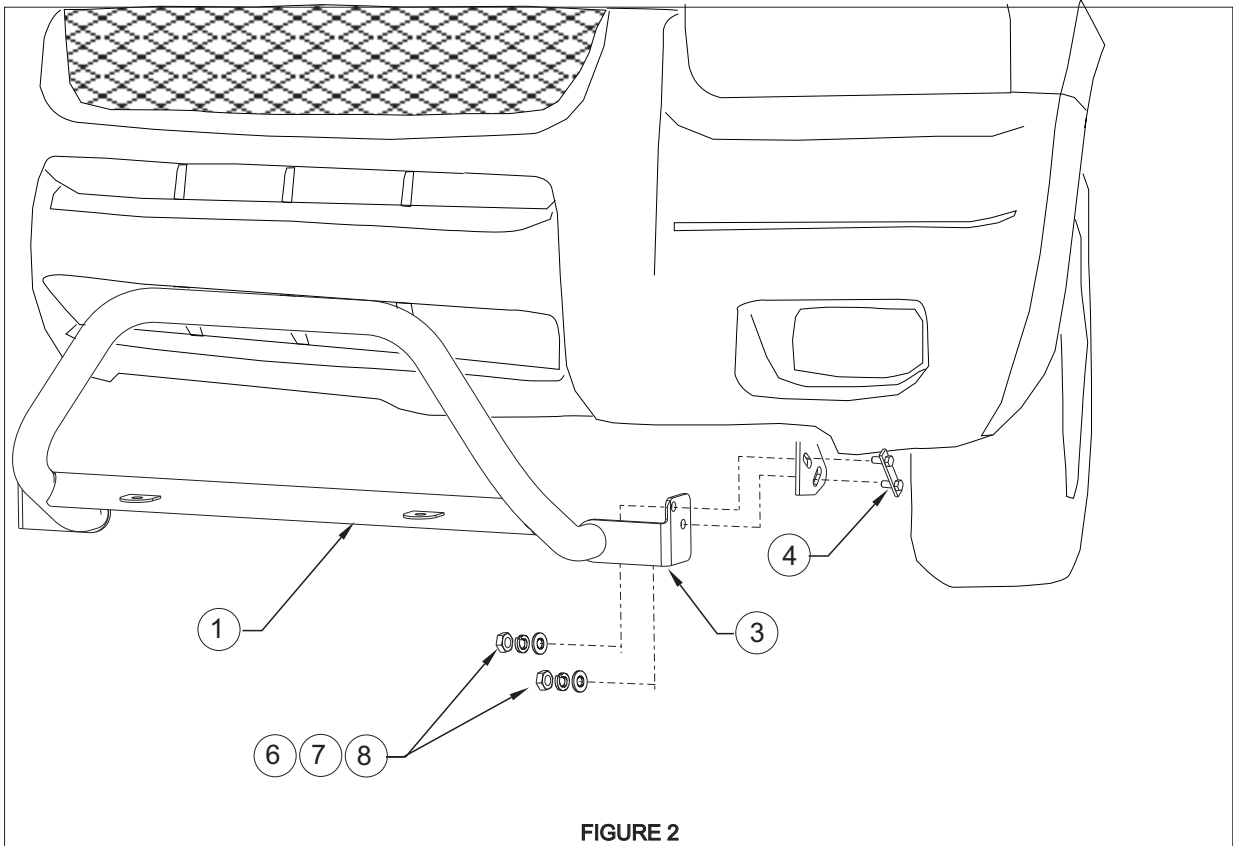
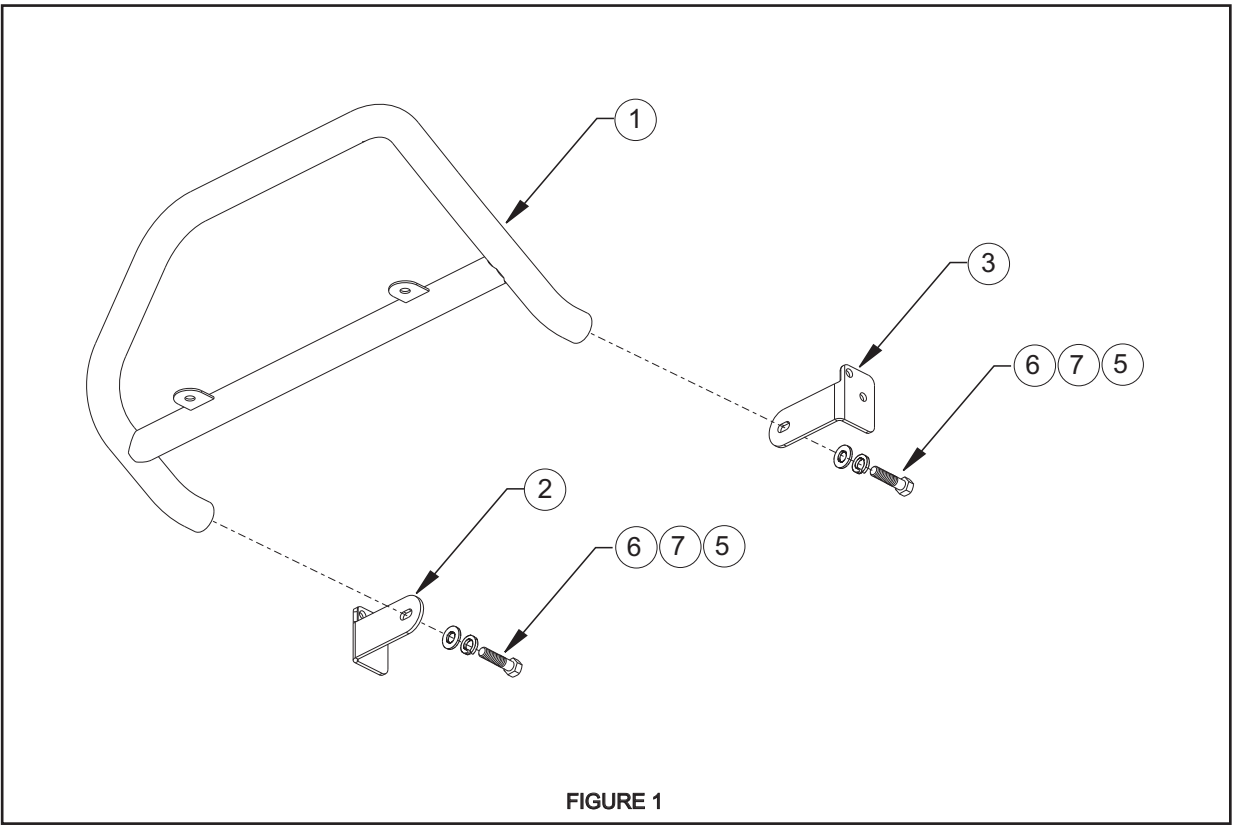

Westin.
SIGNATURE OF QUALITY

AUTOMOTIVE PRODUCTS, INC.

Shop for quality Westin products on our website.

Thank You for choosing Westin products.

Buy grille guards and bull bars in our online store.