

INSTALLATION INSTRUCTIONS

R5 STEP BOARD

WESTiN®

APPLICATION:

2022 Toyota Tundra Double Cab & Crew Max

PART NUMBER:

28-51330, 28-51335, 28-51340, 28-51345

| ITEM | QUANTITY | DESCRIPTION | TOOLS NEEDED |
|------|----------|--|---------------|
| 1,2 | 2 | STEP BOARDS, DRIVER (1) AND PASSENGER (2) | 10MM SOCKET |
| 3 | 1 | DRIVER FRONT BRACKET | 10MM WRENCH |
| 4 | 1 | PASSENGER FRONT BRACKET | 13MM SOCKET |
| 5 | 2 | DRIVER CENTER/REAR MOUNTING BRACKET | 13MM WRENCH |
| 6 | 2 | PASSENGER CENTER/REAR MOUNTING BRACKET | RATCHET |
| 7 | 6 | BRACKET COVER | TORQUE WRENCH |
| 8 | 6 | PLATE ADAPTOR (28-51330/28-51340) | |
| 9 | 12 | M8 HEX NUT (BLACK ZINC FOR 28-51330,28-51340;YELLOW ZINC FOR 28-51335, 28-51345) | |
| 10 | 12 | M8 SLPIT LOCK WASHER (BLACK ZINC FOR 28-51330,28-51340;YELLOW ZINC FOR 28-51335, 28-51345) | |
| 11 | 12 | M8 FLAT WASHER (BLACK ZINC FOR 28-51330,28-51340;YELLOW ZINC FOR 28-51335, 28-51345) | |
| 12 | 12 | M8 HEX HEAD BOLT (SEMS HARDWARE) | |
| 13 | 12 | M8 SPLIT LOCK WASHER (SEMS HARDWARE) | |
| 14 | 12 | M8 FLAT WASHER (SEMS HARDWARE) | |
| 15 | 12 | M6 HEX HEAD BOLT (YELLOW ZINC) | |
| 16 | 24 | M6 FLAT WASHER (YELLOW ZINC) | |
| 17 | 12 | M6 NYLOCK NUT (YELLOW ZINC) | |

ANTI-SEIZE LUBRICANT MUST BE USED ON ALL STAINLESS STEEL FASTENERS TO PREVENT THREAD DAMAGE AND GALLING

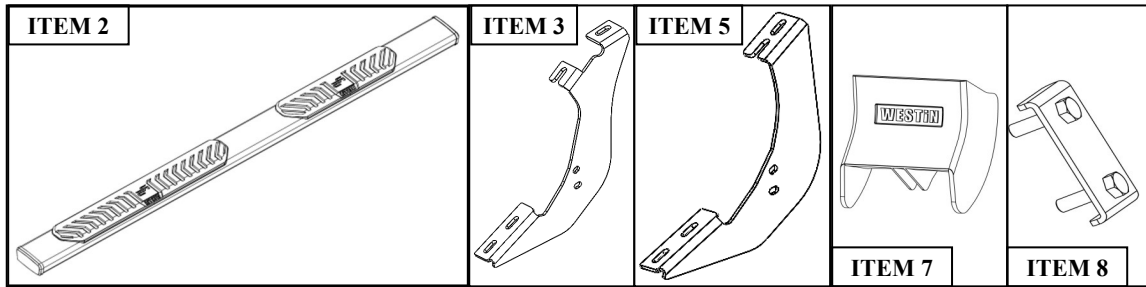

PROCEDURE

1. Remove contents from box, verify if all parts listed are present and free from damage. Carefully read and understand all instructions before attempting installation.
Failure to identify damage before installation could lead to a rejection of any claim.
2. Start installation on either side of the vehicle. Locate mounting locations with factory threaded holes with bolts installed in them. Remove factory bolts from threaded holes, factory bolts will not be used again. See **Figures 1 & 2**.
3. Locate (1) front mounting bracket (Item 3/4) and loosely install it to the front mounting location on the rocker panel using M8 SEMS hardware (Items 12-14). Locate either a driver or passenger center/rear mounting bracket (Items 5/6) and loosely secure on the rocker panel in their correct mounting location. Loosely install using the provided M8 SEMS hardware.

WESTiN

Driver side front rocker panel.

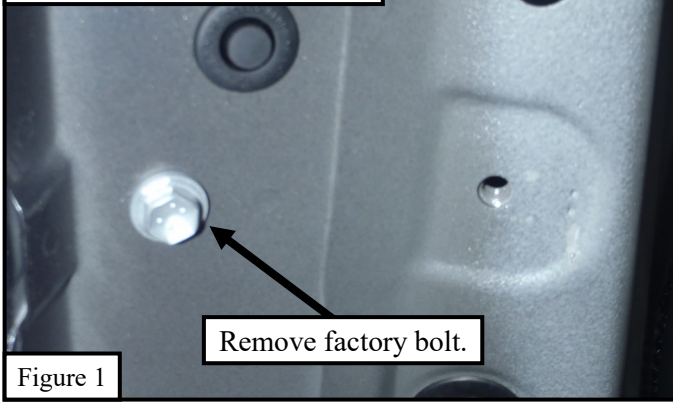

Center bracket rocker panel factory bolts.

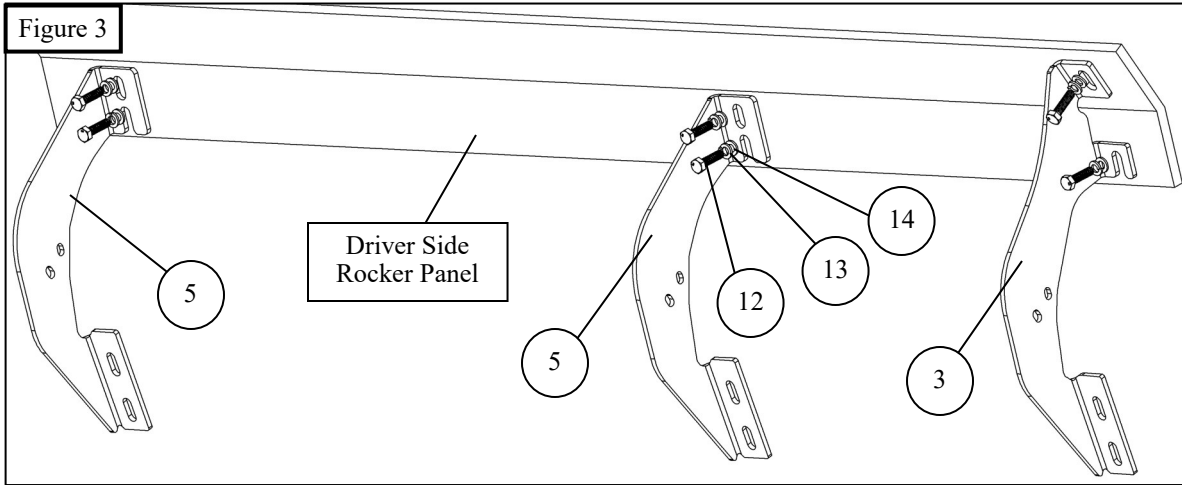

4. Repeat **Step 3** for other vehicle side.
5. Locate (1) plastic bracket cover (Item 7) and loosely secure it to the (6) brackets using the provided hardware: (2) M6 hex head cap screws, (4) M6 flat washers, and (2) M6 nylock nuts. Repeat for every bracket. See **Figure 4**.
6. **For Part Numbers 28-51335 and 28-51345:** Locate (1) driver side step board (Item 1) and (6) M8 square head bolts (Item 6). Slide the M8 square head bolts through the slots underneath the step board and align with the previously installed mount brackets. Repeat for passenger side. See **Figure 5**.
7. **For Part Numbers 28-51330 and 28-51340:** Locate (1) driver side step board (Item 1) and (3) adapter plates (Item 8). Insert the adapter plates onto the step board and align with the previously installed mount brackets. Repeat for passenger side. See **Figure 6**.

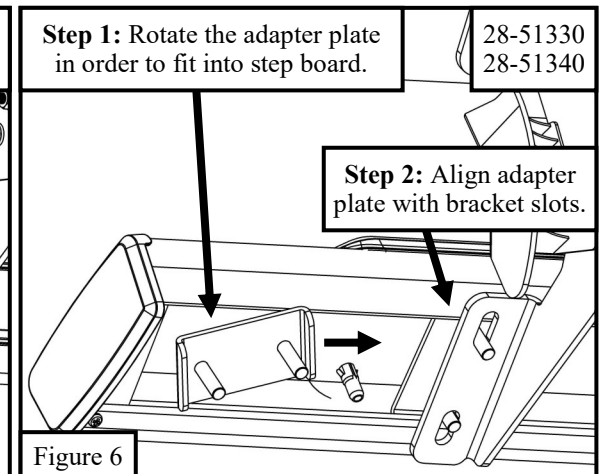
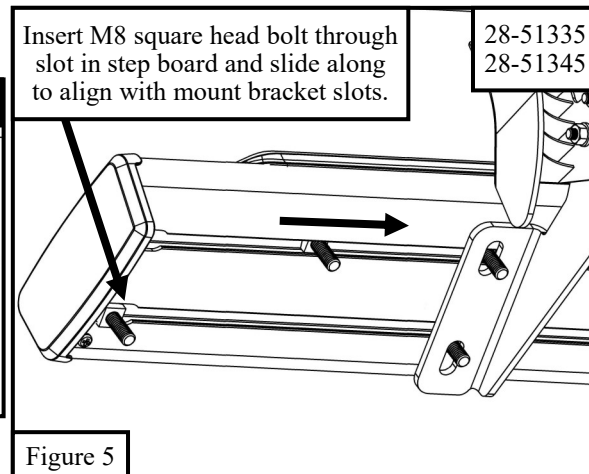
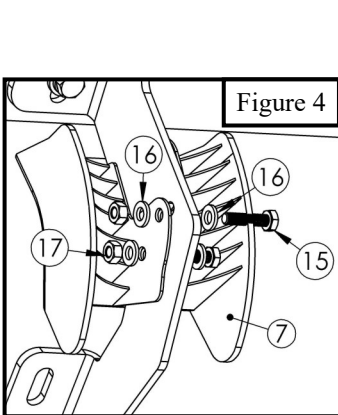

8. Loosely secure the step board onto each mount bracket using (2) M8 hex nuts, (2) M8 split lock washers, and (2) M8 flat washers (Items 12-14). See **Figure 7**.
9. Adjust and align as necessary the mount brackets, step boards, and bracket covers and then tighten M8 hardware to 15-17 ft-lbs and M6 to 5-7 ft-lbs.

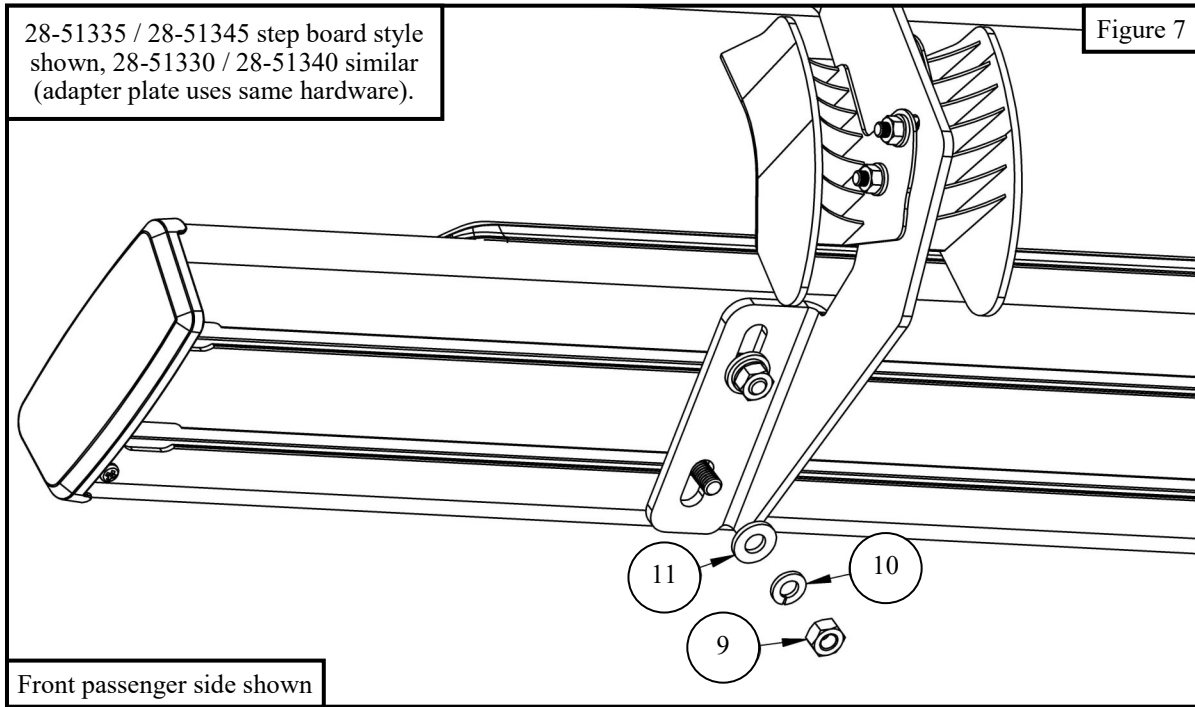

INSTALLATION COMPLETE



CARE INSTRUCTIONS

- REGULAR WAXING IS RECOMMENDED. DO NOT USE ANY TYPE OF POLISH OR WAX THAT MAY CONTAIN ABRASIVES.
- STAINLESS STEEL PRODUCTS CAN BE CLEANED WITH MILD SOAP AND WATER. STAINLESS STEEL POLISH SHOULD BE USED TO POLISH SMALL SCRATCHES.
- GLOSS BLACK FINISHES SHOULD BE CLEANED WITH MILD SOAP AND WATER.

