

INSTALLATION INSTRUCTIONS

STEP BOARD MOUNT KIT



APPLICATION:
2018-2019 Chevrolet Traverse (Excl. 2018 Limited)
PART NUMBER:
27-2275

CONTENT			
ITEM	QUANTITY	DESCRIPTION	TOOLS NEEDED
1	1	DRIVER FRONT MOUNTING BRACKET	13MM WRENCH
2	1	DRIVER CENTER MOUNTING BRACKET	13MM SOCKET
3	1	DRIVER REAR MOUNTING BRACKET	17MM WRENCH
4	1	PASSENGER FRONT MOUNTING BRACKET	17MM SOCKET
5	1	PASSENGER CENTER MOUNTING BRACKET	10MM SOCKET
6	1	PASSENGER REAR MOUNTING BRACKET	TORQUE WRENCH
7	2	M8 BOLT/NUT PLATE	
8	2	M10 BOLT/NUT PLATE	
9	4	M10 BOLT PLATE	
10	2	M10 HEX HEAD BOLT	
11	8	M10 SPLIT LOCK WASHER	
12	8	M10 FLAT WASHER	
13	6	M10 HEX NUT	
14	2	M8 HEX HEAD BOLT	
15	4	M8 SPLIT LOCK WASHER	
16	16	M8 FLAT WASHER	
17	2	M8 HEX NUT	
18	12	M8 SQUARE HEAD BOLT	
19	12	M8 NYLOCK NUT	
20	4	M6 SELF-TAPPING SCREWS	
21	2	M8 PLASTIC RETAINER SQUARES	
22	1	M10 FISH WIRE BOLT LEADER	

ANTI-SEIZE LUBRICANT MUST BE USED ON ALL STAINLESS STEEL FASTENERS TO PREVENT THREAD DAMAGE AND GALLING



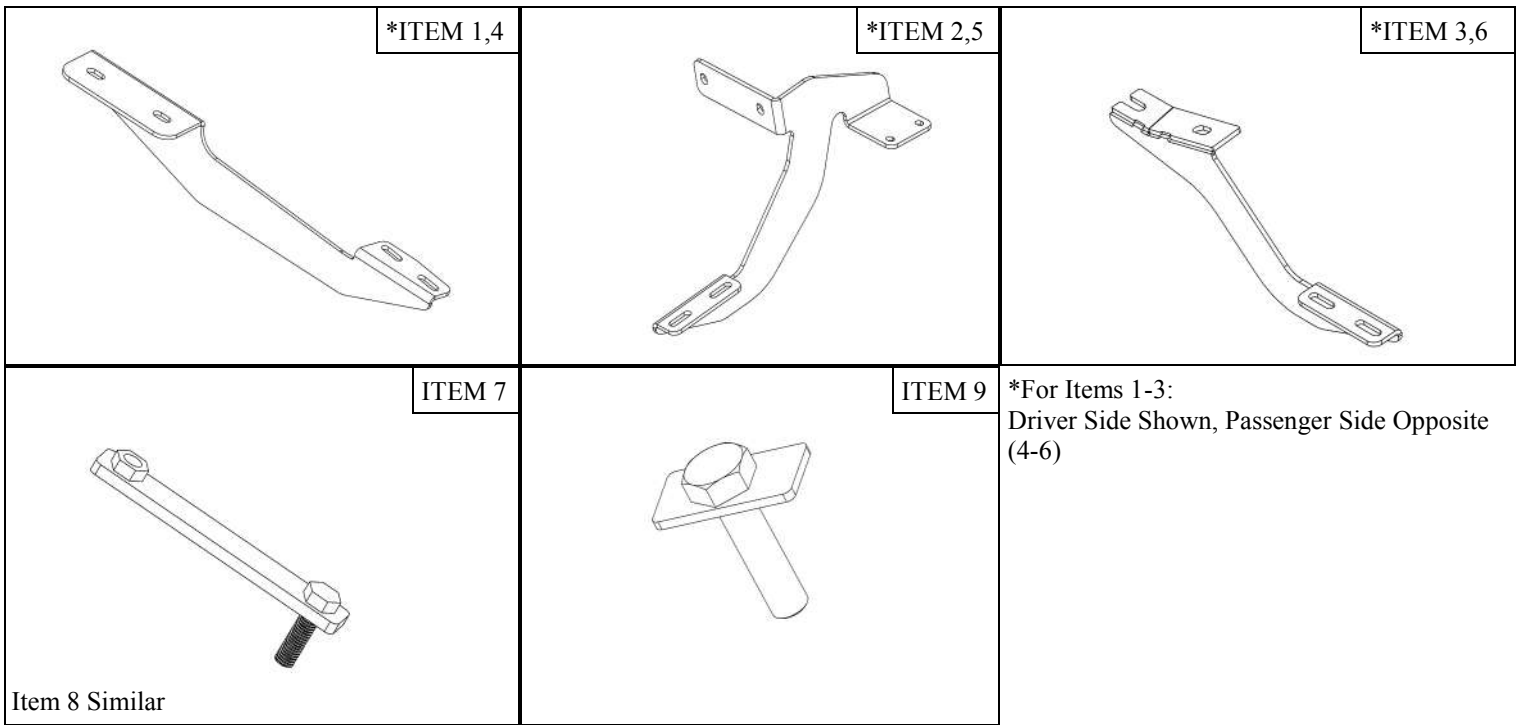

PROCEDURE

1. Remove contents from box, verify if all parts listed are present and free from damage. Carefully read and understand all instructions before attempting installation. **Failure to identify damage before installation could lead to a rejection of any claim.**
2. Starting at the front driver side of the vehicle, insert the M10 Bolt/Nut Plate (8) in to the factory hole. Using the supplied M10 hardware, loosely install the Front Driver Bracket (1) See **Figures 1-3.**

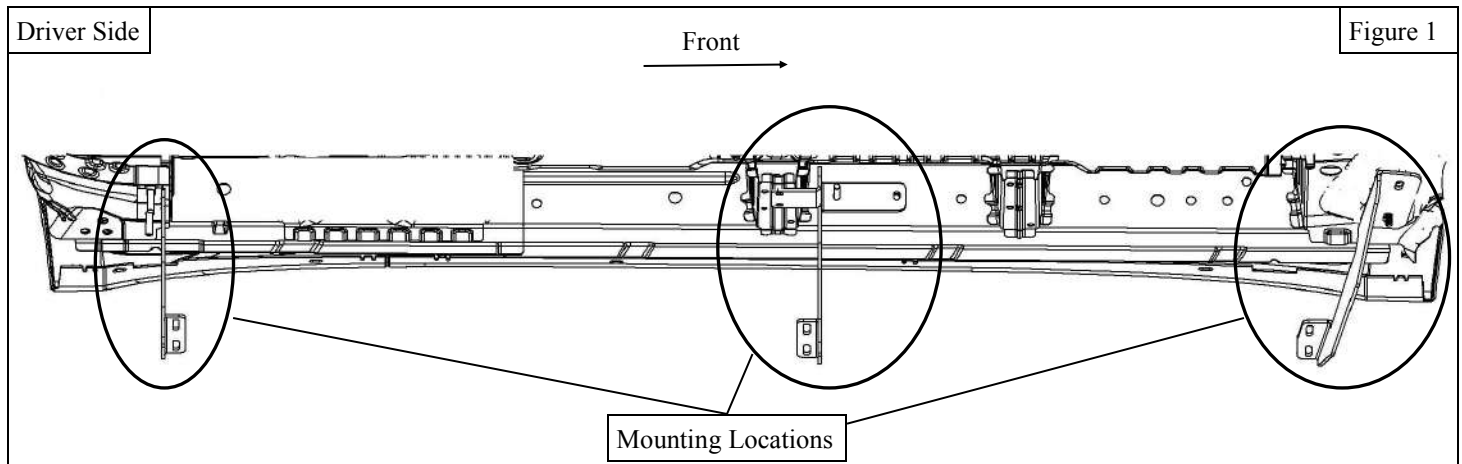

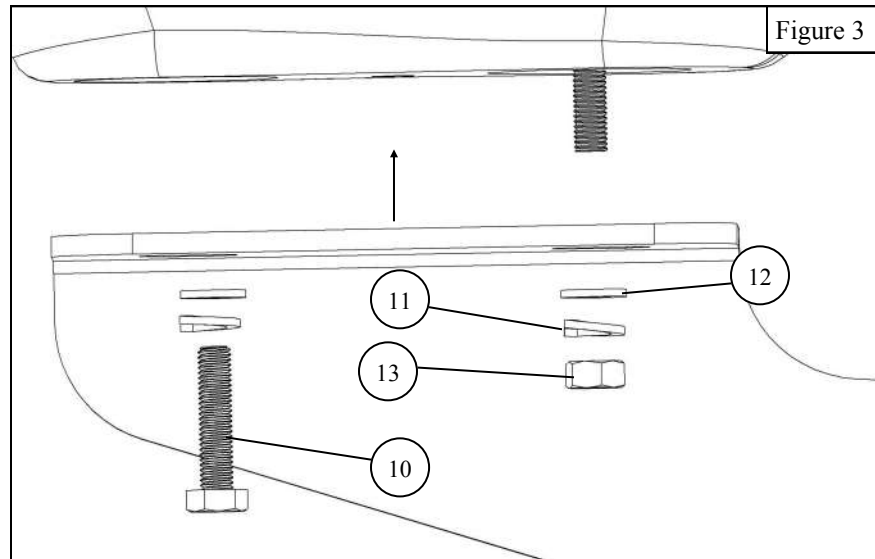
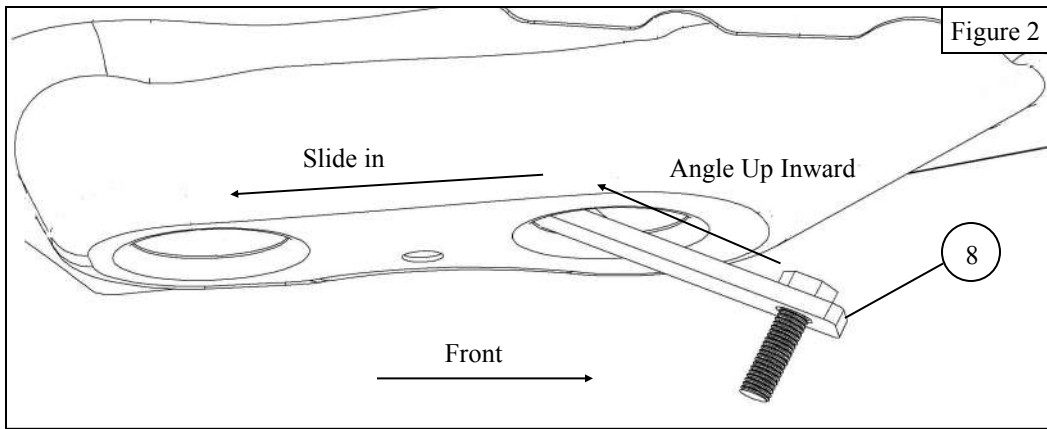

3. Move to the middle of the driver rocker panel. Slide the M8 Bolt/Nut Plate (7) into the factory hole carefully. Use a M8 Plastic Retainer Square (21) to hold the Plate by pushing it into the threads. Using the supplied M8 hardware, loosely assemble the Driver Center Bracket (2) onto the vehicle. See Figures 1 & 4. **Note:** Use the bolt in the M8 Bolt/Nut Plate to rotate the plate and position the nut. M6 Self-Tapping Screws will be used for this bracket in Step 8.

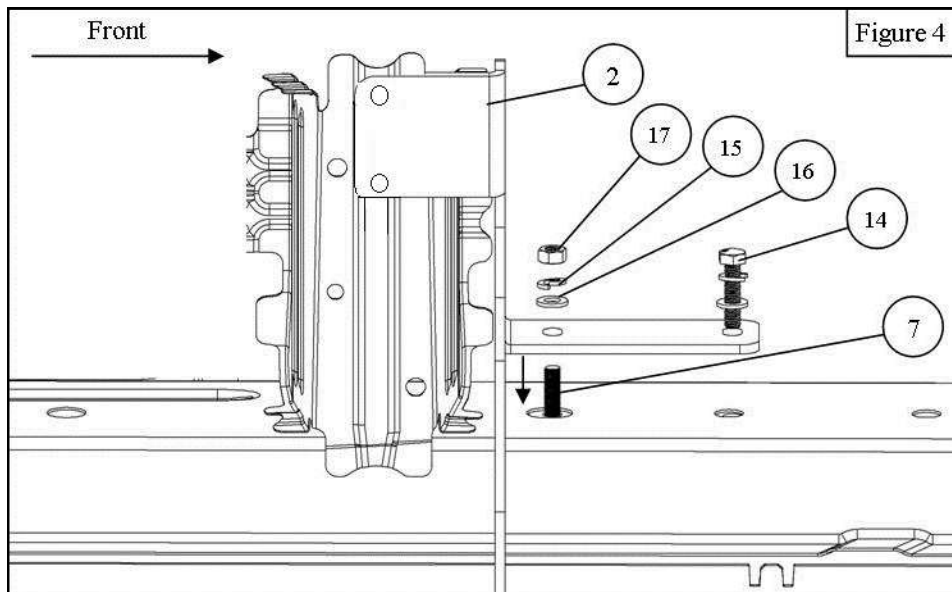

4. Move to the rear driver side of the vehicle. Take a M10 Bolt Plate (9) and thread it into the supplied M10 Fish Wire (22). Guide the M10 Bolt Plate (9) into one of the holes using the access hole as shown in **Figure 5**. Remove the Fish Wire. Repeat for the second hole. Install the Rear Driver Bracket (3) loosely using the supplied M10 Hardware. See **Figure 6**

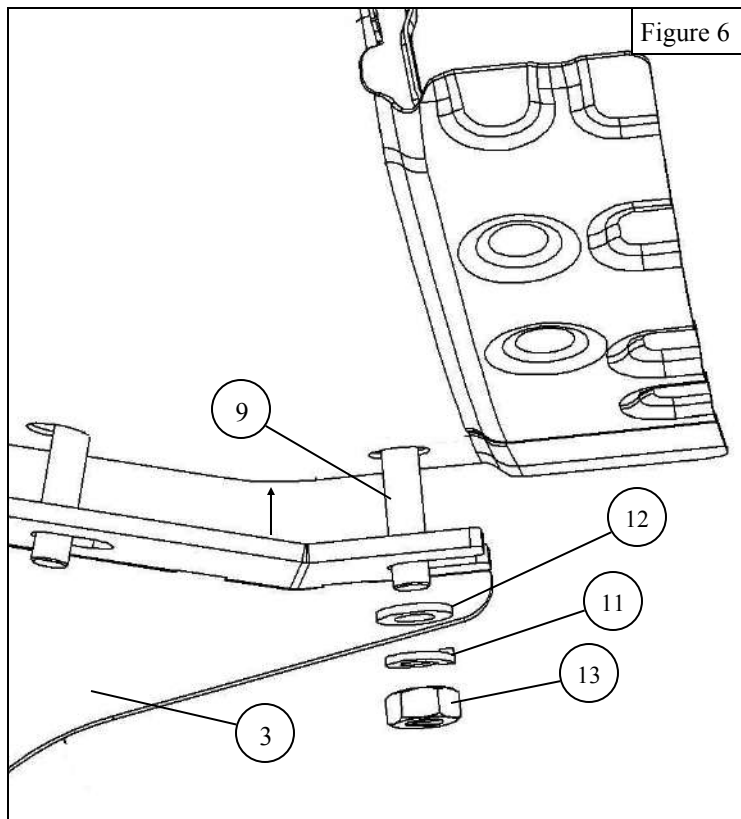
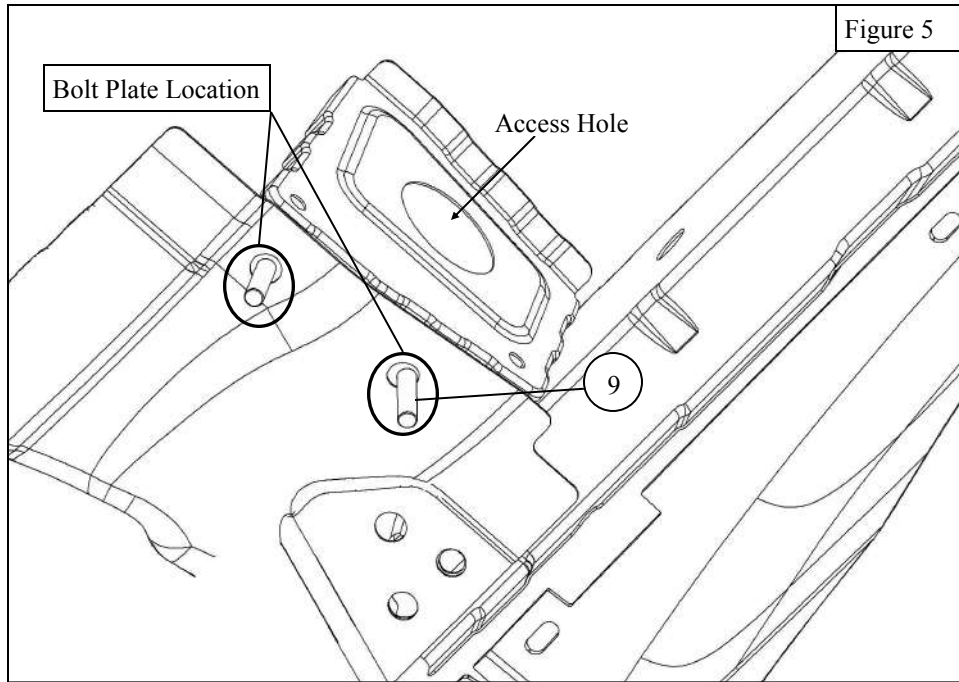

5. Repeat steps 2–4 on the passenger side of the vehicle.
6. Fasten running boards respectively to either side using the M8 hardware (items 16, 18, 19). **See Figure 7.**
Note 1: Running boards sold separately.
Note 2: For Grate Steps Running Boards, refer to the installation instructions included with the running boards.
7. Align and adjust the running boards and brackets as needed and fully tighten all hardware. Torque all M8 fasteners to 15-18 ft-lbs, and all M10 fasteners to 30-35 ft-lbs.

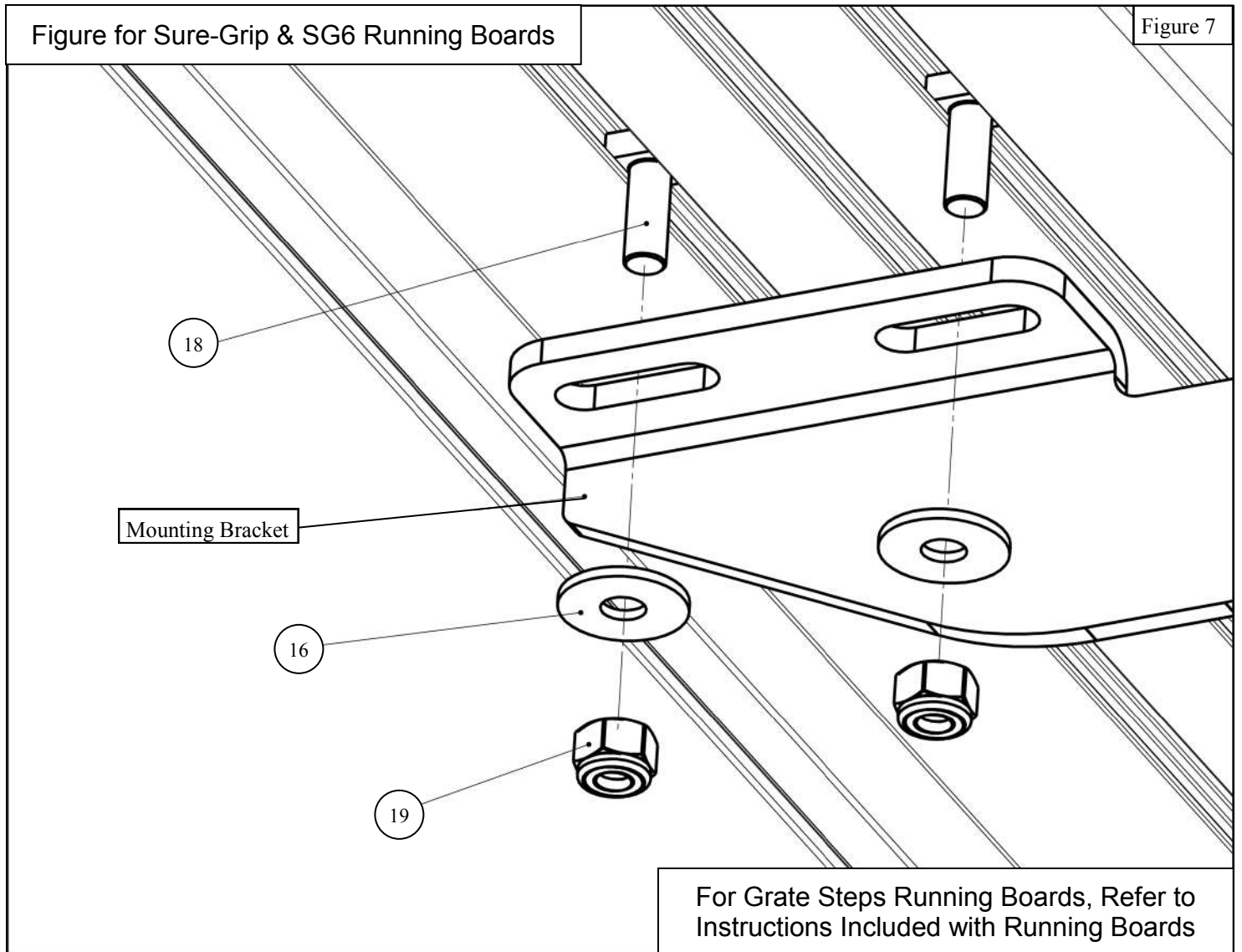

8. Move to the Center Driver Mounting Bracket (2). Screw the supplied M6 Self Tapping Screws (20) into the remaining holes. Repeat this on the passenger side. **See Figure 8.**

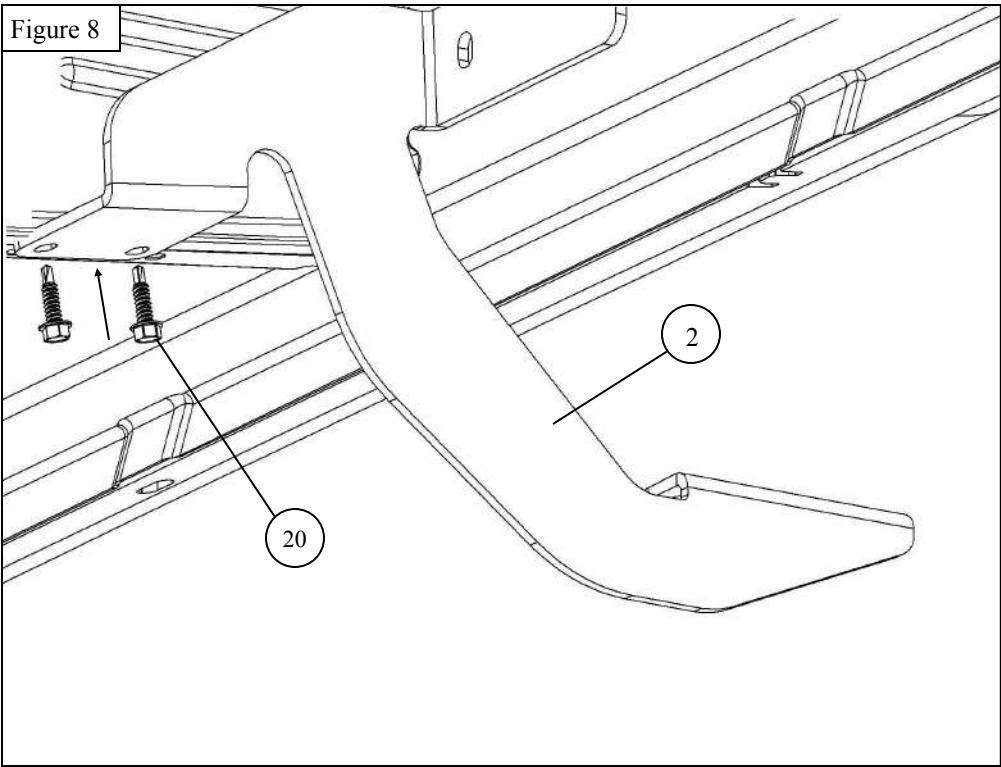

CARE INSTRUCTIONS

- REGULAR WAXING IS RECOMMENDED. DO NOT USE ANY TYPE OF POLISH OR WAX THAT MAY CONTAIN ABRASIVES.
- STAINLESS STEEL PRODUCTS CAN BE CLEANED WITH MILD SOAP AND WATER. STAINLESS STEEL POLISH SHOULD BE USED TO POLISH SMALL SCRATCHES.
- GLOSS BLACK FINISHES SHOULD BE CLEANED WITH MILD SOAP AND WATER



WARNING



Failure to follow these instructions could lead to death, personal injury, and / or property damage.

Failure to follow these instructions could lead to death, personal injury, and / or property damage.

FASTENERS:

All Westin supplied fasteners must be utilized and installed in accordance with the installation instructions and apply torque to the specifications as defined. **DOUBLE CHECK ALL FASTENERS BEFORE INITIAL USE, AND PERIODICALLY IN THE FUTURE TO ENSURE PROPER FUNCTION AND SAFETY.**

DRILLING:

Most Westin products do not require drilling for installation. If drilling is defined as required, use caution when drilling a vehicle. **FAILURE TO REVIEW AN AREA TO BE DRILLED MAY RESULT IN PERSONAL INJURY AND/OR INJURY TO OTHERS AS WELL AS VEHICLE DAMAGE.**

EYE PROTECTION:

ALWAYS WEAR SAFETY GLASSES OR GOGGLES DURING THE INSTALLATION PROCESS TO AVOID PERSONAL INJURY.

MAXIMUM TOWING/CARRYING CAPACITY: (if applicable)

The Westin Receiver Hitches will have a visible tow rating label affixed directly on the product. User should never exceed the vehicle manufacturers maximum tow and weight rating regardless of the capacity of the hitch. **FAILURE TO FOLLOW THESE GUIDELINES WILL VOID THE WESTIN WARRANTY AND MAY RESULT IN PERSONAL INJURY AND/OR INJURY TO OTHERS AS WELL AS VEHICLE DAMAGE.**

FOR CALIFORNIA RESIDENTS ONLY-PROP 65 WARNING:

Some products may contain chemicals such as DEHP, which can cause cancer, birth defects or other reproductive harm.

