

### 7-WAY Blade Wiring Adapter P/N 78007

**READ THIS FIRST:**  
Read and follow all instructions carefully before beginning installation.

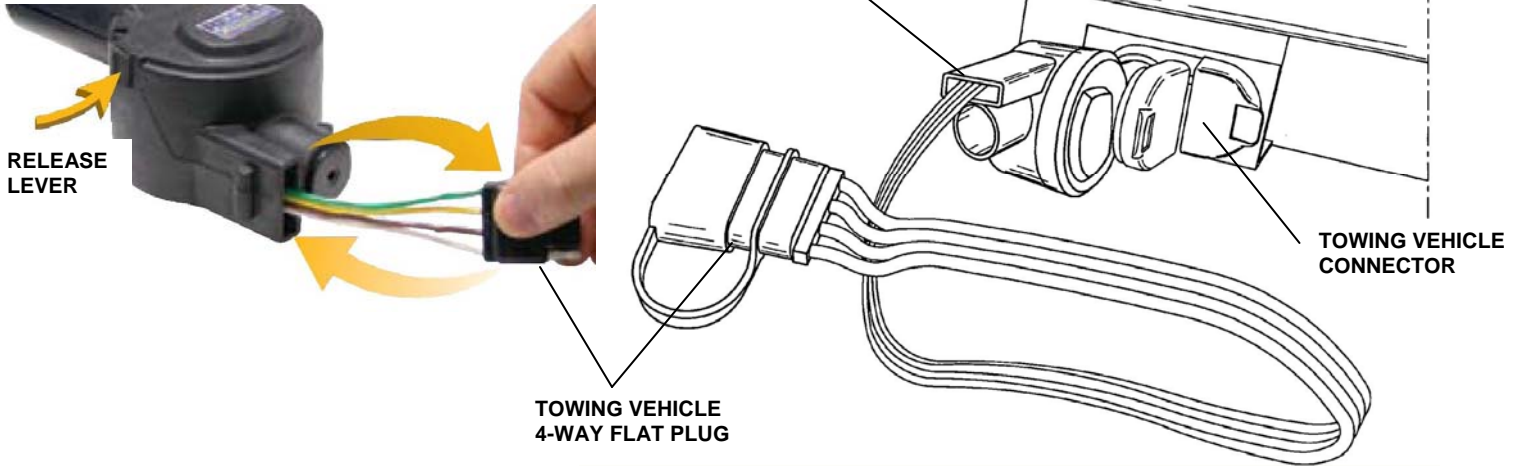

VEHICLE'S CONNECTOR	FUNCTIONS OF WIRING RETRACTABLE ADAPTER	TRAILER'S PLUG
7-Way Blade, RV Type	7-Way Blade To 4-way Flat	4-way Flat

Plug Retractable Adapter into tow vehicle side connector to allow electrical connections between 7-way Blade Receptacle with 4-way Flat Trailer Plug. Extend wires on desirable length ( up to 42") to engage with the trailer 4-way Flat Receptacle.



**WARNING**

When extended DO NOT let wires drag on the ground. When NOT in use, completely retract wires.

**NOTE:**

- Wiring Retractable Adapter may be equipped with the built-in LED circuit tester which helps to confirm that each connection is operating. For the same purpose can be used 4 Flat Dust Cover with LED lights (sold separately) or 4 Flat LED Tester (sold separately).
- To retract wires just push the "Release" lever in the direction as shown.



**WARNING**

All connections must be complete to function properly. Test and verify installation with a test light, circuit tester or trailer once installed.



**WARNING**

Overloading circuit can cause fires. **DO NOT** exceed lower of towing manufacturer rating or:

- Max. Right Turn, Left Turn, Stop, & Tail Light Circuits: (7.5 amps)
- Max. (+) Battery, Reverse, and Electric Brake Circuits: (30 amps)

Read vehicle's owners manual & instruction sheet for additional information. Additional fusing may be required.