

WeatherTech®

Ford F150 Side Window Deflector Instructions

Read all instructions before installing Side Window Deflectors. Incorrectly installed Side Window Deflectors may result in damage of the deflector and/or your vehicle. Installation of this accessory is recommended at temperatures above 50° Fahrenheit.

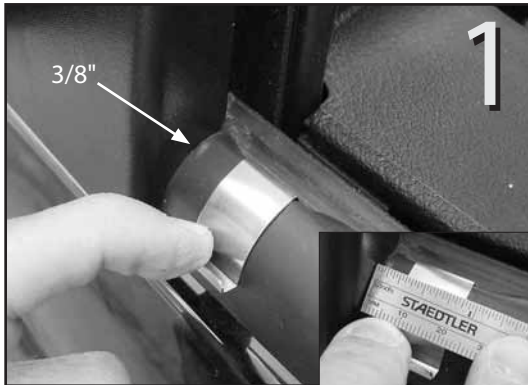

1 Open driver-side window. Hang a clip on the rubber belt molding in the outer molding and dew wiper as shown. Some folding of the outer molding is normal and necessary for proper fitment.



2 Place the bottom of the driver's side deflector into the clip and slide it forward until it seats firmly against the mirror bracket. Ensure that the deflector's front flange is inserted into the window channel.



3 Insert the deflector's rear flange into the window channel.



4 The rear edge of the deflector should be pulled down slightly (exaggerated in the photo). Pull the deflector down and tuck the flange into the window channel working from front to back.



5 Continue tucking the flange into the window channel until it is resting in the window channel along its entire length.



6 Gently pull outward to seat the deflector and ensure that none of the window rubber has been folded inward while inserting the flange.

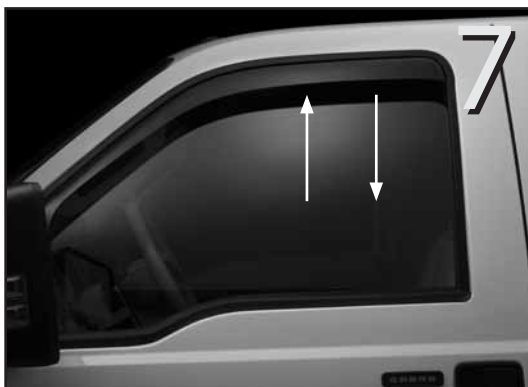

7 Slowly inch the window upward until the window is completely closed. Repeat this 5 times. It is a good idea to leave the window completely closed for several hours after installation to ensure perfect fit.