

WeatherTech®

Side Window Deflectors

Front with Channel Clips

Installation Instructions

Contents

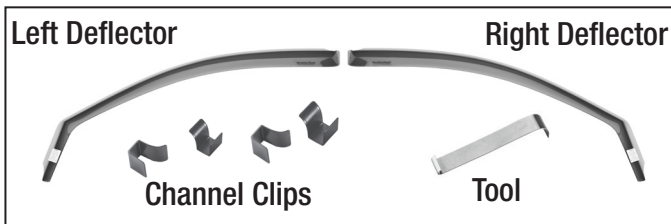

(2) Front Side Window Deflectors, (4) Channel Clips and (1) Tool included. If there is a WeatherTech® label, it should be positioned toward the rear of the vehicle.

⚠ WARNING ⚠

Accessories which are not properly fitted can be dangerous. Read the instructions carefully before installation, and comply with the instructions at all times. If in doubt, contact WeatherTech®.

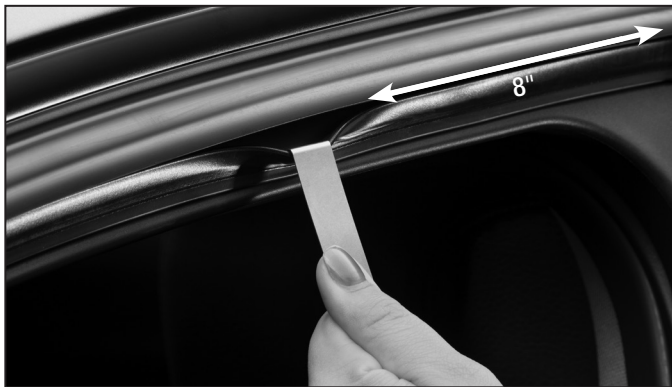

1 Make sure that the window is clean and dry. Then pull down the weather stripping in the first position, which is approximately 8" from the rear of the deflector.



2 Use the same tool to insert a channel clip.

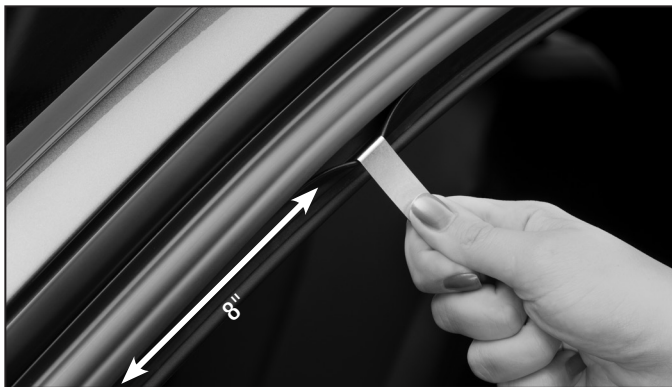

3 Pull down the weather stripping in the second position, which is approximately 8" from the front mirror.

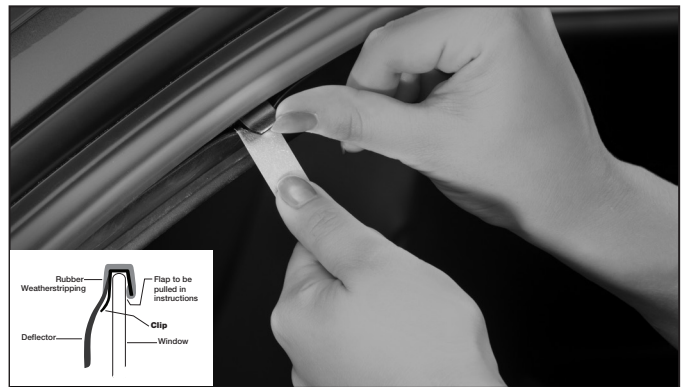

4 Insert the second channel clip as shown.



5 Insert the front of the deflector as shown. Ensure that the edge rests on the top of the outer window sill.



7 Starting with the front of the deflector, begin tucking the flange into the window channel while pressing inward against the channel clips. Be sure to tuck the flange between weather stripping and the channel clip.

9 Repeat steps 1-8 for the passenger side.



6 Bow the deflector outward to insert the rear flange into the window channel. Making sure the window gasket is not folded over.



8 Inspect the deflector to ensure that it is fully inserted into the window channel. Slowly and carefully, close your window fully and press firmly against weather strip from front to rear without engaging auto-up feature.

Installation Tips:

1. When installed correctly, the bottom edge of the front deflector must rest on the door's outer weather stripping and only the thin flange is in the channel between the glass and inner seal.
2. Slowly raise the window up without activating the auto-up. If unable to fully close, have someone press the window between their hands upwards. Simultaneously raise the window up in small increments until fully closed.
3. If safety features cause the window to go down, reset the window by:
 - a. Roll the window down, hold the down button for 5 seconds.
 - b. Raise the window without activating the auto-up feature. Hold the up button for 3 seconds.
4. Leave windows closed fully for 12 hours. Deflector may take longer to acclimate below 60° F / 16° C.

Congratulations!

Your new WeatherTech® Side Window Deflectors have been installed!