

# WeatherTech®

## Easy-On™ Stone & Bug Deflectors

### Important Safety Information



- CAUTION - Before driving, ensure that the hood shield is properly anchored to vehicle.
- Do not use automatic "brush-style" car washes.
- Do not use cleaning solvents of any kind.
- Periodically check all components for tightness.

### Contents **NOTE:** Actual product may vary from illustration.



Hood Shield



Bump On  
x4



Plastic Washer  
x6



Screw  
x6

### Tools Required



Car Wash Supplies

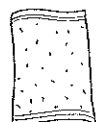

Clean Towel

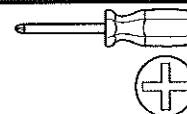

Appropriate hand tools

### Preparation Before Painting / Installation

- A trial fit is recommended to ensure proper positioning and fit.
- Check fit of parts before painting as we will not accept the return of modified or painted parts.
- Wash your vehicle's hood to remove any debris and/or dirt.
- Dry the hood with a clean towel.
- Do NOT install hood shield if vehicle does NOT have a factory installed hood seal / gasket.

### Installation Steps **NOTE:** Actual application may vary slightly from illustrations.

Remove (6) plastic seal retaining fasteners that align with the pre-drilled holes in the hood shield. Next, carefully separate the hood seal / gasket from the areas of the hood that align with the hood shield flange.

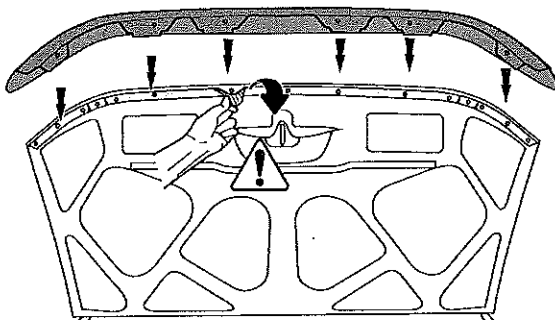

1



**NOTE:** Exercise extreme caution not to tear or damage the hood seal / gasket when separating from hood.

Reposition the hood shield with the tabs sliding between the hood and rubber seal and align with holes.

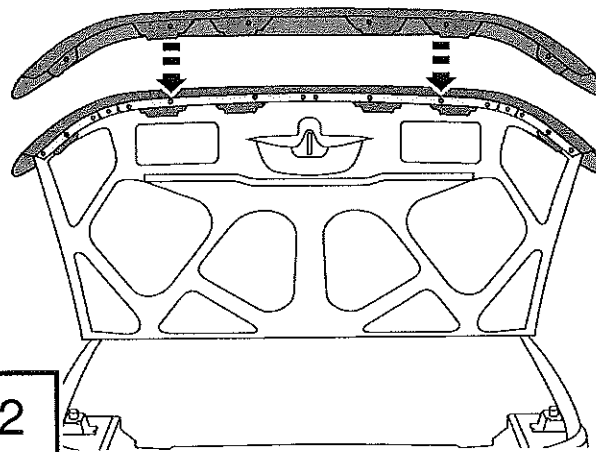

2

## Installation Steps

**NOTE:** Actual application may vary slightly from illustrations.

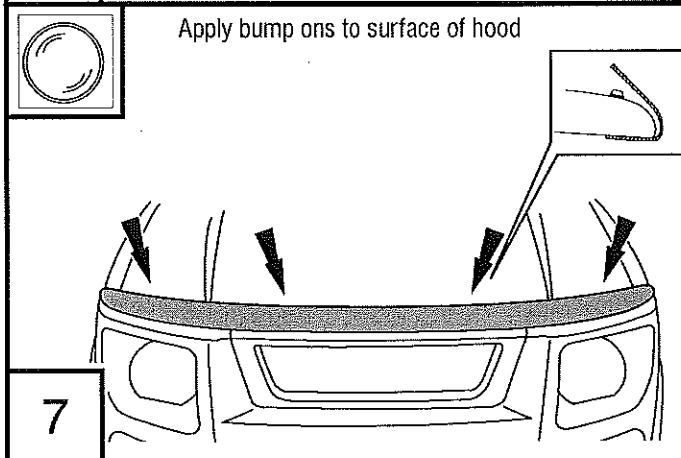
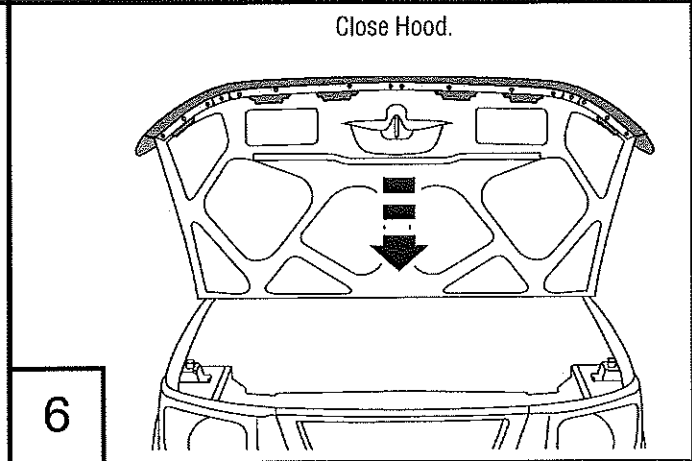
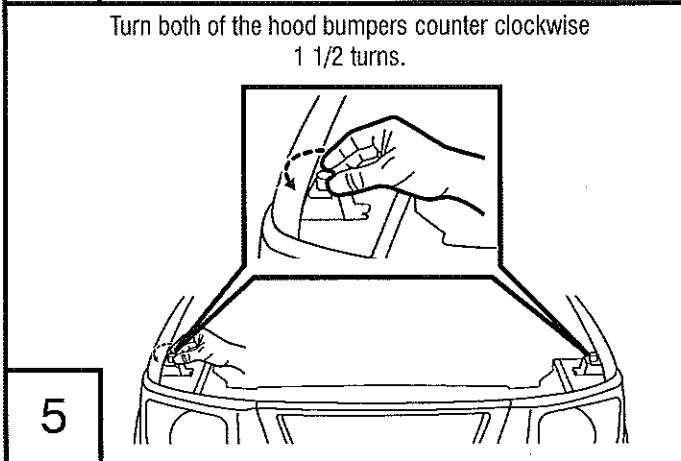
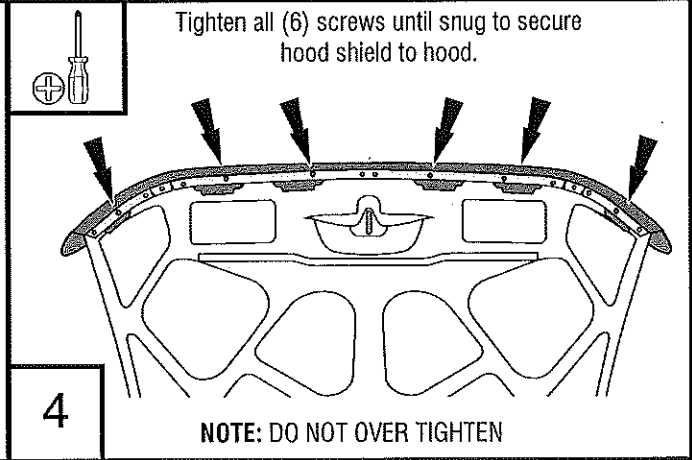
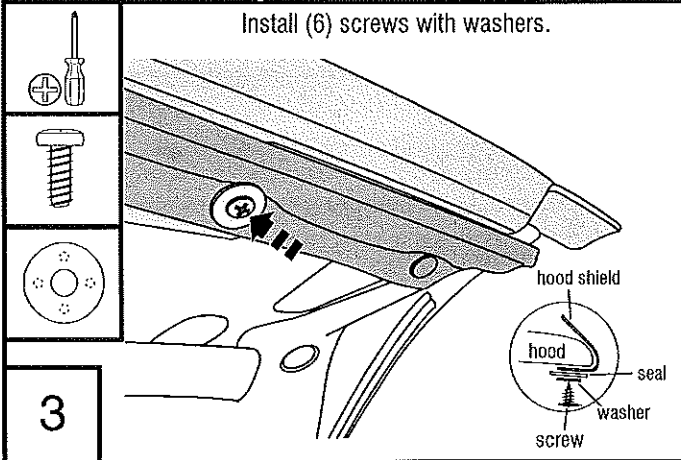

## Care and Cleaning

- Wash only with mild soap & dry with a clean cloth.

Looking for dependable stone & bug deflectors?  
Rely on Weathertech for quality and long-lasting products.