

# WeatherTech®

## Easy-On™ Stone & Bug Deflectors

### Important Safety Information

- ⚠ CAUTION - Before driving, ensure that the hood shield is properly anchored to vehicle.
- Do not use automatic "brush-style" car washes.
- Do not use cleaning solvents of any kind.
- Periodically check all components for tightness.

### Contents **NOTE:** Actual product may vary from illustration.

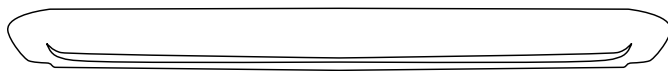

Hood Shield



Bump On x4  
(98024)



Metal Washer x4  
(98038)



Screw x4  
(98048)



Well Nut x4  
(98037)

### Tools Required



Car Wash Supplies

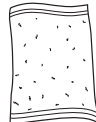

Clean Towel

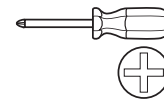

Appropriate hand tools

### Preparation Before Painting / Installation

- A trial fit is recommended to ensure proper positioning and fit.
- Check fit of parts before painting as we will not accept the return of modified or painted parts.
- Wash and dry your vehicle to remove any debris and/or dirt from the installation area.

### Installation Steps **NOTE:** Actual application may vary slightly from illustrations.

Open Hood.

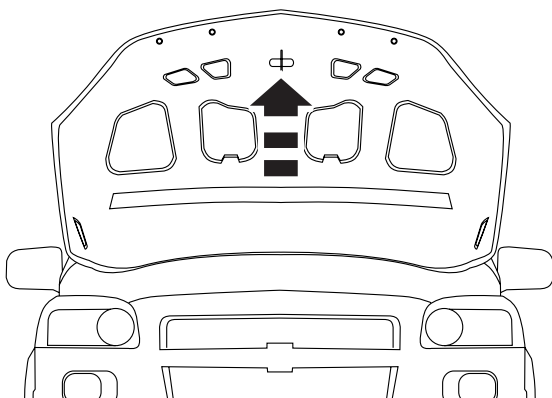

1

2

Assemble fasteners by inserting screw through washer, hood shield and into well nut. Hand tighten.

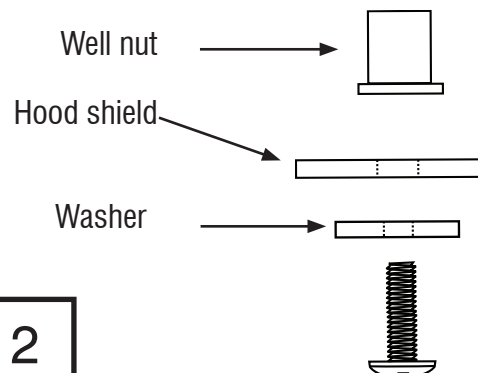

**Installation Steps** NOTE: Actual application may vary slightly from illustrations.

Center part on front edge of hood and align holes

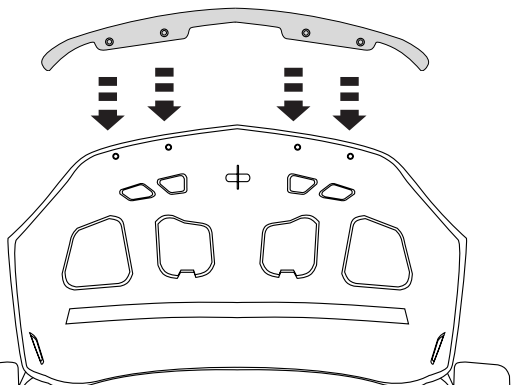

3

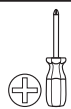

With well nut inserted into hole in hood, secure hood shield to hood by tightening screw to expand well nut. Repeat for remaining fasteners.

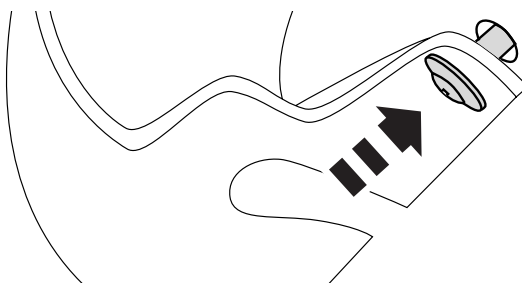

4

**NOTE: DO NOT OVER TIGHTEN**

Close Hood.

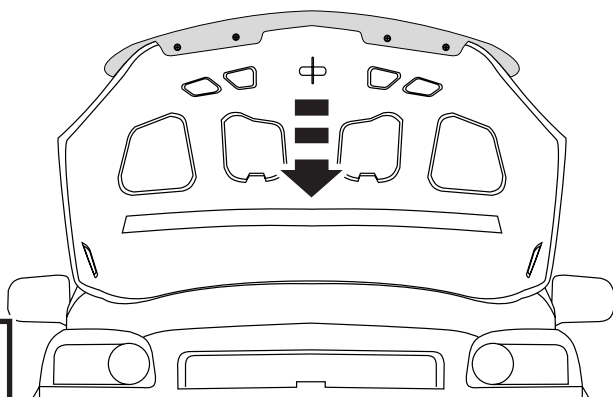

5



Apply bump ons to surface of hood

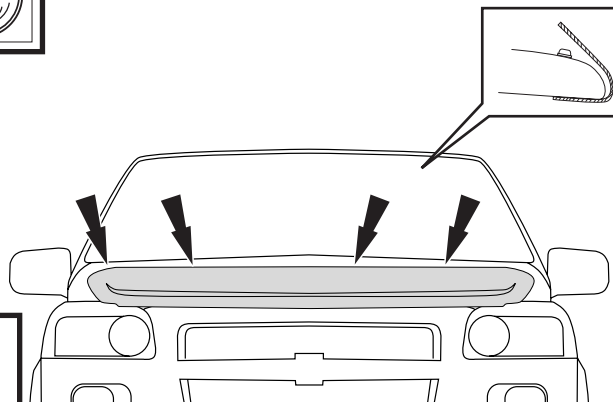

6

**Care and Cleaning**

- Wash only with mild soap & dry with a clean cloth.

Looking for dependable stone & bug deflectors?  
Rely on Weathertech for quality and long-lasting products.